

**Part Number: PT948-12201****Kit Contents**

Item #	Quantity Req'd.	Description
1	1	Driver Side Badge
2	1	Passenger Side Badge
3		

**Hardware Bag Contents**

Item #	Quantity Req'd.	Description
1		

**Additional Items Required For Installation**

Item #	Quantity Req'd.	Description
1		

**Conflicts**

Vehicles without Body Side Moldings
-------------------------------------

**Recommended Tools**

<b>Personal &amp; Vehicle Protection</b>	<b>Notes</b>
Safety Glasses / Gloves	Optional
<b>Special Tools</b>	<b>Notes</b>
Non-Intrusive IR Temperature Probe / Gun	
Squeegee	4" (3M™ Gold) or 4" (3M™ Silver)
<b>Installation Tools</b>	<b>Notes</b>
Heat Source	For temperatures under 70°F
Lint-Free Scratch Resistant Cloth	WypAll L40 Disposable Cloth (Recommended)
<b>Special Chemicals</b>	<b>Notes</b>
Cleaner	VDC Approved Cleaner (PPO)
	Soap & Water Mixture (DIO)
Clean Water	Bottled Distilled Water

**General Applicability**

MY20 and newer Corolla HB with Body Side Moldings
---

**Recommended Sequence of Application**

Item #	Accessory
1	
2	
3	

\*Mandatory

**Vehicle Service Parts** (may be required for reassembly)

Item #	Quantity Req'd.	Description
1		
2		
3		

**Legend**

**STOP:** Damage to the vehicle may occur. Do not proceed until process has been complied with.



**OPERATOR SAFETY:** Use caution to avoid risk of injury.



**CAUTION:** A process that must be carefully observed in order to reduce the risk of damage to the accessory/vehicle and to ensure a quality installation.



**TOOLS & EQUIPMENT:** Used in Figures calls out the specific tools and equipment recommended for this process.



**REVISION MARK:** This mark highlights a change in installation with respect to previous issue.



**SAFETY TORQUE:** This mark indicates that torque is related to safety.



**REGULATORY MARK:** This mark indicates the component is related to regulatory compliance

## Procedure

Care must be taken when installing this accessory to ensure damage does not occur to the vehicle. The installation of this accessory should follow approved guidelines to ensure a quality installation.

These guidelines can be found in the "Accessory Installation Practices" document.

This document covers such items as:

- Vehicle Protection (use of covers and blankets, cleaning chemicals, etc.).
- Safety (eye protection, rechecking torque procedure, etc.).
- Vehicle Disassembly/Reassembly (panel removal, part storage, etc.).
- Electrical Component Disassembly/Reassembly (battery disconnection, connector removal, etc.).

Please see your Toyota dealer for a copy of this document.

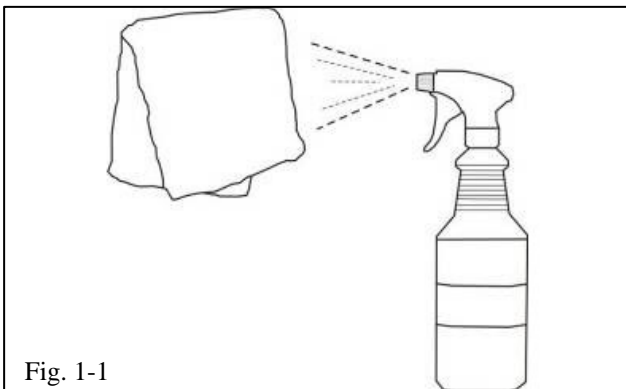

### 1. Prepare the Vehicle.

- (a) Thoroughly clean all installation surfaces. When cleaning with VDC approved cleaner (PPO), follow with a clean water solution (Fig. 1-1).

**⚠ NOTE: Shake VDC cleaner (PPO) or soap and water mixture (DIO) well.**

- (b) Apply VDC cleaner or soap & water mix directly to cloth. Do not spray cleaning solutions directly to body side molding (Fig.1-1).
- (c) Clean surface thoroughly and wipe dry immediately with a new clean cloth. Do not allow cleaner to air dry (Fig. 1-2).
- (d) Apply water to a clean cloth. Clean surface soap & water mixture is completely removed. Wipe dry with a new clean cloth.
- (e) Body side molding installation surface and body side molding badge must be between 60°F and 90°F at time of installation.

**⚠ NOTE: A heat source may be used to reach minimum temperature if necessary.**

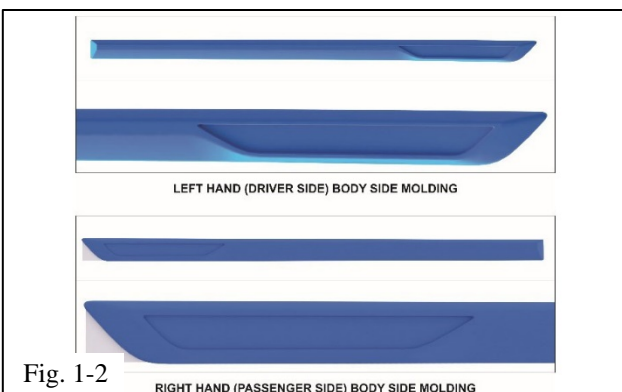



## 2. Check Kit Content.

- ⚠ (a) Inspect kit for content and damage (Fig. 2-1).

## 3. Install Body Side Molding Badge (Passenger Side)

- (a) Locate the rearward corner of the body molding badge (Fig. 3-1).



- (b) While holding the part in one hand, peel the liner completely away with the other hand, exposing the adhesive of the part (Fig. 3-2).

⚠ **NOTE: Do not touch adhesive during installation.**

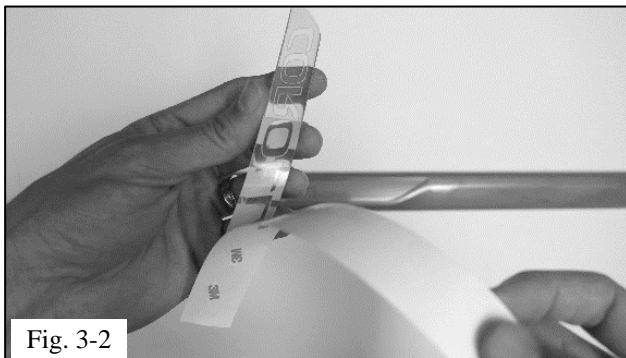

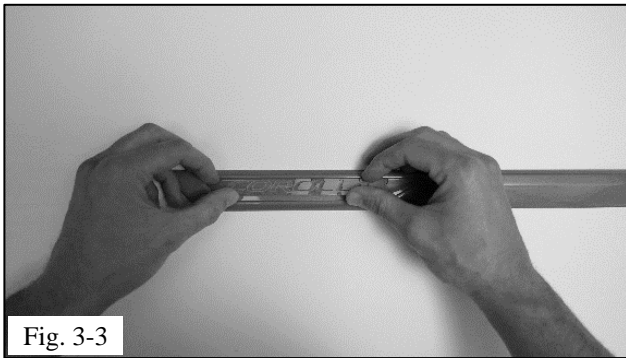

- (c) Center the badge in the middle of the body side molding cavity using the top edge for reference. Do not apply the badge until it has been centered in the cavity (Fig. 3-3).

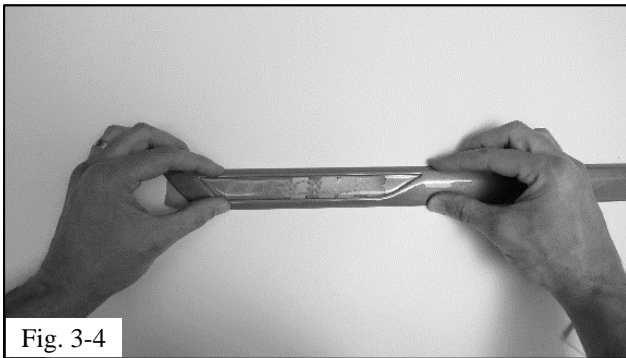

- (d) Allow the badge to drop into the body side molding cavity. Gently apply the part into the cavity while maintaining vertical spacing between the part and the edges of the cavity (Fig 3-4).



**NOTE: Do NOT press firmly into place until alignment has been verified.**

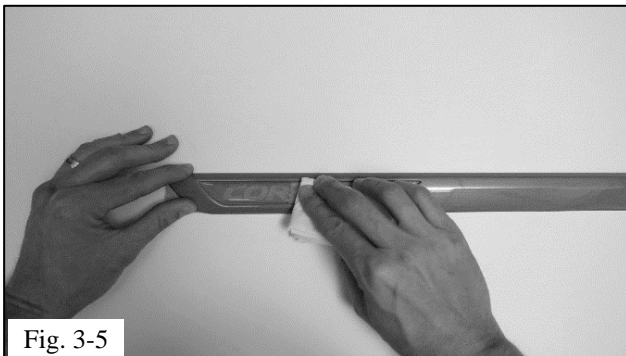

- (e) Once even spacing has been confirmed, begin to gently apply pressure to the badge with a rag starting from the center of the badge and working outward toward the edges, removing all air bubbles (Fig. 3-5).

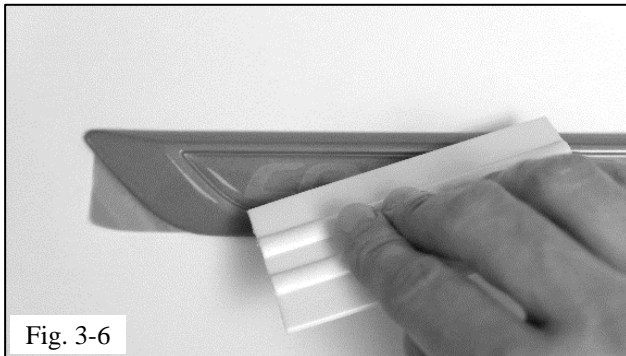

Fig. 3-6

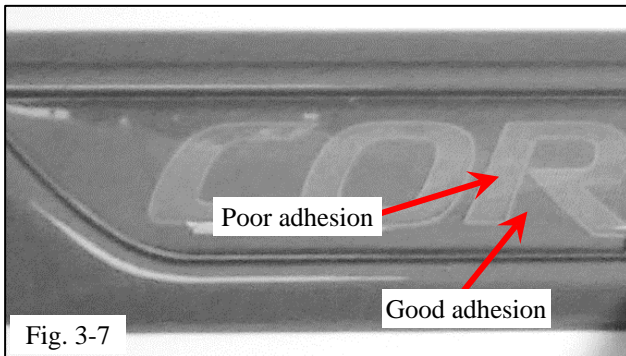

Fig. 3-7

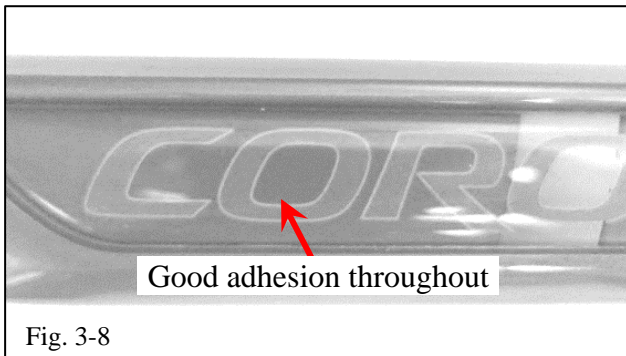

Fig. 3-8

- (f) Using a squeegee, apply firm pressure to the badge along edges and corners to ensure full adhesion, being careful not to scratch the surface of the body side molding (Fig. 3-6).

**NOTE:** To ensure full adhesion of the part, be mindful of areas that are lighter in color than the surrounding badge. Fig. 3-7 illustrates a badge with poor adhesion, where the poorly adhered areas are light and can be differentiated from the darker areas that have good adhesion.

**NOTE:** Be attentive to the outer edges of the badge to ensure all air has been removed and the badge surface has complete contact (Fig. 3-8).

#### 4. Install Body Side Molding Badge (Driver Side).

- (a) Repeat Steps 3(a) – 3(f) for the driver side installation process.

**TOYOTA      COROLLA HB      2020 -      EXTERIOR EMBLEM**

Checklist - these points **MUST** be checked to ensure a quality installation.

Check:	Look For:
<u>Accessory Function Checks</u>  <input type="checkbox"/> Body side molding badge adhesive <input type="checkbox"/> Body side molding badge alignment <input type="checkbox"/> <input type="checkbox"/>	  Badge should be securely attached to the vehicle; no air pockets or lifting.  Badge should be aligned evenly within body side molding cavity.
<u>Vehicle Function Checks</u>  <input type="checkbox"/>  <input type="checkbox"/>  <input type="checkbox"/>	
<u>Vehicle Appearance Check</u>  <input type="checkbox"/> After accessory installation, perform a visual inspection.    <input type="checkbox"/> Verify driver and passenger side badges are installed.	    Ensure no damage (including scuffs and scratches) was caused during the installation process. (For PPO installations, refer to TMNA Accessory Quality Shipping Standard.)