

Part Number: PT767-34221

### Kit Contents

Item #	Quantity Req'd.	Description
1	1	LH Running Board
2	1	RH Running Board

### Hardware Bag Contents

Item #	Quantity Req'd.	Description

### Additional Items Required For Installation

Item #	Quantity Req'd.	Description

### Conflicts

--

### Recommended Tools

<b>Personal &amp; Vehicle Protection</b>	<b>Notes</b>
Safety Glasses	
<b>Special Tools</b>	<b>Notes</b>
<b>Installation Tools</b>	<b>Notes</b>
½" Ratchet	6" extension
12mm Socket	
Torque Wrench	0-50 N-M
<b>Special Chemicals</b>	<b>Notes</b>

### General Applicability

C-Cab Models
--------------

### Recommended Sequence of Application







Item #	Accessory

\*Mandatory

### Vehicle Service Parts (may be required for reassembly)

Item #	Quantity Req'd.	Description
1	12	BOLT, w/ WASHER (90119-A0582)

### Legend

-  **STOP:** Damage to the vehicle may occur. Do not proceed until process has been complied with.
-  **OPERATOR SAFETY:** Use caution to avoid risk of injury.
-  **CAUTION:** A process that must be carefully observed in order to reduce the risk of damage to the accessory/vehicle and to ensure a quality installation.
-  **TOOLS & EQUIPMENT:** Used in Figures calls out the specific tools and equipment recommended for this process.
-  **REVISION MARK:** This mark highlights a change in installation with respect to previous issue.
-  **SAFETY TORQUE:** This mark indicates that torque is related to safety.

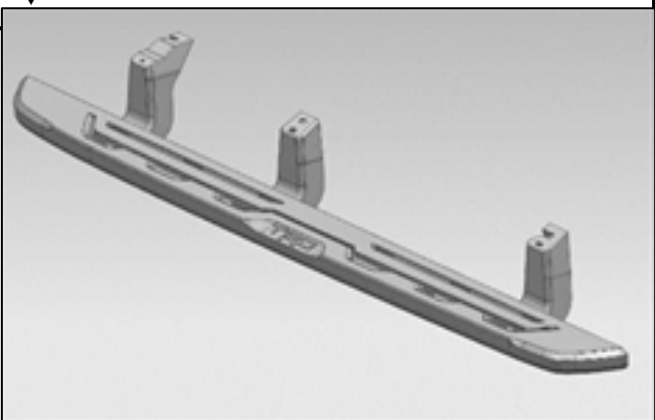

Procedure

Care must be taken when installing this accessory to ensure damage does not occur to the vehicle. The installation of this accessory should follow approved guidelines to ensure a quality installation.

These guidelines can be found in the "Accessory Installation Practices" document.

This document covers such items as:-

- Vehicle Protection (use of covers and blankets, cleaning chemicals, etc.).
- Safety (eye protection, rechecking torque procedure, etc.).
- Vehicle Disassembly/Reassembly (panel removal, part storage, etc.).
- Electrical Component Disassembly/Reassembly (battery disconnection, connector removal, etc.).

Please see your Toyota dealer for a copy of this document.

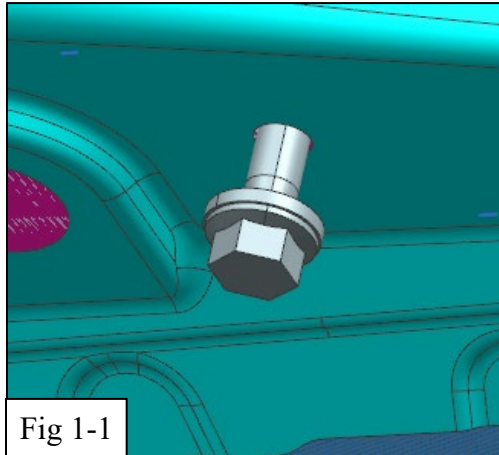

### 1. Running Board Installation RH Side

(a) Using a 12mm socket, remove 12 OE Hex bolts (90119-A0582 BOLT, W/WASHER) from underneath the vehicle in locations 1, 2, 3, 4 per Fig. 1-2 (6 per side). Save them for later use.

(b) Insert removed bolt (90119-A0582 BOLT, W/WASHER) into inner weld nut hole positions #1 and #4 by hand ½ way in. Fig. 1-1 & Fig. 1-2.

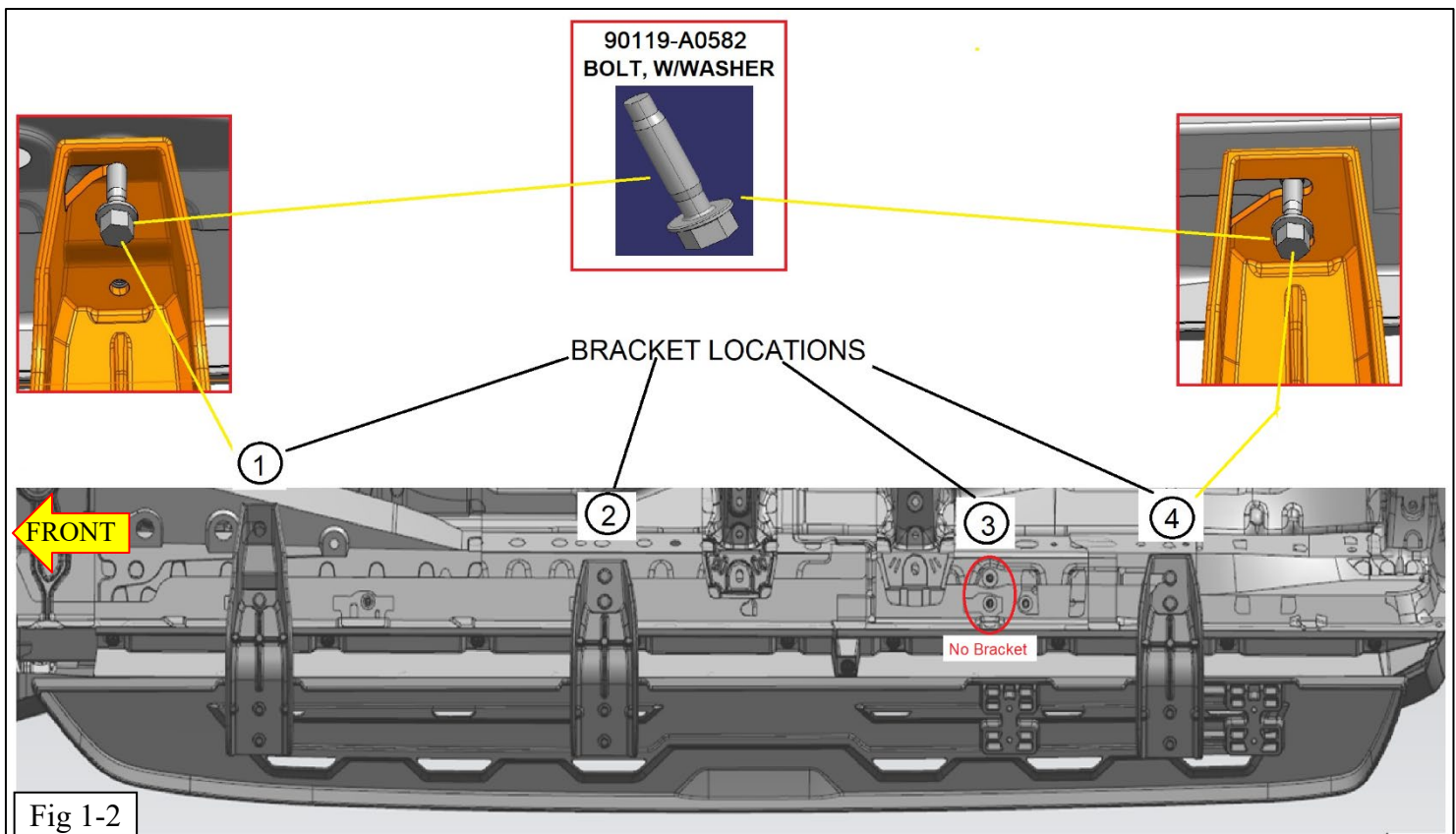

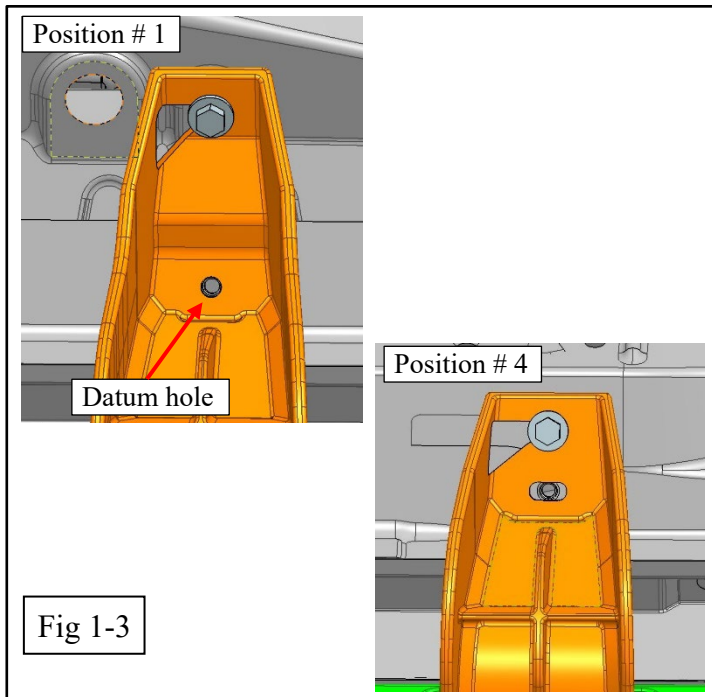

- (d) Hang the running board in position using the bolt and the key-slot in bracket position #1 and #4. Fig 1-3.
- (e) Push up and align the Front Bracket outer datum hole to the hole in the vehicle. Install and torque the two bolts to 34N.m. Repeat on rear bracket. Fig. 1-3 & 1-4.
- (f) Install the final 2 bolts (middle bracket) and torque each of them to 34 N.m.

## 2. Running Board Installation RH Side

- (a) Repeat steps 1(c) to 1(f) for the LH side of the vehicle.

## 3. Retorque All Bolts

Re-torque all bolts to 34 N.m.

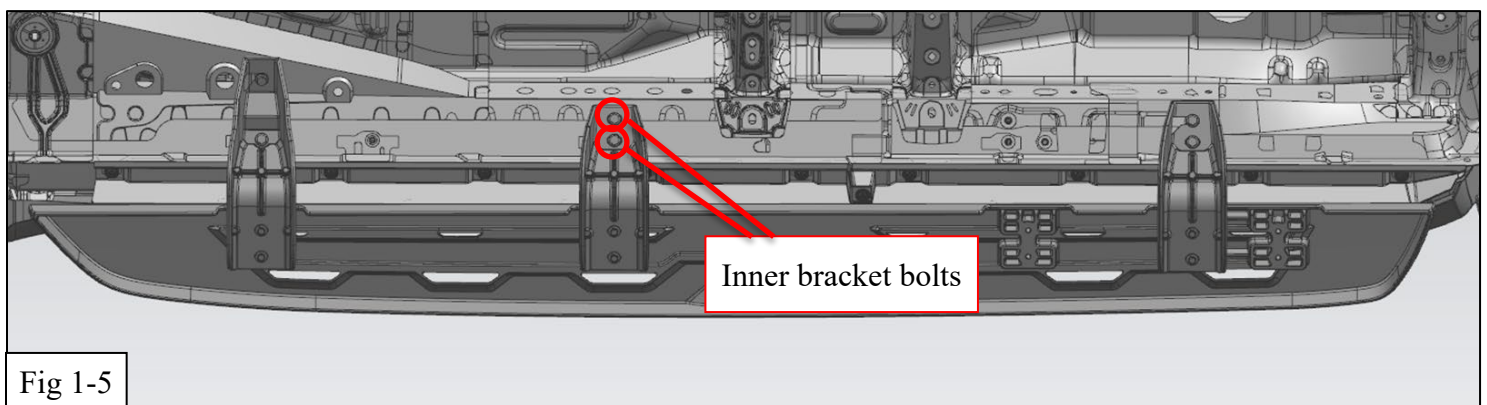
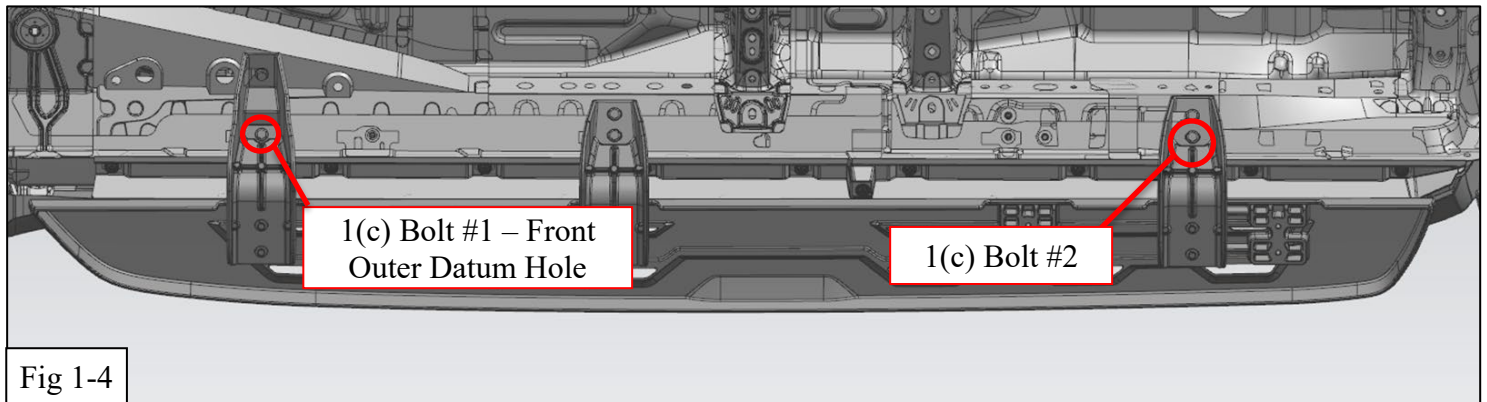

# TOYOTA TUNDRA (C-CAB)

2022 -

# RUNNING BOARD

Checklist - these points **MUST** be checked to ensure a quality installation.

Check:	Look For:
<p><u>Accessory Function Checks</u></p> <p><input type="checkbox"/> Running board alignment</p> <p><input type="checkbox"/></p> <p><input type="checkbox"/></p> <p><input type="checkbox"/></p>	<p>Ensure running board is centered on the vehicle</p>
<p><u>Vehicle Function Checks</u></p> <p><input type="checkbox"/></p> <p><input type="checkbox"/></p> <p><input type="checkbox"/></p>	
<p><u>Vehicle Appearance Check</u></p> <p><input type="checkbox"/> After accessory installation perform a visual inspection.</p>	<p>Ensure no damage (including scuffs and scratches) was caused during the installation process.</p>