

**Part Number: PT398-52084**

### Conflicts

Do not install into vehicles without RKE, or with factory Security.
---

### Recommended Sequence of Application

Item #	Accessory	
1	V4	
2	V5	

### Kit Contents

Item #	Quantity	Description
1	1	Wire Harness
2	1	GBS ECU Mounting Bracket
3	1	V5 ECU Mounting Bracket

### Hardware Bag Contents

Item #	Quantity	Description
1	1	GBS ECU
2	1	V5 ECU
3	1	Status Monitor w/Microphone
4	4	Foam Tape
5	1	Nut
6	25	Wire Ties
7	2	Warning Label (Window)
8	1	Owners Manual
9	1	Warranty Card

### Additional Items Required For Installation

Item #	Quantity	Description

**NOTE:** Part number of this accessory may not be the same as the part number shown

### Recommended Tools

Personal & Vehicle Protection	Notes
Safety Glasses	
Safety Gloves	(Optional)
Vehicle Protection	Blankets, Parts Boxes
Special Tools	Notes
Installation Tools	Notes
Phillips Screwdriver	#2 screwdriver or tip
Flat Blade Screwdriver	Jeweler's screwdriver
Nylon Panel Removal Tool	e.g. Panel Pry Tool #1 Toyota SST # 00002-06001-01
Side Cutters	
Torque Wrench	36 in•lbf (4.07 N•m)
Utility Knife	
Tape	Clear
Socket	10mm, Extension
Special Chemicals	Notes
Cleaner	VDC Approved Cleaner
Glass Cleaner	Household Windex

### Legend



**STOP:** Damage to the vehicle may occur. Do not proceed until process has been complied with.



**OPERATOR SAFETY:** Use caution to avoid risk of injury.



**CAUTION:** A process that must be carefully observed in order to reduce the risk of damage to the accessory/vehicle and to ensure a quality installation.



**TOOLS & EQUIPMENT:** Used in Figures calls out the specific tools and equipment recommended for this process.



**REVISION MARK:** This mark highlights a change in installation with respect to previous issue.

Care must be taken when installing this accessory to ensure damage does not occur to the vehicle. The installation of this accessory should follow approved guidelines to ensure a quality installation

These guidelines can be found in the "Accessory Installation Practices" document.

This document covers such items as:

- Vehicle Protection (use of covers and blankets, cleaning chemicals, etc.)
- Safety (eye protection, rechecking torque procedure, etc.)
- Vehicle Disassembly/Reassembly (panel removal, part storage, etc.)
- Electrical Component Disassembly/Reassembly (battery disconnection, connector removal, etc.)

Please see your Toyota dealer for a copy of this document

## PRECAUTIONS

Please Follow These Precautions During Installation

Confirm that lamps, horn, wiper and other car accessories operate normally before and after installation.



Protect your car surfaces from scratches, cover work area with blankets.

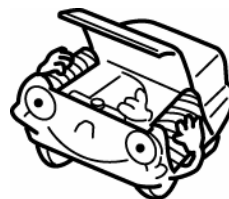

Do not touch the positive battery terminal when removing the negative cable

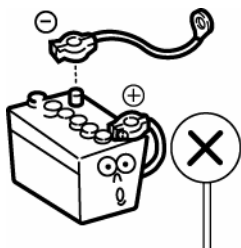

Verify secure connections.

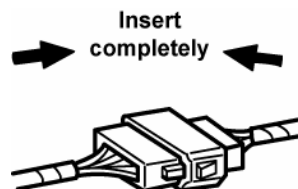

When disconnecting the connectors, be sure to grip the connector body. Do not tug on the wiring.

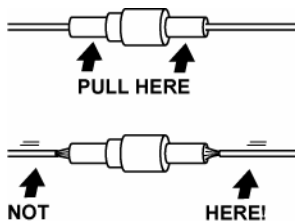

Clip all excess wire ties.

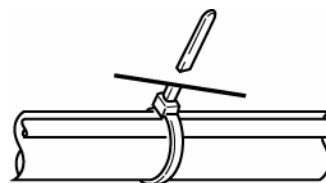

Before reconnecting the negative battery cable to the battery, check the wiring connections, harness, etc. to see that they are properly secure.

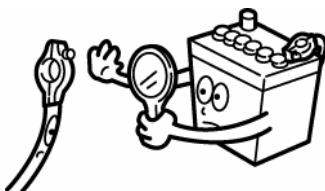

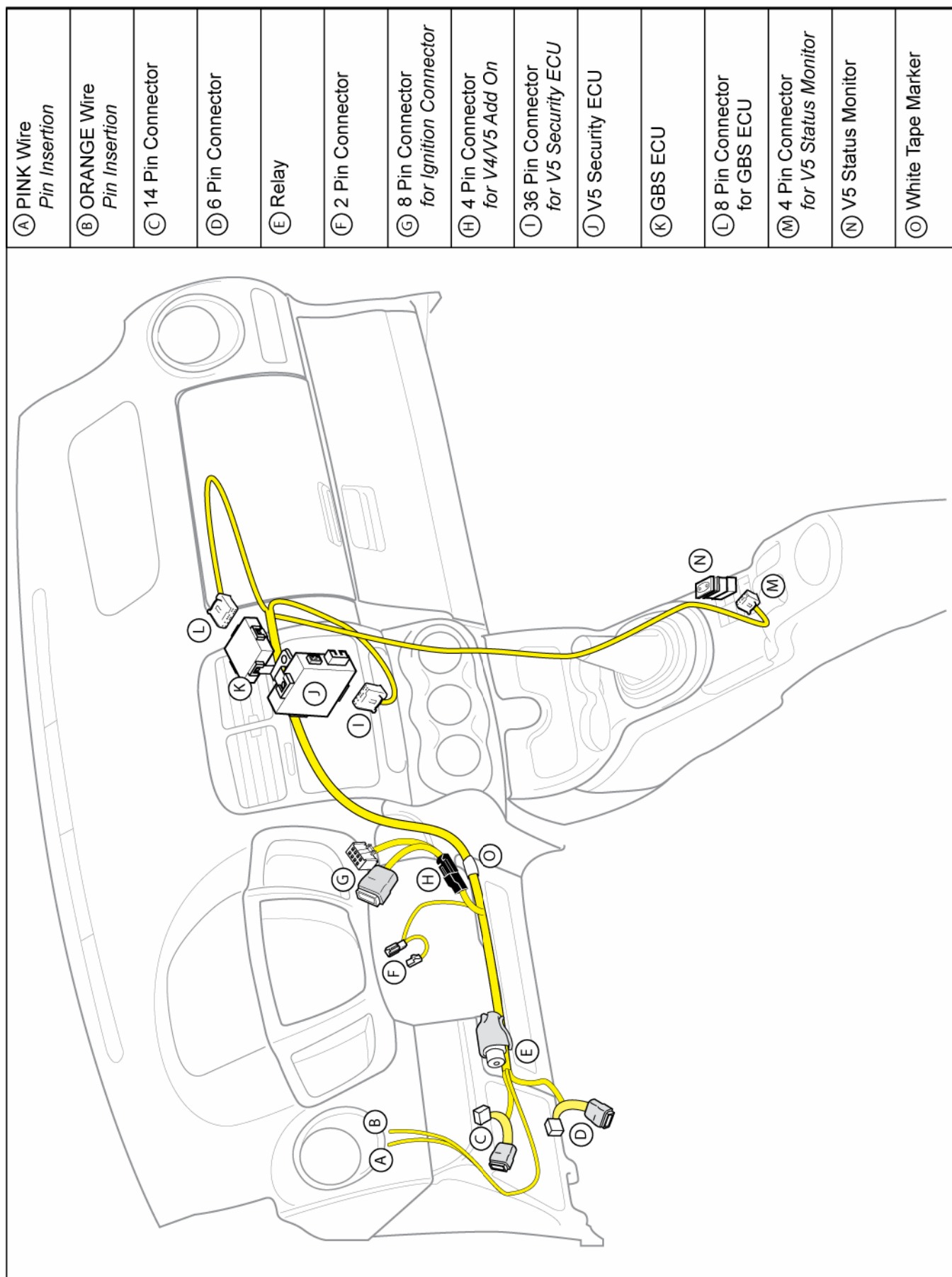

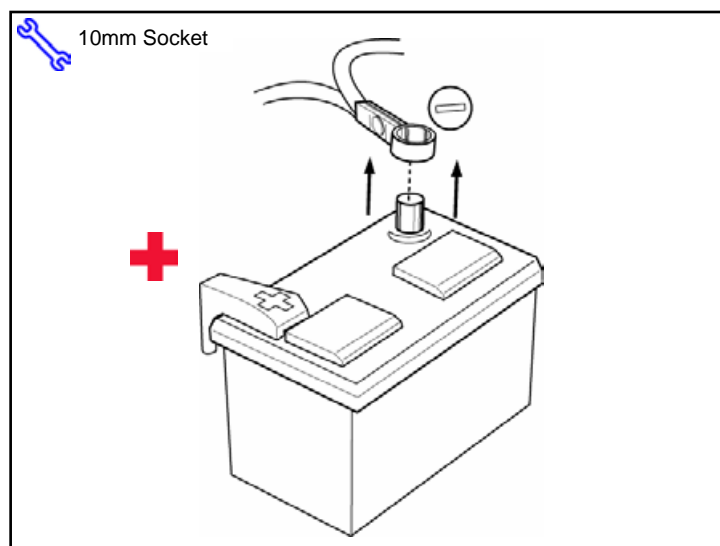

Fig. A-1

## A. Vehicle Disassembly

1. Vehicles with Automatic Transmission should be placed in Park and have the Parking brake set before disconnecting the Battery.
2. Remove the Negative battery cable.
  - (a) Note the battery cable position, as it will be reinstalled in the same position

**+** DO NOT TOUCH THE POSITIVE BATTERY TERMINAL.

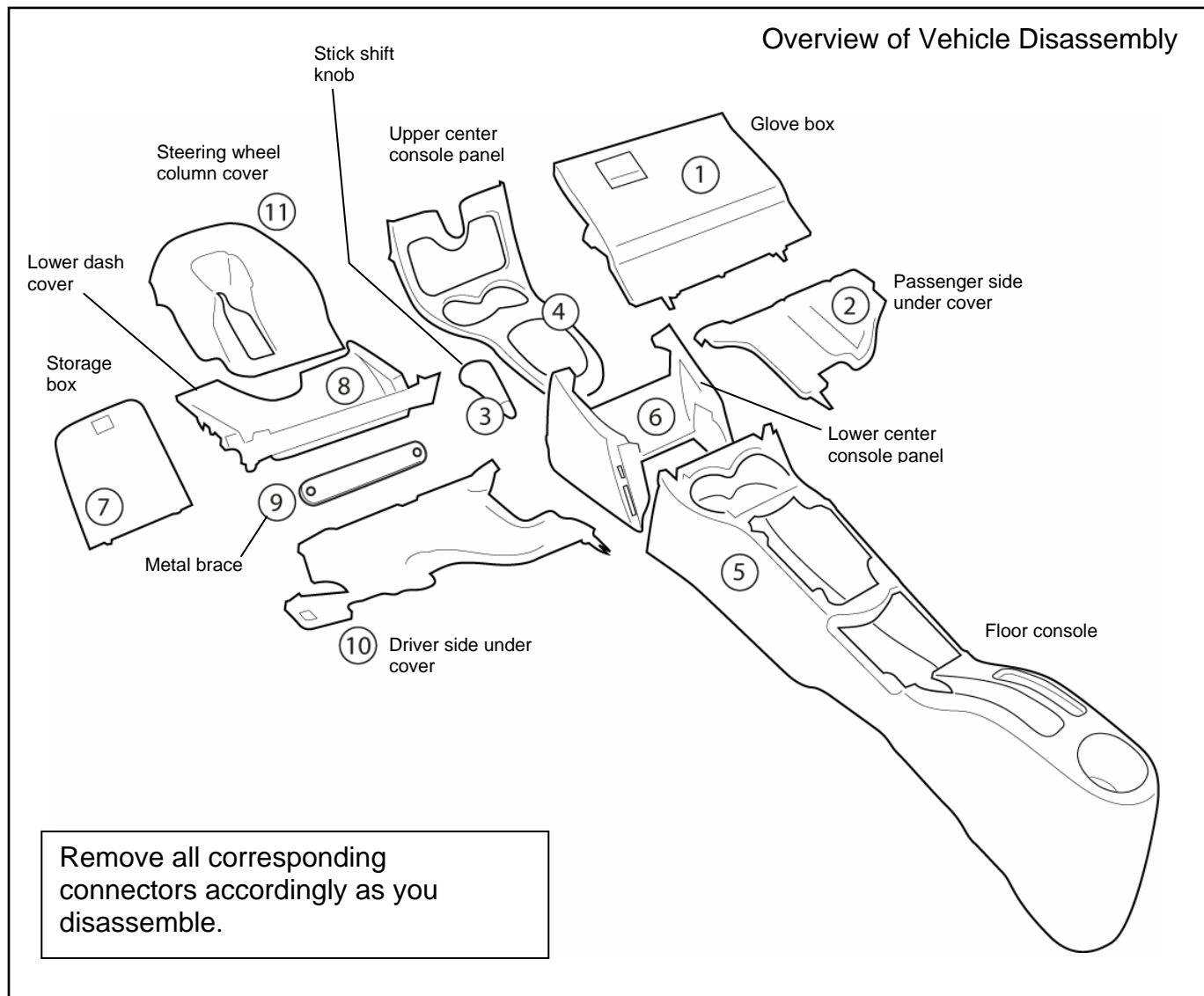

Fig. A-2

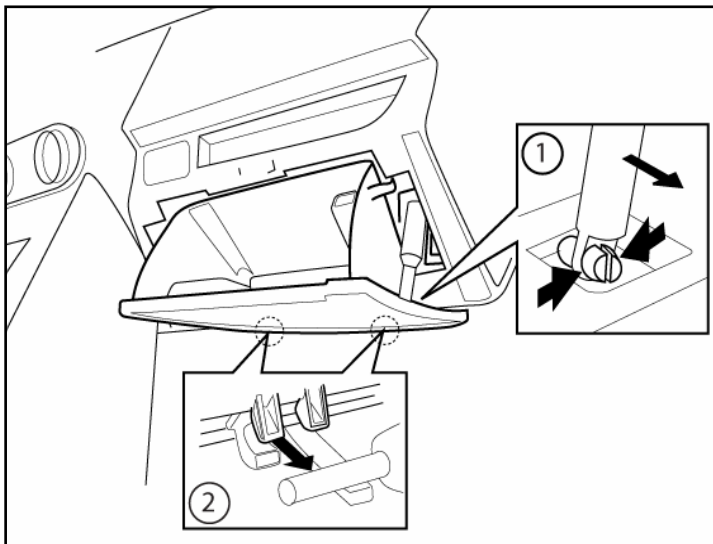

Fig. A-3

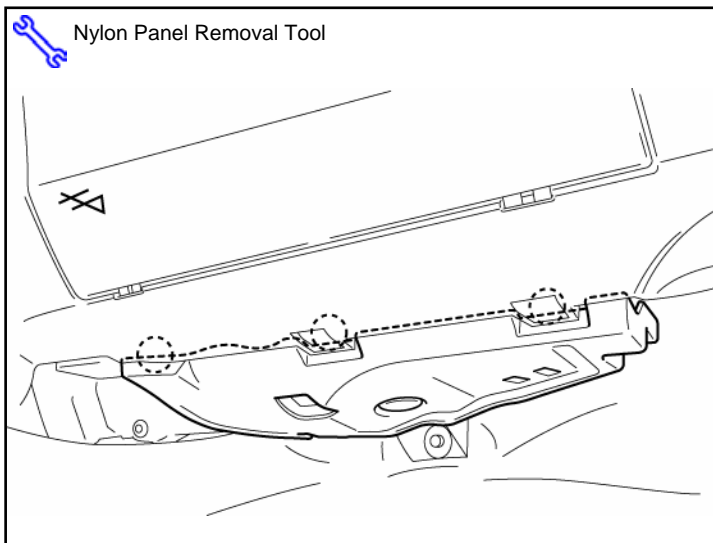

Fig. A-4

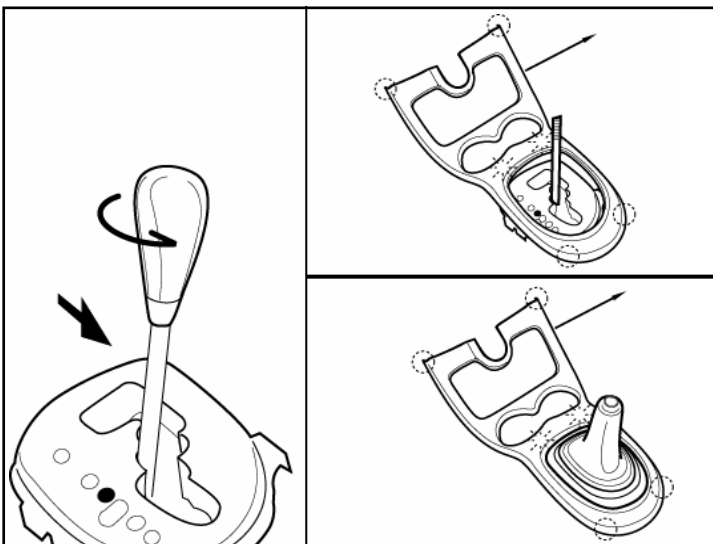

Fig. A-5

3. Disconnect the Dampener from the glove box.

4. Remove the Glove box.

5. Remove the passenger side Under cover.

**Automatic Transmission vehicle**

6. Unscrew the Stick shift knob, and remove the Upper center console panel.

**Manual Transmission vehicle**

7. Unscrew the Stick shift knob, and remove the Upper center console panel.

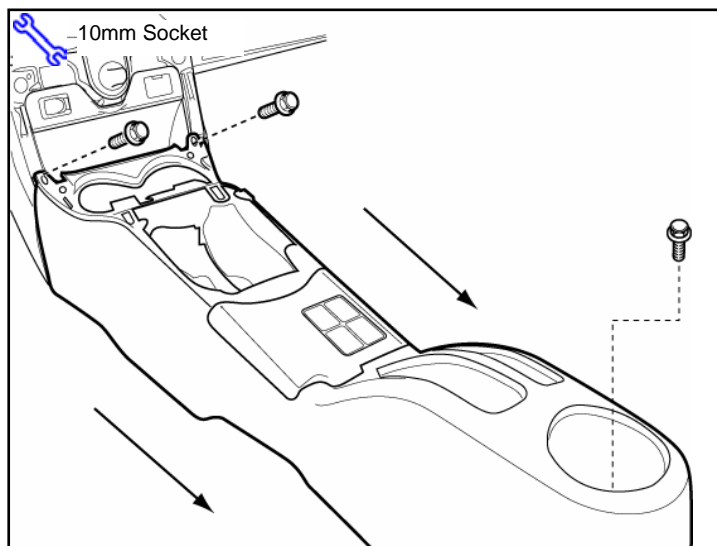

Fig. A-6

8. Remove 3 bolts.
9. Remove the Floor console.

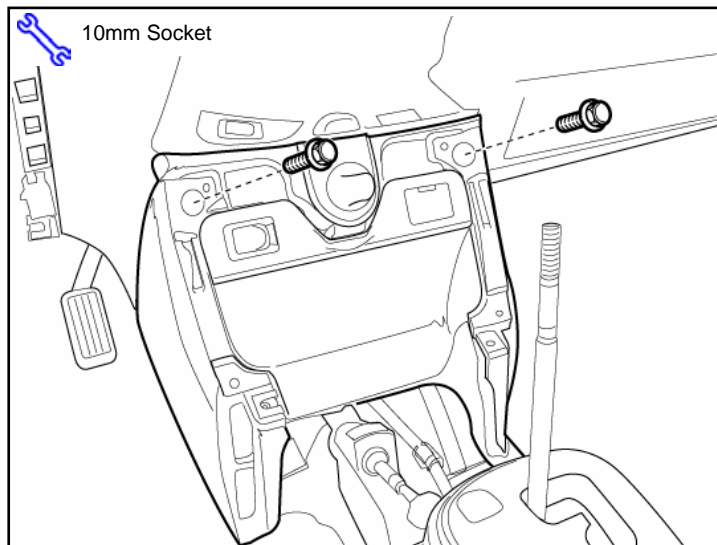

Fig. A-7

10. Remove 2 bolts and remove the Lower center console panel.

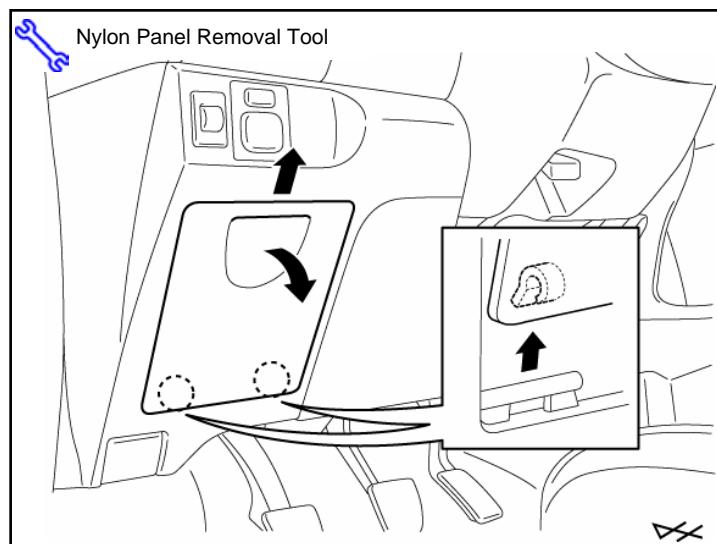

Fig. A-8

11. Remove the Storage box in Driver's side.

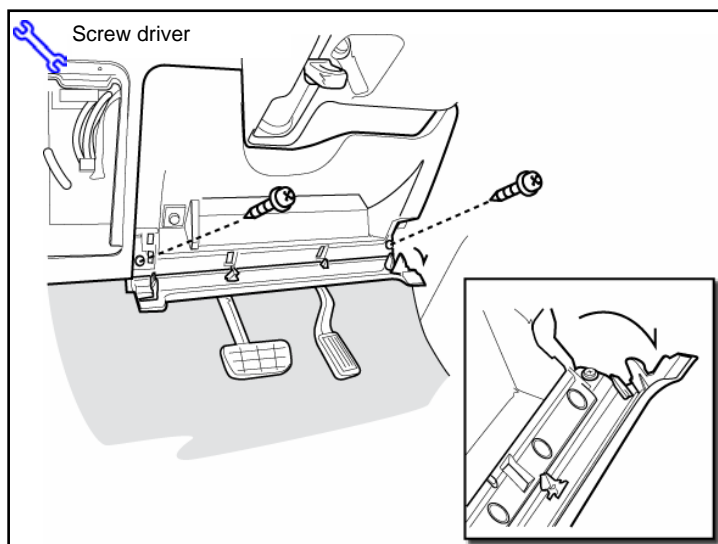

Fig. A-9

12. Open and release clips.

13. Remove 2 Screws.

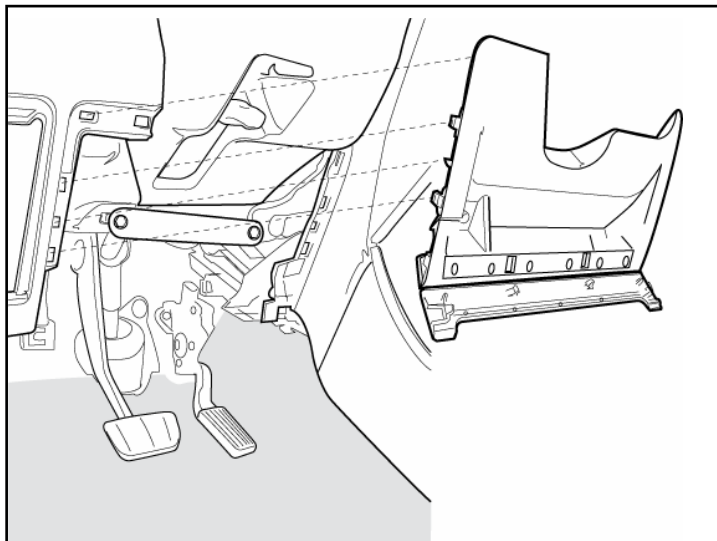

Fig. A-10

14. Remove the Lower dash cover.

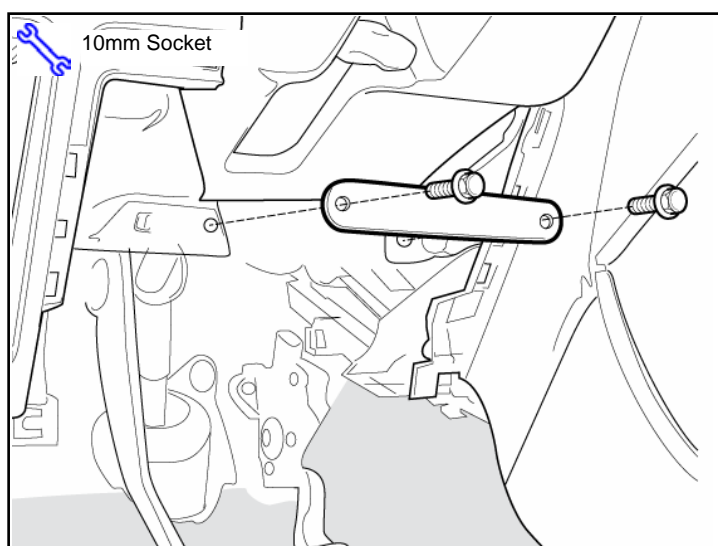

Fig. A-11

15. Remove 2 bolts and the metal brace.

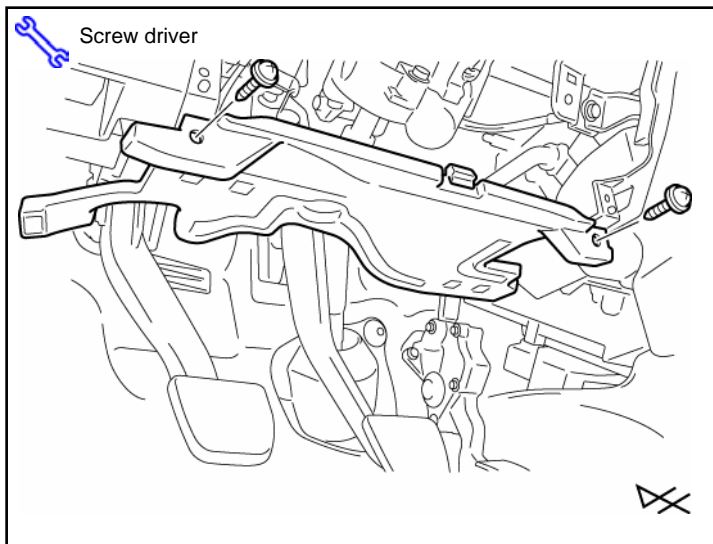

Fig. A-12

16. Remove 2 Screws and the driver side Under cover.

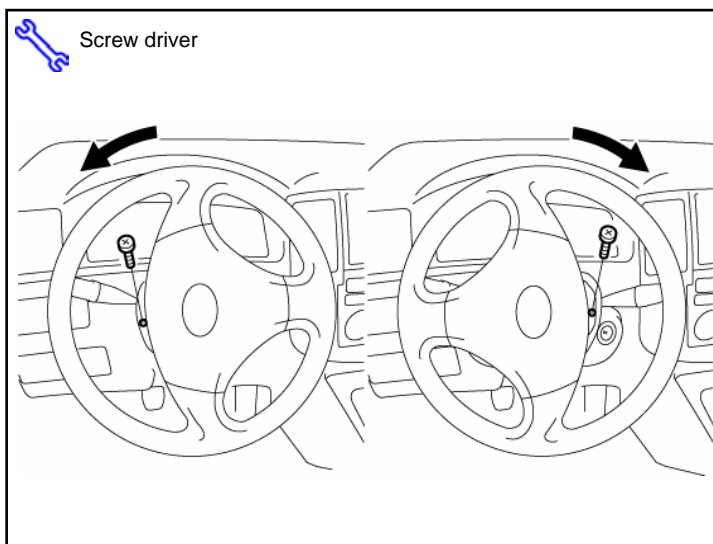

Fig. A-13

17. Insert the key into ignition switch and turn it to On.

18. Gain access to the 2 screws securing the steering column cover, and Remove them.

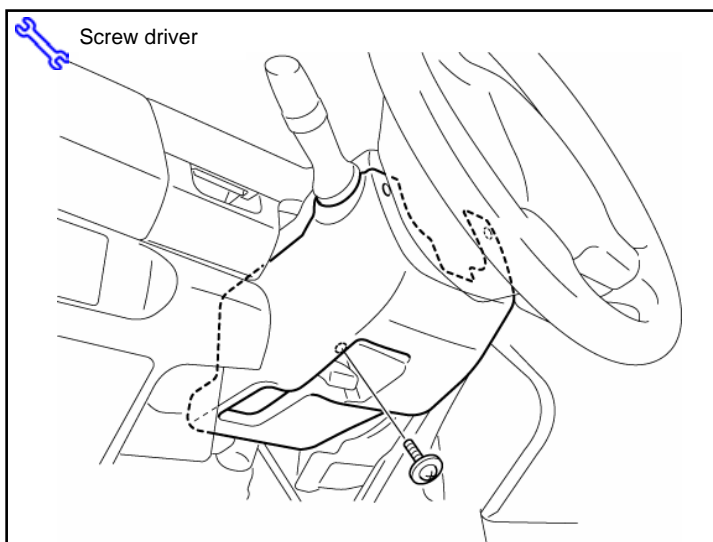

Fig. A-14

19. Remove 1 Screw.

20. Remove the Steering column cover.

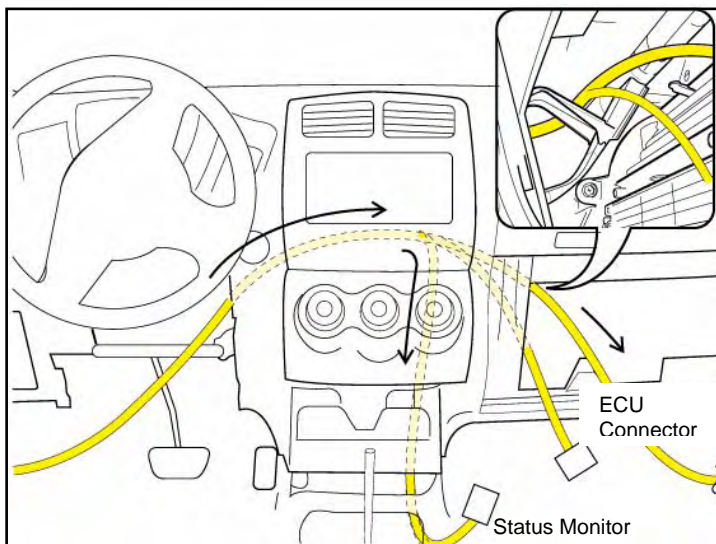

Fig.B-1

## B. Wire Harness Installation (Driver's Side)

1. Route the V5 Harness through Center console.
  - (a) Harness with ECU connectors: route to passenger side.
  - (b) Harness with Status Monitor: route down towards floor console.

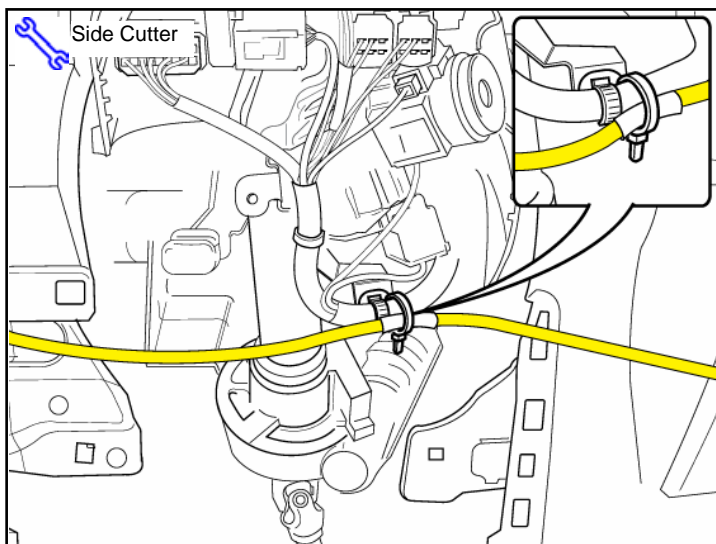

Fig.B-2

2. Secure the V5 Harness's White Tape Marker to the vehicle harness with 1 Wire Tie.

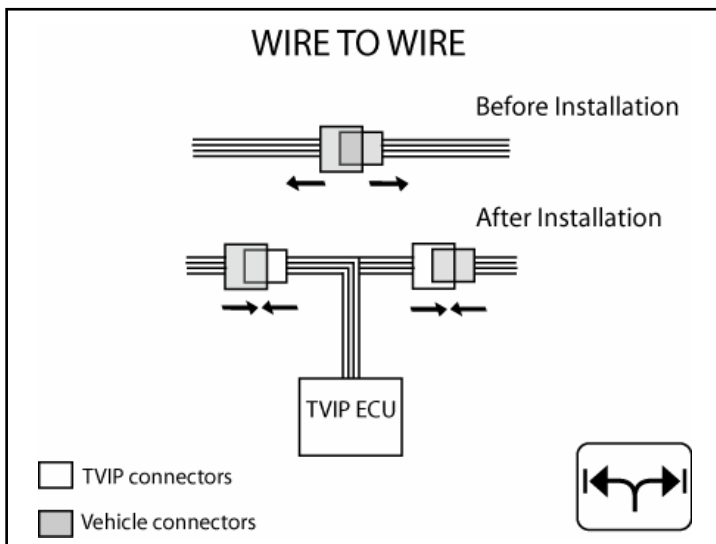

Fig. B-3



“Wire To Wire” is a process of inserting TVIP connectors between vehicle connectors in order to obtain appropriate electronic signals.

It will be repeated throughout installation.

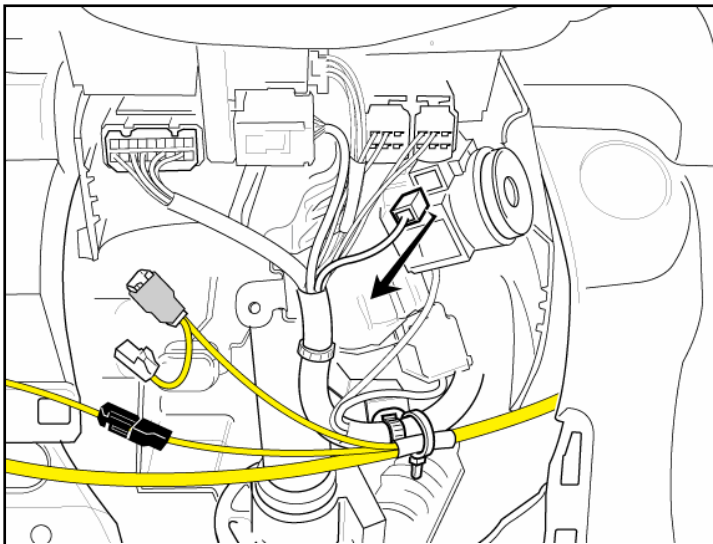

Fig. B-4

3. Unplug the vehicle 2 Pin connector as shown.

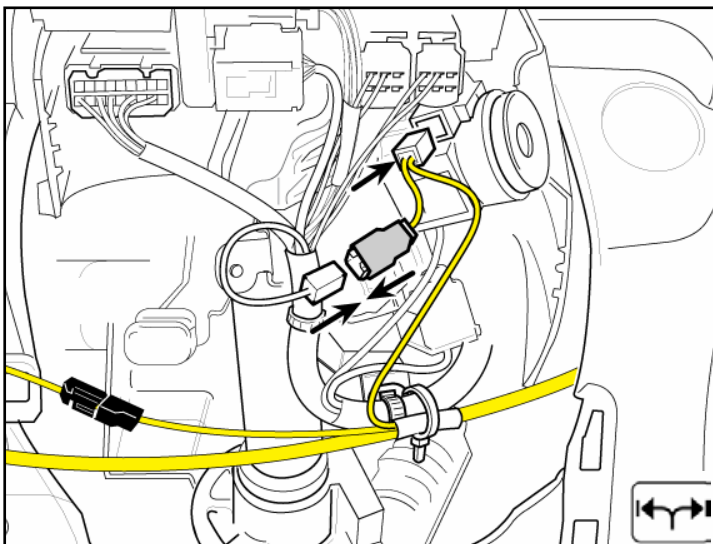

Fig. B-5

4. Proceed with "Wire to Wire". Insert V5 2 Pin Connectors in between vehicle 2 Pin connectors as shown.

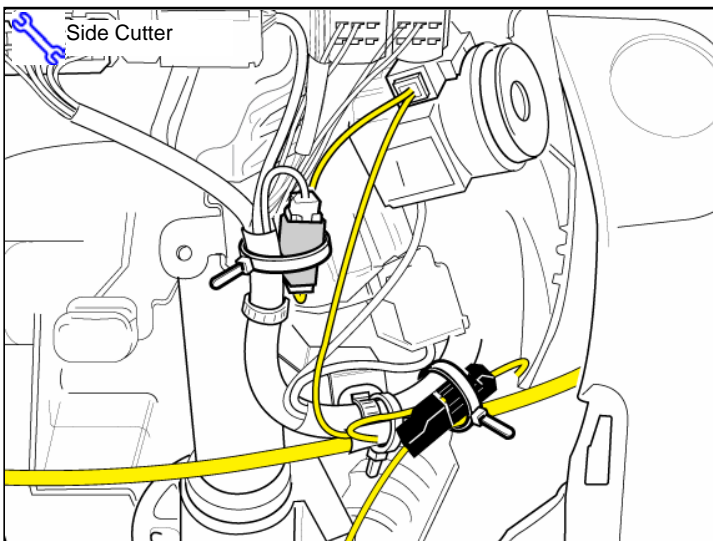

Fig. B-6

### V5 only

-If vehicle is equipped with V4  
Harness already, skip to step 10

5. Secure the joint 2 Pin connectors onto vehicle harness with 1 Wire Tie.
6. Secure the V5 4 Pin Connectors (black) onto the vehicle harness with 1 Wire Tie.

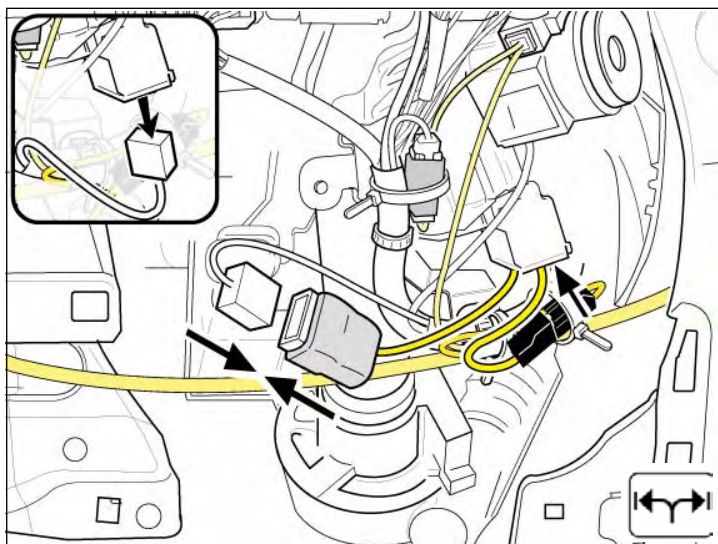

Fig.B-7

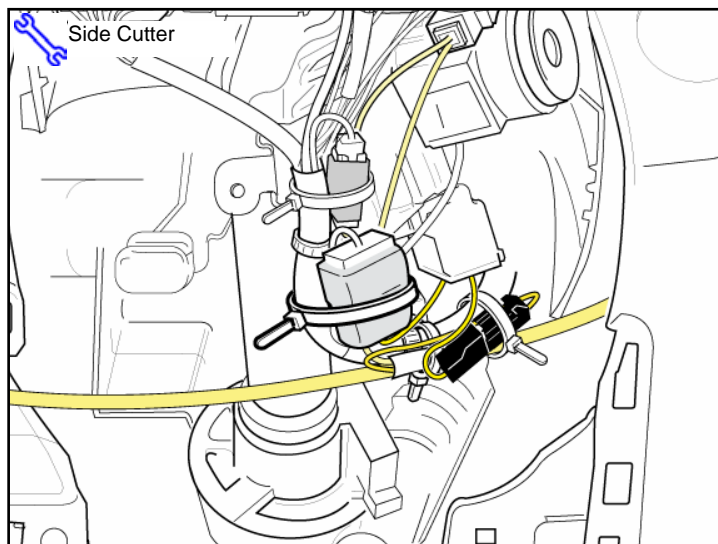

Fig. B-8

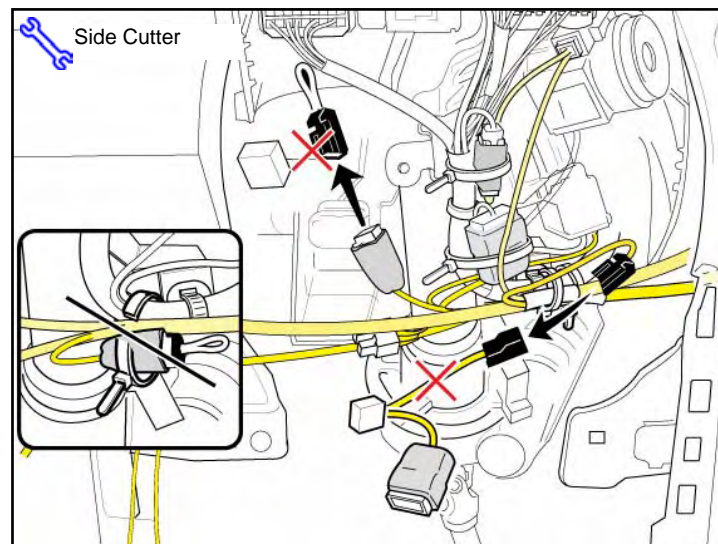

Fig. B-9

7. Unplug the vehicle 8 Pin connector.

8. Proceed with "Wire to Wire".  
Insert V5 8 Pin Connectors in  
between vehicle connectors.

9. Secure the joint 8 Pin connectors onto  
the vehicle harness with 1 Wire Tie.

Move onto step 14.

### V5 onto V4

#### -Add On installation

10. If Vehicle is already equipped with V4  
Harness, V5 Harness rides onto V4  
Harness.

Clip off 1 Wire Tie holding V4 4 Pin  
Connector.

11. Unplug 2 Pin Connectors (black) on  
each of V4 and V5 Harnesses.

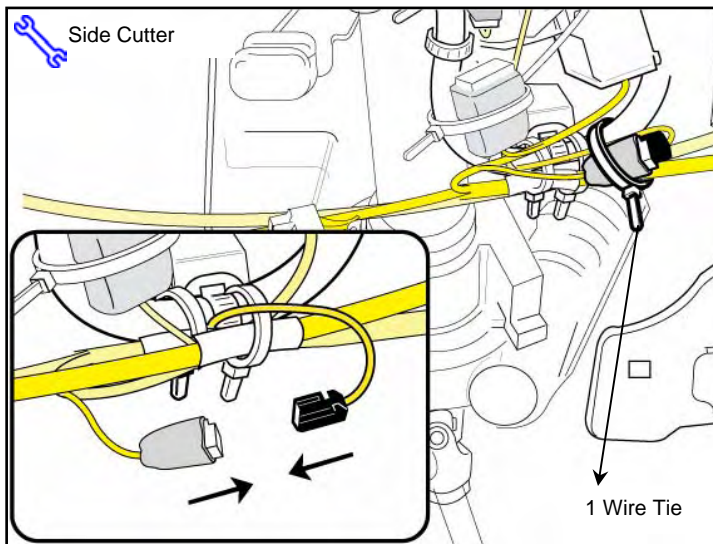

Fig. B -10

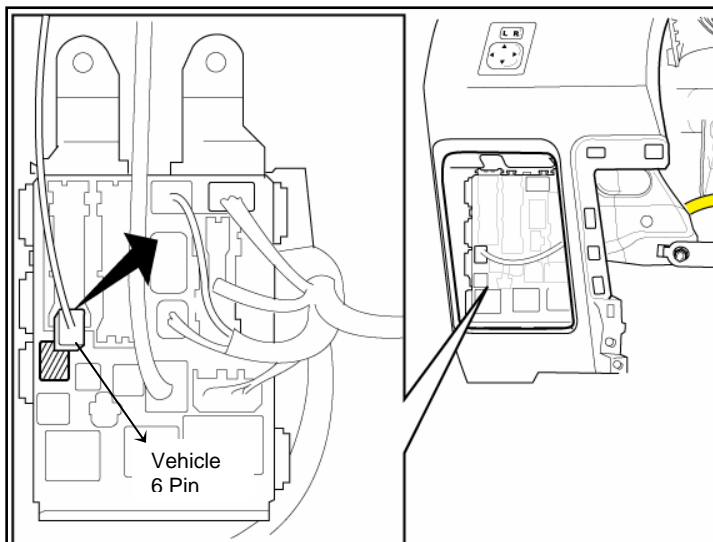

Fig.B-11

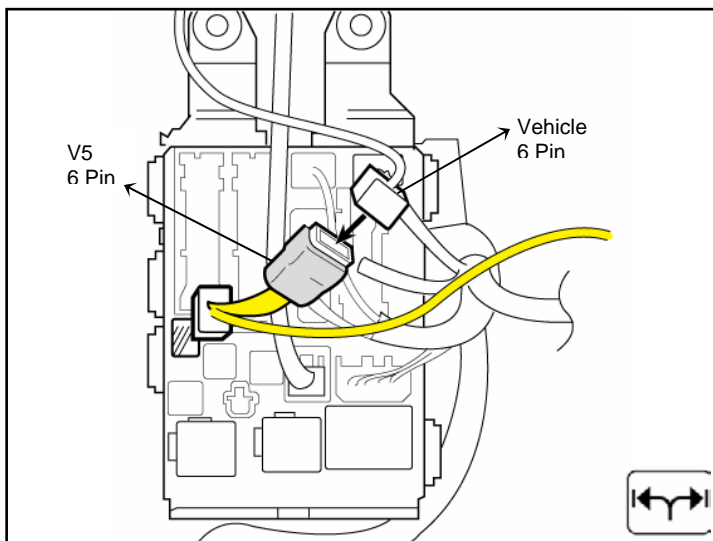

Fig.B-12

12. Insert V5 2 Pin Connector into V4 2Pin Connector.
13. Secure 4 Pin Connectors to the Vehicle harness with 1 Wire Tie.

**V5 only**

-If vehicle is equipped with V4 Harness already, skip to step 19

14. Unplug the vehicle 6 Pin connector on the Junction box.
15. Proceed with "Wire to Wire". Insert V5 6 Pin Connectors in between vehicle 6 Pin connectors.

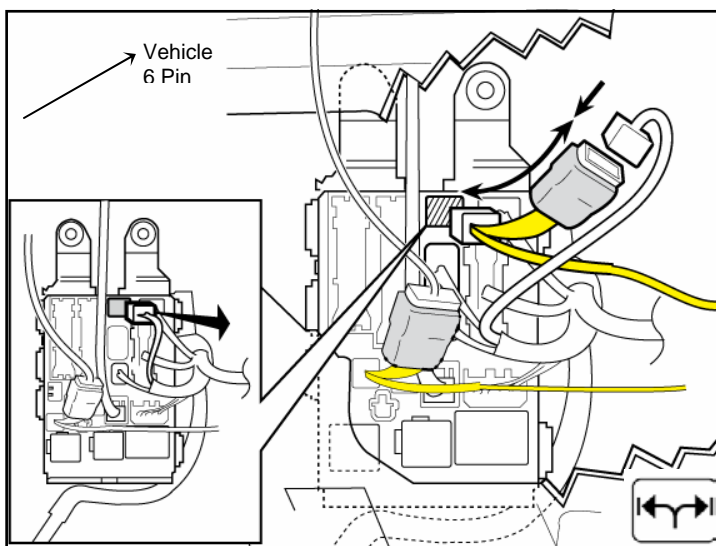

Fig.B-13

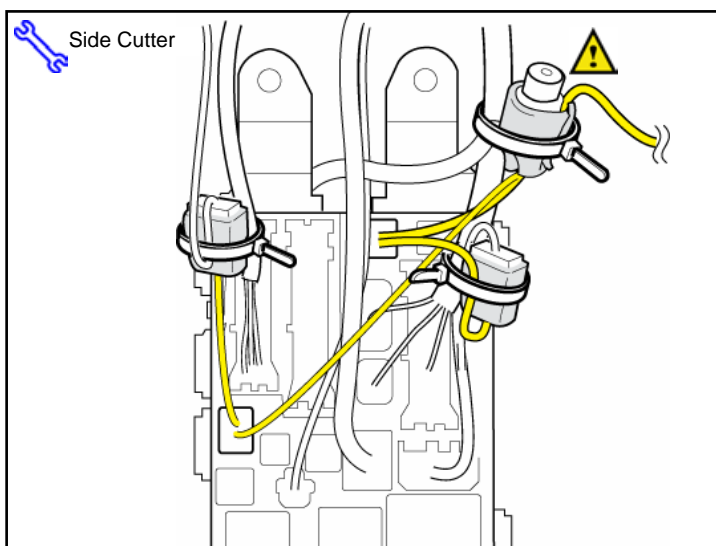

Fig.B-14

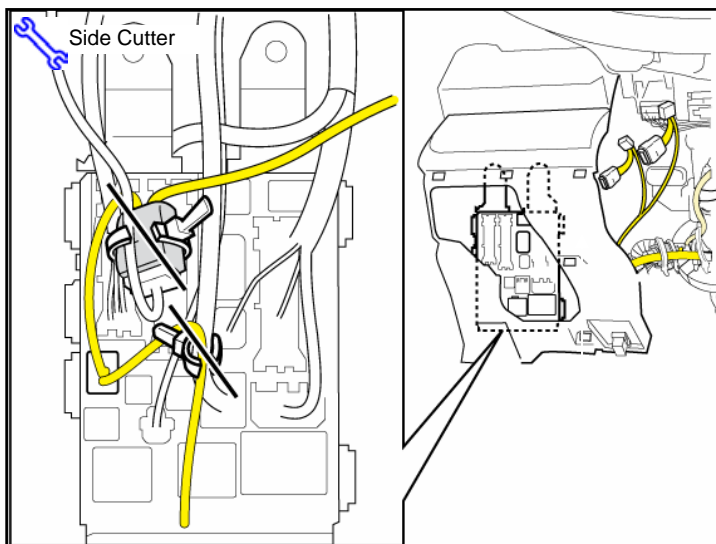

Fig.B-15

16. Unplug the vehicle 14 Pin connector on the Junction box.

17. Proceed with "Wire to Wire". Insert V5 14 Pin Connectors in between vehicle 14 Pin connectors.

18. Secure the 6 Pin and 14 Pin Connectors with 2 Wire Ties.

19. Secure the Relay with 1 Wire Tie.



Ensure that the Relay does not contact any metal surface.

Move onto step 27.

### V5 onto V4

#### -Add On installation

20. Clip the Wire Ties holding bundled up V4 6 Pin Connector.

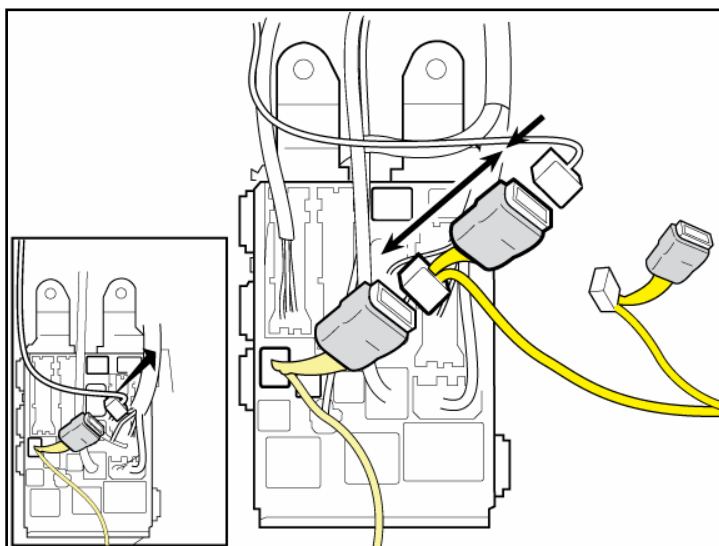

Fig.B-16

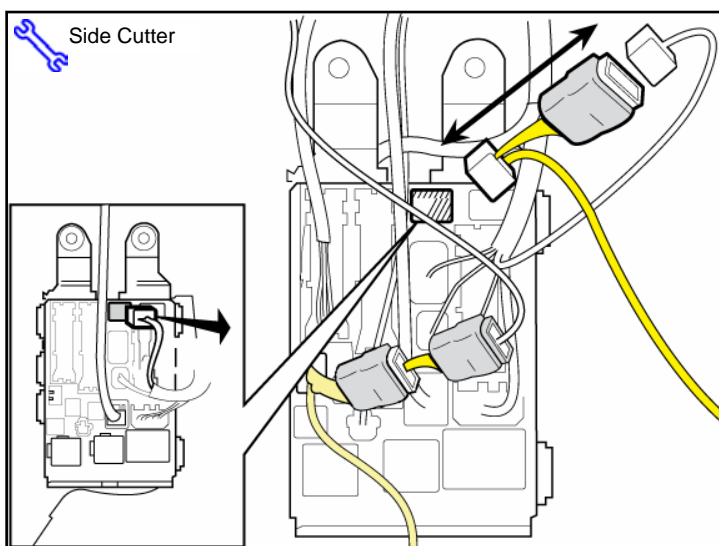

Fig.B-17

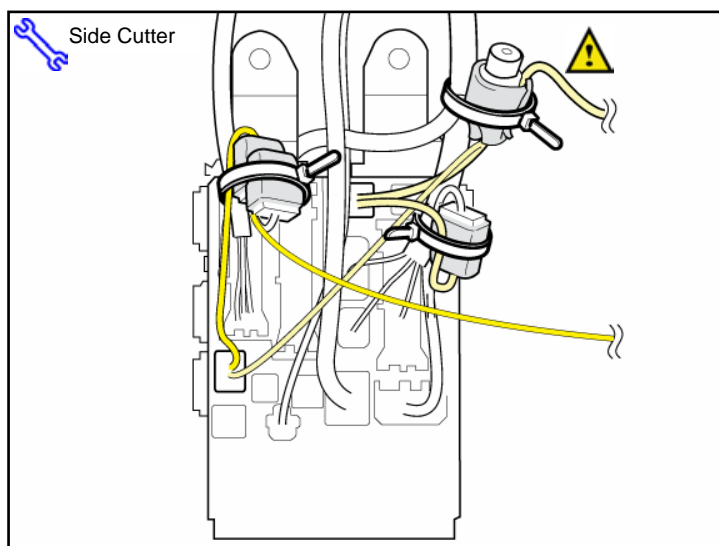

Fig.B-18

21. Unplug the vehicle 6 Pin connector from V4 6 Pin Connector.

22. Proceed with "Wire to Wire" by inserting V5 6 Pin Connectors in between V4 6 Pin Connector and vehicle 6 Pin connector.

23. Unplug the vehicle 14 Pin connector from the junction box.

24. Proceed with "Wire to Wire" by inserting V5 14 Pin Connectors in between the vehicle 14 Pin connectors.

25. Secure the 6 Pin and 14 Pin with 2 Wire Ties.

26. Secure the V5 Relay onto vehicle harness with 1 Wire Tie.



Ensure that the Relay does not contact any metal surface

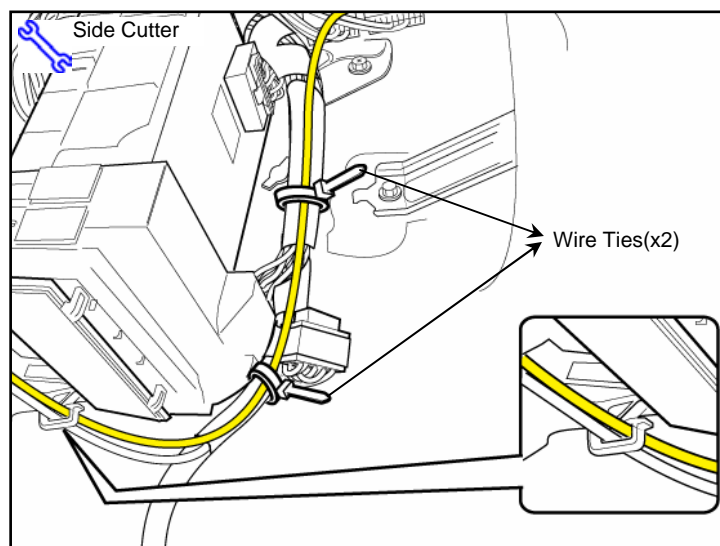

Fig.B-19

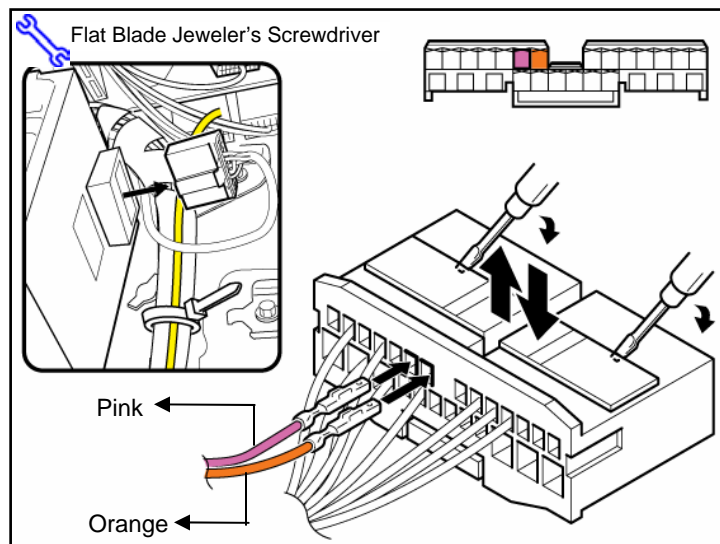

Fig.B-20

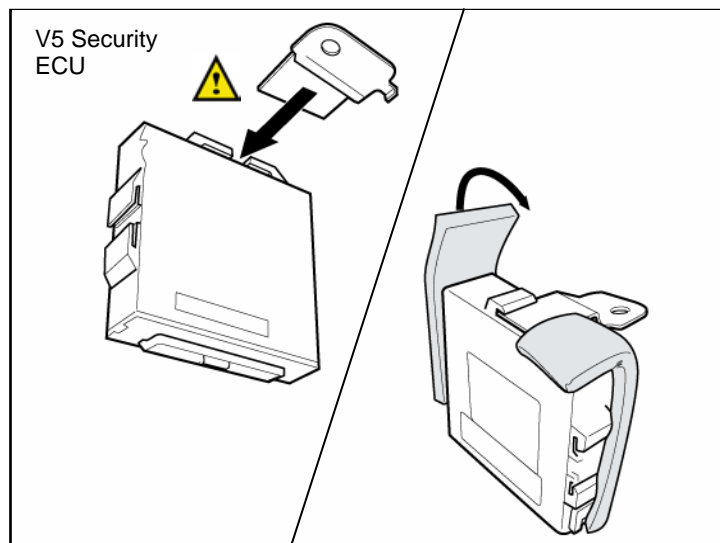

Fig.C-1

27. Route the V4 Harness through the Junction box clip.
28. Secure the V4 Harness to vehicle harness with 2 Wire Ties.

29. Unplug the 26 Pin Connector on the back of Junction box.
30. Lift up the Terminal retainer on the 26 Pin Connector, using Jeweler's screwdriver.
31. Insert the Orange and Pink wire Terminals into the indicated slots of 26 Pin connector, and close the retainer.
32. Plug the vehicle 26 Pin connector back into Junction box.

### C. TVIP ECU Preparation

1. Insert Mounting Bracket into indicated slot of V5 Security ECU.



Make sure correct slot is selected. Bracket attachment is permanent once installed.

2. Apply 2 small Foam Tapes on V5 Security ECU.

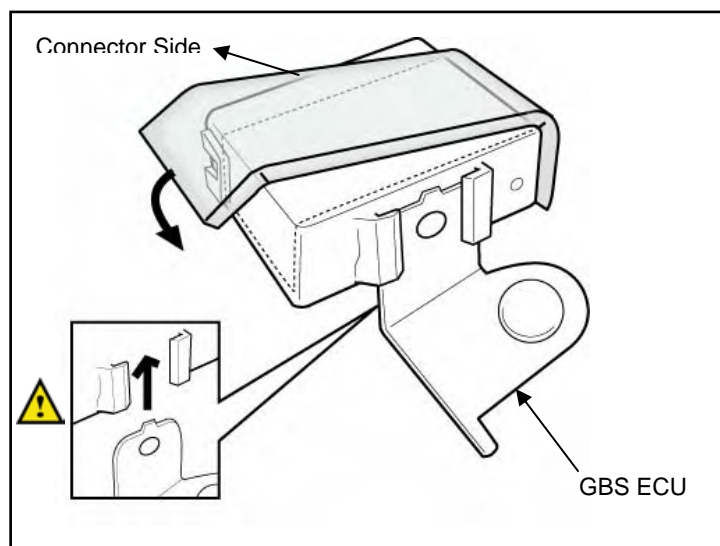

Fig.C-2

3. Insert Mounting Bracket into indicated slot of GBS ECU.



Make sure correct slot is selected. Bracket attachment is permanent once installed.

4. Apply 1 small Foam Tapes.

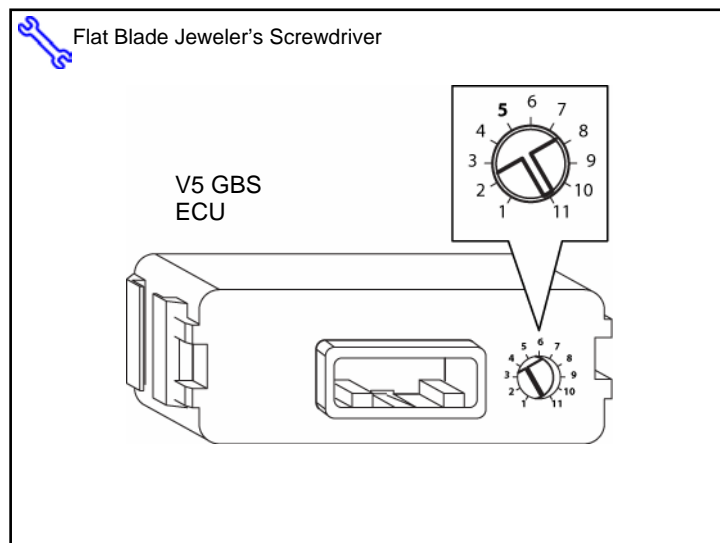

Fig.C-3

5. Set the GBS ECU's sensitivity to 5.

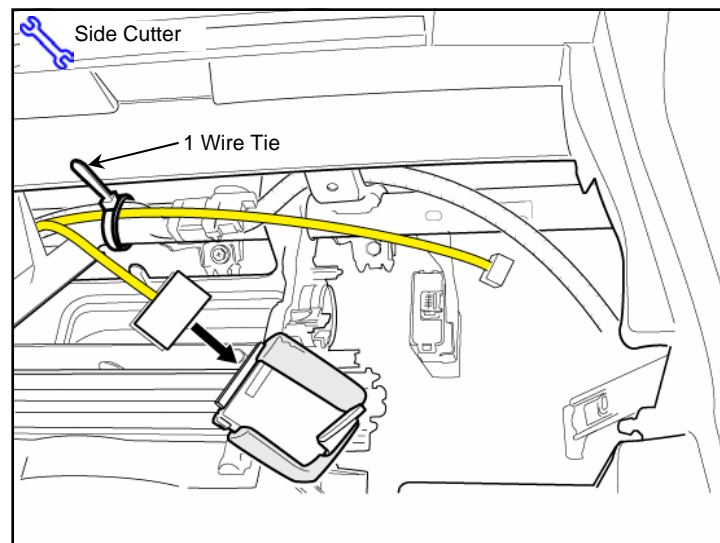

Fig.D-1

## D. Wire Harness Installation (Passenger's side)

1. Secure V5 Harness to the reinforcement with 1 Wire Tie.
2. Insert V5 36 Pin Connector into V5 Security ECU.

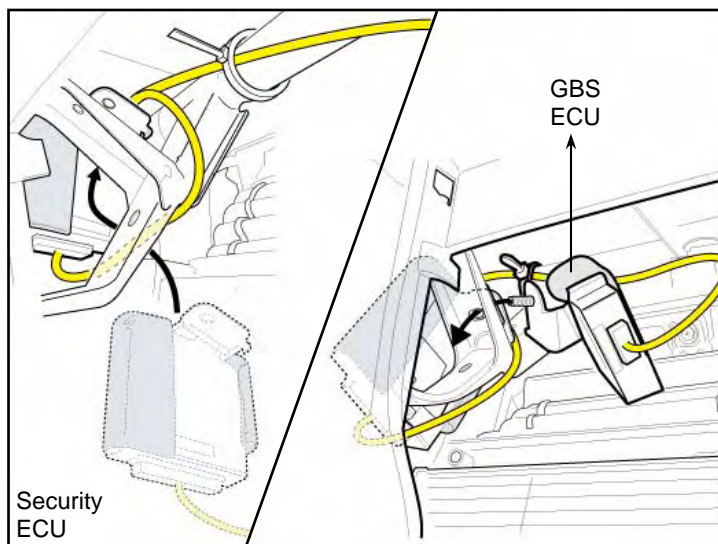

Fig.D-2

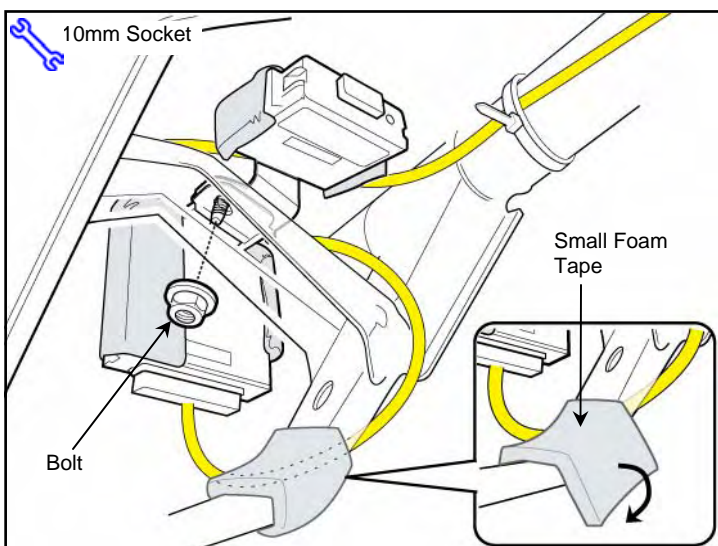

Fig.D-3

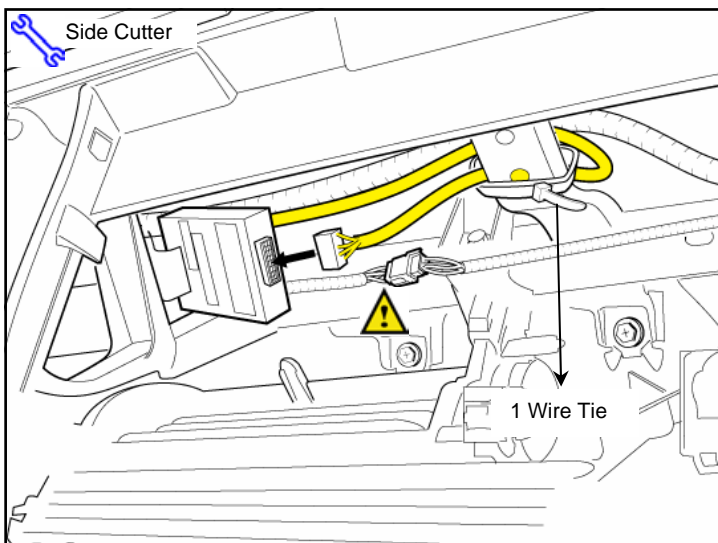

Fig.D-4

3. Maneuver and place V5 Security ECU behind the vehicle metal brace as shown.

4. Place GBS ECU on of vehicle metal brace in alignment with Security ECU Bracket.

5. Mount the 2 aligned ECUs at once onto the metal vehicle brace with 1 Bolt.

6. Apply 1 small Foam Tape on the vehicle metal brace as shown.

7. Secure V5 Harness to the brace with 1 Wire Tie.

**⚠** Air Bag Connector is near above the Harness. Use Caution when pulling the Wire Ties.

8. Insert V5 8 Pin Connector into the GBS ECU.

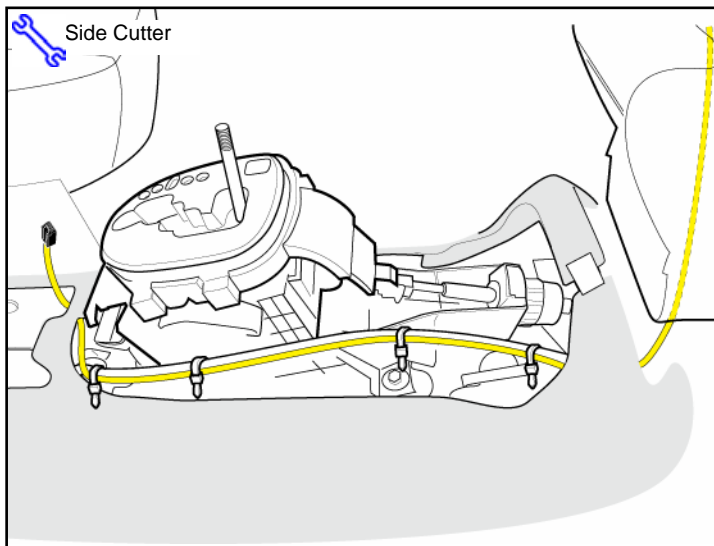

Fig.E-1

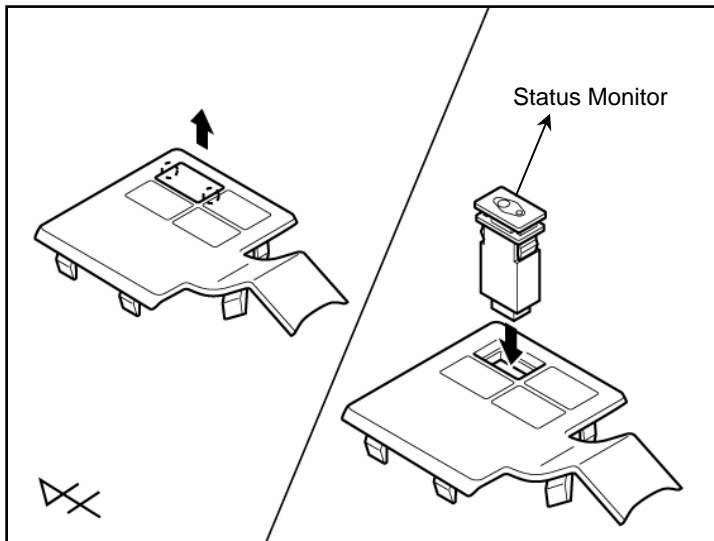

Fig.E-2

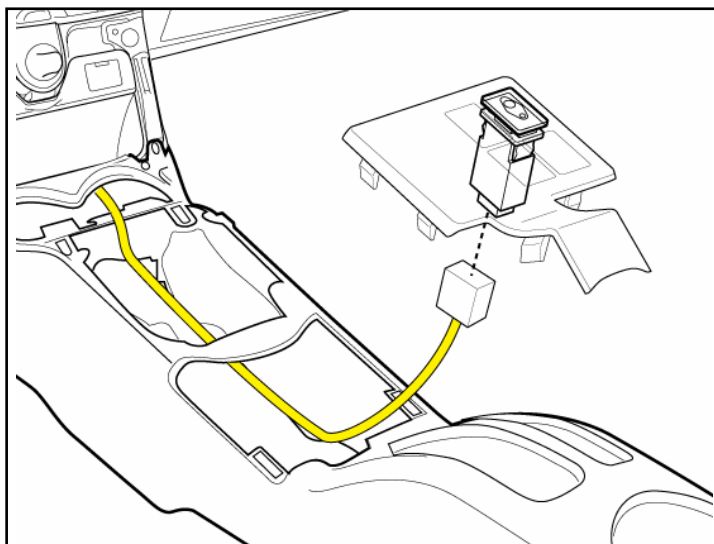

Fig.E-3

## E. Status Monitor Installation

1. Route the V5 Harness down to center console area as shown.
2. Secure V5 Harness onto vehicle harness with 4 Wire Ties.
3. Remove the knockout cover.
4. Insert V5 Status Monitor in place.
5. Insert 8 Pin Connector (black) into the Status Monitor.

Rest the Floor console on top of center console temporarily.

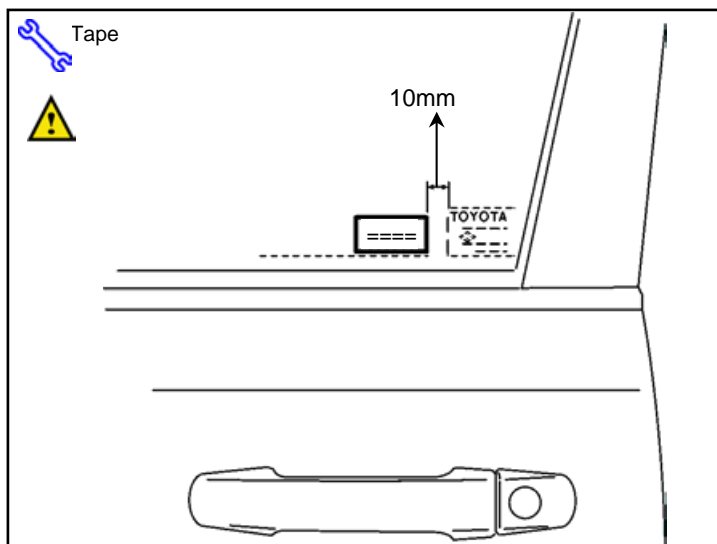

Fig.F-1

## F. Attaching the Labels

1. Using Household Windex, clean the inside of the both front door windows.
2. Use a piece of Clear Tape to lift the label off its protective backing.
3. Attach the Warning Labels on the inside of front door windows as shown.



Line up Labels properly.

Do not attempt to reposition the Labels once they are placed.

Align it 10mm from the last label, if one exists.

## G. Completion of Installation

1. Verify the Dome Fuse is installed.
2. Reassemble the vehicle.



Verify that panels fit together properly, with no uneven gaps.

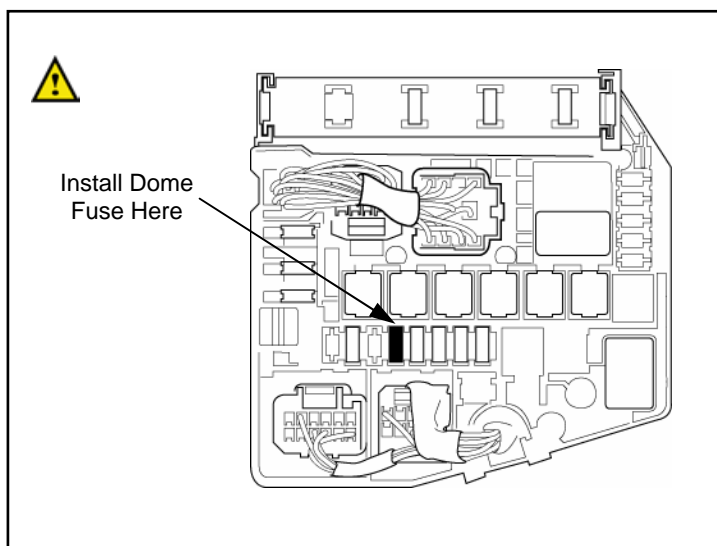

Fig.G-1

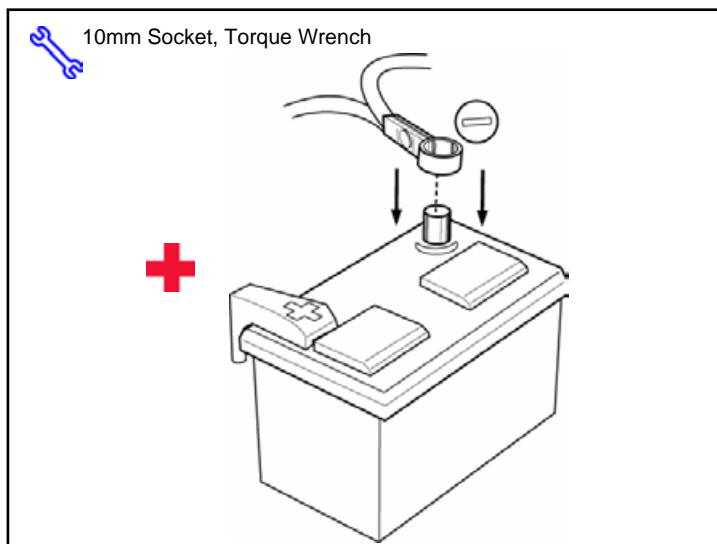

Fig.G-2

3. Position the Negative Battery Cable at the original factory position.
4. Tighten the Nut to 36 in•lbf. (4.07 N•m)



**DO NOT TOUCH THE POSITIVE BATTERY TERMINAL.**

5. Clean up and remove trash.
6. Place the owner's manual, sealed in its protective bag, in the glove box.

## Accessory Function Checks

	Procedure	Look for:
1	Press and release the remote control lock button to start the system's arming process.	The turn signal lights flash once. All doors lock. The security LED lights up.
2	Wait 30 seconds.	Security LED starts flashing; the system is now armed.
3	Press and release the remote control's unlock button to disarm the system.	The turn signal lights flash twice. The driver's door unlocks. The Security LED stops flashing.

**Open the driver's door, insert the key into the ignition switch and turn it to "ON". Roll down all the windows, remove the key and exit the vehicle.**

4	Arm and disarm the system with the remote again, then wait 30 seconds.	The doors automatically relock. The system automatically starts the arming process.
5	Press and release the remote control's unlock button again to stop the arming process.	Refer to step 3.
6	Insert the key into the driver's door key cylinder and turn it toward the front of the vehicle to start the arming process.	All doors lock. The Security LED lights up.
7	Wait 30 seconds.	Security LED starts flashing; the system is now armed.
8	Reach inside and manually unlock the driver's door to trigger an alarm.	The driver's door automatically relocks. The horn sounds repeatedly. The headlights flash repeatedly. The turn signal lights flash repeatedly. The Security LED lights up.
9	Manually unlock the driver's door again and hold it unlocked, open the door, then sit in the driver's seat.	The driver's door lock attempts to lock repeatedly. The horn continues to sound repeatedly. The headlights and turn signal lights continue flashing. The Security LED remains on.

10	Insert the key into the ignition switch and turn it to "START" to stop the alarm.	<p>The horn stops sounding.</p> <p>All the lights stop flashing and/or turn off.</p> <p>The Security LED turns off.</p> <p>The starter cranks and the engine starts.</p>
----	---	--

**Turn the key back to "LOCK", remove it, and then exit the vehicle.**

11	With the door open, press the lock switch on the door to lock the doors, then close the door to start the system's arming process.	<p>All doors lock.</p> <p>The Security LED lights up.</p>
12	Wait 30 seconds.	SECURITY LED starts flashing; the system is now armed.
13	Reach inside and manually unlock the front passenger's door to trigger an alarm.	<p>The front passenger's door automatically relocks.</p> <p>The horn sounds repeatedly.</p> <p>The headlights flash repeatedly.</p> <p>The turn signal lights flash repeatedly.</p> <p>The SECURITY LED lights up.</p>
14	Press and release the remote control's unlock button to stop the alarm.	<p>The horn stops sounding.</p> <p>All the lights stop flashing.</p> <p>The LED turns off.</p>
15	Press and release the remote control's lock button to start the system's arming process, then wait 30 seconds until the system is armed.	Refer to steps 1 and 2.
16	Unlock and open one of the rear passenger doors to trigger an alarm. (if available).	Refer to step 13.
17	Press and release the remote control's unlock button to stop the alarm.	Refer to Step 14
18	Repeat the above steps with the other rear passenger door. (if available).	Refer to steps 1, 2, and 13.

**Roll up all windows, remove the key and exit the vehicle.**

20	Press and release the remote control's lock button to start the arming process.	Refer to step 1.
21	Wait 30 seconds.	After 30 seconds, the LED starts flashing; the system is now armed.

**Perform the following check in a temperature-controlled environment.  
(50°-90° F)**

22	With the tip of a key, or Striker Tool pulled all the way out (PPO only), tap the center of the driver's door window to trigger the alarm.	The horn sounds repeatedly. The headlights flash repeatedly. The turn signal lights flash repeatedly. The LED lights up.
23	Press the unlock button on the Remote to stop the Alarm.	

**NOTE:** If the alarm does not trigger during functional verifications, increase the GBS sensitivity to the next setting.

**NOTE:** If you do not disarm the system, the alarm will last 20 seconds. It is not necessary to check the alarm duration.

**Vehicle Function Check**

	Function		Function
<input type="checkbox"/>	Head Light	<input type="checkbox"/>	ABS Light (if equipped) <i>If the warning light remains on, it may indicate a system malfunction.</i>
<input type="checkbox"/>	High Beams	<input type="checkbox"/>	Rear Wiper/Washer (if equipped)
<input type="checkbox"/>	Turn Signal Lights	<input type="checkbox"/>	Clock (if equipped)
<input type="checkbox"/>	Tail Lights	<input type="checkbox"/>	Accessory Power Socket (if equipped)
<input type="checkbox"/>	Stop Lights	<input type="checkbox"/>	Starter
<input type="checkbox"/>	Backup Lights	<input type="checkbox"/>	Audio/Video (if equipped)
<input type="checkbox"/>	Hazard Lights	<input type="checkbox"/>	Power Sliding Door (if equipped)
<input type="checkbox"/>	Marker Lights	<input type="checkbox"/>	Convenience Memory Settings (if equipped)
<input type="checkbox"/>	Dome/Courtesy Lights	<input type="checkbox"/>	Heated Seats (if equipped)
<input type="checkbox"/>	Panel/Switch Illumination	<input type="checkbox"/>	Massage Seats (if equipped)
<input type="checkbox"/>	Accessory Controls/Illumination (if equipped)	<input type="checkbox"/>	Rear Window Defogger (if equipped)
<input type="checkbox"/>	Key Sensor Buzzer	<input type="checkbox"/>	Power Side Mirrors (if equipped)
<input type="checkbox"/>	Fog Lights (if equipped)	<input type="checkbox"/>	Side Mirror Defogger (if equipped)
<input type="checkbox"/>	Daytime Running Lights (if equipped)	<input type="checkbox"/>	Front Windshield Defogger (if equipped)
<input type="checkbox"/>	Trunk/Tailgate/Bed Lights (if equipped)	<input type="checkbox"/>	Navigation System (if equipped)
<input type="checkbox"/>	Glove Box Light (if equipped) I	<input type="checkbox"/>	Rear Sunshade (if equipped)
<input type="checkbox"/>	Cruise Control Light (if equipped)	<input type="checkbox"/>	Steering Wheel Audio Control (if equipped)
<input type="checkbox"/>	Seat Belt Warning Light <i>If the warning light remains on, it may indicate a system malfunction.</i>	<input type="checkbox"/>	Steering Wheel Column Adjusts Without Interference
<input type="checkbox"/>	Air Bag Warning Light <i>If the warning light remains on, it may indicate a system malfunction.</i>	<input type="checkbox"/>	Lamp Failure Sensor <i>If the warning light remains on, it may indicate a system malfunction.</i>

	Function		Function
<input type="checkbox"/>	Track/Skid Control Light (if equipped) <i>If the warning light remains on, it may indicate a system malfunction.</i>	<input type="checkbox"/>	Front Wiper/Washer
<input type="checkbox"/>	HVAC	<input type="checkbox"/>	Hood Latch Release
<input type="checkbox"/>	Power Locks (if equipped)	<input type="checkbox"/>	Passenger Air Bag Switch (if equipped)
<input type="checkbox"/>	Power Windows (if equipped)	<input type="checkbox"/>	Rollover Side Curtain Air Bag Switch (RSCA) (if equipped)
<input type="checkbox"/>	Power Seats (if equipped)	<input type="checkbox"/>	
<input type="checkbox"/>	Horn	<input type="checkbox"/>	
<input type="checkbox"/>	Gauges	<input type="checkbox"/>	

**Remove the short pin after Function Check.**  
 Check with your port/dealer to find out if this step is needed.

