

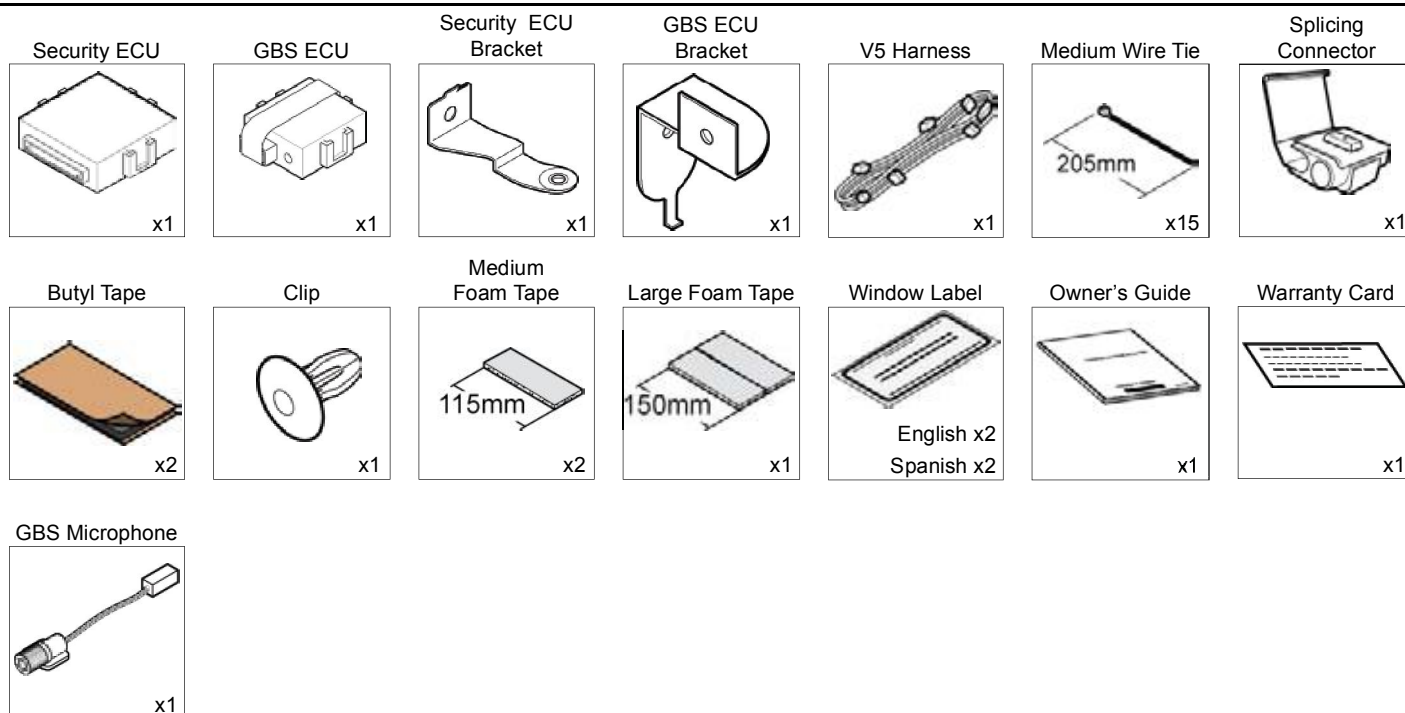
Part #: PT398-42093

NOTE: Part number of this accessory may not be the same as the part number shown.

Conflicts:

Do not install into Vehicles equipped with TDS.

Kit Contents:



Additional Items

(may be required)

Item#	Description

Recommended Sequence of Application

Item#	Description
1	TVIP V4 Remote Engine Starter
2	TVIP V5 RS3200 PLUS

Recommended Tools

Personal & Vehicle Protection	Description
Safety Glasses	
Safety Gloves	(Optional)
Vehicle Protection	Blankets, Parts Boxes
Special Tools	
GBS Striker Tool	CAD-E IADS P/N ALL 02-016-01
Installation Tools	
Screwdriver	#2 Phillips, Flat Blade Jeweler's
Nylon Panel Removal Tool	e.g. Panel Pry Tool #1 Toyota SST# 00002-06001-01
Side Cutter	
Torque Wrench	36 in•lbf (4.07 N•m)
Utility Knife	
Tape	Clear, Electrical
Socket	10mm, extension
Pliers	Needle Nose, Pliers
Special Chemicals	
Cleaner	VDC Approved Cleaner
Glass Cleaner	Household Glass Cleaner

Table of Contents

I. Preparation	1–3
1. Table of Contents	2
2. Wire Routing Overview	3
II. Procedure	4–19
1. Disassembly	4
2. V5 Harness Installation (Driver's Side)	8
3. V5 Harness Installation (Driver's Side Junction Box Area)	11
4. V5 Harness Installation (Center Console Area)	12
5. V5 Security ECU and GBS ECU Preparation and Installation	14
6. V5 Harness Installation (Passenger's Side)	16
7. GBS Microphone Installation	18
8. Complete the Installation	19
III. Checklist	21–26
1. Accessory Function Checks	21
2. Vehicle Function Checks	25

Legend



Do not proceed until process has been completed.



Follow steps carefully to avoid damaging the Vehicle or Accessory



Use caution to avoid injury.



Used in Figures to call attention to specific tools recommended for the process.



Highlights a change in installation with respect to previous issue.



Indicates that torque is related to safety.



Video Available; click to play.

Accessory Installation Practice (read before installation)

Care must be taken when installing this accessory to ensure damage does not occur to the vehicle. The installation of this accessory should follow approved guidelines to ensure a quality installation.

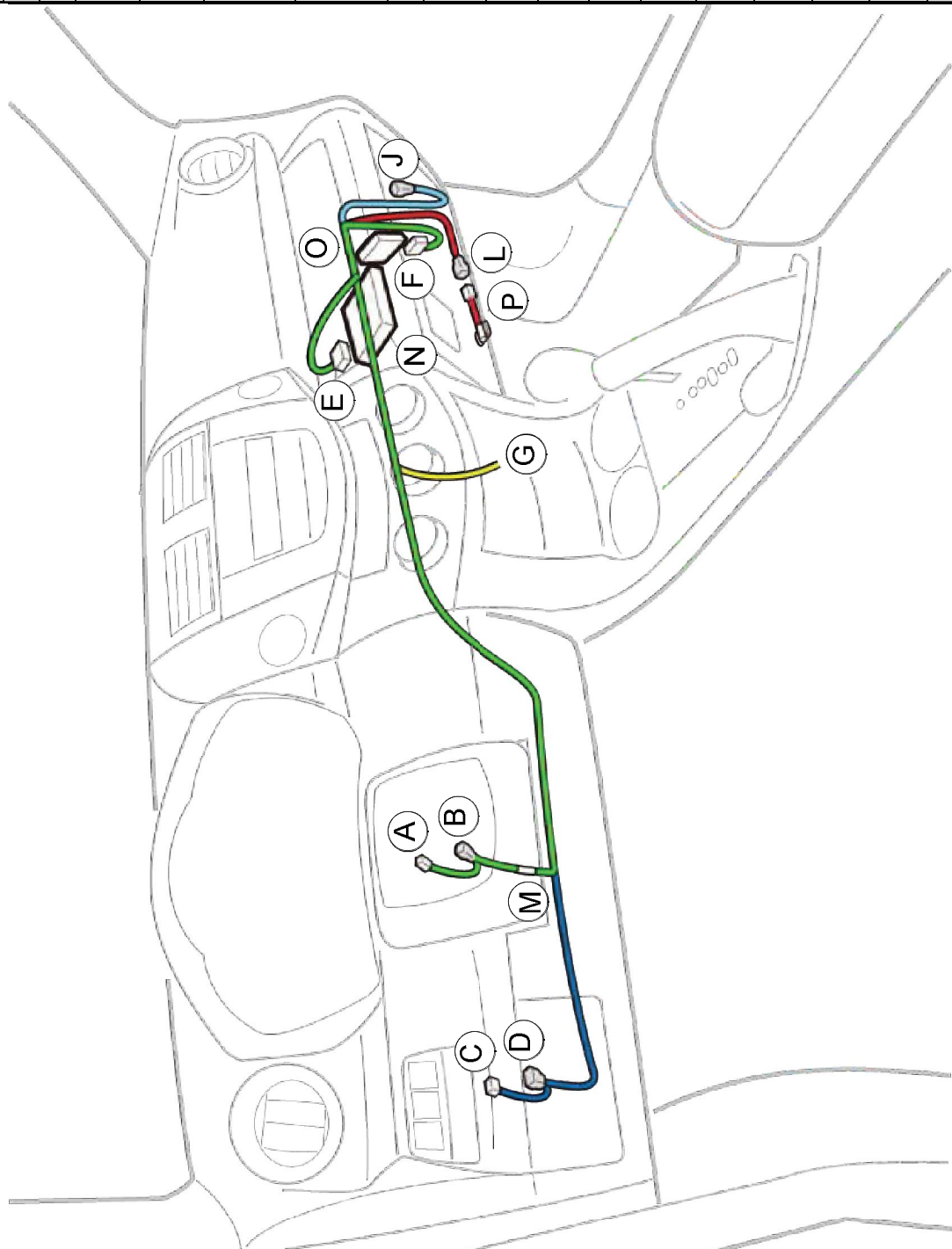
These guidelines can be found in the "Accessory Installation Practices" document.

This document covers such items as:

- Vehicle Protection (use of covers and blankets, cleaning chemicals, etc.)
- Safety (eye protection, checking torque procedure, etc.)
- Vehicle Disassembly/Reassembly (panel removal, part storage, etc.)
- Electrical Component Disassembly/Reassembly (battery disconnection, connector removal, etc.)

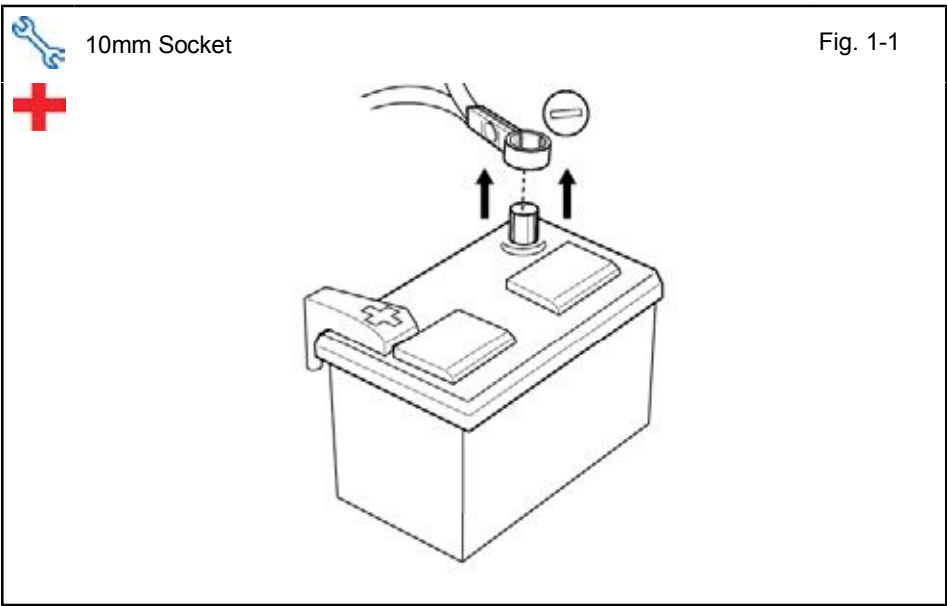
Please see your Toyota dealer for a copy of this document.

RAV4
Wire Harness Outline (Passenger's Compartment)*



TVIP	Vehicle	Description
A	E6	2P WHITE
B	E6	2P WHITE
C	IS	18P WHITE
D	IS	18P WHITE
E	—	36P WHITE for Security ECU
F	—	8P WHITE for GBS ECU
G	E22 or E90	YELLOW WIRE (for non-Smart)
G	E23 or E91	YELLOW WIRE (for Smart)
J	E58	2P WHITE
L	—	2P WHITE for Microphone
M	—	White Tape Marker
N	—	Security ECU
O	—	GBS ECU
P	—	Microphone

*Color of Harness on Overview corresponds with Colored Tape near Connectors on



1. Disassembly.

- a. For Manual Transmission Vehicles place the Vehicle in Park with the Parking Brake set.
- b. Disconnect the Negative Battery Terminal.
 - Protect the Fender.
 - Note the Battery Cable Position as it will be re-installed in the same position.

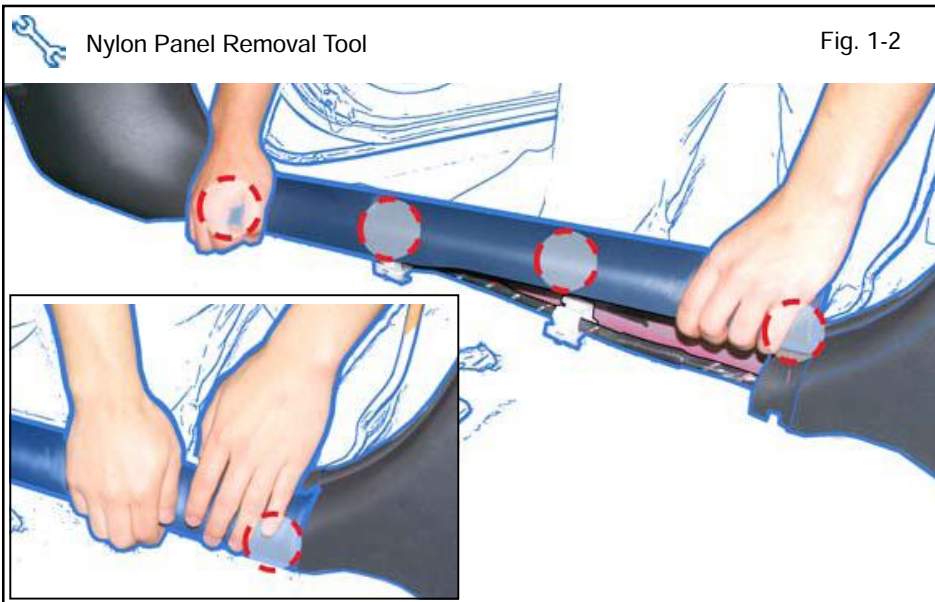
CAUTION: Do not touch the Positive Terminal.

Disassembly Overview

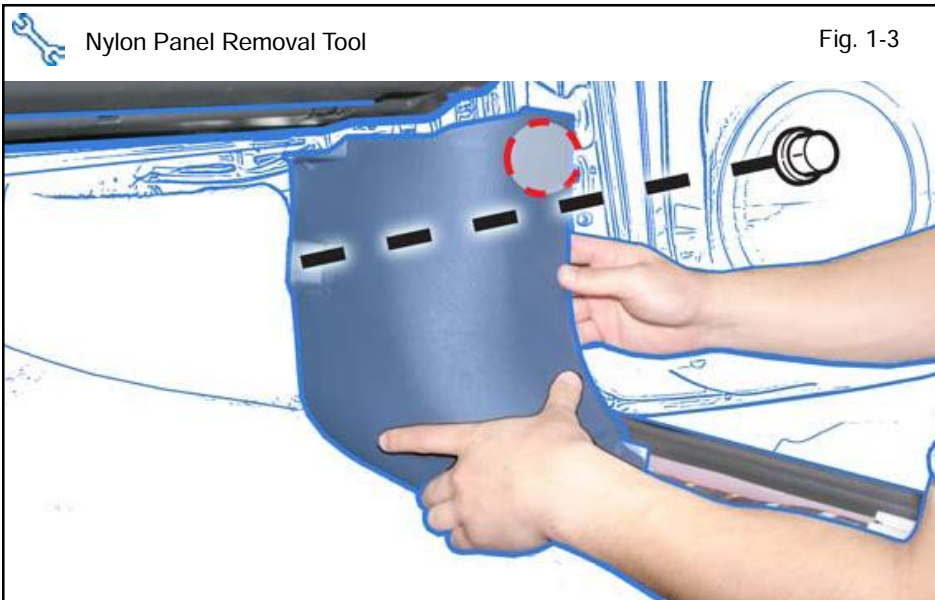
DRIVERS SIDE / CENTER CONSOLE

PASSENGERS SIDE

1	Glovebox Under Cover
2	PS Step Cover
3	PS Cowl Cover
4	Glovebox
5	DS Lower Dash Cover
6	DS Lower Dash Brace
7	Lower Steering Column Cover
8	Center Console Left Trim
9	Center Console Right Trim
10	Radio
Disconnect all Corresponding Connectors	



- c. Remove the Passenger's Step Cover.



- d. Remove the Passenger's Cowl Cover.
- Remove 1 Nut.



- e. Remove the Glove Box Under Cover.

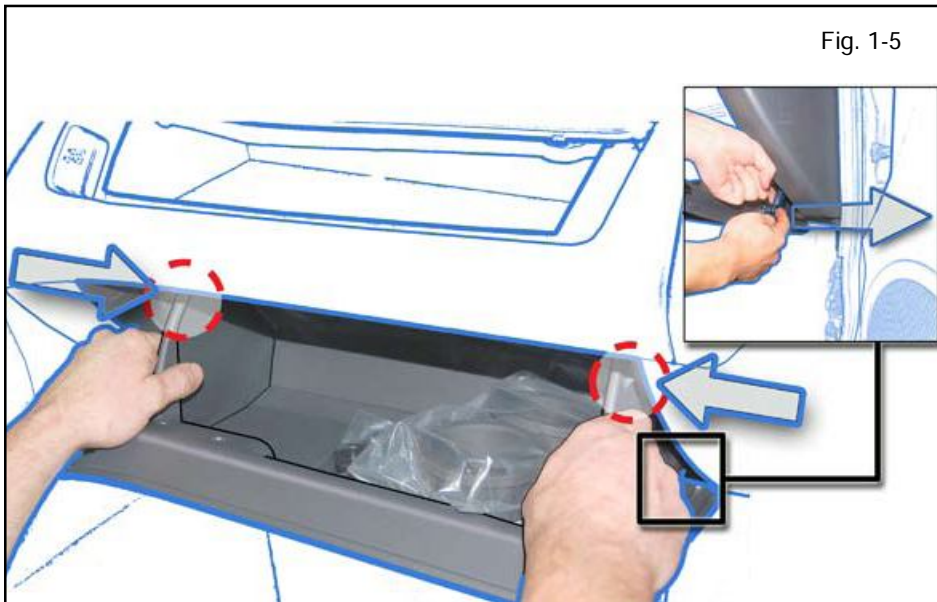


Fig. 1-5

- f. Dislodge the Glove Box.
- Disconnect the Dampener.



Fig. 1-6

- g. Remove the Glovebox.



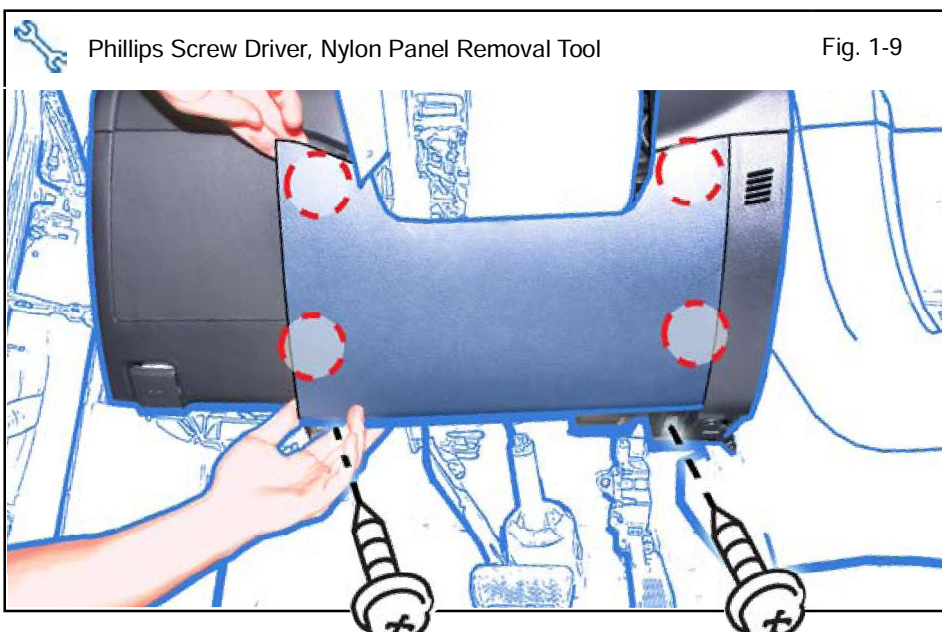
Nylon Panel Removal Tool

Fig. 1-7

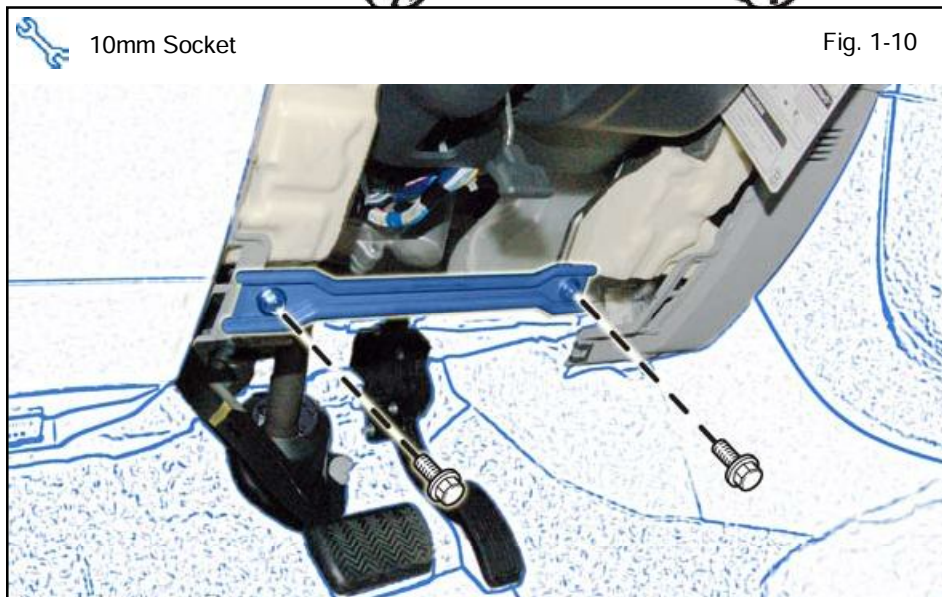
- h. Remove both Trim Panels from the Center Console.



- i. Remove 4 Bolts from the Radio.
- j. Remove the Radio Unit.



- k. Remove the Driver's Side Lower Dash.
 - Remove 2 Screws.



- l. Remove the Lower Dash Brace.
 - Remove 2 Bolts

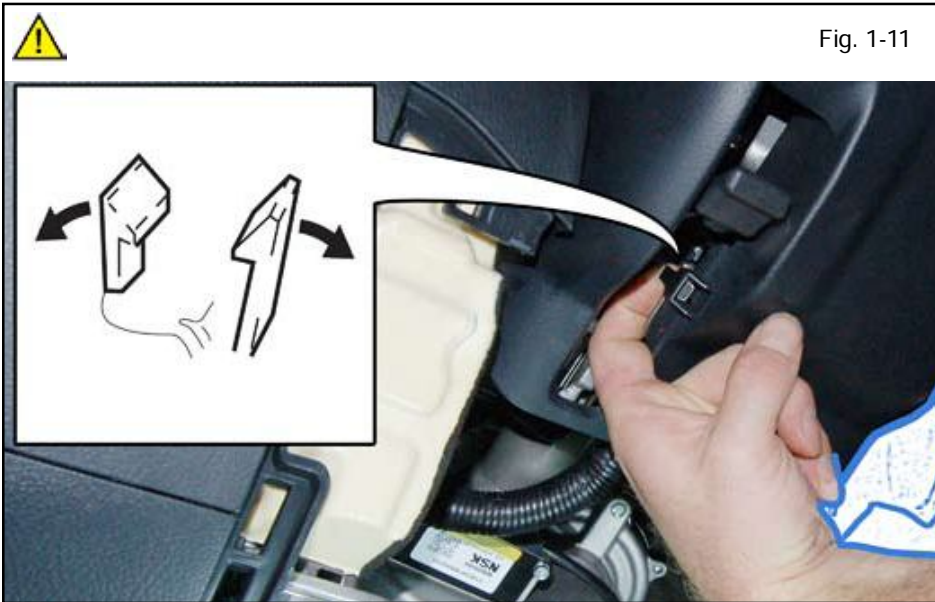


Fig. 1-11

Non-Smart Vehicles Only

- m. Dislodge the Center Clip.
- Insert fingers into the opening of the Tilt Lever of the Steering Column Under Cover to disengage 1 Claw.



CAUTION: Do not force this clip as it is very easy to break.



Fig. 1-12

- n. Dislodge the Back Clips on both sides.
- o. Release the Front Clips on both sides.
- Insert the Key into the Ignition and turn it to ON.
 - Turn the Steering wheel from Right to Left to access the Holes.
 - Use a Flat Blade Jeweler's Screwdriver wrapped with Electrical Tape to release the clips.
- p. Remove the Key from the Ignition.

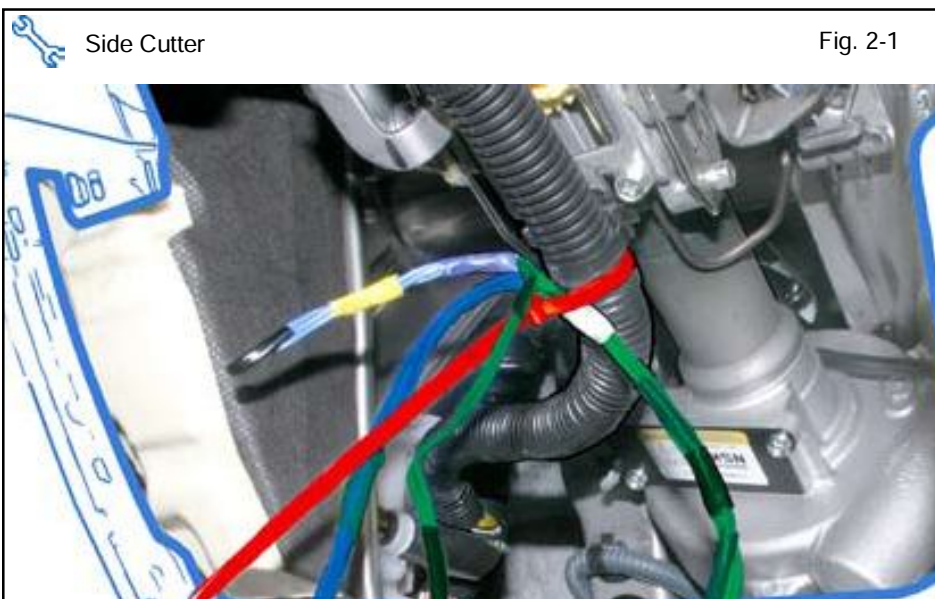


Fig. 2-1

2. V5 harness Installation.

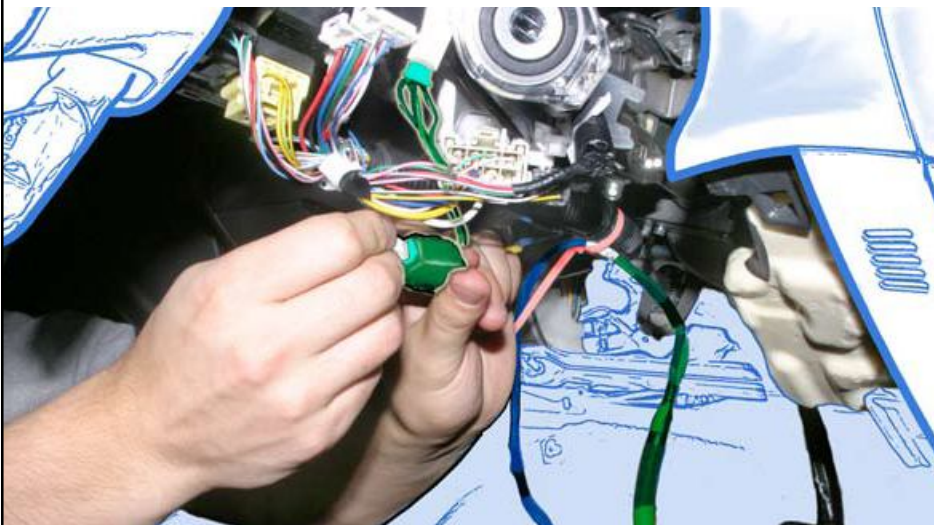
Non-Smart Vehicles Only

- a. Secure the V5 Harness's White Tape Marker to the Vehicle Harness near the Vehicle Harness Clamp with 1 Wire Tie.

Fig. 2-2



Fig. 2-3




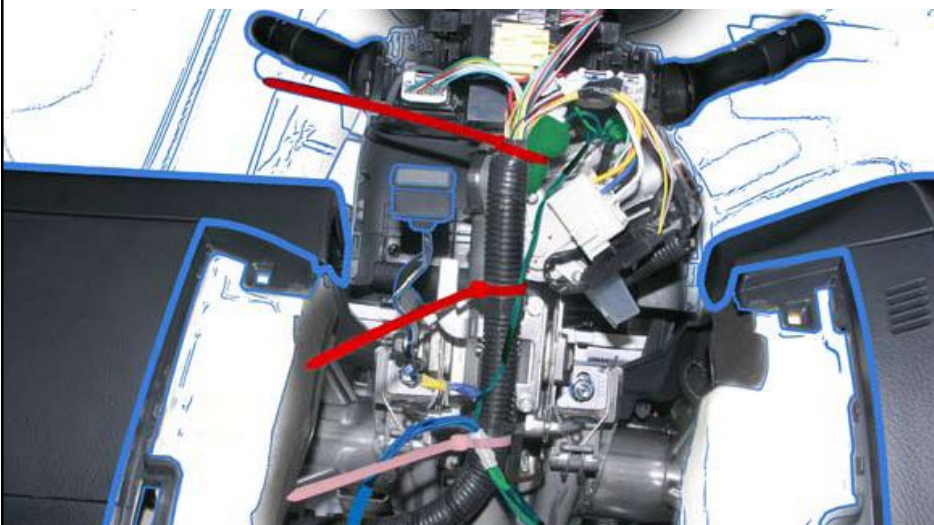
 Side Cutter

Fig. 2-4



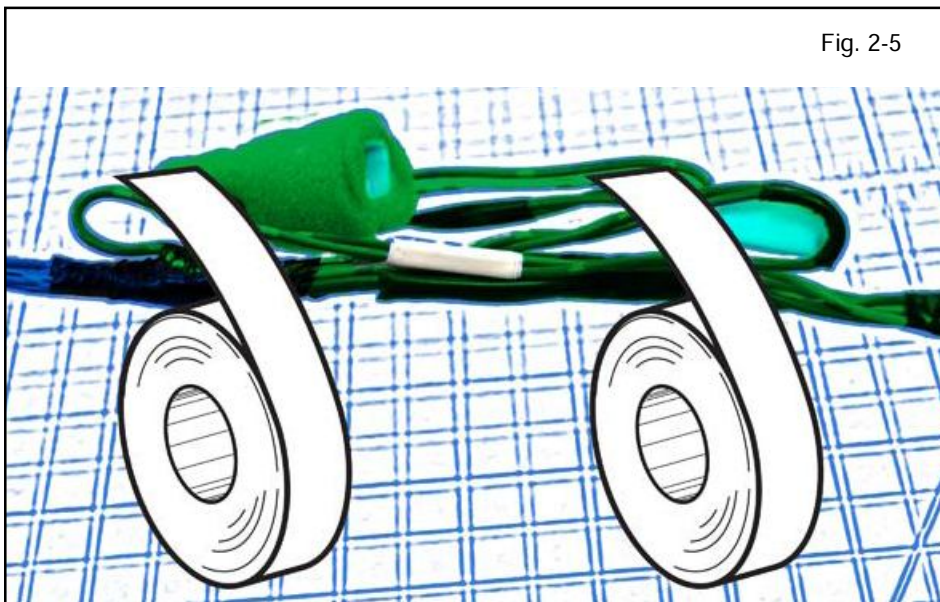
b. Disconnect the Vehicle's 2P Connector.

c. Connect the V5 2P Connectors in between the Vehicle's Connectors.

d. Secure the 2P Connectors to the Vehicle Harness with 1 Wire Tie.

e. Secure the V5 Harness to the Vehicle Harness with 1 Wire Tie.

Fig. 2-5



Smart Vehicles ONLY

- f. Locate the V5's 2P Connectors with the White Tape.
- g. Bundle up the wire and Connectors and secure with Electrical Tape.

- h. Secure V5 White Tape Marker to the Vehicle Harness with 1 Wire Tie.

Fig. 2-6

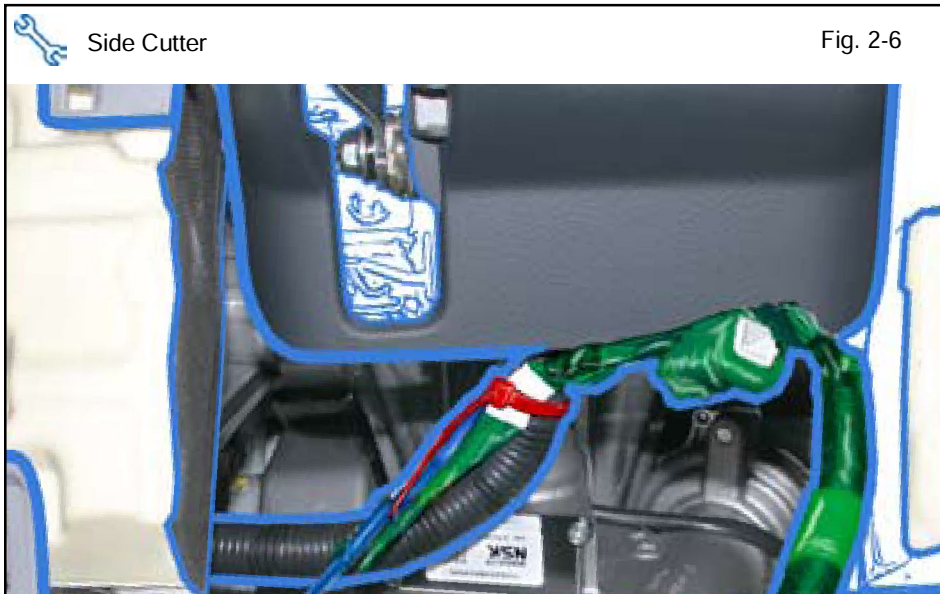
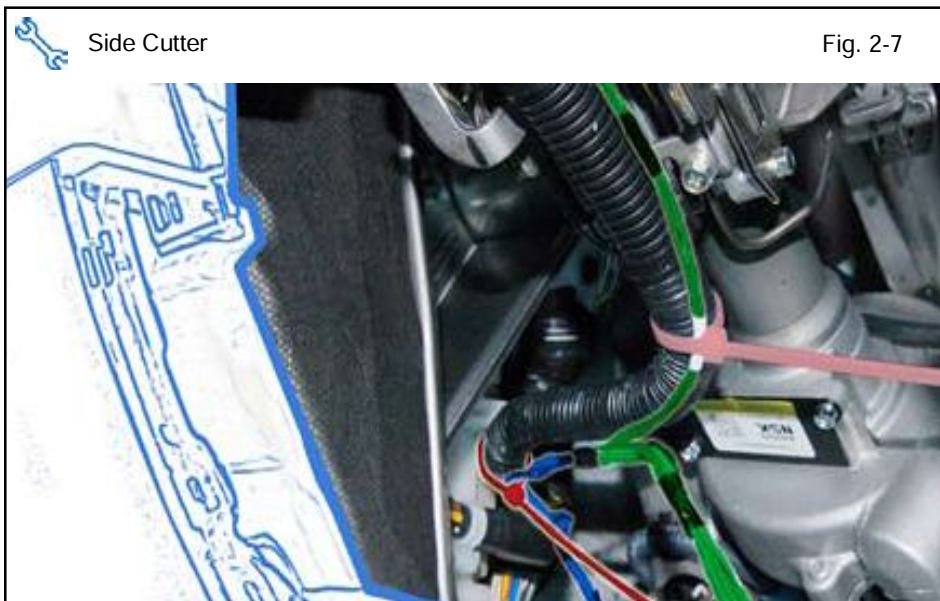
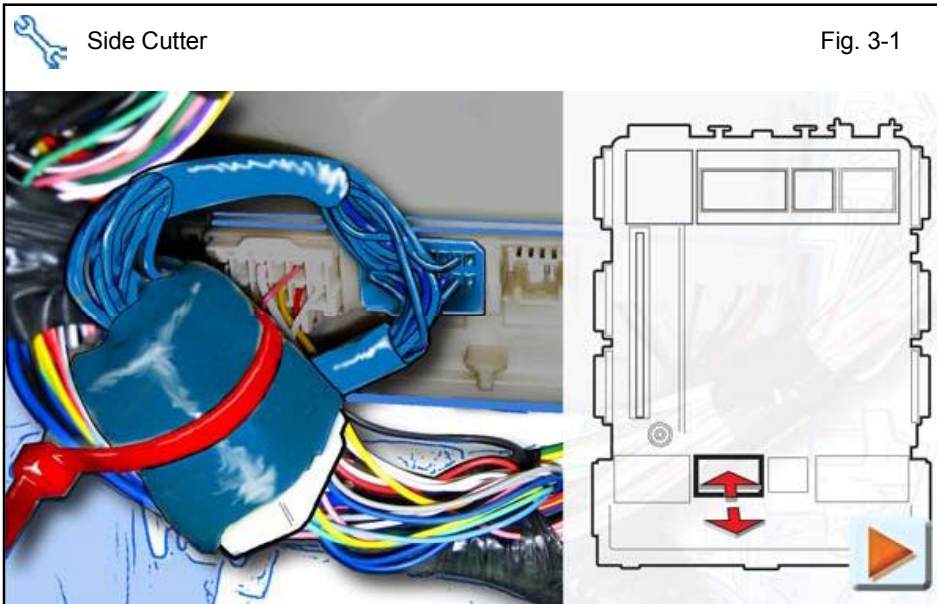


Fig. 2-7



- i. Route the V5's 18P Connectors toward the back of the Junction Box.
- j. Secure the V5 Harness to the Vehicle Harness with 1 Wire Tie.



3. V5 Harness Installation (Driver's Side Junction Box Area)

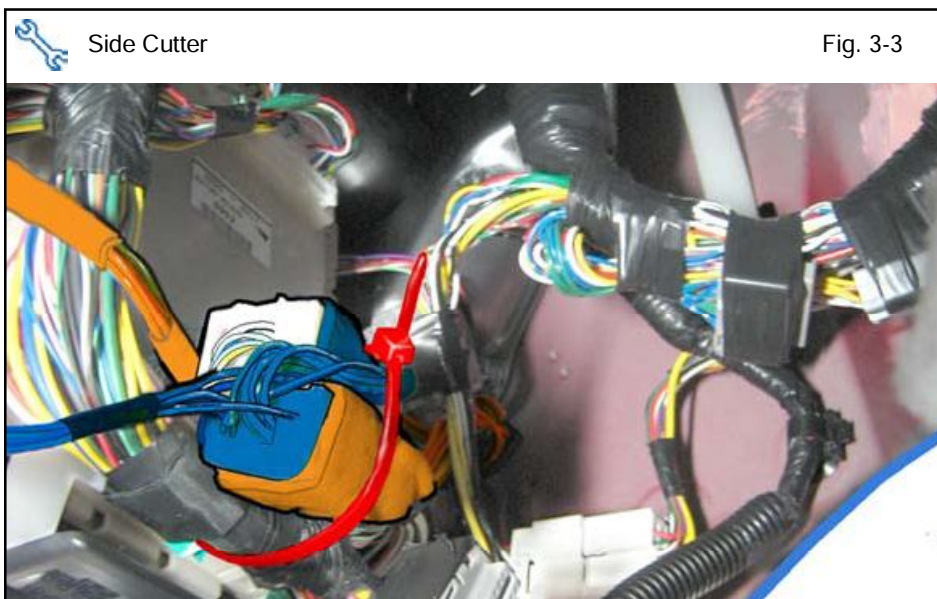
V5 ONLY

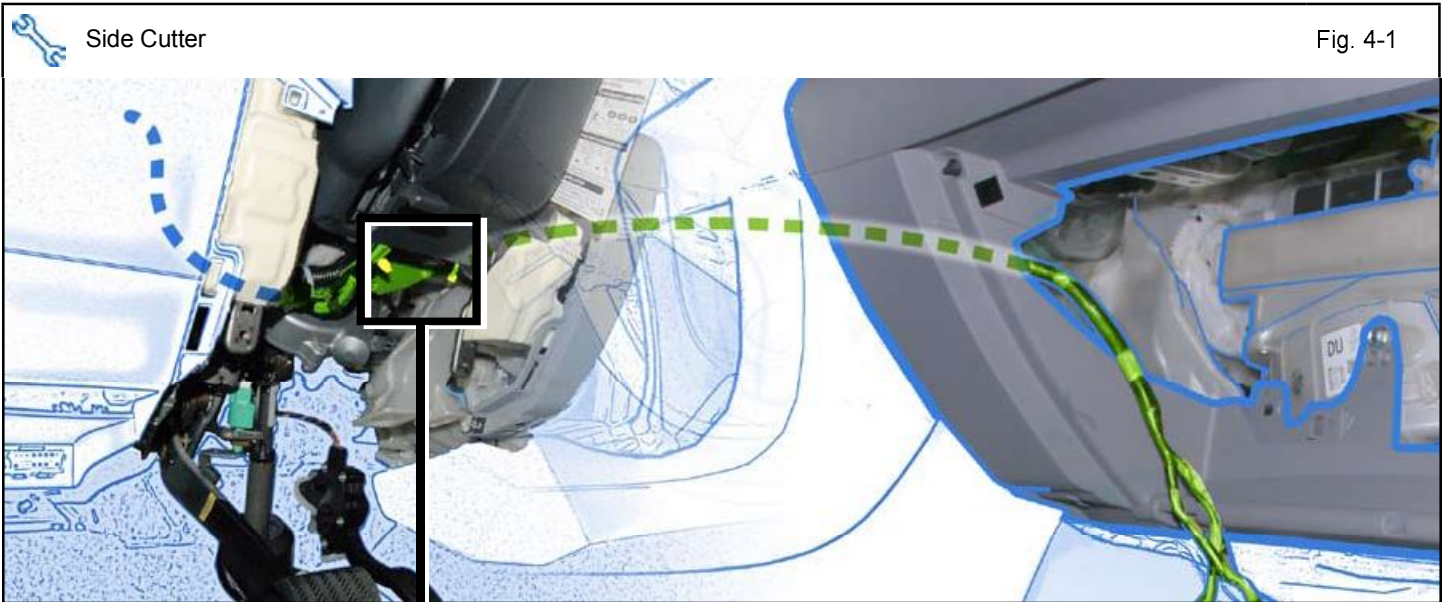
- Disconnect the Vehicle's 18P Connector from the backside of the Junction Box.
- Connect the V5 18P Connectors in between the Junction box and the Vehicle's 18P Connector.
- Secure the 18P Connectors and the V5 Harness to the Vehicle Harness with 1 Wire Tie.



V4/V5 ADD-ON ONLY

- Cut the Wire Tie securing the V4 18P Connectors.
- Disconnect the Vehicle's 18P Connector from the V4 18P Connector.
- Connect the V5 18P Connectors in between the V4 Harness and the Vehicle's 18P Connector.
- Bundle up both sets of connectors and secure them and the V4/V5 Harnesses to the Vehicle Harness with 1 Wire Tie.



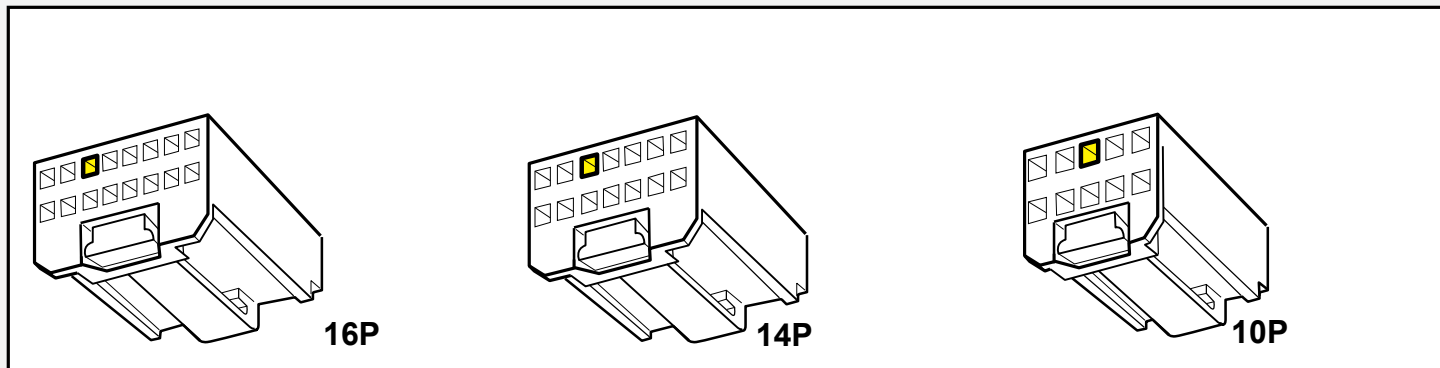


4. V5 Harness Installation (Center Console Area)

- Route the V5 Harness from the Driver's Side to the Passenger's Side.
- Secure the V5 Harness to the Vehicle Brace with 1 Wire Tie.

NOTE:

There is a difference between the connectors on different Vehicles depending on country of origin and manufacturing dates.



NOTE: the Splicing location highlighted in Yellow is the same on all three Connector variations.

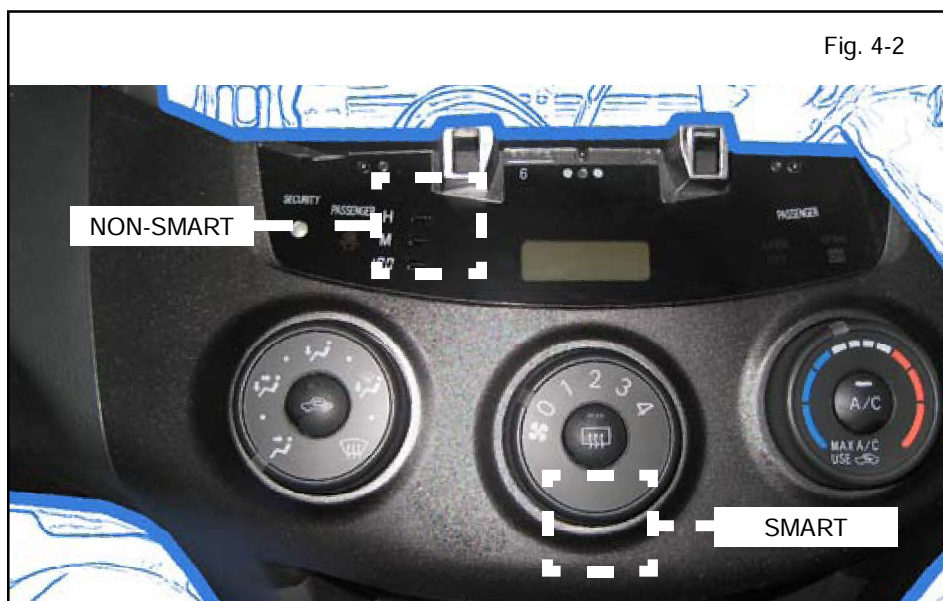
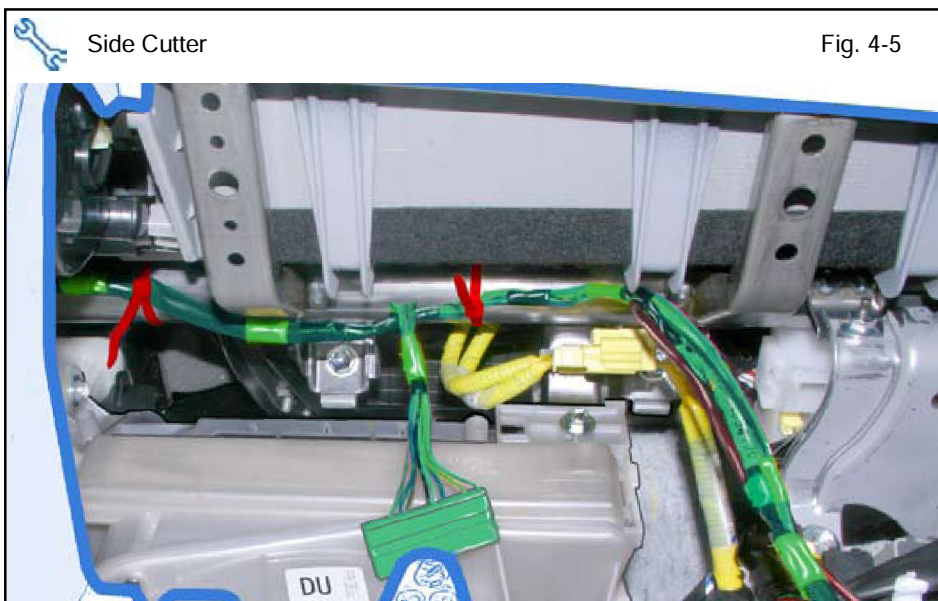
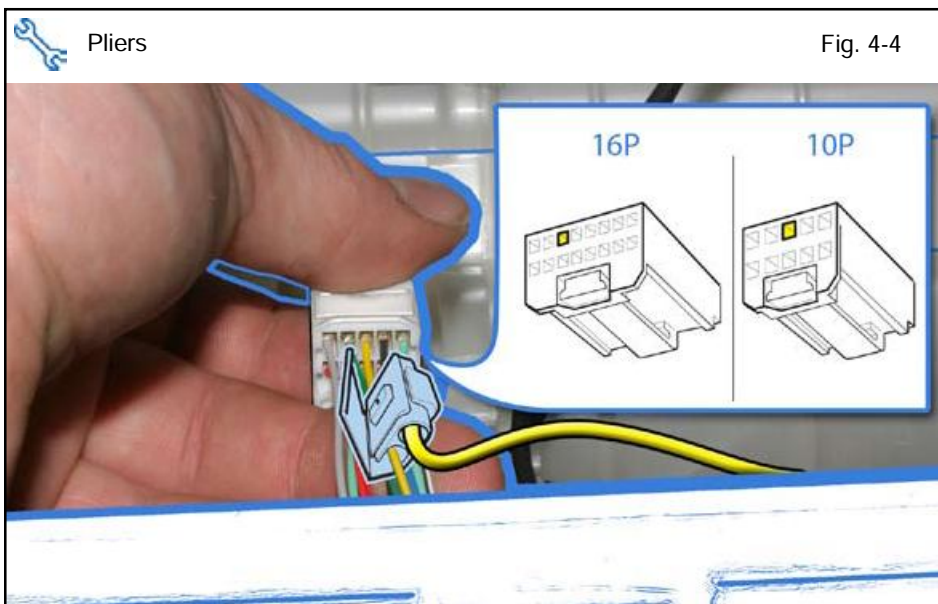
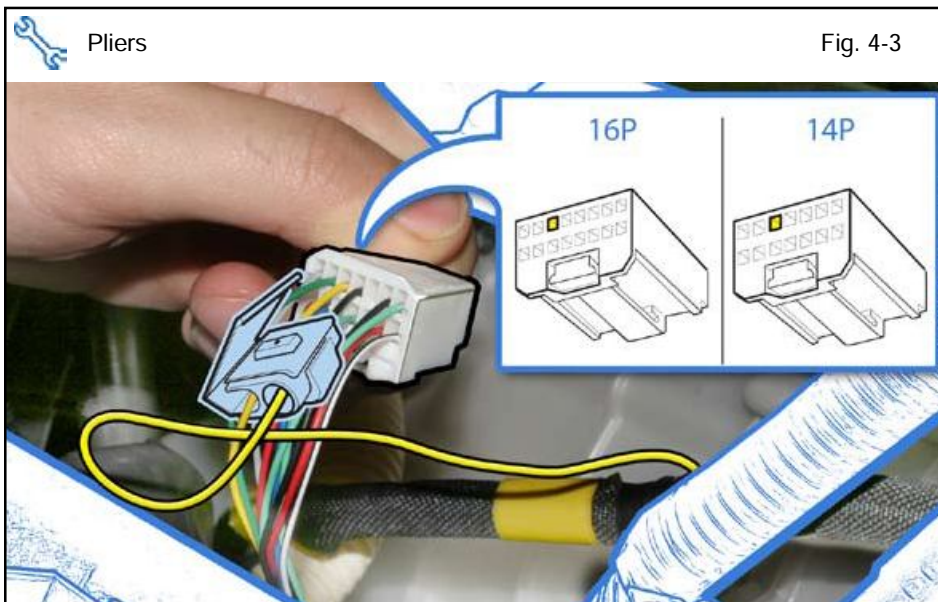


Fig. 4-2

- c. Locate the Vehicle Connector located in this area on the backside of the Climate Control Console.

NOTE: the connector location varies depending on whether the Vehicle is Smart or Non-smart.



Smart Vehicles ONLY

- d. Locate and Disconnect the appropriate Vehicle Connector.
- e. Secure the V5 Yellow Wire to the Yellow Wire on the Vehicle Connector using 1 Splicing Connector.
- f. Reconnect the Vehicle Connector.

Non-Smart Vehicles ONLY

- g. Locate and Disconnect the appropriate Vehicle Connector.
- h. Secure the V5 Yellow Wire to the Yellow Wire on the Vehicle Connector using 1 Splicing Connector.
- i. Reconnect the Vehicle Connector.

- j. Secure the V5 Harness to the Vehicle Brace with 2 Wire Ties. Locate the Vehicle Connector located in this area on the backside of the Climate Control Console.

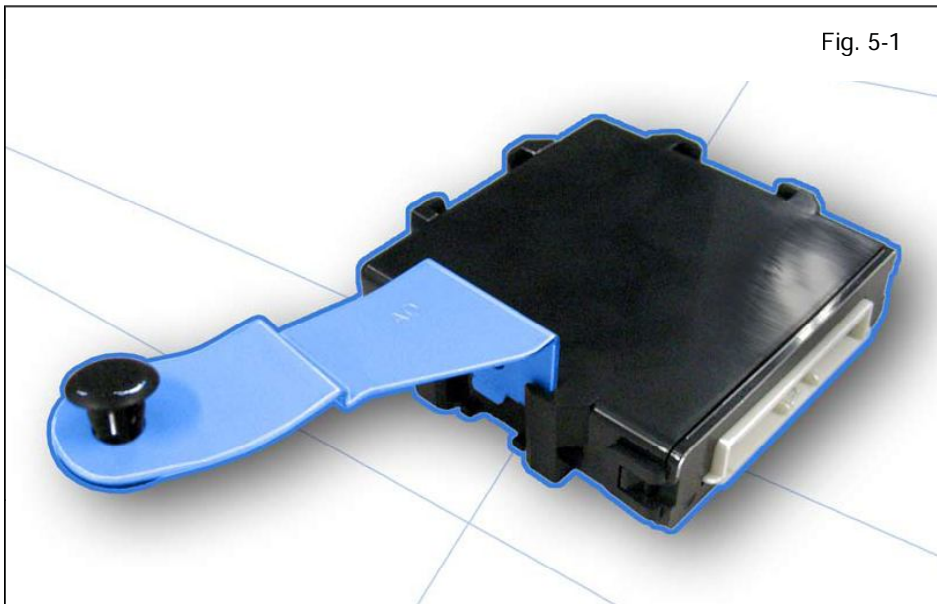


Fig. 5-1

5. V5 Security ECU and GBS ECU Preparation and Installation.

- Attach the Security Bracket to the Security ECU.
- Insert the Clip into the Bracket.

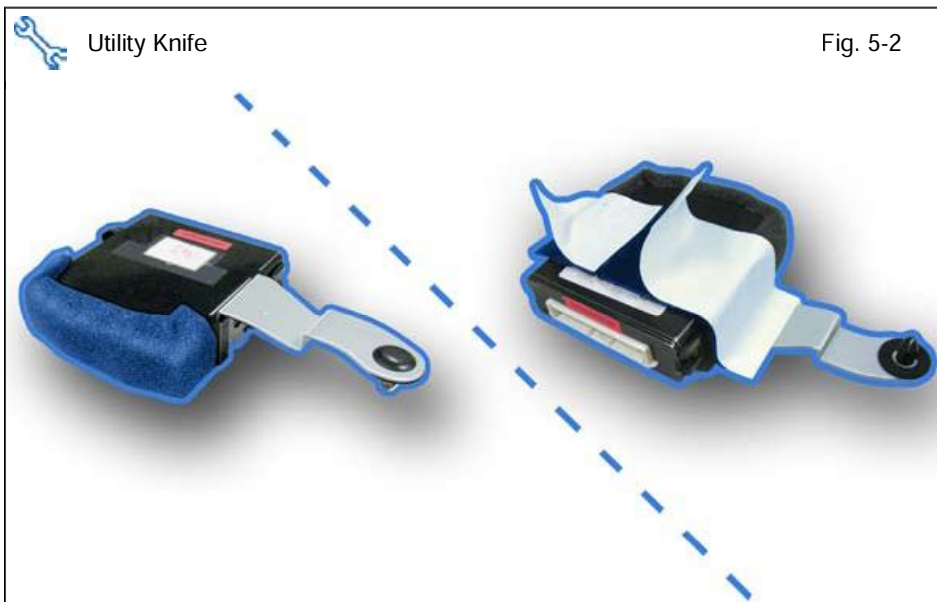


Fig. 5-2

- Apply 1 Medium Foam Tape to the Security ECU.
- Apply 1 and 1/2 pieces of Butyl Tape to the Security ECU.

NOTE: Do not remove the Protective Backing from both sides of the Butyl.

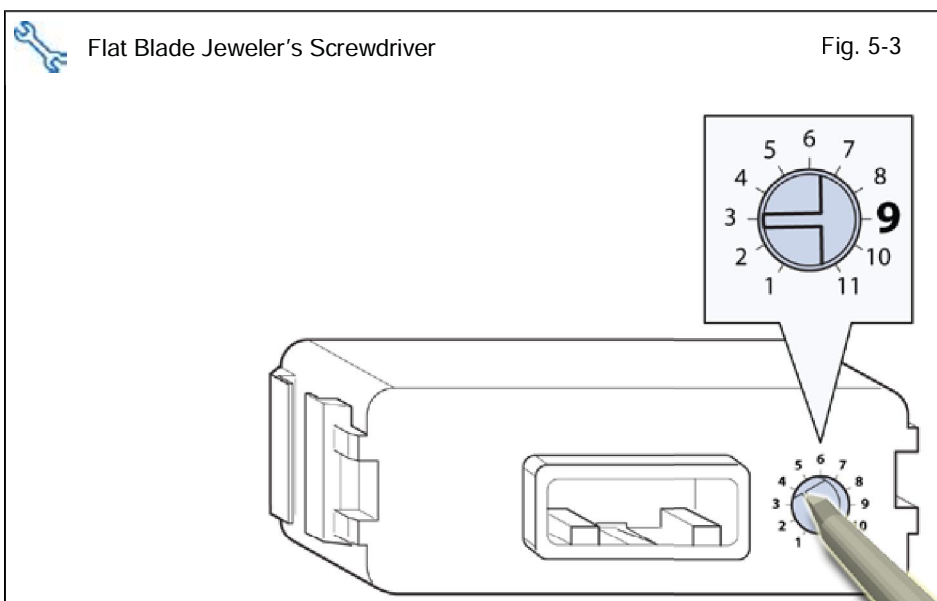
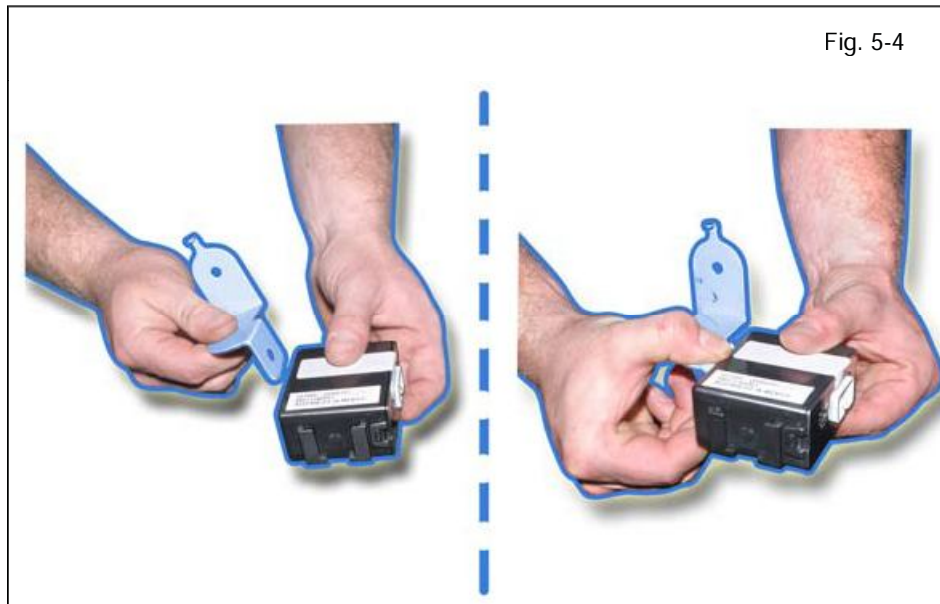
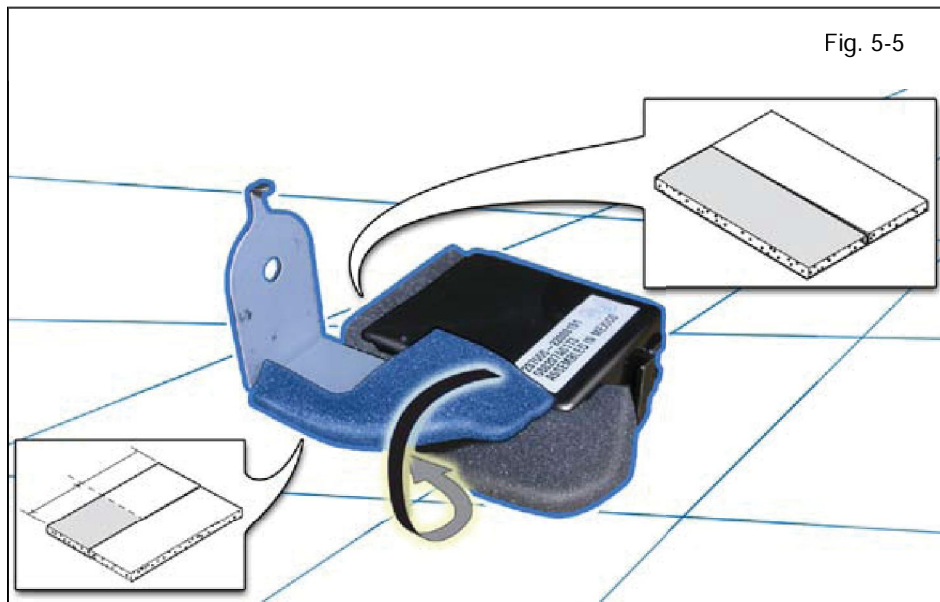


Fig. 5-3

- Set the GBS ECU to "9."



- f. Attach the GBS ECU Bracket to the GBS ECU.



- g. Apply 1 Large Foam Tape to the edge of the GBS ECU.
- h. Apply 1/2 Piece of Large Foam Tape to the GBS ECU Bracket.
- Do not discard excess.

Fig. 6-1



Fig. 6-2

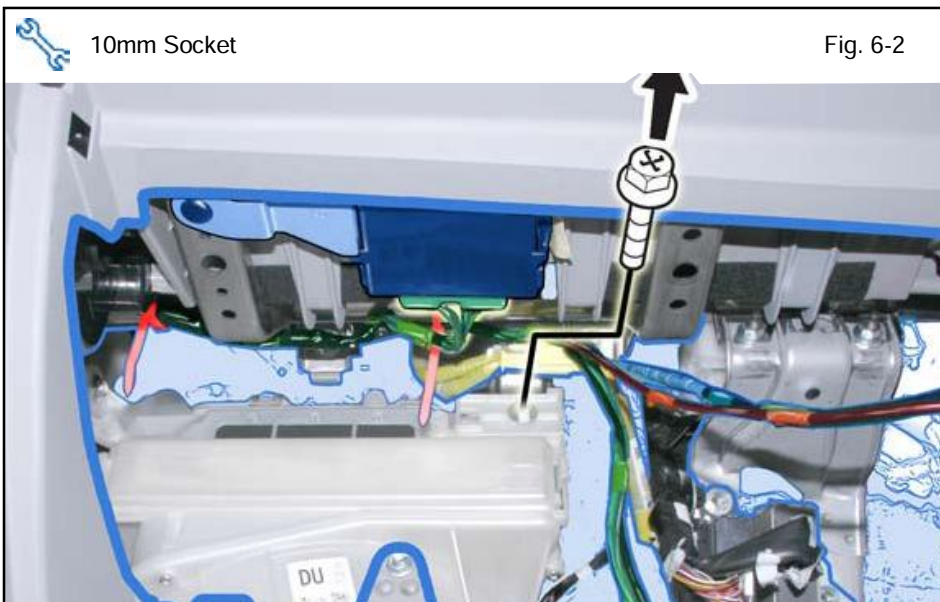
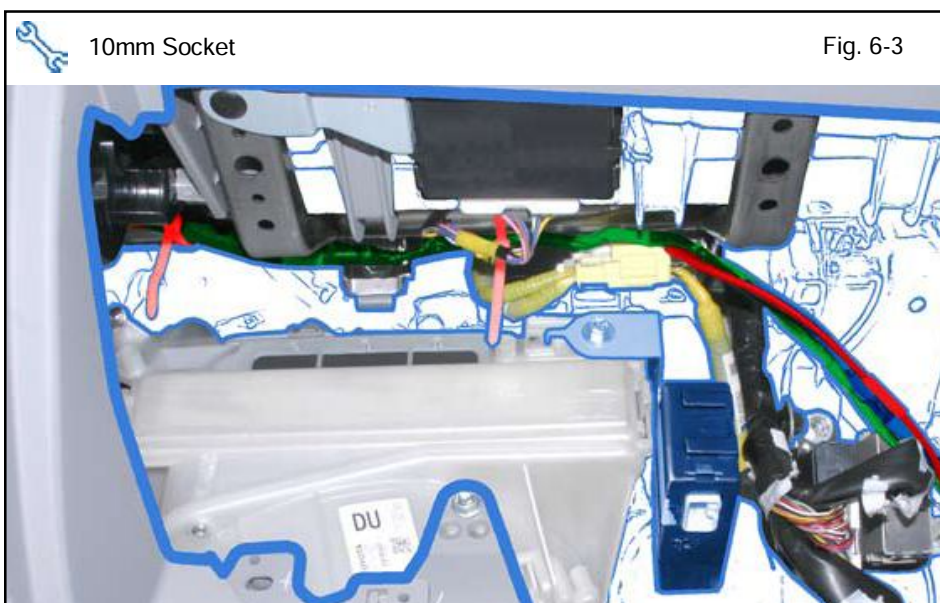


Fig. 6-3



6. V5 Harness Installation (Passenger's Side)

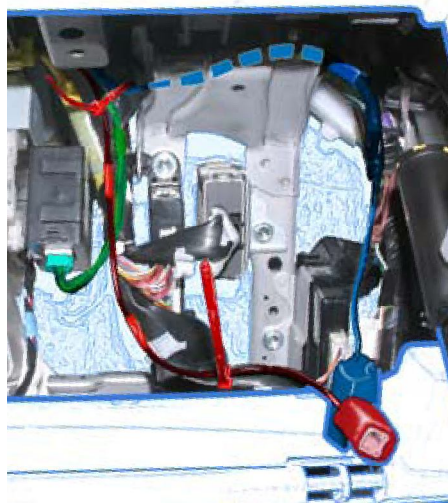
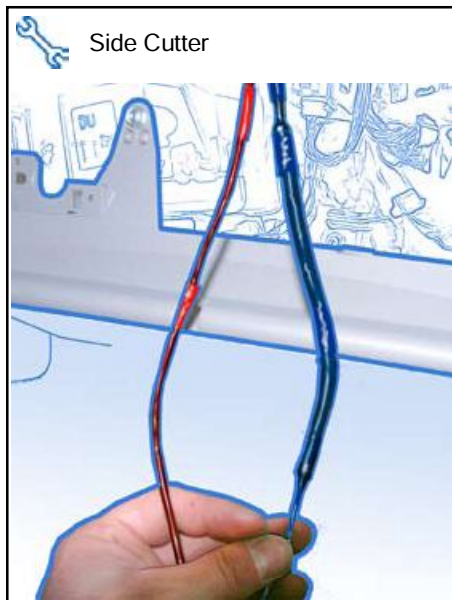
- Using VDC Approved Cleaner and Cleaning Method clean the area where the V5 Security ECU will be installed.
- Remove the remaining Protective Backing from the Butyl Tape on the Security ECU.
- Install the Security ECU.
 - Make sure that the Clip snaps in place.
- Connect the V5 36P Connector to the V5 Security ECU
- Remove the Bolt from the Top of the Blower Motor.
- Install the GBS ECU using the Vehicle Bolt.

Fig. 6-4



- g. Connect the V5 8P Connector to the GBS ECU.

Fig. 6-5



- h. Locate the V5 2P Connector Without the Harness Shielding.
- i. Route this portion of the Harness downward.
- j. Route the other portion over the top of the Brace.
- k. Secure the V5 Harness to the Vehicle Harness with 2 Wire Ties.

Fig. 6-6



- l. Locate the Vehicles 2P Female Pre-Connector.

NOTE: There are 2 Pre-Connectors. Make sure to un-tape the 2P Connector ONLY.

- m. Remove the Tape securing it to the Vehicle Harness.
- n. Connect the V5 2P Connector to the Vehicles 2P Pre-Connector.



Side Cutter

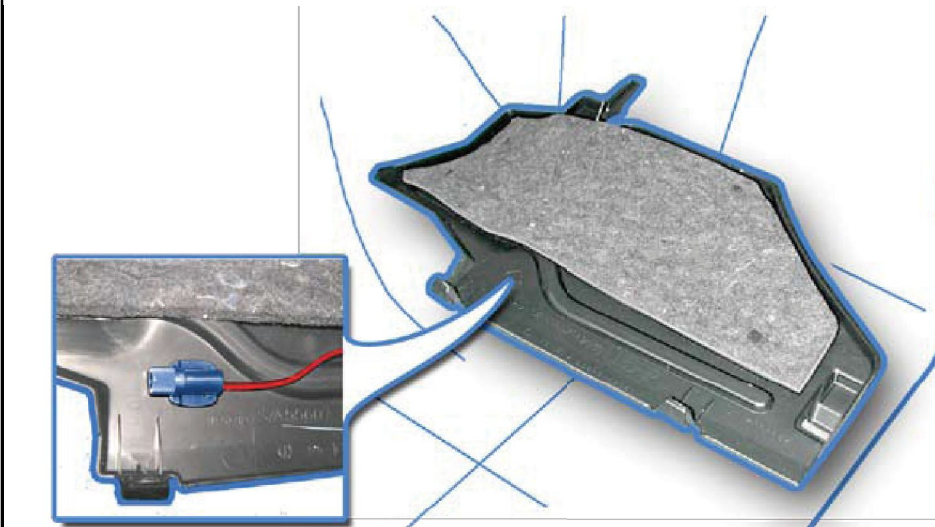
Fig. 6-7



- o. Secure the V5 Harness to the Vehicle Harness with 1 Wire Tie.
- p. Secure the 2P Connectors and the excess V5 Harness to the Vehicle Harness with 1 Wire Tie.



Fig. 7-1



7. GBS Microphone Installation

- a. Using VDC approved Cleaner and Cleaning Method clean the area indicated on the Glovebox Under Cover.
- b. Remove the Protective Backing from the V5 Microphone.

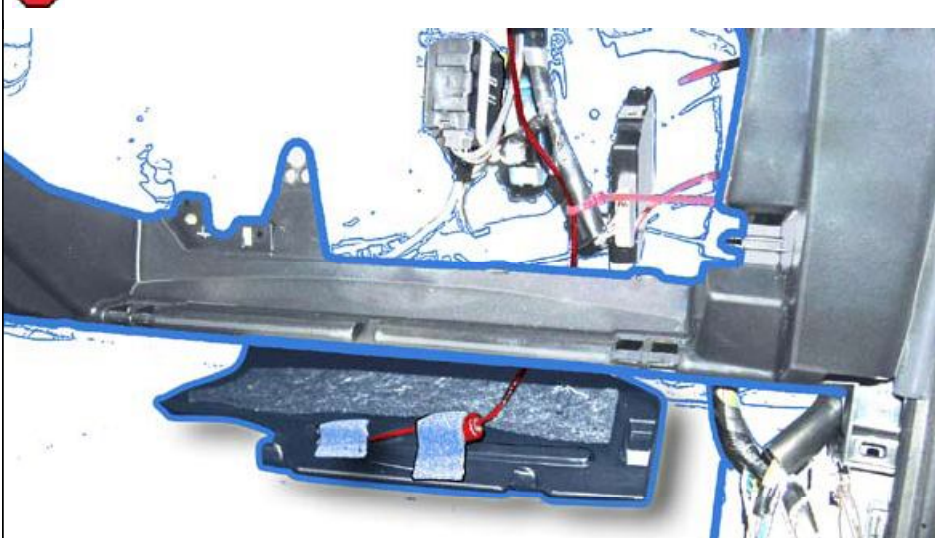


CAUTION: Do not touch the Adhesive Surface.

- c. Attach the Microphone to the Glove Box Under Cover.

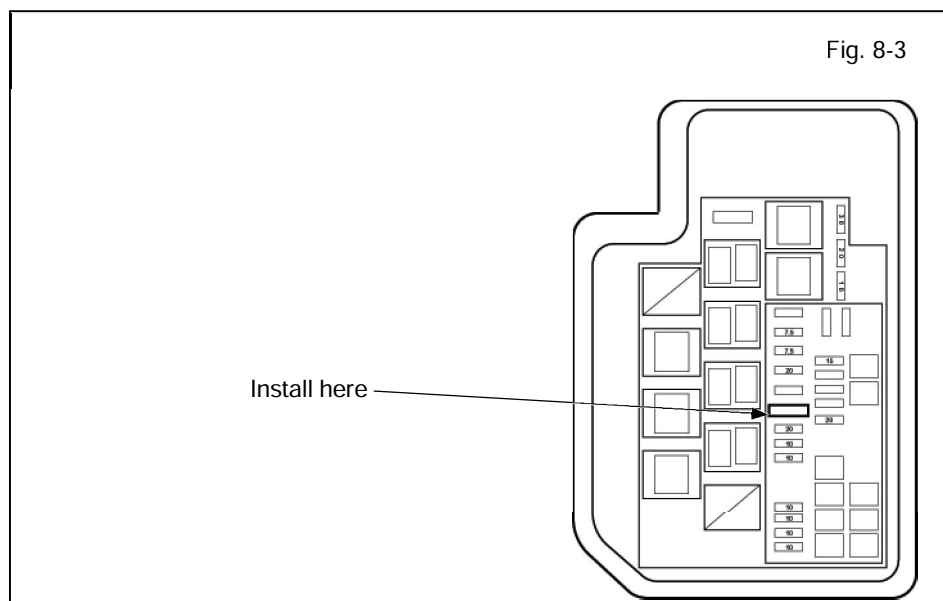
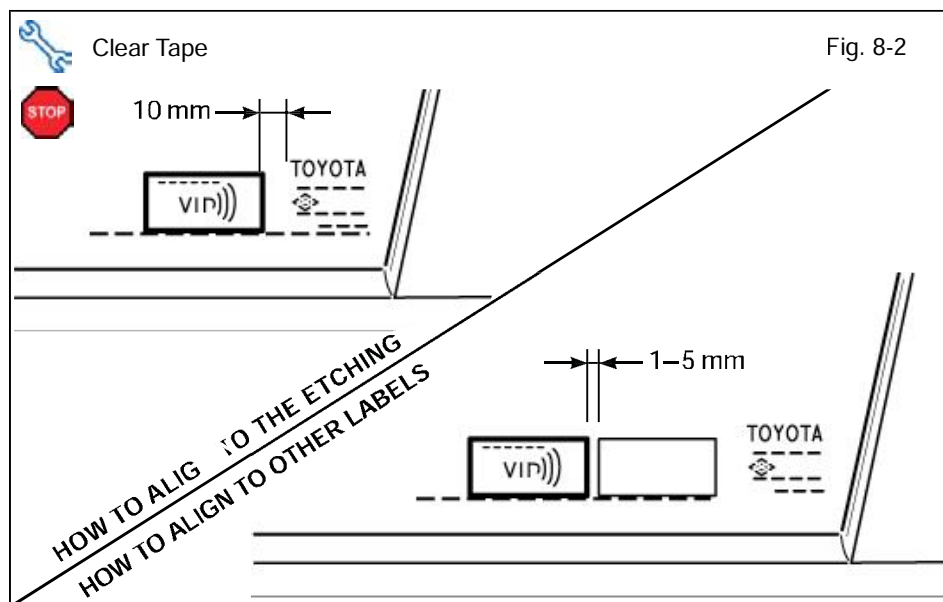
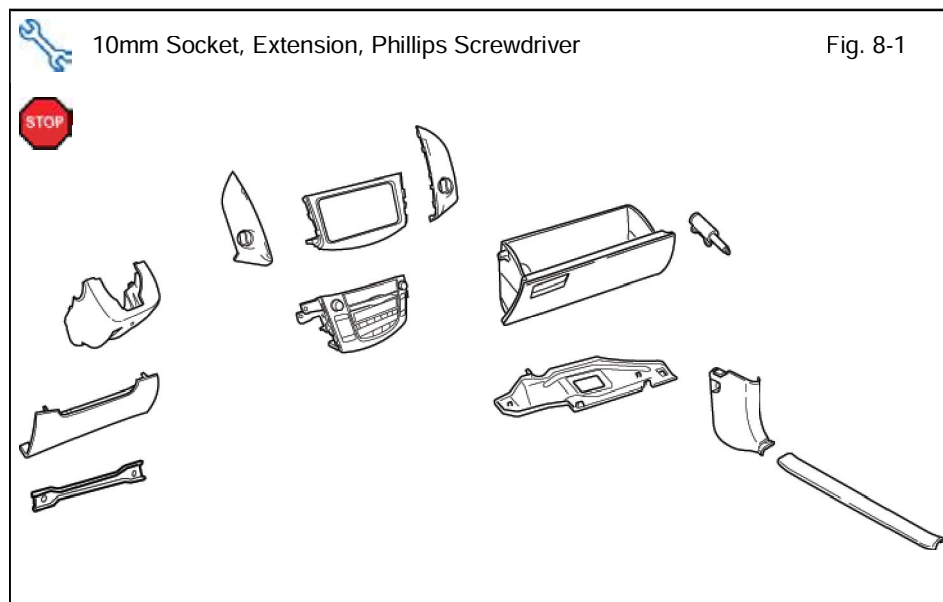


Fig. 7-2



CAUTION: Do not cover the Microphone Opening with the Foam Tape.

- d. Use 1/2 Piece of Large Foam Tape to secure the Microphone to the Glove Box Under Cover.
- e. Connect the last V5 2P Connector to the Microphone's 2P Connector.
- f. Use 1 Piece of Medium Foam Tape to secure the 2P Connectors to the Glovebox Under Cover.



8. Complete the Installation

a. Reassembling the Vehicle.

STOP **VERIFY:** that panels fit together properly, with no uneven gaps.

STOP **VERIFY:** that all Connectors are plugged in.

b. Use Household Glass Cleaner to clean the inside of the Front Door Windows.

c. Use a piece of Clear Tape to lift the Label from the protective backing.

STOP **CAUTION:** Do not touch the adhesive surface.

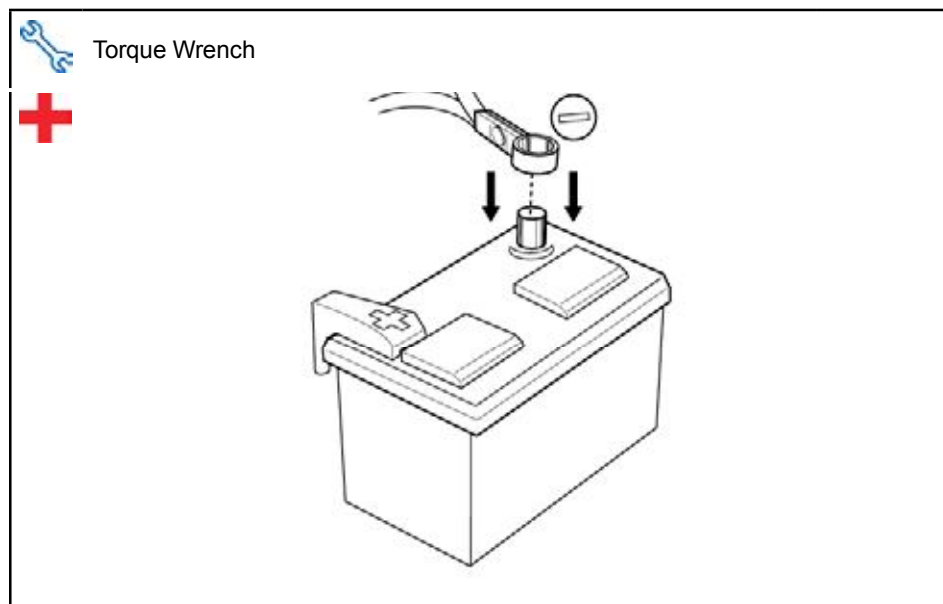
d. Attach the Label as shown.

STOP **NOTE:** Make sure to Align according to Etching or Other Label.

REPEAT: steps b–d with the other Window.

e. Verify that the Short Pin is Installed.

- If not Install now.



- f. Position the Negative Battery Cable at the original factory position.

- Tighten the Nut to 36 in•lbf (4.07 N•m)

CAUTION: Do not touch the positive terminal.

- g. Clean up and Remove trash.

- h. Sealed in its protective bag, place the Owner's Manual in the Glovebox.

- i. Reset the power windows.

Turn the ignition "ON."

- Lower the Windows halfway.

Pull up on the Power Window Switches until the windows close.

- Continue to hold up on the switches for a minimum of 1 Second.

- j. Reset the Moon Roof.

Open the Moon Roof halfway.

- Push and hold the Moon Roof Switch to close until the Moon Roof closes.

Continue to hold the switch for a minimum of 1 Second.

- k. Reset the tailgate door.

- Push door lock control switch to the "unlock" side.

- Pull up tailgate door handle.

Accessory Function Checks (non-Smart Vehicles ONLY)

1	Press and release the remote control lock button to start the system's arming process.	The turn signal lights flash once All doors lock. The Security LED lights up.
2	Wait 30 seconds.	Security LED starts flashing; the system is now armed.
3	Press and release the remote control's unlock button to disarm the system.	The turn signal lights flash twice. The driver's door unlocks. The Security LED flashing.

Open the driver's door, insert the key into the ignition switch and turn it to "ON". Roll down all the windows, remove the key  exit the vehicle.


4	Arm and disarm the system with the remote again, then wait 60 seconds.	The doors automatically relock. The system automatically starts the arming process.
5	Press and release the remote control's unlock button again to stop the arming process.	Refer to step 3.
6	Insert the key into the driver's door key cylinder and turn it toward the front of the vehicle to start the arming process.	All doors lock. The Security LED lights up.
7	Wait 30 seconds.	Security LED starts flashing; the system is now armed.
8	Reach inside and manually unlock the driver's door to trigger an alarm.	The driver's door automatically relocks. The horn sounds repeatedly. The headlights flash repeatedly. The turn signal lights flash repeatedly. The Security LED lights up.
9	Manually unlock the driver's door again and hold it unlocked, open the door, then sit in the driver's seat.	The driver's door lock attempts to lock repeatedly. The horn continues to sound repeatedly. The headlights and turn signal lights continue flashing. The Security LED remains on.
10	Insert the key into the ignition switch and turn it to "START" to stop the alarm.	The horn stops sounding. All the lights stop flashing and/or turn off. The Security LED turns off. The starter cranks and the engine starts.

Turn the key back to "LOCK", remove it, and then exit the vehicle.

11	With the door open, press the lock switch on the door to lock the doors, then close the door to start the system's arming process.	All doors lock. The Security LED lights up.
12	Wait 30 seconds.	Security LED starts flashing; the system is now armed.

CHECKLIST – these points **MUST** be checked to ensure a quality installation.

13	Reach inside and manually unlock the front passenger's door to trigger an alarm.	The front passenger's door automatically relocks. The horn sounds repeatedly. The headlights flash repeatedly. The turn signal lights flash repeatedly. The Security LED lights up.
14	Press and release the remote control's unlock button to stop the alarm.	The horn stops sounding. All the lights stop flashing. The Security LED turns off.
15	Press and release the remote control's lock button to start the system's arming process, then wait 30 seconds until the system is armed.	Refer to steps 1 and 2.
16	Unlock and open one of the rear passenger doors to trigger an alarm. (if available).	Refer to step 13.
17	Press and release the remote control's unlock button to stop the alarm.	Refer to Step 14.
18	Repeat the above steps with the other rear passenger door. (if available).	Refer to steps 1, 2, and 13.

Roll up all windows, remove the key  the vehicle.

19	Press and release the remote control's lock button to start the arming process.	Refer to step 1.
20	Wait 30 seconds.	After 30 seconds, the Security LED starts flashing; the system is now armed.

Perform the following check in a temperature-controlled environment. (50°-90° F)

21	With the tip of a key, or Striker Tool pulled all the way out (PPO only), tap the center of the driver's door window to trigger the alarm.	The horn sounds repeatedly. The headlights flash repeatedly. The turn signal lights flash repeatedly. The Security LED lights up.
22	Insert the key into the driver's door key cylinder and turn it toward the back of the vehicle to stop the alarm.	Refer to Step 10

If the alarm does not trigger during the Glass Breakage Test, increase the GBS sensitivity to the next setting and test again.

NOTE: If you do not disarm the system, the alarm will last 20 seconds. It is not necessary to check the alarm duration.

Accessory Function Checks (Smart Vehicles ONLY)

1	Press and release the remote control lock button to start the system's arming process.	The turn signal lights flash once All doors lock. The Security LED lights up.
2	Wait 30 seconds.	Security LED starts flashing; the system is now armed.
3	Press and release the remote control's unlock button to disarm the system.	The turn signal lights flash twice. The driver's door unlocks. The Security LED flashing.

Open the driver's door, with the smart key in your possession, press the power button to "ON". Roll down all the windows, remove the key exit the vehicle.

4	Arm and disarm the system with the remote again, then wait 60 seconds.	The doors automatically relock. The system automatically starts the arming process.
5	Press and release the remote control's unlock button again to stop the arming process.	Refer to step 3.
6	Press the lock button on the driver's exterior door handle to start the arming process.	All doors lock. The Security LED lights up.
7	Wait 30 seconds.	Security LED starts flashing; the system is now armed.
8	Reach inside and manually unlock the driver's door to trigger an alarm.	The driver's door automatically relocks. The horn sounds repeatedly. The headlights flash repeatedly. The turn signal lights flash repeatedly. The Security LED lights up.
9	Manually unlock the driver's door again and hold it unlocked, open the door, then sit in the driver's seat.	The driver's door lock attempts to lock repeatedly. The horn continues to sound repeatedly. The headlights and turn signal lights continue flashing. The Security LED remains on.
10	With the smart key in your possession, press the power button twice on the dash to "START" to stop the alarm.	The horn stops sounding. All the lights stop flashing and/or turn off. The Security LED turns off. The starter cranks and the engine starts.

Press the "START" button to turn the vehicle off, and then exit the vehicle.

11	With the door open, press the lock switch on the inside of the door to lock the doors, then close the door to start the system's arming process.	All doors lock. The Security LED lights up.
12	Wait 30 seconds.	Security LED starts flashing; the system is now armed.
13	Reach inside and manually unlock the front passenger's door to trigger an alarm.	The front passenger's door automatically relocks. The horn sounds repeatedly. The headlights flash repeatedly. The turn signal lights flash repeatedly. The Security LED lights up.

CHECKLIST – these points **MUST** be checked to ensure a quality installation.

14	Press and release the remote control's unlock button to stop the alarm.	The horn stops sounding. All the lights stop flashing. The Security LED turns off.
15	Press and release the remote control's lock button to start the system's arming process, then wait 30 seconds until the system is armed.	Refer to steps 1 and 2.
16	Unlock and open one of the rear passenger doors to trigger an alarm. (if available).	Refer to step 13.
17	Press and release the remote control's unlock button to stop the alarm.	Refer to Step 14.
18	Repeat the above steps with the other rear passenger door. (if available).	Refer to steps 1, 2, and 13.

Roll up all windows, and exit the vehicle.



Take the Smart Key and the Smart Card Key away from the Vehicle. Place them 7 ft. (2 meters) or more away from the Vehicle.

19	Press and release the remote control's lock button to start the arming process.	Refer to step 1.
20	Wait 30 seconds.	After 30 seconds, the Security LED starts flashing; the system is now armed.

Perform the following check in a temperature-controlled environment. (50°-90° F)

21	With the tip of a key, or Striker Tool pulled all the way out (PPO only), tap the center of the driver's door window to trigger the alarm.	The horn sounds repeatedly. The headlights flash repeatedly. The turn signal lights flash repeatedly. The Security LED lights up.
22	Press and release the remote control's unlock button to stop the alarm.	Refer to Step 10



NOTE: If the alarm does not trigger during functional verifications the Smart Key and Smart Card Key might be too close. Move them farther from the vehicle and test the system again.

If the alarm does not trigger during the Glass Breakage Test, increase the GBS sensitivity to the next setting and test again.

NOTE: If you do not disarm the system, the alarm will last 20 seconds. It is not necessary to check the alarm duration.








Vehicle Function Checks

	Function
--	----------

Enter the Vehicle

<input type="checkbox"/>	Dome/Courtesy Lights	<input type="checkbox"/>	Steering Wheel Column Adjusts Without Interference
<input type="checkbox"/>	Horn		

Start the Vehicle

<input type="checkbox"/>	Starter	<input type="checkbox"/>	Gauges
<input type="checkbox"/>	Panel/Switch Illumination	<input type="checkbox"/>	ABS Light (if equipped) <i>If the warning light remains on, it may indicate a system malfunction.</i> 
<input type="checkbox"/>	Lamp Failure Sensor <i>If the warning light remains on, it may indicate a system malfunction.</i> 	<input type="checkbox"/>	Track/Skid Control Light (if equipped) <i>If the warning light remains on, it may indicate a system malfunction.</i> 
<input type="checkbox"/>	Seat Belt Warning Light <i>If the warning light remains on, it may indicate a system malfunction.</i> 	<input type="checkbox"/>	Tire Pressure Monitoring System (TPMS). <i>Prior to TPMS activation and Pre-delivery Service (PDS) of the Vehicle the TPMS light will blink when IG is turned on.</i> 
<input type="checkbox"/>	Air Bag Warning Light <i>If the warning light remains on, it may indicate a system malfunction.</i> 		
<input type="checkbox"/>	Cruise Control Light (if equipped) 		<i>After TPMS activation and PDS of the Vehicle the TPMS light will illuminate for a few seconds and go off when IG is turned on.</i>

Using a Mirror or Assistant check the following.

<input type="checkbox"/>	Trunk/Tailgate/Bed Lights (if equipped)	<input type="checkbox"/>	Tail Lights
<input type="checkbox"/>	Brake Lights	<input type="checkbox"/>	Daytime Running Lights (if equipped)
<input type="checkbox"/>	Backup Lights	<input type="checkbox"/>	Marker Lights
<input type="checkbox"/>	Clearance Sonar (if equipped)		

Stop the Engine, Place the Vehicle's IG in the ON position.

<input type="checkbox"/>	Hazard Lights	<input type="checkbox"/>	Turn Signal Lights
<input type="checkbox"/>	Head Light	<input type="checkbox"/>	Fog Lights (if equipped)
<input type="checkbox"/>	High Beams	<input type="checkbox"/>	Accessory Controls/Illumination (if equipped)
<input type="checkbox"/>	Power Side Mirrors (if equipped)	<input type="checkbox"/>	Convenience Memory Settings (if equipped)
<input type="checkbox"/>	Power Sliding Door (if equipped)	<input type="checkbox"/>	Rear Sunshade (if equipped)

		Function	
<input type="checkbox"/>	Front Wiper/Washer	<input type="checkbox"/>	Rear Wiper/Washer (if equipped)
<input type="checkbox"/>	Power Sun/Moon Roof (if equipped)	<input type="checkbox"/>	Rollover Side Curtain Air Bag Switch (RSCA) (if equipped)
<input type="checkbox"/>	Clock (if equipped)	<input type="checkbox"/>	Navigation System (if equipped)
<input type="checkbox"/>	Audio/Video (if equipped)	<input type="checkbox"/>	HVAC
<input type="checkbox"/>	Steering Wheel Audio Control (if equipped)	<input type="checkbox"/>	Rear Window Defogger (if equipped)
<input type="checkbox"/>	Front Windshield Defogger (if equipped)	<input type="checkbox"/>	Accessory Power Socket (if equipped)
<input type="checkbox"/>	Side Mirror Defogger (if equipped)	<input type="checkbox"/>	Heated/Vented Seats (if equipped)
<input type="checkbox"/>	Massage Seats (if equipped)		
<input type="checkbox"/>	Glovebox Light (if equipped)	<input type="checkbox"/>	Passenger Air Bag Switch (if equipped)
<input type="checkbox"/>	Power Locks (if equipped)	<input type="checkbox"/>	Power Windows (if equipped)
<input type="checkbox"/>	Power Seats (if equipped)	<input type="checkbox"/>	Key Sensor Buzzer

Remove the short pin after Function check.

Check with your Port/Dealer to see if this step is necessary.

