



PT278-00160



ACCESSORIES

Distributed by Toyota Motor Sales, U.S.A., Inc.
Torrance, CA 90509
©2006 Toyota Motor Sales, U.S.A., Inc.

Part# PT278-00160

INSTRUCTION SHEET: FOR INSTALLATION OF MINI TIE-DOWN

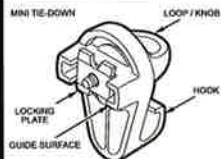

The bed rail system enables you to insert and move the mini tie-down to the best location along the bed rail to secure a load.

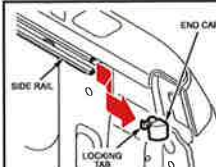

Remove (DO NOT DISCARD) end cap from side rail.

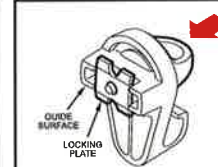

Depress the loop/knob so locking plate is equal with guide surface of the mini tie-down.

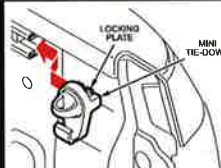

With the loop/knob depressed, slide the tie-down into the rail. Release the loop/knob once the tie-down enters the rail.

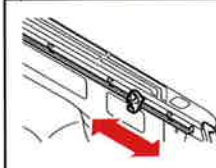

Slide mini tie-down to nearest detent position and snap into place. To move to another detent position, depress loop/knob to slide to next detent.



Tighten loop/knob in a clockwise motion until tight. Re-install end cap. Check tie-down to ensure that it is locked into detent and secure on rail.

WARNING
Properly install & tighten the mini tie-downs into the bed rail system. Failure to properly install & tighten the mini tie-downs can cause cargo to become unsecured. Unsecured cargo can cause injury when the vehicle is in motion.

WARNING
Properly secure all cargo to prevent shifting or sliding during driving. Failure to properly secure cargo can cause injury when the vehicle is in motion.

CAUTION
Applying loads at an angle to the mini tie-down greater than 45° or loads greater than 110lbs (for the loop/knob) and 50lbs (for the hook) may cause damage to the bed, bed rail system, mini tie-down and/or the cargo.

Place this instruction sheet in glove box for future reference