

Part Number: 64910-21070-B2

Kit Contents

Item #	Quantity Reqd.	Description
1	1	Cargo Cover
2		
3		

Hardware Bag Contents

Item #	Quantity Reqd.	Description
1		
2		
3		

Additional Items Required For Installation

Item #	Quantity Reqd.	Description
1		
2		
3		

Conflicts

--

Recommended Tools

Personal & Vehicle Protection	Notes
Blanket	
Special Tools	Notes
Installation Tools	Notes
Special Chemicals	Notes

General Applicability

All SCION tC

Recommended Sequence of Application

Item #	Accessory
1	
2	
3	

*Mandatory

NOTE: Part number of this accessory may not be the same as the part number shown.

Vehicle Service Parts (may be required for reassembly)

Item #	Quantity Reqd.	Description
1		
2		
3		

Legend

 **STOP:** Damage to the vehicle may occur. Do not proceed until process has been complied with.

 **OPERATOR SAFETY:** Use caution to avoid risk of injury.

 **CAUTION:** A process that must be carefully observed in order to reduce the risk of damage to the accessory/vehicle and to ensure a quality installation.

 **TOOLS & EQUIPMENT:** Used in Figures calls out the specific tools and equipment recommended for this process.

 **REVISION MARK:** This mark highlights a change in installation with respect to previous issue.

 **SAFETY TORQUE:** This mark indicates that torque is related to safety.

Care must be taken when installing this accessory to ensure damage does not occur to the vehicle. The installation of this accessory should follow approved guidelines to ensure a quality installation.

These guidelines can be found in the "Accessory Installation Practices" document.

This document covers such items as:-

- Vehicle Protection (use of covers and blankets, cleaning chemicals, etc.).
- Safety (eye protection, rechecking torque procedure, etc.).
- Vehicle Disassembly/Reassembly (panel removal, part storage, etc.).
- Electrical Component Disassembly/Reassembly (battery disconnection, connector removal, etc.).

Please see your SCION dealer for a copy of this document.

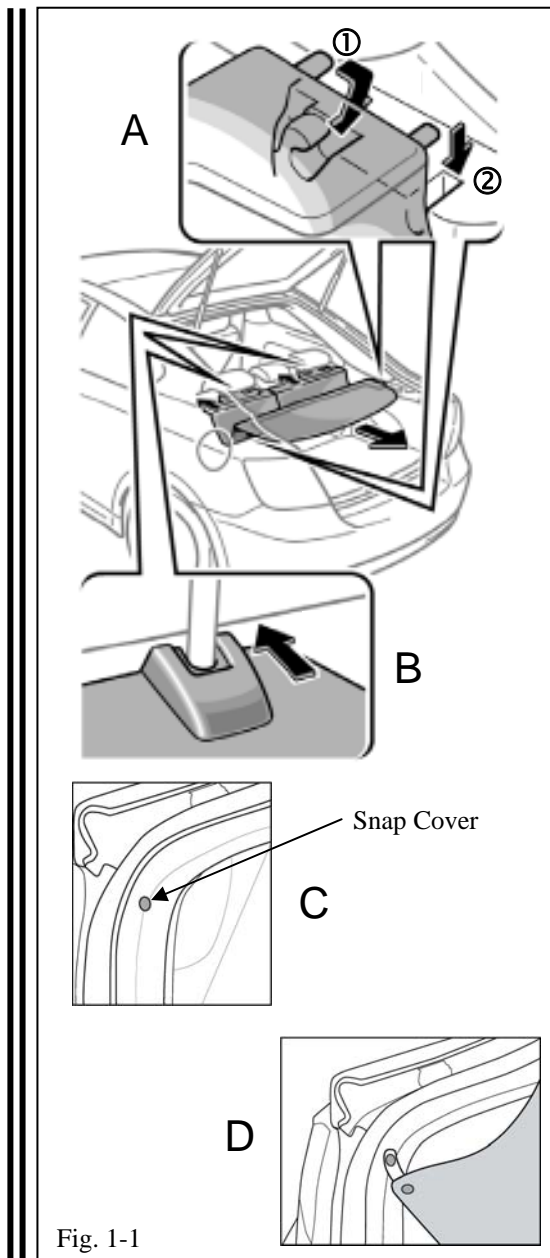

1. Installation of Cargo Cover

(a) Open vehicle rear cargo door and locate the Cargo Cover mounting points on the driver and passenger side of the cargo compartment.

 (b) Place the left and right end of cargo cover support forward pin into the mounting point ①. Then rotate the cover down to place the support rear pin ② into the slot. (Fig. 1-1A)

 (c) Clip the hooks on the head restraint. (4 places). (Fig 1-1B)

 (d) Remove the snap covers located on the rear trim panel (2 places). (Fig 1-1C)

 (e) Attach the rear retention snaps. (Fig. 1-1D)

Fig. 1-1

Checklist - these points **MUST** be checked to ensure a quality installation.

Check:

Look For:

Accessory Function Checks

- Confirm the cover is attached properly to the anchor points in the vehicle.

Make sure the support pins are fully seated in the anchor points, clips are attached to the rear head restraint and retention snaps are attached.

Vehicle Function Checks

- Rear cargo door

Rear cargo door should open and close freely without interference from the cargo cover