

Five Axis Design Lip Kit

Installation Instructions - page 1/3

⚠ IMPORTANT: The double-back tape used to mount the Five Axis Design Lip Kit to the vehicle is extremely strong, and once in place, it is very difficult to remove or reposition the part! Please observe the following technique when final mounting the parts to the car takes place:

Double-back Tape Part Alignment and Mounting Technique

1. Make sure the mounting surface is free from wax, grease, and dirt. Clean thoroughly with a solvent degreaser to insure maximum tape adhesion.
2. Test fit the part on the car and make an indexing mark at the approximate center of the part so that the part can be easily re-aligned using this mark. Remove the part.
3. Using the same approximate center of the part (step 2), take a sharp knife or razor, slice through the double-back tape backing, and peel it back approximately 1" on each side of the slice, exposing the adhesive.
4. Fold the backing at a 45 degree angle exposing it beyond the part. Be sure that enough of the backing is sticking beyond the part so that it can be firmly grasped in order to remove it in the following steps. Failure to do so will cause problems.
5. With the backing sticking out behind the part, carefully position the part, taking great care to align it properly to the indexing mark (step 2). **DO NOT PRESS FIRMLY** but gently enough for the exposed adhesive to make contact with the mounting surface. Once the center is in place, make sure the rest of the part is aligned properly also.
6. Grasp one side of the exposed backing and slowly pull it away from between the part and the mounting surface, gently applying pressure along the way. Do not apply firm pressure until the entire backing is removed, and it is confirmed that the part is in its final position. Repeat process for the remaining backing.
7. Once all backing is removed, firmly press part onto mounting surface.

NOTE: In some cases, there may be more than one strip of continuous tape. In this case, use the same technique to expose only a small portion of the adhesive, leaving enough backing to remove once the part is against the mounting surface and in position.

Should a small portion of the tape accidentally becomes adhered in the wrong location, remove the part very gently taking great care not to tear or detach the tape from the part it was originally mounted to. If this happens, slice the tape from the part and salvage as much as possible. Replace the damaged area with new tape.

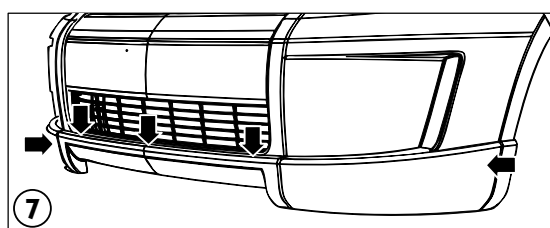
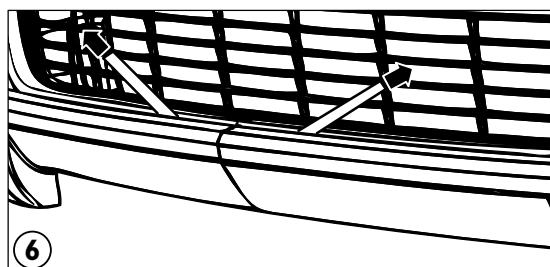
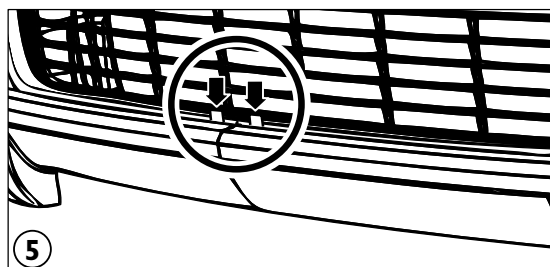
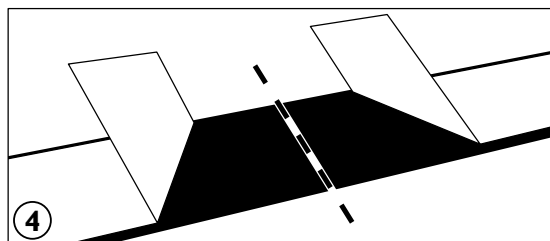
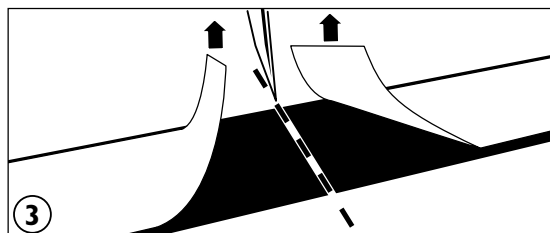
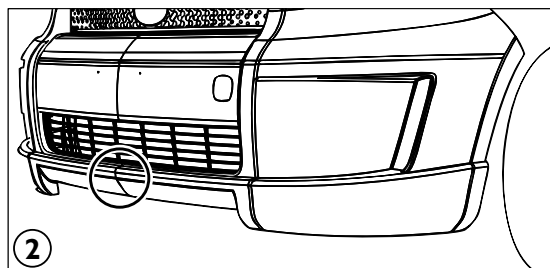
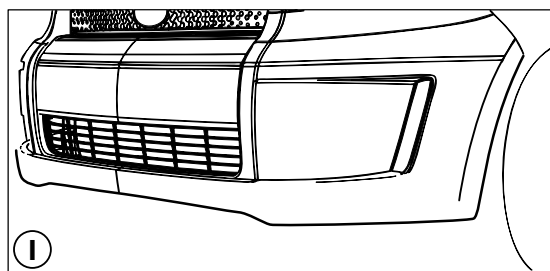

FIVE **axis** **DESIGN**

Five Axis Design Lip Kit

Installation Instructions - page 2/3

⚠ **IMPORTANT:** Make sure the mounting surface is free from wax, grease, and dirt. Clean thoroughly with a solvent degreaser to insure maximum tape adhesion.

Front Lip Installation Instructions:

After test fitting and painting, use the following steps for final attaching Front Lip to the vehicle:

1. Align and adhere Front Lip to the bumper using double-back tape. Use the part alignment and adhesion method described on the first page. Be sure to put adequate pressure on the areas indicated by the arrows to insure maximum tape adhesion.
2. Use the pre-drilled holes in the wheelhouse area to secure the part to the bumper using the self-tapping screws provided.

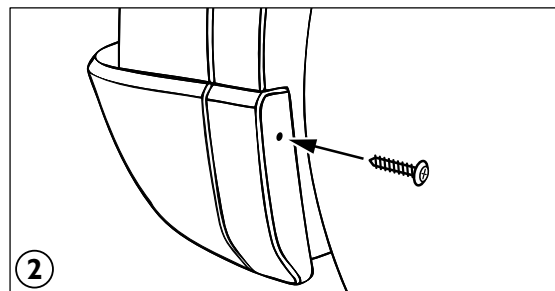
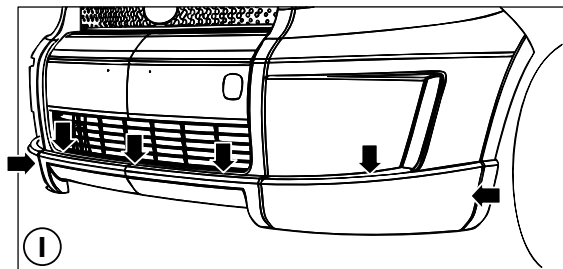

Rear Valance Installation Instructions:

After test fitting and painting, use the following steps for final attaching Rear Valance to the vehicle:

3. Align and adhere Rear Valance to the bumper using double-back tape. Use the part alignment and adhesion method described on the first page. Be sure to put adequate pressure on the areas indicated by the arrows to insure maximum tape adhesion.
4. Use the pre-drilled holes in the wheelhouse area to secure the part to the bumper using the self-tapping screws provided.

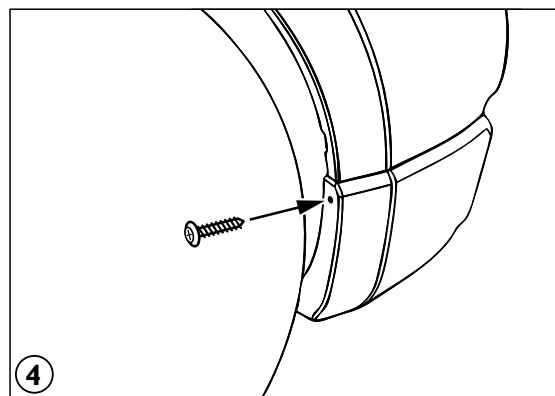
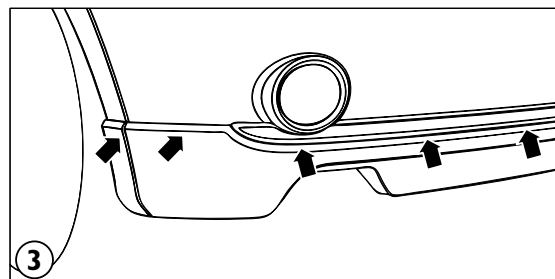

Five Axis Design Lip Kit

Installation Instructions - page 3/3

⚠ **IMPORTANT:** Make sure the mounting surface is free from wax, grease, and dirt. Clean thoroughly with a solvent degreaser to insure maximum tape adhesion.

Rocker Installation Instructions:

After test fitting and painting, use the following steps for final attaching Rockers to the vehicle:

1. Remove (2) 10mm screws and the L-shaped trim piece from the front wheelhouse at the rocker.
2. Keep only the black 10mm screw for mounting the new rocker and discard the rest.
3. Align and adhere Rocker to the doorsill using double-back tape. Use the part alignment and adhesion method described on the first page. Be sure to put adequate pressure on the areas indicated by the arrows to insure maximum tape adhesion.
4. Take extra care making sure that there is adequate clearance between the Rocker and bottom lower corner of the rear door.
5. Use the factory black 10mm screw and the pre-drilled holes in the wheelhouse area to secure the part using the self-tapping screws provided.

Rear Valance Two-tone Paint

After painting the Rear Valance body color and allowing it to dry, mask and paint the center lower portion black.

6. Using the existing part separation groove as a guide, mask out the lower area to be painted.
7. Paint masked area using an automotive trim black or similar low gloss paint to black out the lower area.

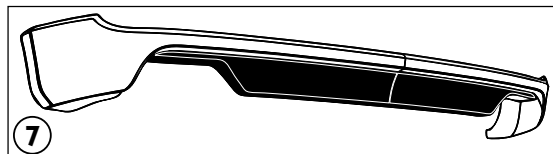
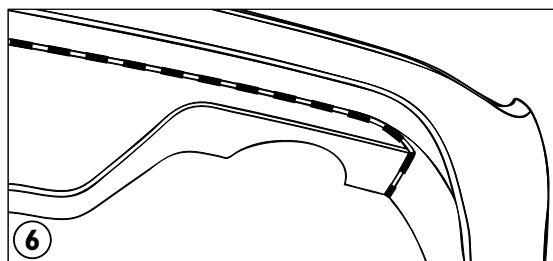
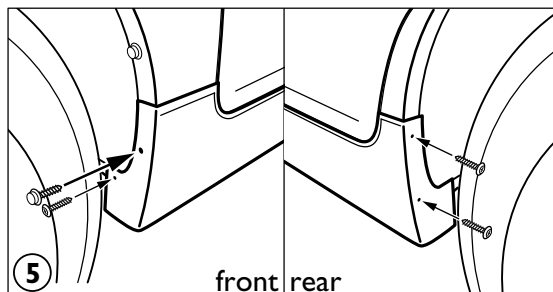
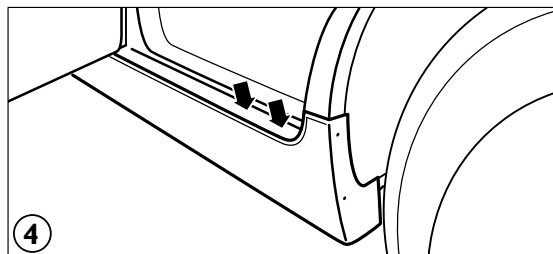
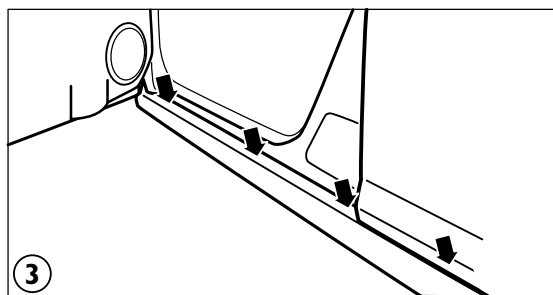
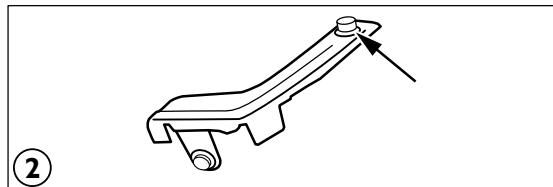
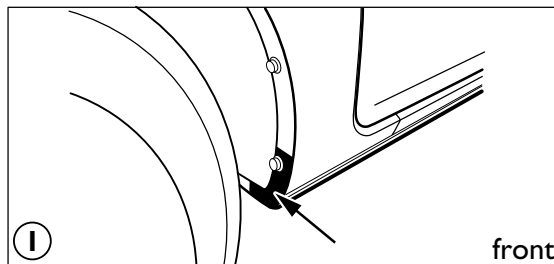

FIVE axis
DESIGN