

Toyota

FJ Cruiser

2010 -

Skid Plate Assembly

Part Number: 00016-60015

Accessory Code: SK2

Mount Kit: 00016-60325-01

Mount Kit: 00016-60015-01



## Conflicts

Note: PRE 2010 MODELS

### Kit Contents for 2010 -

Item #	Quantity Req'd.	Description
1	1	Skid Plate
2	1	Passengers Side Front Bracket
3	1	Drivers Side Front Bracket
4	1	Rear Mounting Bracket

### Kit Content for 2007 -

Item #	Quantity Req'd.	Description
1	1	Skid Plate
2	1	Passenger Bracket
3	1	Driver Bracket
4	2	Spacer

### Hardware Bag Contents for 2010 -

Item #	Quantity Req'd.	Description
1	2	M8X1.25mmX40mm Hex Bolt
2	4	M8X1.25mmX30mm Hex Bolt
3	2	M8X1.25mmX60mm Countersunk Socket Cap Screw
4	2	M8X1.25mmX20mm Hex Bolt
5	12	3/8" Flat Washer
6	8	3/8 Spring Type LOC Washer
7	4	M8 Hex Nut

### Hardware Bag Contents for 2007 -

Item #	Quantity Req'd.	Description
1	6	M8-1.25 X 30MM Hex Bolt
2	2	M8-1.25MM 90MM Hex Bolt
3	4	M8-1.25Hex Nut
4	12	3/8" Flat Washer
5	8	3/8" Split Lock Washer

### Recommended Tools

<b>Safety Tools</b>	
<b>Special Tools</b>	
<b>Installation Tools</b>	
12mm,13mm Socket	
13mm Wrench	
3/16" Allen Wrench	
Ratchet	
Torque Wrench	
<b>Special Chemicals</b>	

### Applicability Chart

Mount Kit	Model: 2007 -	Model: 2010 -													
00016-60325-01	X														
00016-60015-01		X													

### General Applicability

2010 FJ Cruiser

### Additional Item Required For Installation

Item #	Quantity Req'd.	Description
1	1	J

### Legend

- STOP:** Damage to the vehicle may occur. Do not proceed until process has been complied with.
- OPERATOR SAFETY:** Use caution to avoid risk of injury.
- CAUTION:** A process that must be carefully observed in order to reduce the risk of damage to the accessory/vehicle and to ensure a quality installation.
- TOOLS & EQUIPMENT:** Used in Figures calls out the specific tools and equipment recommended for this process.
- REVISION MARK:** This mark highlights a change in installation with respect to previous issue.
- SAFETY TORQUE:** This mark indicates that torque is related to safety.

### SPECIAL NOTE: Installation Sequences

After TMS and Safety mandated preparatory steps have been taken, the installation sequence is the suggested method for completing the accessory installation. In some instances the suggested sequence is written for one associate to install and in others the sequence is given as part of a team accessory installation. Unless otherwise stated in the document, the associates may perform the installation steps in any order to make the installation as efficient as possible while maintaining consistent quality.

1. Remove the two forward 12MM mounting bolts from the factory skid plate. Attach the driver and passenger side mounting bracket below the skid plate using the supplied M8 x 40MM Hex bolts, 3/8" lock washers, and 3/8" flat washers. Tab should be seated on the front edge of the factory skid plate. Tighten to 10ft. lbs.
2. Remove the two rear 12MM mounting bolts from the factory skid plate and attach the rear mounting bracket using the two provided M8 countersunk socket cap screws. Tighten to 25ft/lbs
3. Attach the new skid plate to the front mounting brackets using four M8 x 30MM hex bolts, eight 3/8" flat washers, four 3/8" loc washers, and four M8 hex nuts. Tighten to 10 ft/lbs
4. Secure the rear mounting holes to the rear mounting bracket using two M8 x 20MM hex bolts, two 3/8" flat washers, and two 3/8" loc washers. Tighten to 10 ft/lbs.

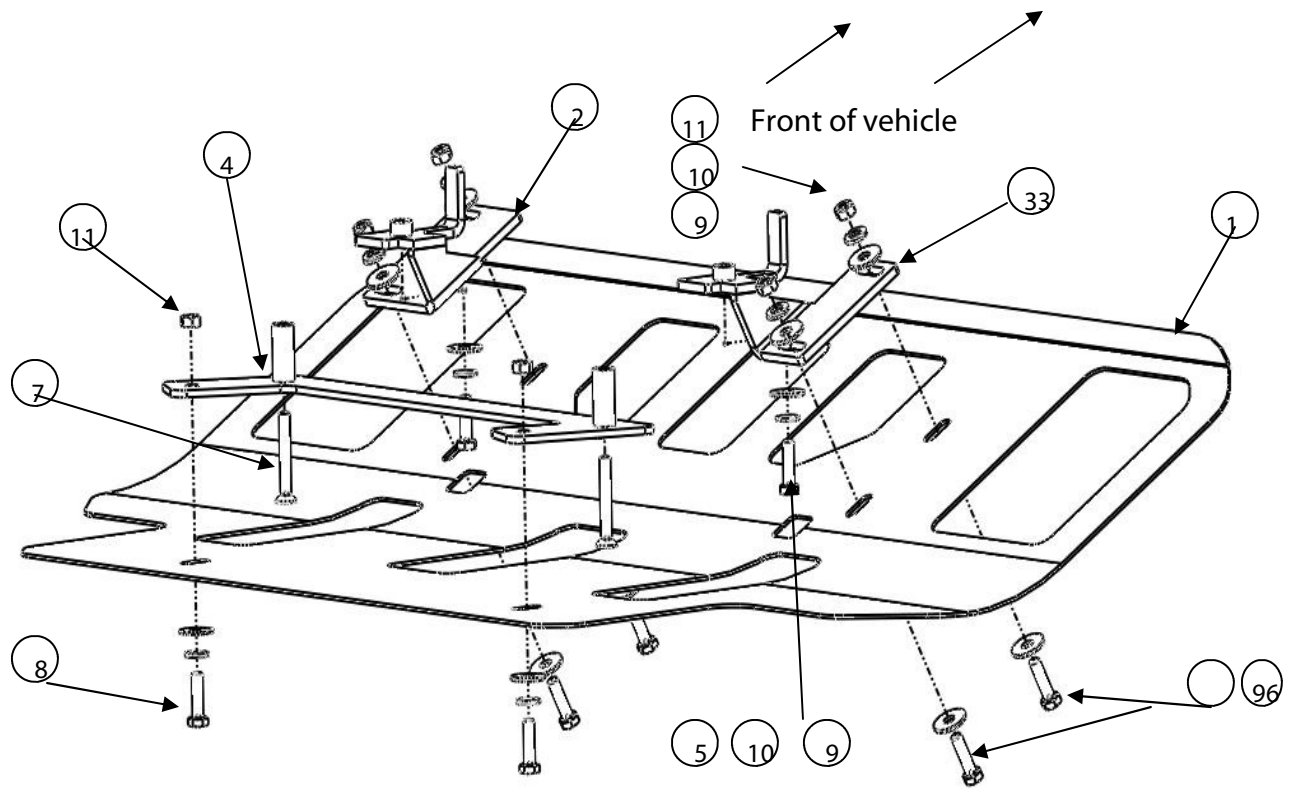

- STEP 1. Remove the contents from box and check for damage. Verify all parts are present. Read instructions completely before beginning.
- STEP 2. Determine passenger and driver brackets. Attach mount bracket to the front cross member of the vehicle using a M8-1.25 x 30mm hex head bolt, 3/8" flat washer, and 3/8" lock washer as shown. Leave loose. Repeat for opposite side. SEE FIGURE 1. **Note: Use 3/8" washers on either bracket to level the skid plate as necessary.**
- STEP 3. Install the skid plate to the rear mount locations using the spacers, M8-1.25 x 90mm hex head bolts, 3/8" flat washers and 3/8" lock washers as shown. Leave loose.
- STEP 4. Attach Skid Plate to brackets using M8 fasteners as shown. Level and adjust Skid Plate. Torque 8mm fasteners to 25 FT.LBS. (-25% / +50%)

Place washers here, as needed

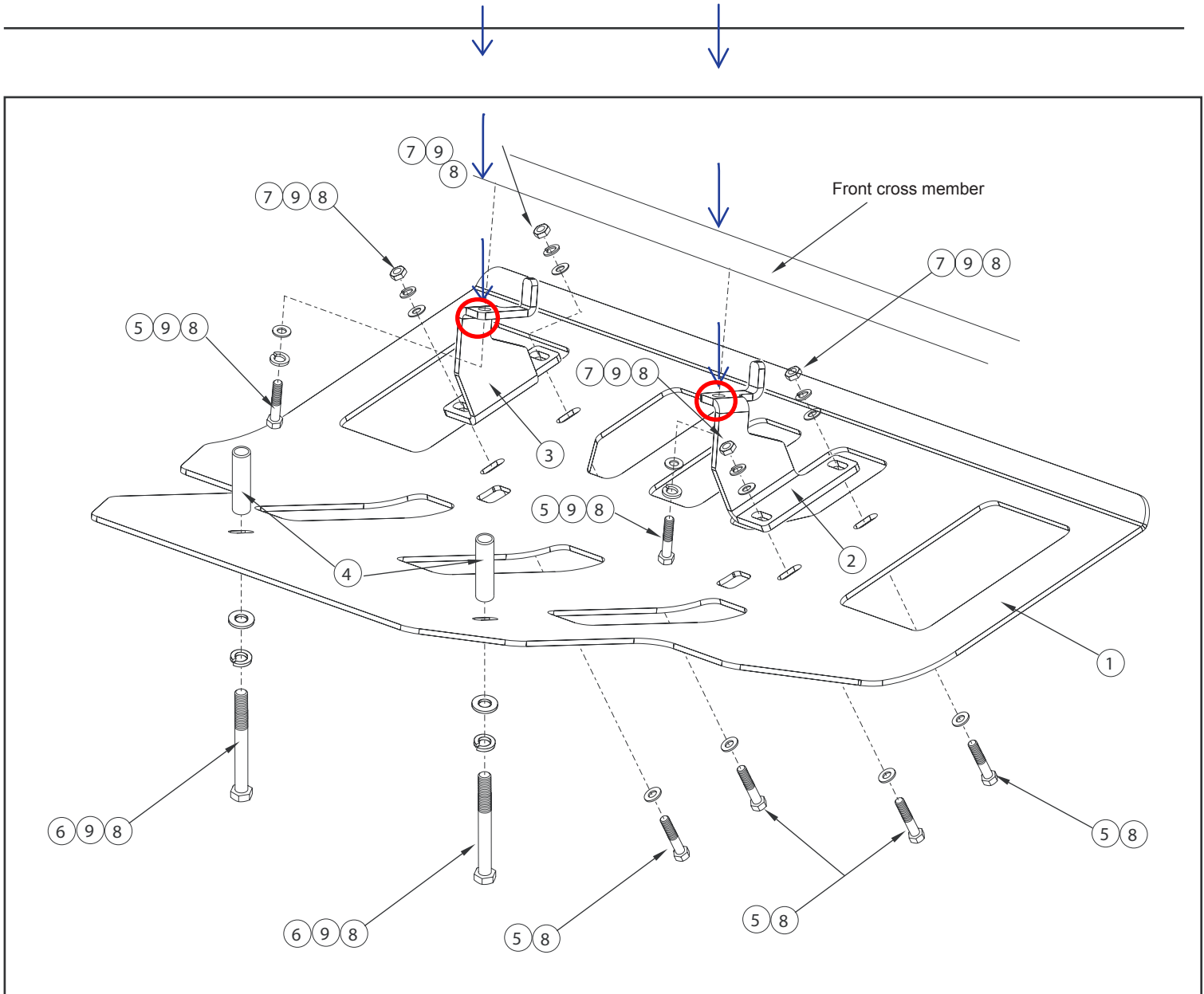



FIGURE 1  
INSTALLATION VIEW

Checklist - these points must be checked to ensure quality installation

Check: \_\_\_\_\_

Look For: \_\_\_\_\_

Visual check of skid plate and gap

  Re-check all bolts for torque.

Visually centered left to right & level

**Model 2010 -**

Torque two rear 12mm bolts to target of 25 ft. lbs.  
Range of 18.75ft. lbs min ~ 37.5ft. lbs max  
-25% / +50%

Torque all 8mm & 2 forward 12mm bolts  
to target of 10 ft. lbs.  
Range of 7.5 ft lbs min. ~ 15 ft lbs. max  
+/- 25%

**Model 2007 -**

Torque all fasteners to target of 25ft. lbs.  
Range of 18.75ft. lbs. min ~ 37.5 ft. lbs. max.  
-25% / +50%

Note: Range Provided by QA