

**TOYOTA RAV-4 2006-UP CHROME STEP BAR ASSEMBLY**

**PART NUMBER : 00016-42960-13**

**Code: LD1**

## SERVICE KIT NUMBERS:

00016-42960-72	PASS.TUBE
00016-42960-71	DRIVERS. TUBE
00016-42960-74	MOUNT KIT
00016-42960-73	STEP PAD

## Kit Contents

Item #	Quantity Req'd.	Description
1	2	STEP BAR
2	2	BRACKET, PASSENGER
3	2	BRACKET, DRIVER
4	4	BOLT PLATE

## Hardware Bag Contents

[illegible]

### Additional Items Required For Installation

Item #	Quantity Req'd.	Description

## Conflicts

**Note:**

## Recommended Tools

<b>Safety Tools</b>	
<b>Special Tools</b>	
<b>Installation Tools</b>	
3/4" SOCKET	
7/32" HEX WRENCH	
RATCHET	
TORQUE WRENCH	30 & 65 ft. lbs.
<b>Special Chemicals</b>	

**Color Applicability/Trim Level**[illegible]

### General Applicability

[illegible]

### Recommended Sequence of Application

Item #	Accessory	

\*Mandatory

### Legend

 **STOP:** Damage to the vehicle may occur. Do not proceed until process has been complied with.

 **OPERATOR SAFETY:** Use caution to avoid risk of injury

 **CRITICAL PROCESS:** Proceed with caution to ensure a quality installation. These points will be audited on a completed vehicle installation



 **GENERAL PROCESS:** This highlights specific processes to ensure a quality installation. These points will be audited during the accessory installation

 **TOOLS & EQUIPMENT:** This calls out the specific tools and equipment required for this process

 **REVISION MARK:** This mark highlights a change in installation with respect to previous issue.

### **SPECIAL NOTE: Installation Sequences**

After **TMS** and **Safety** mandated preparatory steps have been taken, the installation sequence is the suggested method for completing the accessory installation. In some instances the suggested sequence is written for one associate to install and in others the sequence is given as part of a team accessory installation. Unless otherwise stated in the document, the associates may perform the installation steps in any order to make the installation as efficient as possible while maintaining consistent quality.

- STEP 1. Remove the contents from box and check for damage. Verify all parts are present. Read instructions completely before beginning.
- STEP 2. Locate oval slots at front and rear of rocker panel. If plastic plugs are present remove them. Insert 1/2" bolt plates into oval slots. Use plastic washers to hold them in place. SEE FIGURE 1.
- STEP 3. Install brackets on to bolt plates and secure with 1/2" fasteners. Leave Loose. Place step tube onto brackets and secure with 3/8" Hardware. Tube with holes closest to the end of the tube goes toward the front of the vehicle. SEE FIGURE 2.
-  STEP 4. Center and adjust brackets and step tubes for desired fitment. Torque 1/2" fasteners to 65 lbs/ft. And 3/8" fasteners to 30 lbs/ft. 

**FIGURE 1**  
**DRIVERS SIDE SHOWN**  
**PASS. SIDE OPPOSITE**

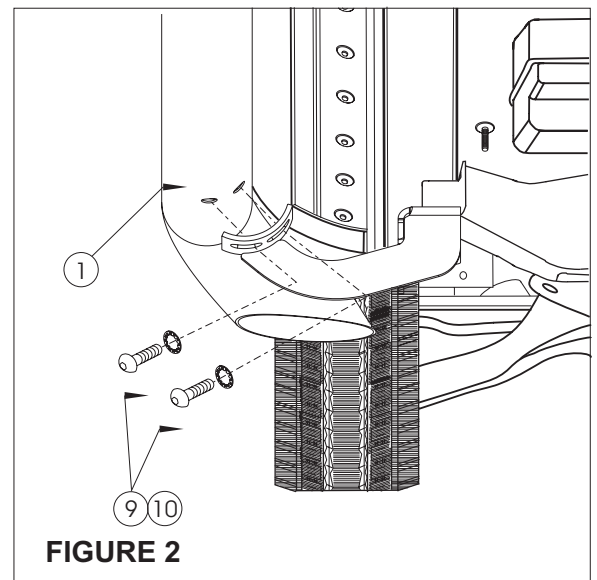
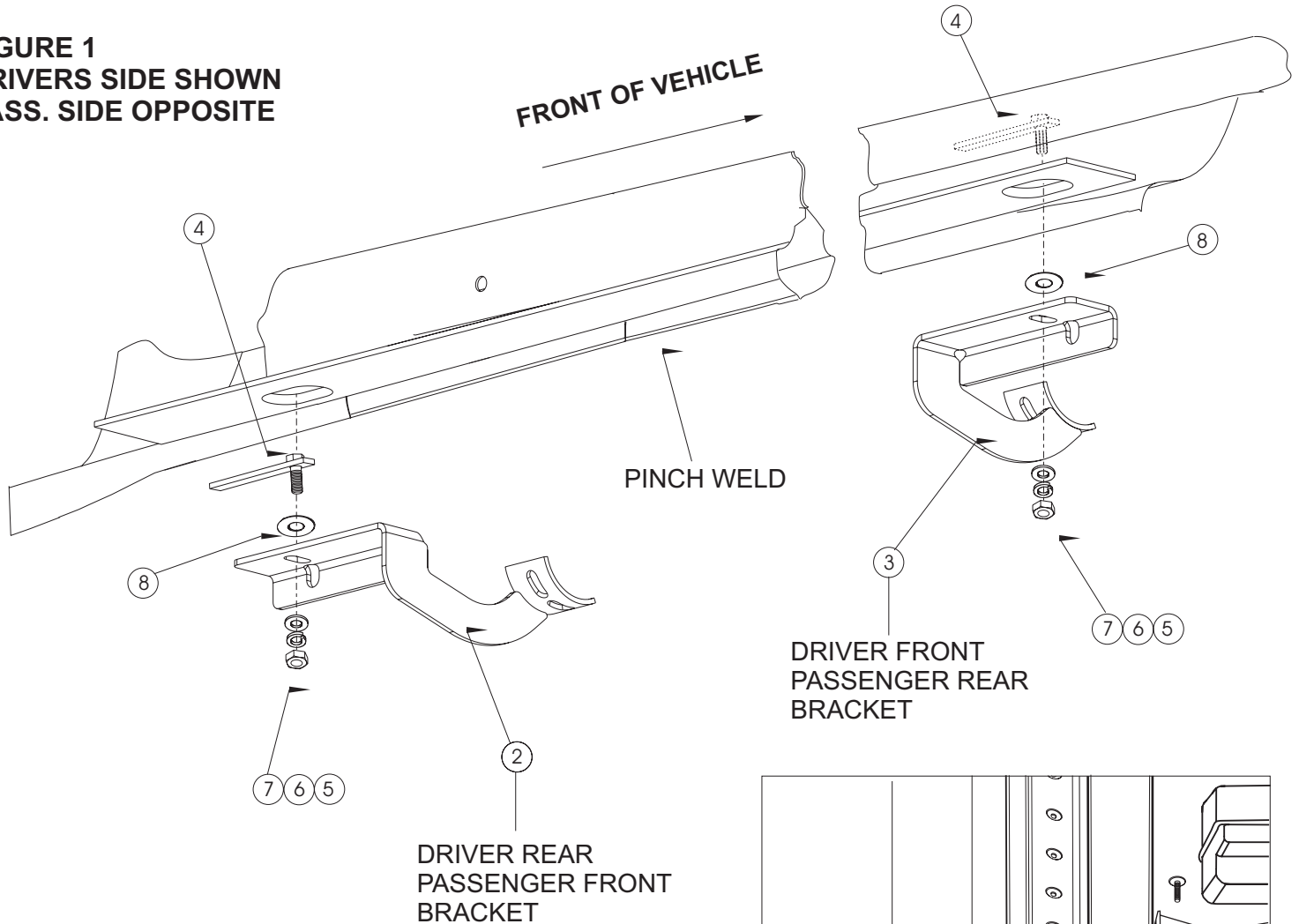

**Accessory Function Check**

**Checklist:** these points **MUST** be checked to insure a quality installation.

<b><u>Check:</u></b>	<b><u>Look for:</u></b>
<input type="checkbox"/> Installation torque 1/2" fasteners	Torque 1/2" fasteners to 65 lbs/ft.
<input type="checkbox"/> Installation torque 3/8" fasteners	Torque 3/8" fasteners to 30 lbs/ft.
<input type="checkbox"/> Step Bar Positioning	Centered on vehicle

**VEHICLE FUNCTION CHECK**

AFTER ALL PANELS, COVERS, AND COMPONENTS HAVE BEEN REINSTALLED, THAT WERE REMOVED, TEST THOROUGHLY, ALL MECHANICAL AND ELECTRICAL COMPONENTS DISCONNECTED AND OR REMOVED FROM THE VEHICLE DURING THE INSTALLATION OF THIS ACCESSORY.