

Fig. A1



Fig. A2



Fig. A3

Care must be taken while installing this accessory to ensure damage does not occur to the vehicle. approved guidelines to insure a quality installation.

These guidelines can be found in the “Accessory Installation Practices” document.

A. Installation Preparation

1. Verify that the part is for the correct vehicle model and that it fits the vehicle properly.
2. During installation, the vehicle, the part, and the tape MUST be between 60° and 110° F for proper adhesion. Failure to maintain proper installation procedure may result in the part not functioning correctly.
3. Inspect the vehicle for damage prior to installing the Fender Flares.
 - i. Paint: Prepare part surfaces per Toyota paint standards. Do not use lacquer thinner or enamel reducer as a degreaser.
4. Install Edge Trim.
 - i. Peel red plastic liner from adhesive strip. (Fig. A1)
 - ii. Apply to the edge of the flare, starting at one end of the outside of the flare and working to the other. (Front: 78” piece, Rear Main: 44” piece; see iii for Door Piece). (Fig. A2)
 - iii. Apply to the edge of the Door Piece, starting at one end of the outside and working to the other. Stop edge trim at bottom edge of door. (Door Piece: 34” piece). (Fig. A2 & A3)



Fig. A4



Fig. A5



Fig. A6

5. Make sure that all Front Flare, Rear Main Flare, and Rear Door Piece installation surfaces are free of dirt and/or grease. (Fig. A4, A5, A6)
 - i. Use a clean, lint-free cloth and isopropyl alcohol-based cleaner.



Fig. B1



Fig. B2



Fig. B3



Fig. B4

B. Install Front Flare

1. Hold the flare firmly on the fender. Using three forward holes in the flare as a guide, mark three clip locations with a grease pencil. (Fig. B1 and B2)
2. Remove flare from fender. Center a supplied Black Tab over each mark made in Step 1. (Fig. B3)
3. Slide a supplied "S" Clip over each Tab. (Fig. B4)
4. Replace flare on fender, aligning holes with holes in clips. (Fig. B5)
5. Start supplied Truss-Head Screws through three rear holes in flare and into factory holes in rear of wheel well. (Fig. B6)



Fig. B5



Fig. B6



Fig. B8



Fig. C1



Fig. C2

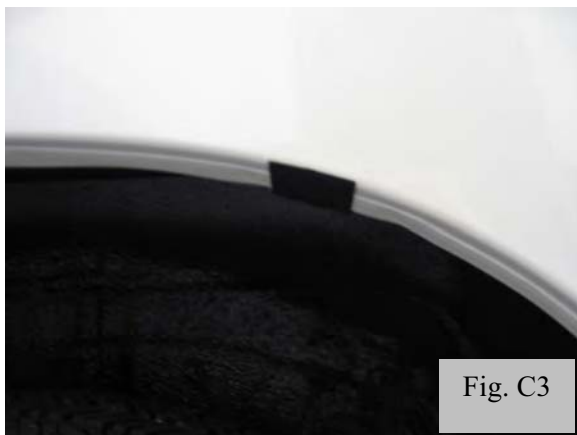

Fig. C3

6. Start supplied Serrated-Flange Screws through three forward holes in flare and into the "S" Clips installed in Step 6. (Fig. B8) Using a Right-Angle or Stubby Phillips #2 Screwdriver, tighten all screws.

C. Install Rear Main Flare

1. Hold the flare firmly on the fender. Using holes in the flare as a guide, mark four Clip locations with a grease pencil. (Fig. C1 and C2)
2. Remove flare from fender. Center a supplied Black Tab over each mark made in Step 1. (Fig. C3)
3. Slide a supplied "S" Clip over each Tab. (Fig. C4)

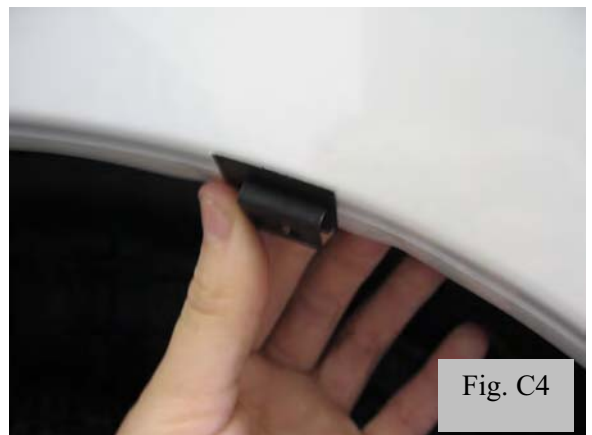

Fig. C4



Fig. C5



Fig. C6

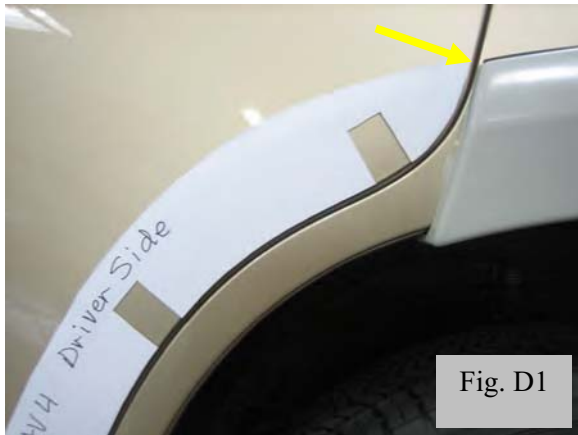

Fig. D1



Fig. D2

4. Replace flare on fender, aligning holes with holes in clips. (Fig. C5)
5. Start supplied Serrated-Flange Screws through holes in flare and into the "S" Clips installed in Step 4. (Fig. C6) Do not tighten screws until after the Door Piece is installed.

D. Install Rear Door Piece

1. For DIO installation cut out paper door template, attach the pieces together using the instructions listed on pages 9~11 by aligning the top edge with the previously installed rear flare. Fig. D1
2. For PIO installation align the top edge of the magnetic template with previously installed rear flare. Fig. D1
3. Attach one black plastic tab to the vehicle door on each of the 4 corresponding locations found on the template. Fig. D2
4. Assemble the clip. (Fig. D3)
5. Install the clip over the black tabs. (Fig. D4)



Fig. D3



Fig. D4



Fig. D5



Fig. D6

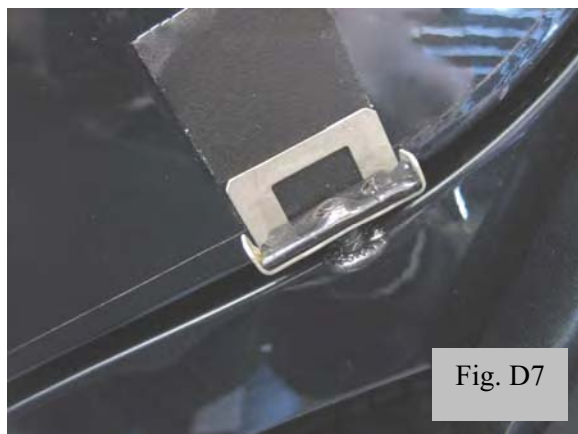

Fig. D7



Fig. D8

6. Press clip into place. (Fig. D5)
7. Use pliers to secure the clip to the sheet metal. (Fig. D6)
8. Hand start screws through each clip. The end of the shaft should be flush with the uppermost edge of the clip (Fig. D7).
9. Hold Door Piece in place with a clamp between the two center locations to apply preload such that plastic is fully set in the clip. Tighten screws in locations immediately to either side of the clamp. Once center two screws are installed, move the clamp up near the top location for the upper screw installation and to the lower location for lower screw installation. (Fig. D8)
10. Tighten screws using #2 Phillips bit and small ratchet. (Fig. D9, the clamp was removed from the picture to better show the tools)



Fig. D9



Audit Criteria

Check: _____

Rear Door Swing

Verify Tape Adhesion

Verify appearance.

Look For: _____

Door Flare should not contact Rear Quarter Panel Flare

1mm gap between the screw and the flare will be acceptable. The screw must be tight though.

Minor gouges will be acceptable in the fender well area only. They must be touched up.

Note: The template should fit the door, if it doesn't then a scaling error probably occurred during printing.

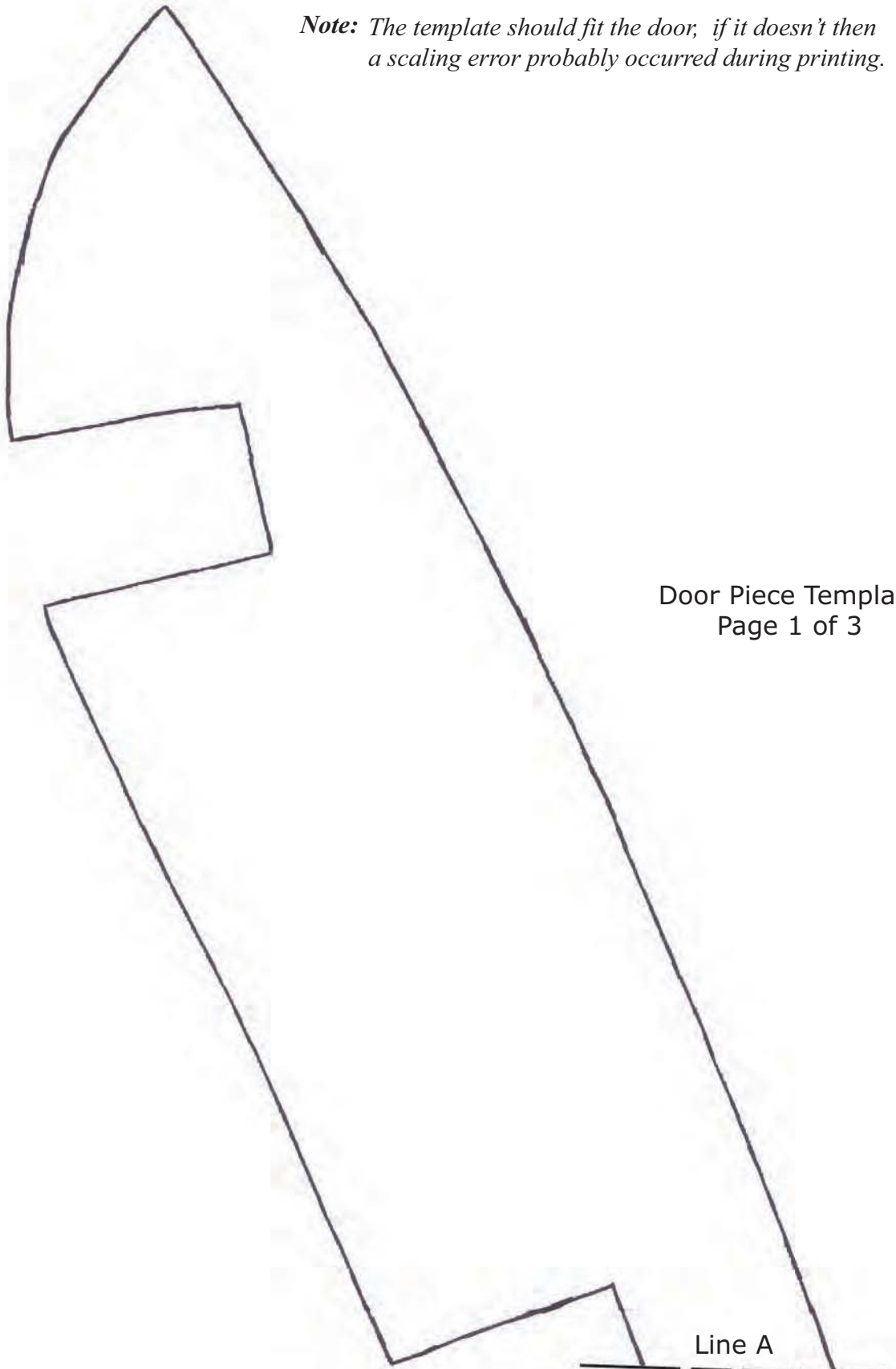

Door Piece Template
Page 1 of 3

Line A
This line must overlap line A
of page 2 of 3.

This line must overlap line A
of page 1 of 3.

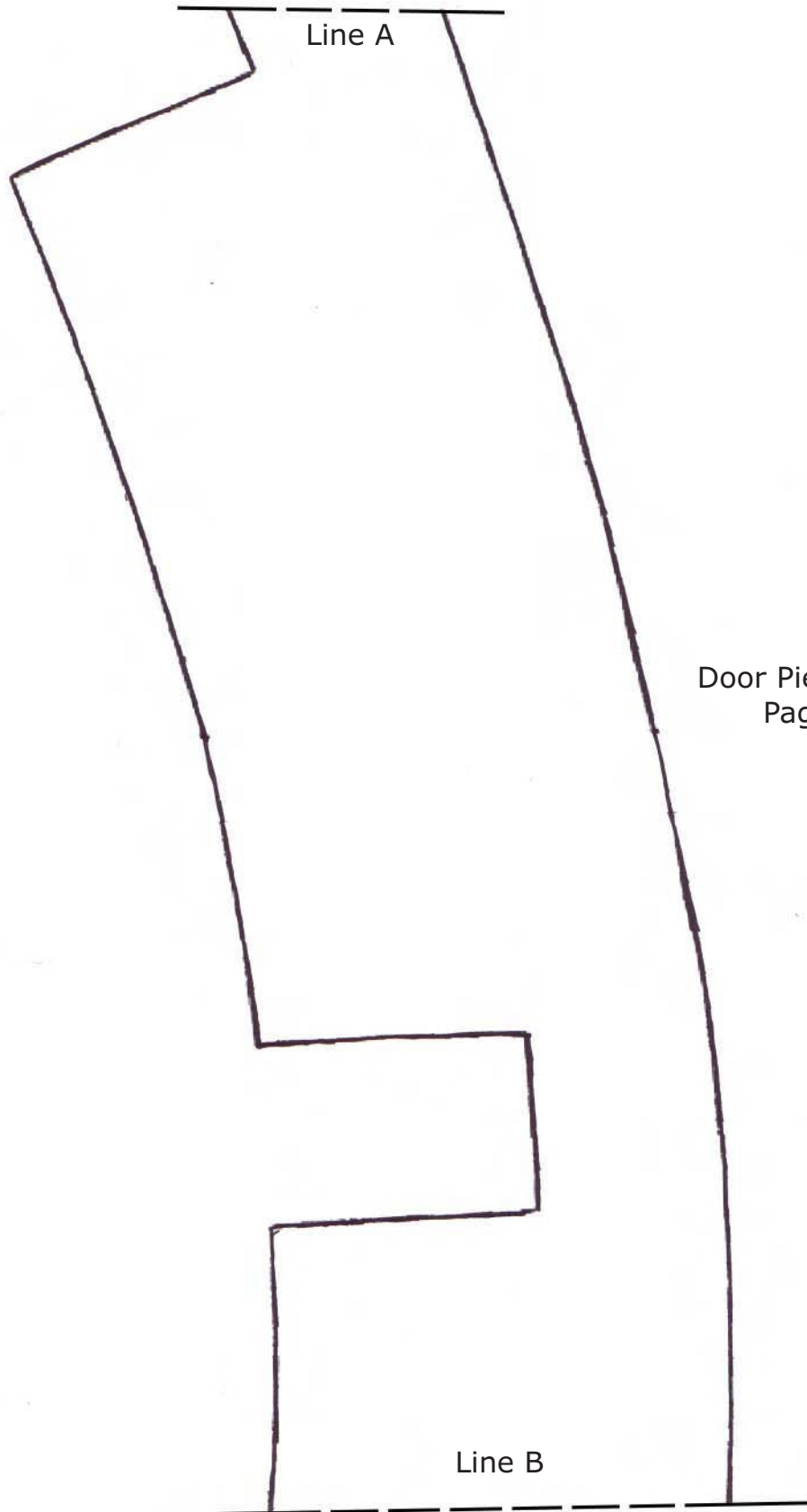

Door Piece Template
Page 2 of 3

This line must overlap line B
of page 3 of 3.

This line must overlap line B
of page 2 of 3.

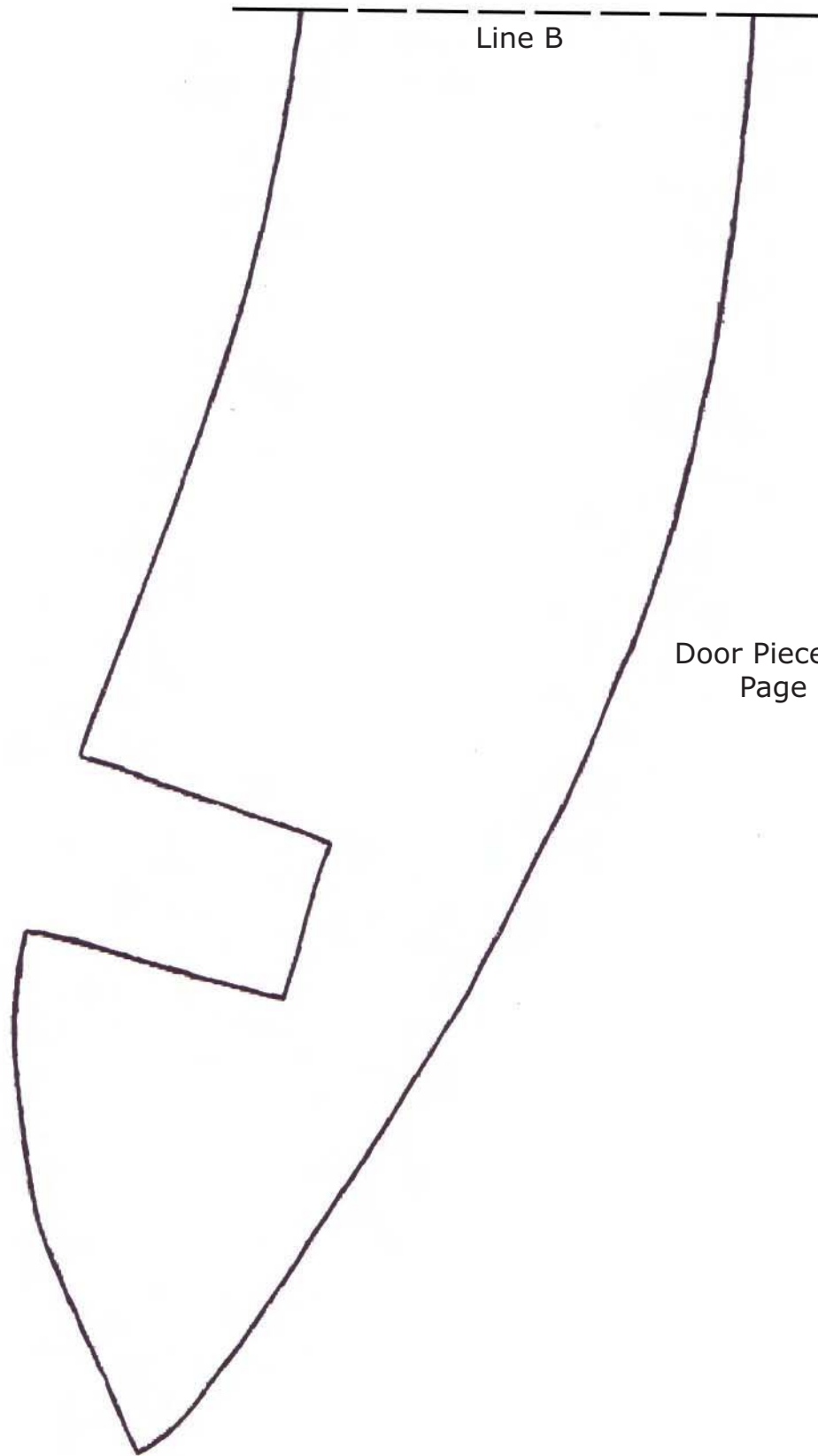

Door Piece Template
Page 3 of 3