

TOYOTA TACOMA

2007-

SPORT EXHAUST

Section I - Installation Preparation

Part Number: 00016-35600 Long Bed

00016- 35650 Short Bed

Code: EX 1

Section I – Installation Preparation



Kit Contents

Item #	Quantity Reqd.	Description
1	1	Front Pipe
2	1	Intermediate Pipe
3	1	Muffler Assembly
4	1	Tail Pipe Assembly
5	3	2.25" Clamps
6	1	Air Filter
7		
8		

Hardware Bag Contents

Item #	Quantity Reqd.	Description
1		
2		
3		
4		
5		
6		
7		
8		

Additional Items Required For Installation

Item #	Quantity Reqd.	Description

Conflicts

Note:

Recommended Tools

Safety Tools	
Safety Glasses	
Special Tools	
Installation Tools	
3/8" Drive Ratchet	
3/8" Drive Extension (3 in.)	
15 mm Socket	
Pry Bar	
Flat Blade Screwdriver	
Torque Wrench (35 ft. lbs.)	
Special Chemicals	
Silicone Spray Lubricant	

Color Applicability/Trim Level

Accessory Color	Vehicle/Trim Color																		

General Applicability





--

Recommended Sequence of Application

Item #	Accessory	
1		
2		
3		

*Mandatory

Legend

-  **STOP:** Damage to the vehicle may occur. Do not proceed until process has been complied with.
-  **OPERATOR SAFETY:** Use caution to avoid risk of injury
-  **CRITICAL PROCESS:** Proceed with caution to ensure a quality installation. These points will be audited on a completed vehicle installation
-  **TOOLS & EQUIPMENT:** This calls out the specific tools and equipment required for this process
-  **REVISION MARK:** This mark highlights a change in installation with respect to previous issue.

SPECIAL NOTE: Installation Sequences

After TMS and Safety mandated preparatory steps have been taken, the installation sequence is the suggested method for completing the accessory installation. In some instances the suggested sequence is written for one associate to install and in others the sequence is given as part of a team accessory installation. Unless otherwise stated in the document, the associates may perform the installation steps in any order to make the installation as efficient as possible while maintaining consistent quality.

This Toyota Performance Exhaust System has been designed for the 2007 Toyota Tacoma Double Cab, short bed equipped with a 4.0L V-6 engine and automatic or manual transmissions.



Caution!!! Never work on a hot exhaust system. Serious injury in the form of burns can result If the vehicle has been in use and the exhaust system is hot, allow vehicle to cool for at least 1 hour. Always wear eye protection when working under any vehicle.

Note: It is our recommendation that you use a hoist or hydraulic lift to facilitate the installation of your new performance exhaust system.

Taking all under car safety precautions, lift the vehicle using a hoist or hydraulic lift. Once this has been done, you may begin the removal of your old exhaust system from your vehicle.

Note: Before removing the original exhaust system from your vehicle, please compare the parts you have received with the bill of materials provided on the next page to assure that you have all the parts necessary for the installation of your new Performance Exhaust System.

Performance Cat-Back Bill of Materials

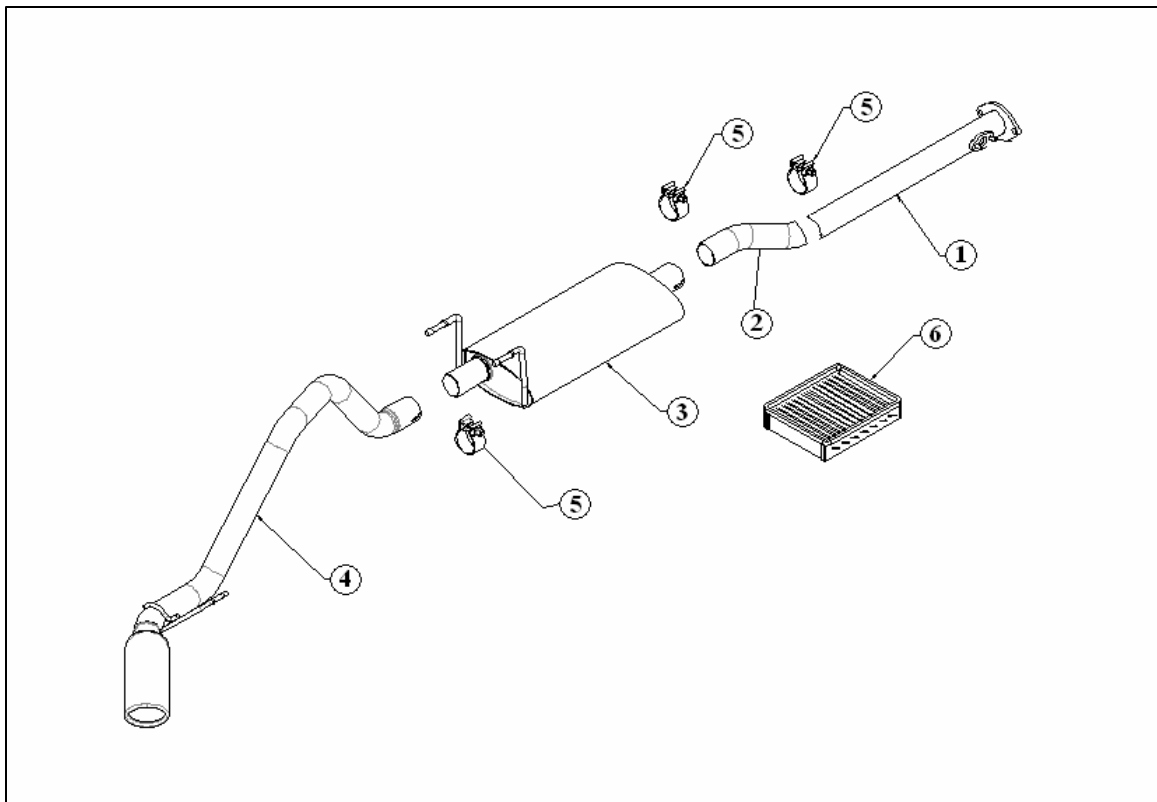

1. Front pipe
2. Intermediate pipe
3. Muffler assembly
4. Tail pipe assembly
5. 2.25" clamp (qty 3)
6. Air Filter

Original Exhaust System Removal

- 1. Unbolt the flange shown in figure 1 located behind the catalytic converters. Place the hardware to the side for use during the installation of your new exhaust system.*
- 2. Lubricate all the hangers and rubber isolators.*
- 3. Using a muffler stand or an additional person to hold the exhaust up in place, remove the hangers from the rubber isolators and then remove the exhaust system as shown in figure 2.*

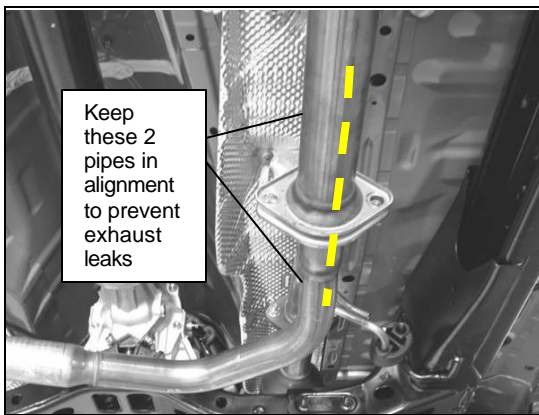

Figure 1



Figure 2

Toyota Performance Exhaust System Installation

1. Using the original hardware, place the front pipe in position as shown in figure 3. Hand tighten the hardware for now.
2. Place a clamp over the expanded end of intermediate pipe and set it into position as shown in figure 4. **Do Not** tighten the clamp.



Figure 3



Figure 4

3. Place a clamp over the expanded end of the muffler assembly and set it up into position as shown in figure 5 installing the hangers into the rubber isolators. **Do Not** tighten the clamp.
4. Place a clamp over the expanded end of the tail pipe assembly and set it up into position as shown in figure 6 installing the hanger into the rubber isolator. **Do Not** tighten the clamp.



Figure 5



Figure 6



5. Check your exhaust system for proper clearance under the vehicle by pulling downward. Verify correct positioning and adequate clearance between exhaust tip & rear fender.



6. Adjust exhaust pipe as necessary once properly positioned, hold exhaust in place and tighten clamps to 35ft. pds. and release. 



7. Tighten the flange hardware and torque to 35 ft lbs.
Note: Ensure that all fasteners & clamps are properly tightened to 35ft.lbs during the installation process only.



8. Before starting your vehicle, make sure to check all wires, hoses, brake lines, body parts and tires for safe clearance from the exhaust system.



9. Start vehicle and check for any leaks. If any leaks are found, determine cause (such as loose or incorrectly positioned clamp) and repair as necessary.



10. Install new re-usable air filter and place stucked on top side of cover.

Note: When you first start your vehicle after the installation of your new Performance Exhaust System, there may be some smoke and fumes coming from the system. This is a protective oil based coating used in the manufacturing of mandrel bent performance exhaust tubing. This is not a problem and will disappear within a very short period of time after the exhaust has reached normal operating temperatures.

