



Southeast Toyota Distributors, LLC

## Southeast Toyota Distributors, LLC Accessory Installation Instructions

### 2020 AVALON TOUCH KEYPAD

Year & Model:	2020 AVALON
Part Number:	00016-00506
Accessory Code:	KP1010
PIO / DIO:	PIO & DIO
Business Partner:	J56

### Conflicts

Note: None

### General Applicability

Fits Models:	
1.	All Models
2.	
3.	

### Additional Items Required For Installation

Item#	Description:
1	6221711020; (2) A-Pillar Clips Needed
2	

### Sequence of Application

Item#	Accessory:
1	N/A
2	

**SPECIALNOTE: Installation Sequences**  
After TMS & Safety mandated preparatory steps have been taken, the installation sequence is the suggested method for completing the accessory installation. In some instances the suggested sequence is written for one associate to install & in others the sequence is given as part of a team accessory installation. Unless otherwise stated in the document, the associates may perform the installation steps in any order to make the installation as efficient as possible while maintaining consistent quality.

### Recommended Tools

<b>Safety Items</b>	
Safety Glasses	Safety Gloves
<b>Special Tools</b>	
Back housing Alignment Tool	Windshield QC Scale
Temperature probe /Heat Gun	
<b>Installation Tools</b>	
Heat Source	For Temperatures under 50°F
Molding Remover	Pliers
Ratchet/Driver	Side Cutters
Socket (10mm)	Torque Wrench (48 in*lbs.)
Masking Tape	Small Flat Head (Taped)
Roller	Felt Block
Padded Work Surface	Protective Blanket
<b>Special Chemicals</b>	
VPC Approved Cleaner	

### Legend

	<b>STOP:</b> Damage to the vehicle may occur. Do not proceed until process has been complied with.
	<b>OPERATOR SAFETY:</b> Use caution to avoid risk of injury.
	<b>CAUTION:</b> A process that must be carefully observed in order to reduce the risk of damage to the accessory/vehicle and to ensure a quality installation.
	<b>TOOLS &amp; EQUIPMENT:</b> Used in figures calls out the specific tools and equipment recommended for this process.
	<b>REVISION MARK:</b> This mark highlights a change in installation with respect to previous issue.
	<b>SAFETY TORQUE:</b> This mark indicates that torque is related to safety.
	<b>REGULATORY MARK:</b> This mark indicates that the component is related to regulatory compliance.
	<b>VIDEO:</b> This image indicates a video to show a installation procedure, PIO Only.

**Table of Contents**

---

I.	Preparation...	1-5
a.	Table of Contents...	2
b.	Kit/Hardware & Wire Harness Bag Contents .....	3
c.	Parts for Installation...	4
d.	Service & Warranty Information.....	5
II.	Procedures	
a.	Battery Removal.....	6
b.	Vehicle Disassembly – Installation Process.....	7-35
III.	Re-install Battery... ..	36
IV.	Function and Quality Checks... ..	37-38
V.	Diagnostic / Block Diagrams & Connector Procedures.....	39-41
VI.	Blank Page.....	42
VII.	Warranty Statement.....	43-44

**Kit/Hardware Bag Contents:**

Item #	Quantity	Description
1.	1	TKP Overmold with Molex 5-pin Harness
2.	1	Keypad Button Graphic Sticker
3.	1	TKP Vehicle Harness
4.	3	RED Female T-Taps
5.	3	BLACK Female T-Taps
6.	6	Zip Ties 8"
7.	1	DLC Power & Ground Jumper
8.	1	TKP User Manual
9.	1	TKP Seat Headrest Hangtag

**Kit/Hardware Bag Contents for DIO:**

Item #	Quantity	Part Number	Description
1.	1	00016-00506-DK	Installation Tool Kit
2.	1	00016-00506-DL	DIO-Touch Key Pad Kit
3.	10	00016-00506-BS	DIO-X10 Stickers



Item 1.



Item 2.



Item 3.

### Parts for Installation:

Care must be taken when installing this accessory to ensure damage does not occur to the vehicle. The installation of this accessory should follow approved guidelines to ensure a quality installation. These guidelines can be found in the “Accessory Installation Practices” document.

This document covers such items as:

- Vehicle Protection (use of covers and blankets, cleaning chemicals, etc.).
- Safety (eye protection, re-checking torque procedure, etc.).
- Vehicle Disassembly/ Reassembly (panel removal, part storage, etc.).
- Electrical Component Disassembly/Reassembly (battery disconnection, connector removal, etc.).

Item #	Quantity	Description
1.	1	TKP Overmold with Molex 5-pin Harness
2.	1	Keypad Button Graphic Sticker
3.	1	TKP Vehicle Harness
4.	3	RED Female T-Taps
5.	3	BLACK Female T-Taps
6.	6	Zip Ties 8"
7.	1	DLC Power & Ground Jumper
8.	1	User Manual
9.	1	Seat Headrest Hangtag

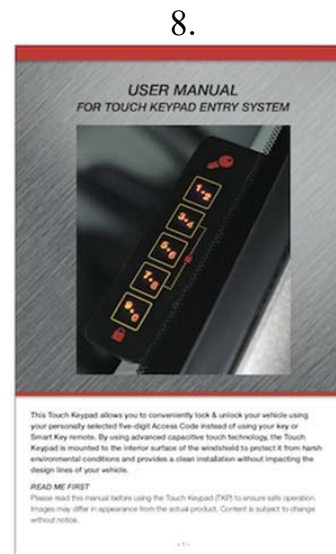
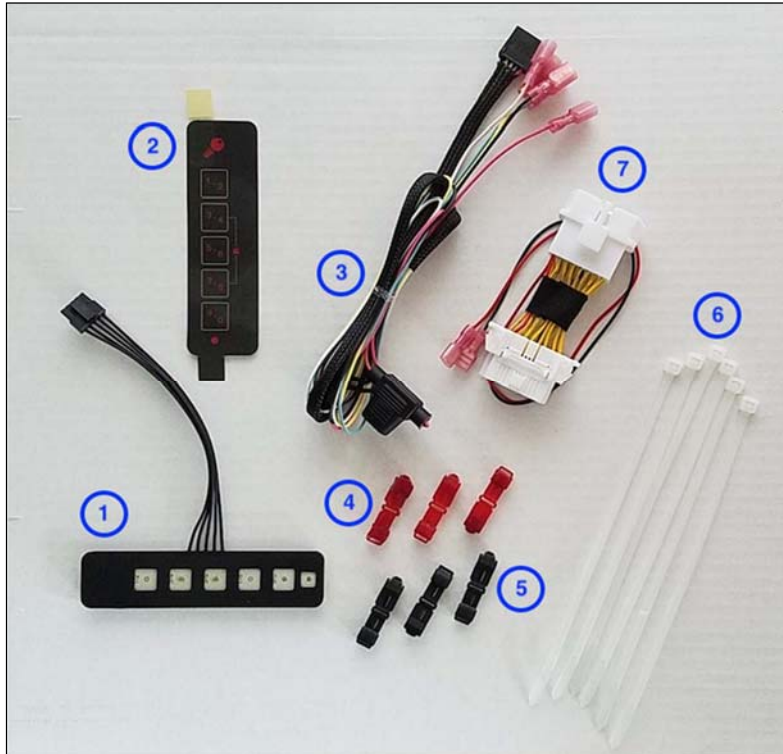



**Service & Warranty Information**

Image Key	Parts information		Warranty Information	
	Part Number	Description	Warranty Time	Labor Op. Code
N/A	00016-00506	Touch Keypad	N/A	N/A
A	00016-00505-01	TKP REPLMNT KEYPAD	0.5	ATK001
B	00016-00505-02	TKP WIRE HARNESS	0.5	AHAR05
C	00016-00555	DLC P&G JUMPER 16PIN	0.5	ATK001

Note: Replacement keypad (Item A) includes two stickers. Wire harness (Item B) includes zip ties and t-taps.

**Service & Warranty Information:**

If you are a dealer located outside of the Southeast Region, please contact the SET Accessory Warranty Department at (888) 851-2722 or email [Accessory.Warranty@SEToyota.com](mailto:Accessory.Warranty@SEToyota.com) for claim payment instructions.

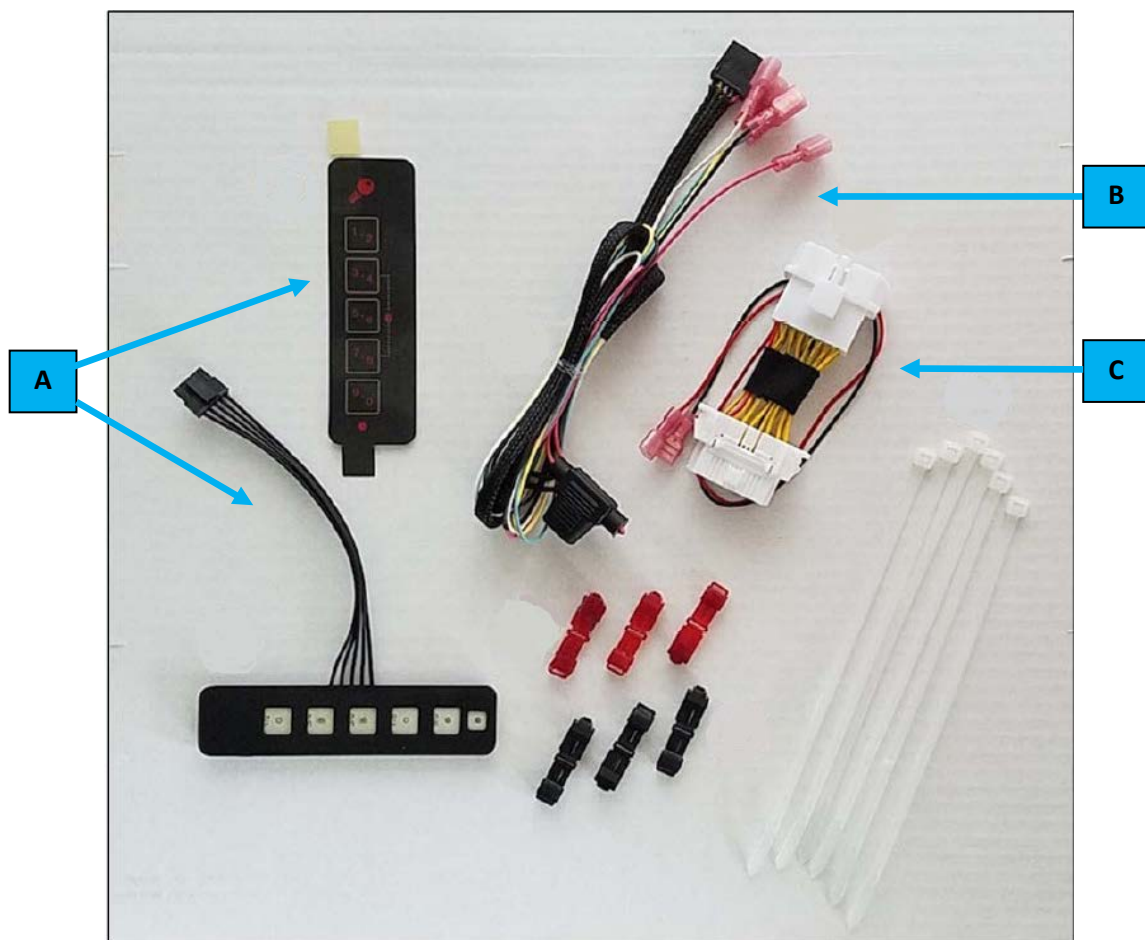
**Image:**

*Figure 1-1*

## 1. BATTERY REMOVAL

Prepare for the Installation:

- (a) The engine components and coolant may be hot.
- (b) Check the kit for contents and any damage.
- (c) Protect the fender.

*Figure 1-2*

**Do not disconnect terminal at the 12mm nut .**



**Use 10mm socket.**



**Do NOT touch the positive terminal.**

**Wait at least 90 seconds after.**

**Disconnect the cable from the negative(-) battery terminal to disable the SRS system.**

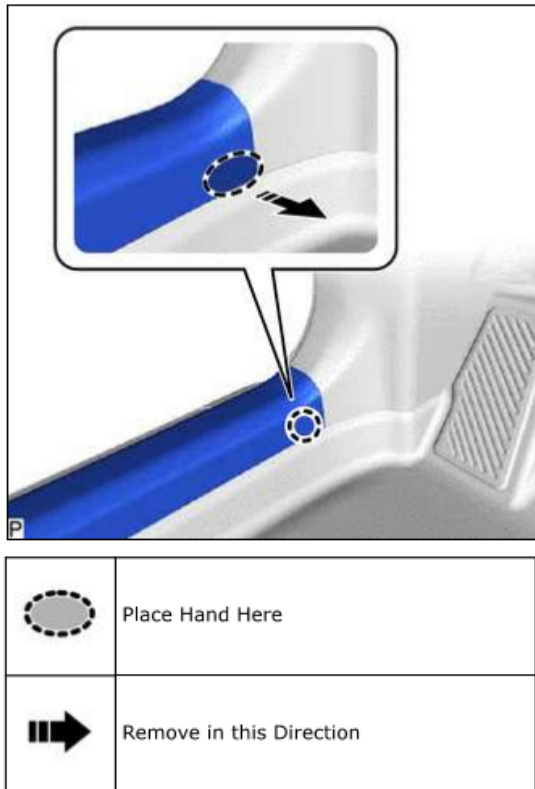
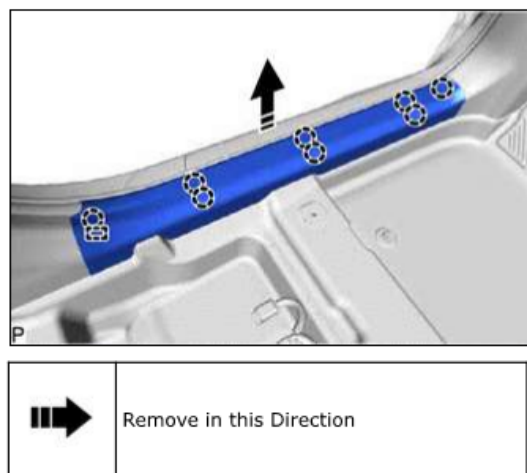
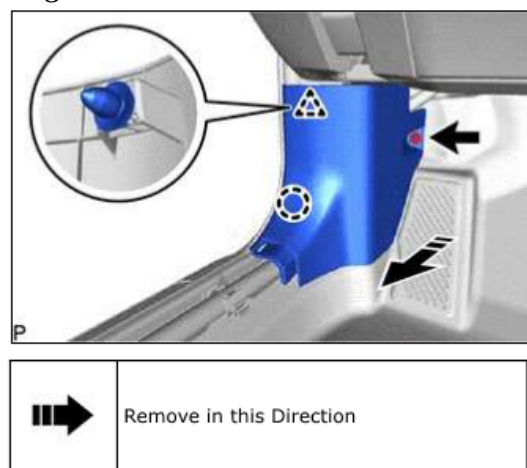
**Figure 2****Figure 3****Figure 4**

## VEHICLE DISASSEMBLY- INSTALLATION PROCESS



Place a protective blanket in the front footwell area.

### 2. REMOVE FRONT DOOR SCUFF PLATE LH.

(a) Disengage the 8 claws and guide to remove the front door scuff plate LH as shown in Figure 2 and Figure 3 .

### 3. REMOVE COWL SIDE TRIM SUB-ASSEMBLY LH

(a) Remove the clip.

(b) Disengage the claw and clip to remove the cowl side trim sub-assembly LH as shown in Figure 4.

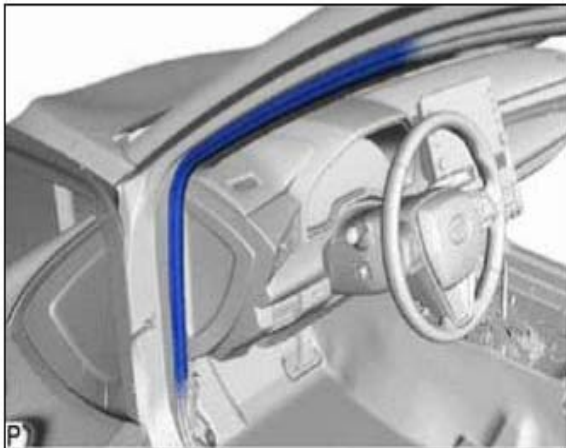
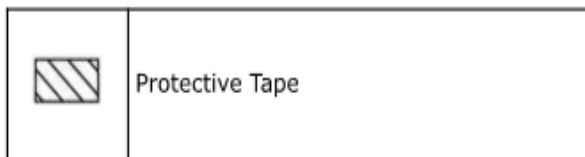
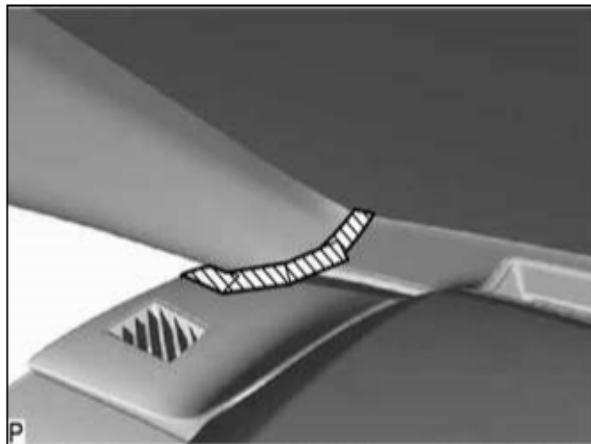

**Figure 5**

**4 REMOVE FRONT DOOR OPENING TRIM WEATHERSTRIP LH**

(a) Disconnect the front door opening trim weatherstrip LH.

Figure 5.



**Figure 6**

**5. REMOVE FRONT PILLAR GARNISH LH**

(a) Apply protective tape around the front pillar garnish LH as shown. Figure 6.

(b) Pull the upper part of the front pillar garnish LH towards the inside of the cabin and disengage the front pillar garnish LH from the base of the 2 front pillar garnish clips. Figure 6

**HINT:**

Let the front pillar garnish LH hang from the front pillar garnish clips.

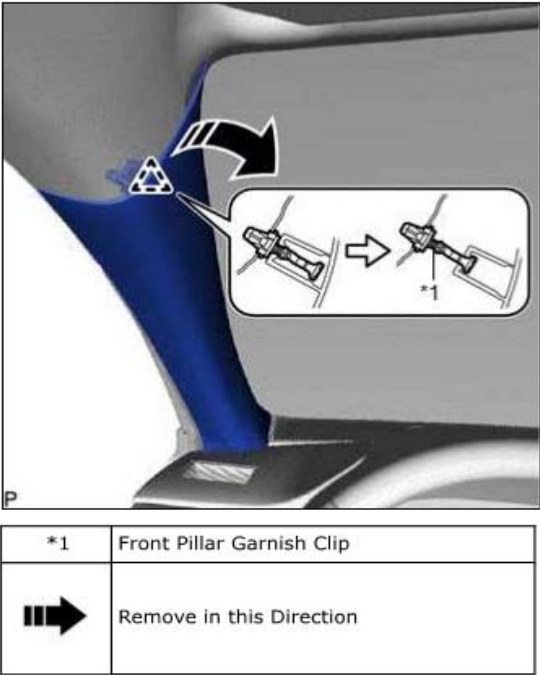

Figure 7

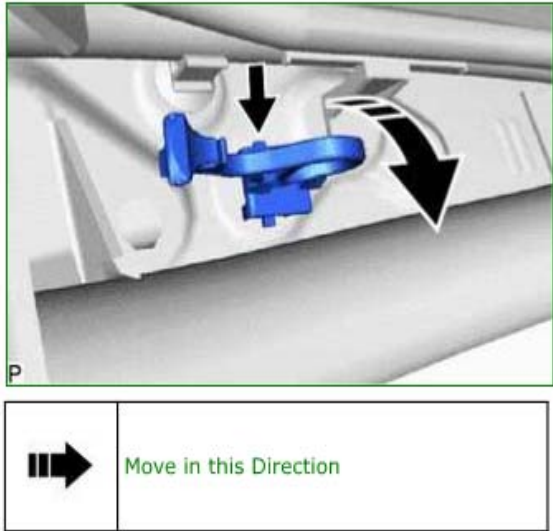

Figure 7-1

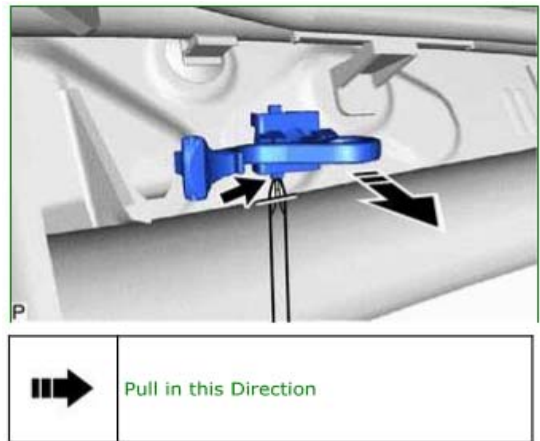

Figure 7-2

(c) While pushing the tabs of the front pillar garnish clip as shown in Figure 7, disengage it.

HINT: When the front pillar garnish clip cannot be disengaged easily:

1. while pushing the tab of the front pillar garnish clip shown in the illustration with your finger, move the front pillar garnish clip in the direction shown in the illustration.  
Figure 7

2. while pulling the front pillar garnish clip as shown in the illustration, push the tab of the front pillar garnish clip shown in Figure 7-1 with a screwdriver and disengage the front pillar garnish clip.  
Figure 7-1

(d) Disengage the front pillar garnish LH from the base of the front pillar garnish clip. Figure 7-2

Both A-Pillar Clips Must Be Replaced.  
Part Number: (2) 6221711020



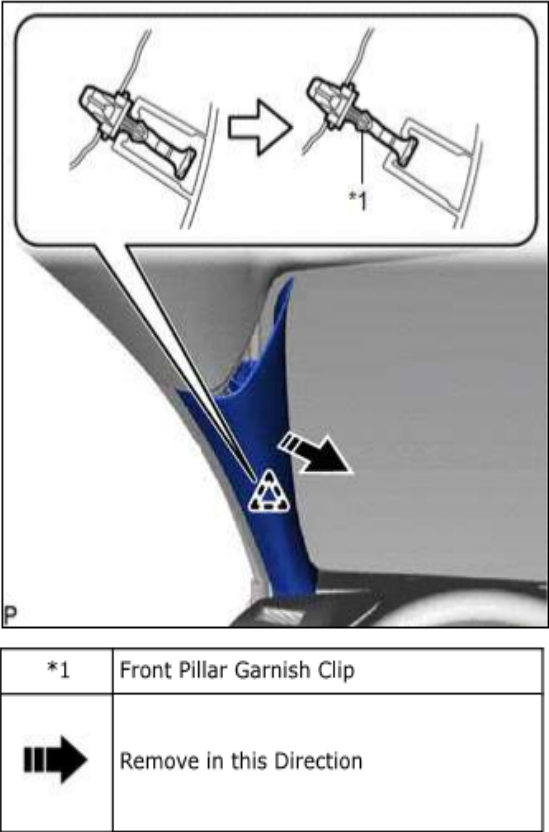

Figure 8

(e) while pushing the tabs of the front pillar garnish clip as shown in the illustration, disengage it.  
Figure 8

**HINT:**  
When the front pillar garnish clip cannot be disengaged easily:

1. While pushing the tab of the front pillar garnish clip shown in the illustration with your finger, move the front pillar garnish clip in the direction shown in the Figure 8

2 While pulling the front pillar garnish clip as shown in the illustration, push the tab of the front pillar garnish clip shown in the illustration with a screwdriver and disengage the front pillar garnish clip.  
Figure 8

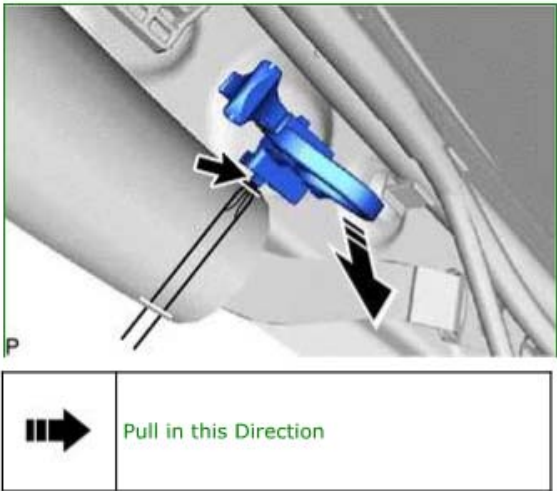



Figure 8-1

**W/O Front No. 3 speaker**

(f) Disengage the 2 guides to remove the front pillar garnish LH as shown in the illustration. Figure 8-1

 **Both A-Pillar Clips Must Be Replaced.  
Part Number: (2) 6221711020**

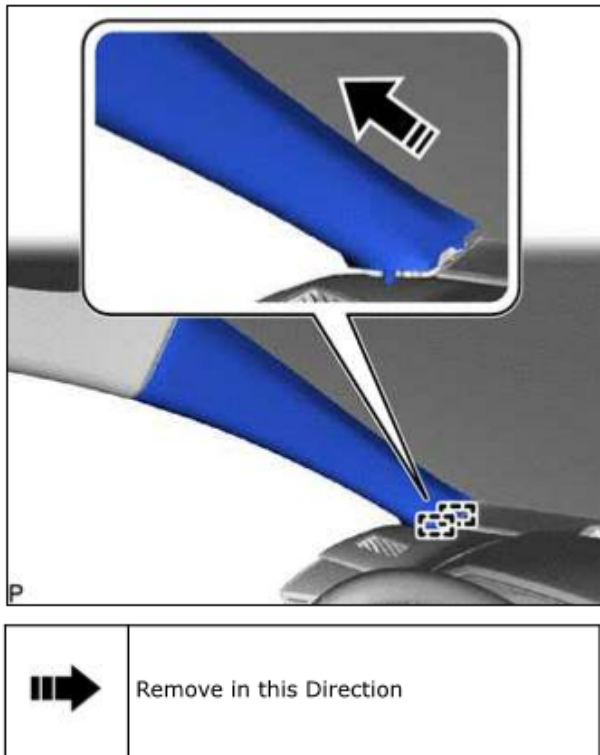

**Figure 9**

(g) W/ Front No. 3 Speaker.

(1) Disengage the 2 guides as shown. Fig. 9

(2) Disconnect the connector to remove the front pillar garnish LH

(h) Remove the 2 front pillar garnish clips from the front pillar garnish LH. Figure 9

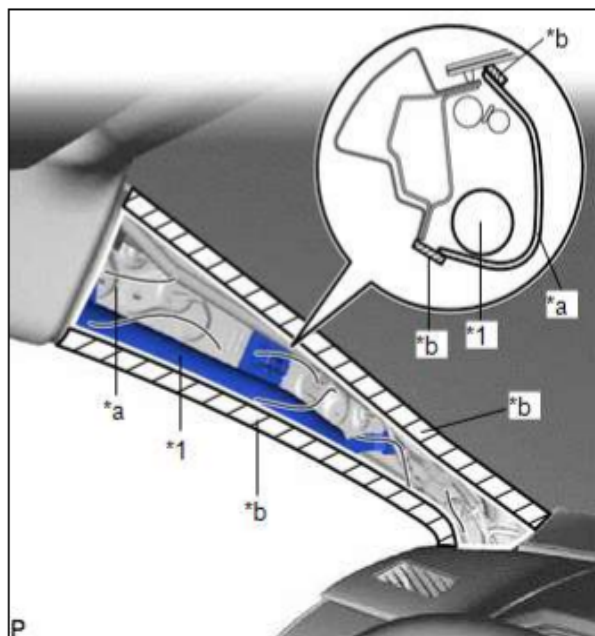

(i) Protect the curtain shield airbag assembly. Figure 10

*1	Curtain Shield Airbag Assembly LH
*a	Protective Cover
*b	Adhesive Tape

**Figure 10**

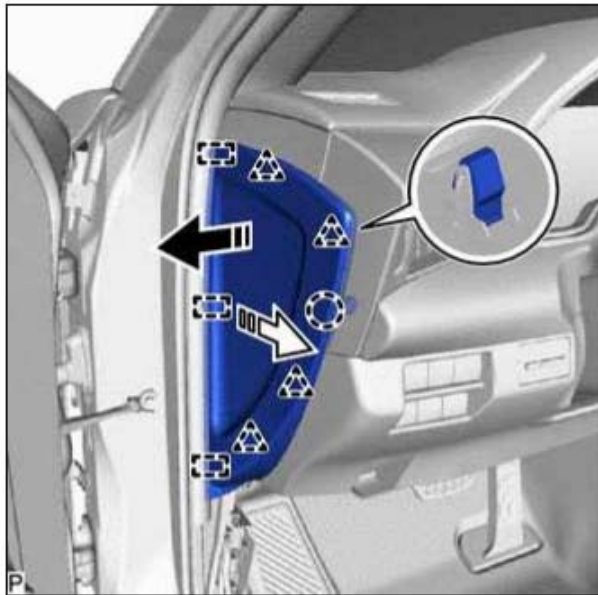

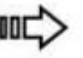
	Remove in this Direction (1)
	Remove in this Direction (2)

**Figure 11**

## 6. REMOVE INSTRUMENT SIDE PANEL LH

(a) Pull the instrument side panel LH in the direction indicated by the arrow (1) shown in Figure 11 disengage the claw and 4 clips.

(b) Pull the instrument side panel LH on the direction by the arrow (2) shown in the illustration to disengage the 3 guides and remove it.

Figure 11

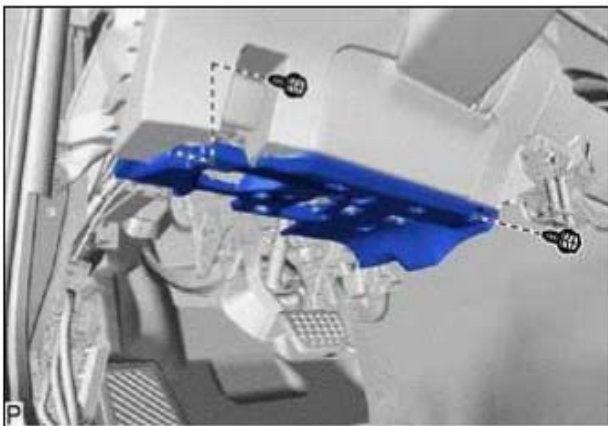
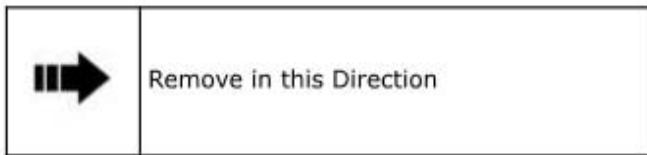
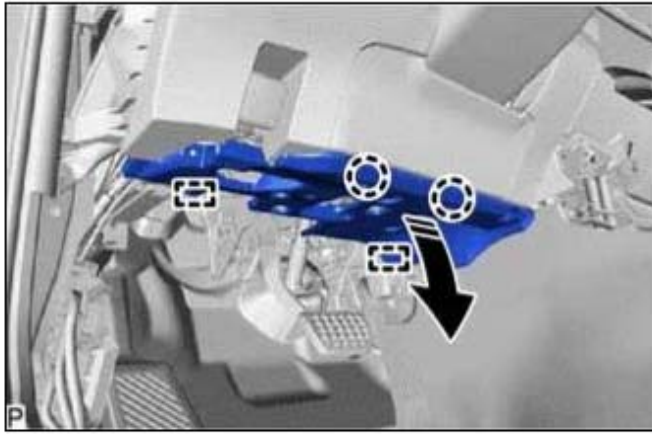

**Figure 12**

## 7. REMOVE NO 1 INSTRUMENT PANEL UNDER COVER SUB-ASSEMBLY

(a) Remove the 2 screws.

Figure 12



(b) Disengage the 2 claws and 2 guides as shown in the Figure 13.

*Figure 13*



(c) Disengage the 2 claws to disconnect the DLC3 connector. Figure 14

*Figure 14*

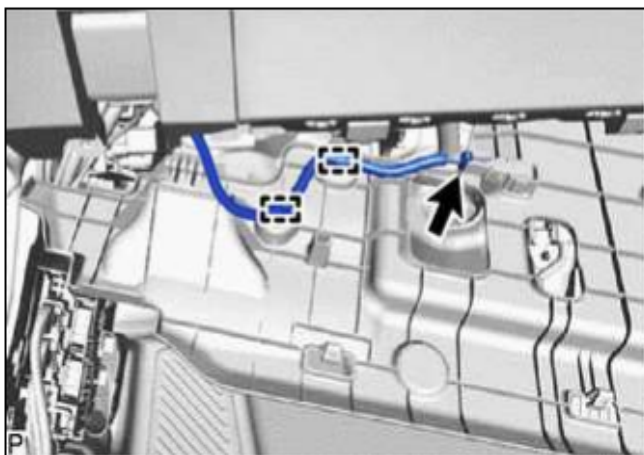

(d) Disconnect the connector and disengage the 2 clamps to remove the No. 1 instrument panel under cover sub-assembly. Figure 15

*Figure 15*

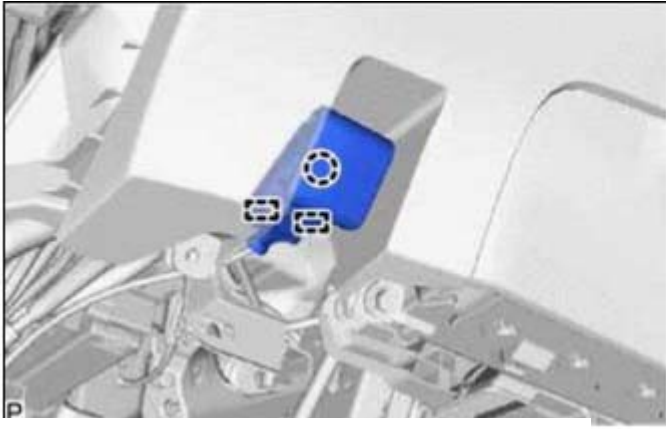

**Figure 16**

## 8. DISCONNECT HOOD LOCK CONTROL LEVER SUB-ASSEMBLY

(a) Disengage the claw and 2 guides to disconnect the hood lock control lever sub-assembly. Figure 16

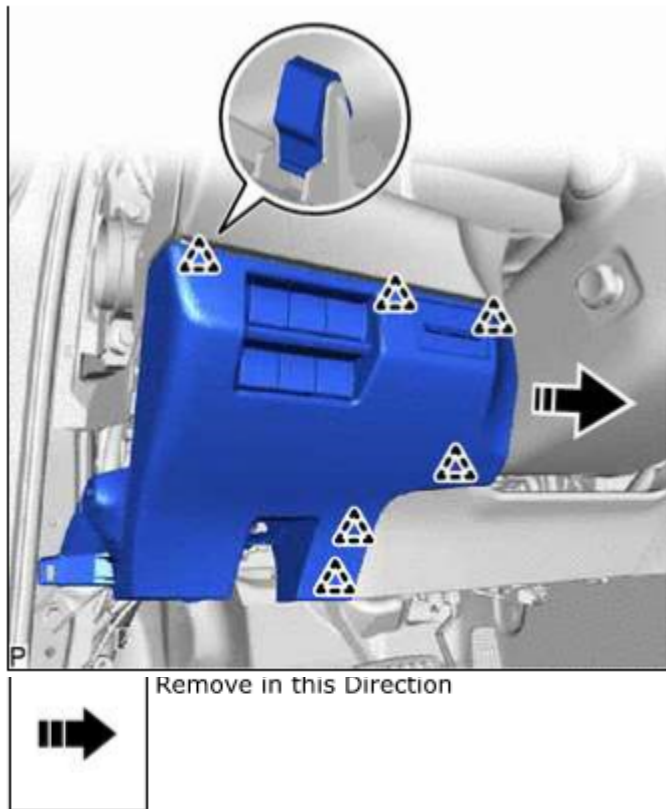

**Figure 17**

## 9. REMOVE NO. 1 INSTRUMENT PANEL SUB-ASSEMBLY

(a) Disengage the clips as shown in Figure 17.

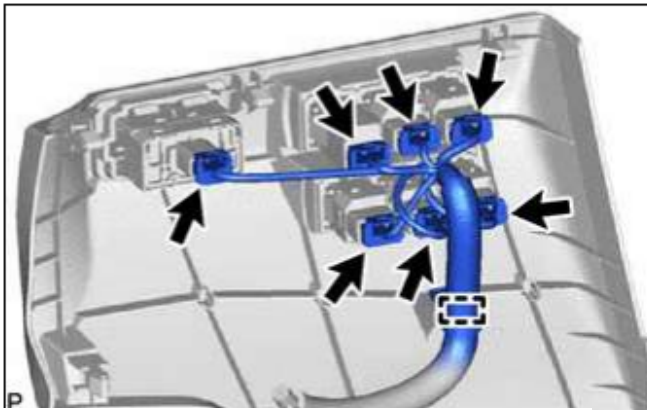
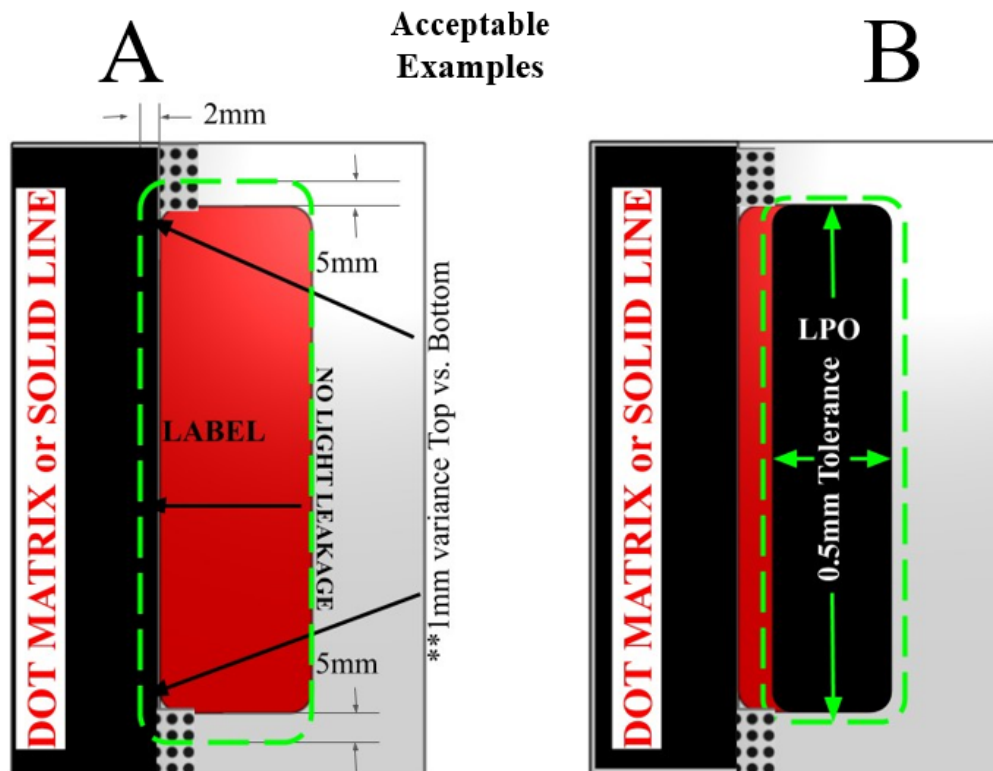

**Figure 18**

(b) Disengage the clamp Figure 18.

### BUTTON STICKER & BACKHOUSING APPEARANCE STANDARDS

#	Inspection Item	OK Criteria	Photo Reference
1	Window Label Vertical Alignment	<ul style="list-style-type: none"> <li>+/- 5mm from target</li> </ul>	A
2	Window Label Horizontal Alignment	<ul style="list-style-type: none"> <li>+/- 2mm from target</li> <li>No light leakage between Label &amp; Solid Black Out.</li> <li>Dot Matrix +/- 0.5mm</li> </ul>	A
3	LPO Vertical & Horizontal Alignment	<ul style="list-style-type: none"> <li>+/- 0.5mm from target</li> </ul>	B
4	Window Label Visual Defects	<ul style="list-style-type: none"> <li>Viewed from a customer viewing angle of 18 inches.</li> </ul>	C, D, E, F, G
5	Visual Defect White Blotch Glue Wet Out	<ul style="list-style-type: none"> <li>3 PCS +/- 0.5mm</li> </ul>	
6	Dust/Dirt/Seed	<ul style="list-style-type: none"> <li>1 PCS +/- 1mm</li> </ul>	
7	Ghosting	<ul style="list-style-type: none"> <li>Contrasting Color 1PCS +/- 1mm</li> <li>Non-Contrasting Up to the width of the label.</li> </ul>	
<b>Note: Inspection Items 5, 6, and 7 Can Not be combined on one label.</b>			





C



C: Adhesive Marring

D



D: Adhesive Tack Point

E



E: Light Leakage

F

*F: Vertical Backhousing Alignment*

G

*G: Label Edge Imperfection*





**Figure 19**



**Note:** Accessory and vehicle windshield surface must be at least 50°F at time of installation.



Use magnetic Windshield QC Scale.



Clean the roof panel directly above the windshield to prevent scratches from the magnetic Windshield QC Scale.

#### 10. LOCATE THE TKP BACKHOUSING TOP EDGE ON WINDSHIELD

(a) Place the magnetic Windshield QC Scale on the windshield next to the A-pillar as shown. Figure 19.

(b) Locate the magnetic Windshield QC Scale on the windshield by aligning the Windshield 0" line at the top edge of the windshield.

(c) Locate the top edge of the TKP Backhousing on the windshield at the indicated AVALON line at 19". See Figure 20.

**Hint:** The magnetic Windshield QC Scale is printed on both sides and can be seen from inside the vehicle.



**Figure 20**

## 11. KEYPAD GRAPHIC STICKER INSTALLATION



**Use Blue Masking Tape.**



**Make sure the inside windshield mounting location for the TKP Back housing is clean.**



**Refer to page 12 and 13 for QA Standards before affixing the Graphic Sticker to the inside of the windshield.**

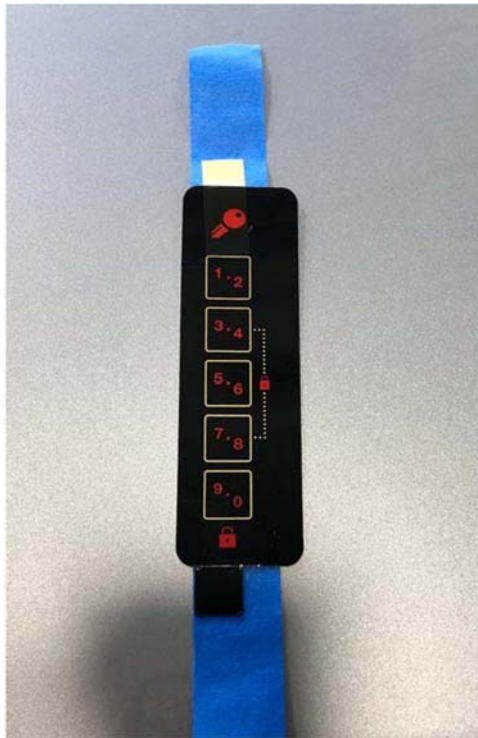

**Figure 21**



**Figure 22**

(a) Apply a strip of blue masking tape on to the backside of the Keypad Button Graphic Sticker. Figure 21.

(b) Using the YELLOW pull tab, uncover the top portion of adhesive on the graphic side of the Button Sticker.

(c) Holding onto the blue masking tape, carefully align the top edge of the Keypad Button Graphic Sticker to the Avalon mark on the magnetic Windshield QC Scale. Figure 22.

(d) At the same time carefully align the left edge of the Button Sticker with the windshield blackout next to the A-pillar.

(e) Once properly positioned, tack the top edge of the Button Sticker to the windshield using light pressure.

(f) Using the YELLOW pull tab, remove the protective film completely from the graphic side of the Button Sticker.

## Key Pad Placement

*Figure 23*

**Use a Felt block or wide Moulding Remover. Figure 23.**

(g) Smoothly & forcefully press the Moulding Remover down the length of Button Sticker.

*Hint: This can be done from the top or bottom of the Button Sticker.*

*Figure 24*

(h) Make multiple passes over the Button Sticker to achieve maximum wet-out. Figure 24.

(i) Carefully press out any air bubbles or ghost marks using the Moulding Remover.

(j) Remove the strip of blue masking tape.

*Inspect any imperfections in the wet-out against the QC Acceptance Criteria. If Button Sticker does not meet criteria, remove Button Sticker and re-apply new one that meets specification.*

(k) Using the bottom BLACK pull tab, remove the protective film from the backside of the Button Sticker.

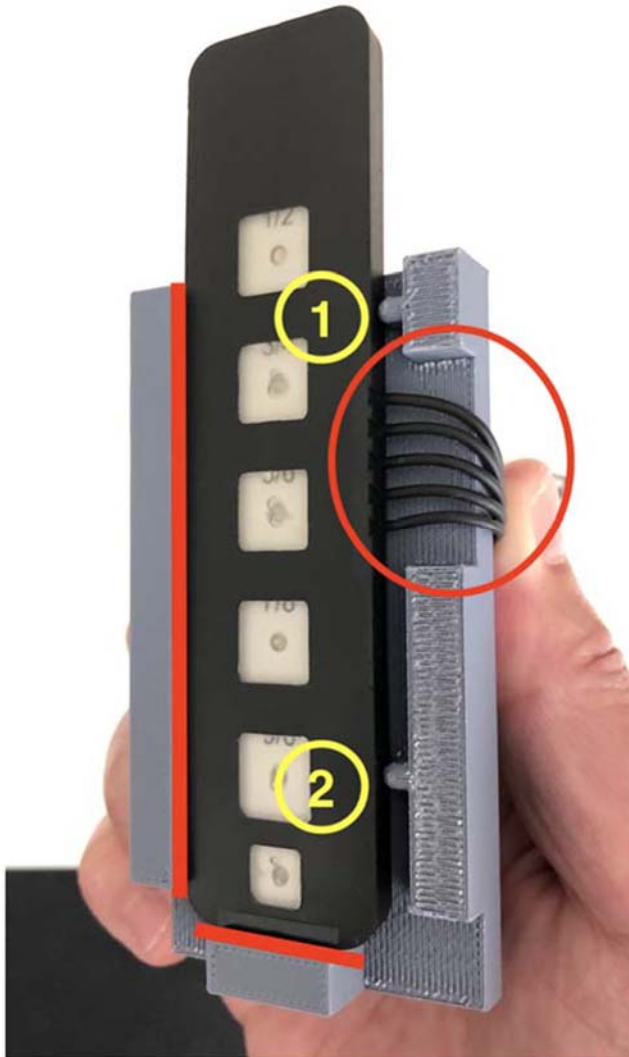

**Figure 25**

## 12 AFFIX THE TKP ACKHOUSING TO THE KEYPAD BUTTON GRAPHIC STICKER



Use the Backhousing Alignment tool.



Keep the LED light surface of the TKP Backhousing clean by only handling the sides.

(a) Place the TKP Back housing into the Alignment Tool as shown. Figure 25.



Insure the TKP Backhousing is pressed securely into the Alignment Tool along the highlighted surfaces and held in place by the two lock tabs #1 & #2.

**Hint: The TKP Back housing can be held more securely by pinching the sides of the Alignment Tool together.**

(b) Bend the Pigtail Harness back 90-degrees and hold it with your thumb as shown. Figure 25.

**Hint: It may be easier to route the pigtail harness under the factory harness along the A-pillar at this point.**





Figure 26a

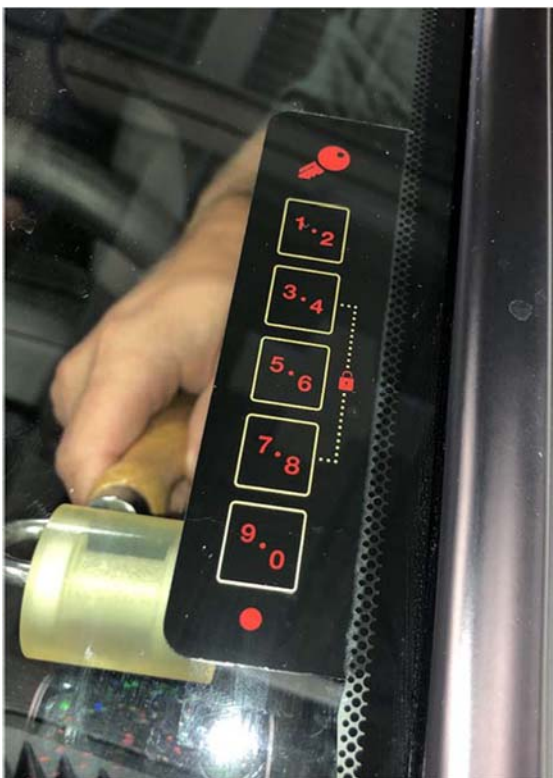

Figure 26b

(c) Place the Alignment Tool & TKP Back housing assembly against the windshield next to the Button Sticker to the lower RH side as shown. Figure 26a.



**Keep the assembly pressed firmly against the windshield during the following steps.**

(d) From inside the vehicle, carefully slide the assembly LEFT towards the A-pillar until it stops against the long-side edge of the Button Sticker.

(e) Carefully slide the assembly UP until it stops against the bottom edge the Button Sticker.



**Visually check that the Back housing is aligned with the Button Sticker.**

(f) Press the top of the Back housing against the Button Sticker to release it from the Alignment Tool.

**Hint: At this point if necessary, you can still lift the Back housing from the Button Sticker and adjust the alignment manually.**



**Inspect any misalignment of the Back housing against the QC Acceptance Criteria. If the back housing does not meet criteria it must be replaced. You CAN NOT make adjustments to Housing once its adhered to the Button Sticker.**



(g) Using your thumb, press at three or four points along the Back housing against the Button Sticker to firmly set it.



**Do not press the Program Button. Use the Roller.**

(h) Firmly press the Roller along the complete length of the Back housing at least four (4) times to achieve maximum adhesion between the Back housing and the Button Sticker.

Figure 26b

T-TAP INSTALLATION

When installing the female T-Tap connectors, be sure the wire is located inside the wire channel of the female T-Tap connector before closing the connector over the wire with pliers.

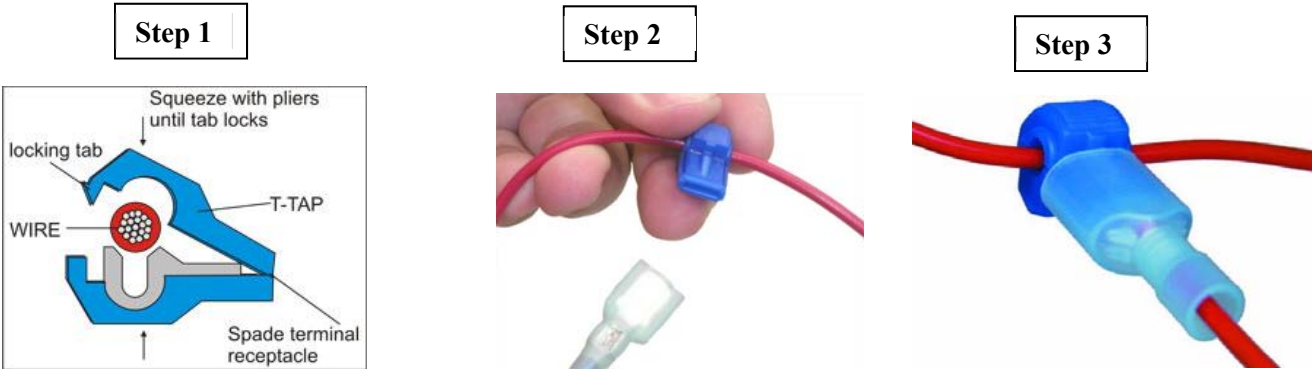

CONNECTOR KG5: Front Door LH Wire and Instrument Panel Wire (Left Kick Panel)

Location: Lower driver’s side kick panel area

TKP HARNESS	VEHICLE	PIN	T-TAP
Light Blue - Lock	LG	9	Black
White - Unlock	BE	15	Black

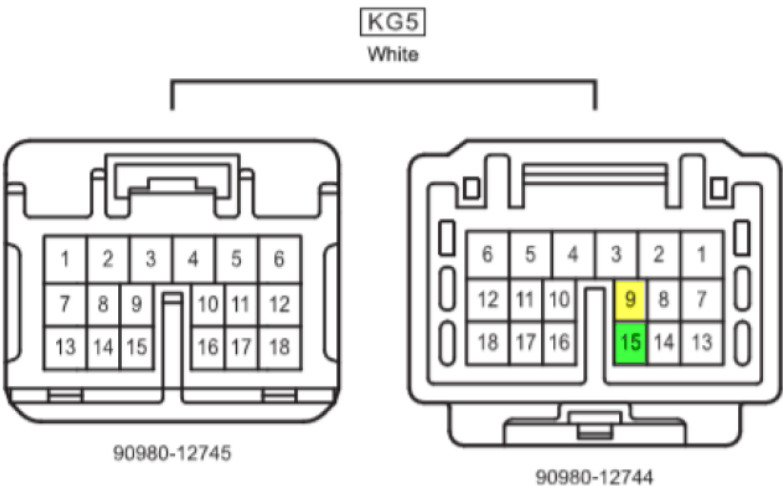



CONNECTOR 4F 32 PIN

Location: On driver’s side LH dash Panel

TKP HARNESS	VEHICLE	PIN	T-TAP
Yellow - Ignition	Red	2	Blue

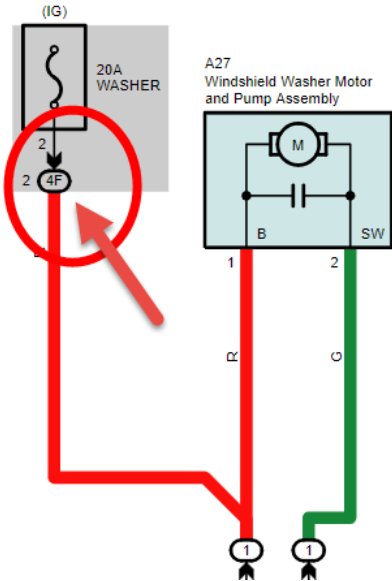
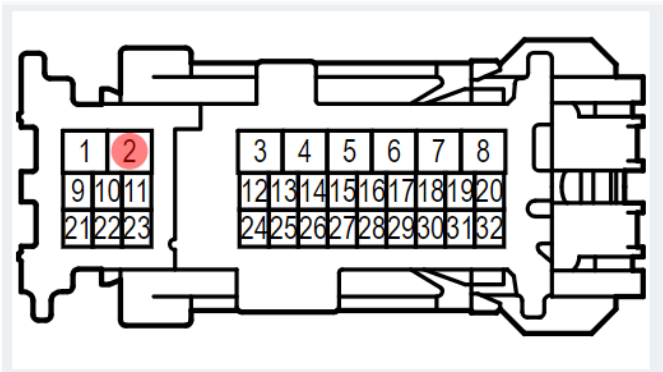

**Note :** Install the T-Taps in a staggered position on the wires. T-Taps should not be side-by-side nor same distance from the connector. There should be approximately at least one inch of wire remaining between the connector and the closest t-tap to the connector. See Examples 1 & 2

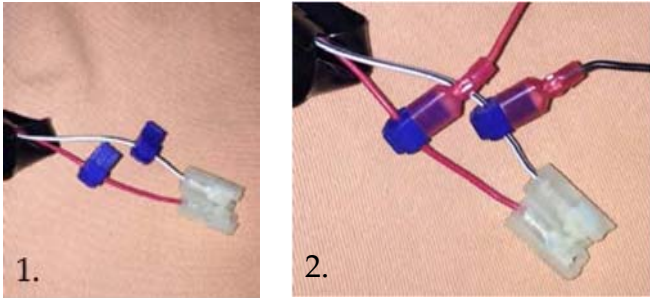

TKP VEHICLE HARNESS

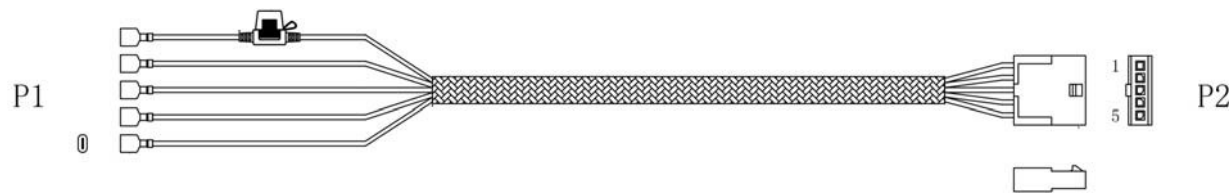

CONNECTOR P1 & P2: TKP Vehicle Harness

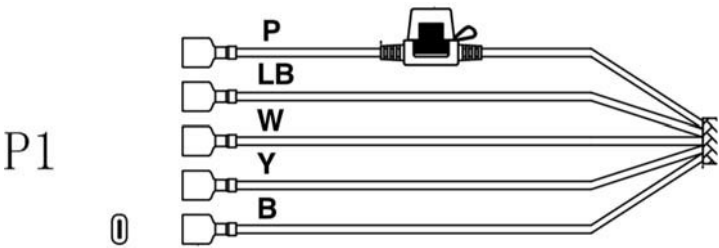

TKP VEHICLE HARNESS		WIRE COLOR
1	POWER	PINK
2	LOCK	LIGHT BLUE
3	UNLOCK	WHITE
4	ACC	YELLOW
5	GROUND	BLACK

Female Molex 5-pin Connector P2 BLACK

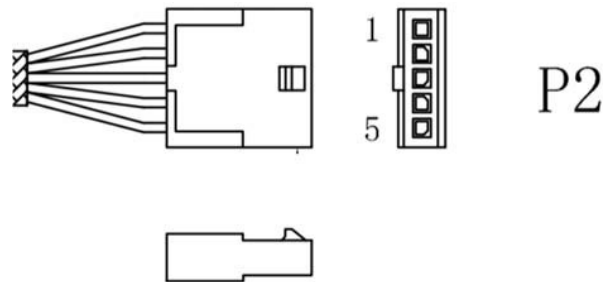

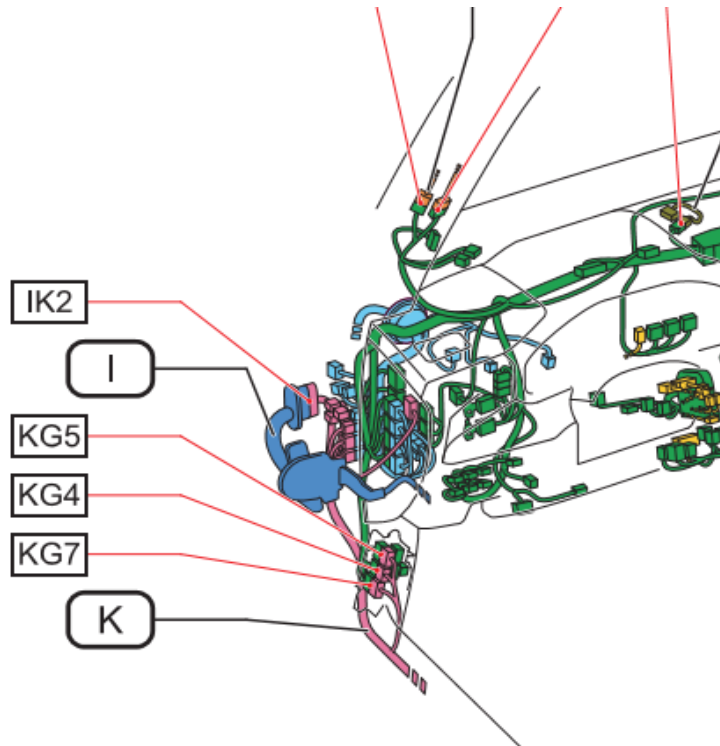

**Figure 27**

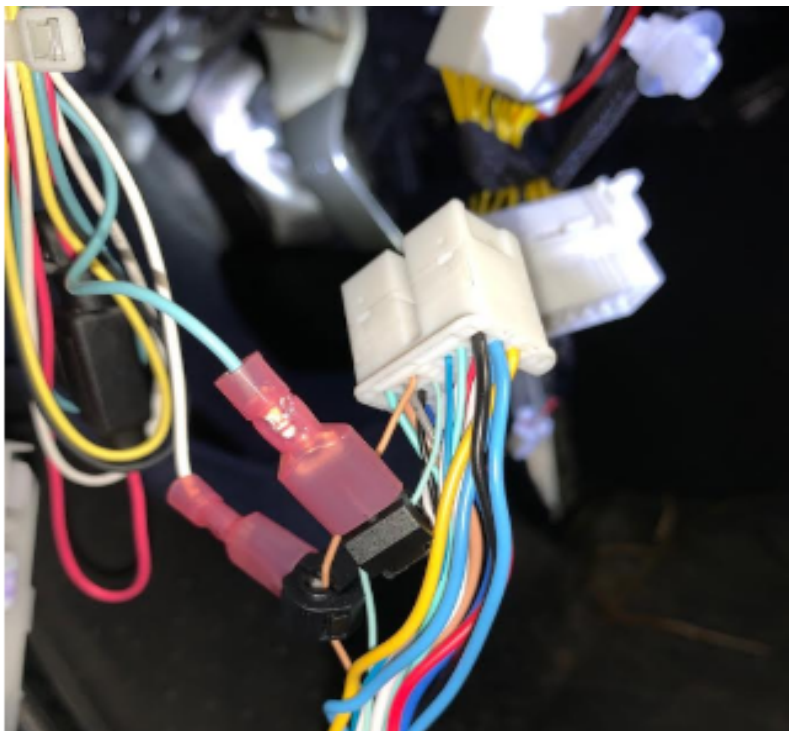

**Figure 28**

**13. Locate CONNECTOR KG5 : Front Door LH Wire and Instrument Panel Wire (Left Kick Panel) figure 27**

(a) Disconnect the KG5 connector. Figure 28.

(b) Pull back the protective tape to expose at least 2" of the wires behind the connector.

(c) Separate the LOCK wire (Pin #9 / Color LG-Light Green) from the bundle.

(d) Separate the UNLOCK wire (Pin #15 / Color BE-Beige) from the bundle.

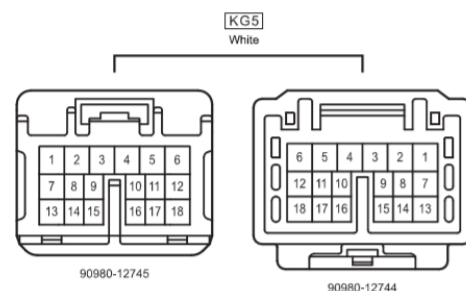

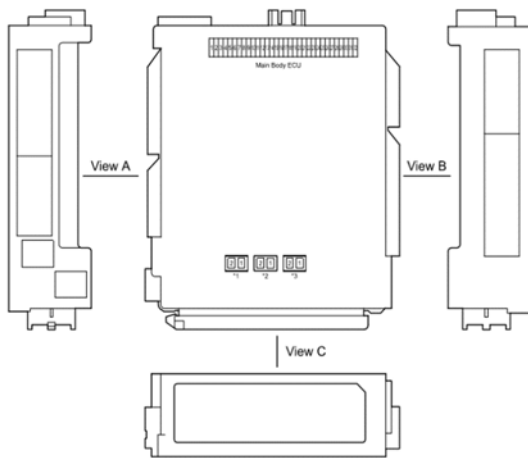

**14. Locate CONNECTOR 4F INSTRUMENT  
PANEL REINFORCEMENT 32 PIN  
CONNECTOR.**

**Figure 29**

**Figure 29**



(a) Pull back the protective tape to expose at least 2" of the wires behind the connector.

(b) Separate out washer wire (Pin #2 / Color Red) from the bundle. Figure 30.

**Figure 30**

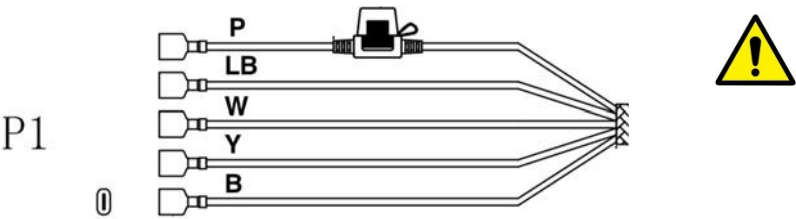

Before connecting, make sure the TKP Vehicle Harness' male blade connectors P1 are not bent to one side to ensure they insert securely into their corresponding female T-Tap connectors.

TKP VEHICLE HARNESS		WIRE COLOR
1	POWER	PINK
2	LOCK	LIGHT BLUE
3	UNLOCK	WHITE
4	ACC	YELLOW
5	GROUND	BLACK

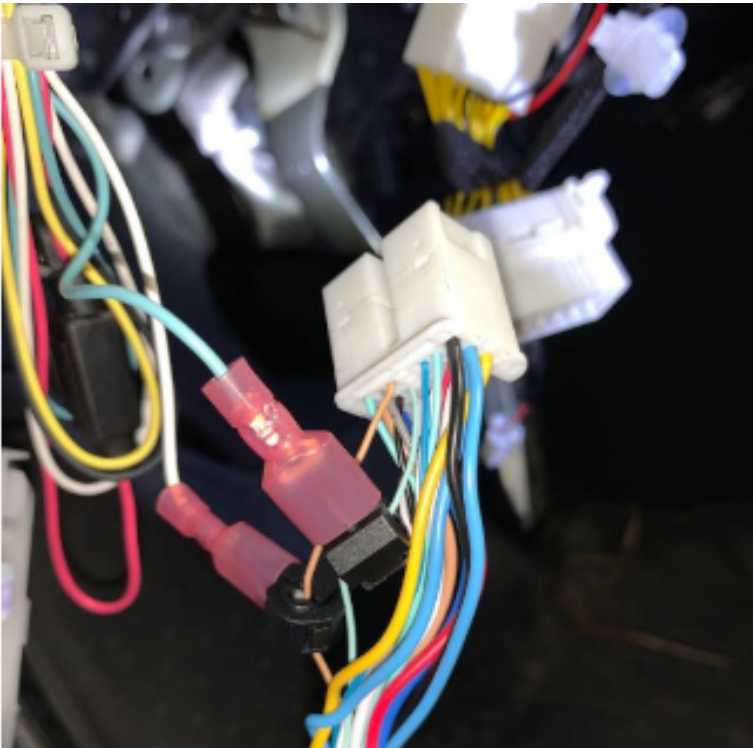

Figure 31

15. CONNECT THE LOCK & UNLOCK WIRES IN CONNECTOR IF1 TO THE TKP VEHICLE HARNESS MALE BLADE CONNECTORS P1

(a) Connect the male blade connector of the TKP Vehicle Harness LIGHT BLUE wire to the KG 5 (Pin # 9 Color/LG) connector wire T-Tap Figure 31.

(b) Connect the male blade connector of the TKP Vehicle Harness WHITE wire to the KG 5 (Pin # 15 Color/BE) connector wire T-tap ( Pin-14). Figure 31

(c) Reconnect the KG5 connector.



***Figure 32***

16. CONNECT THE WASHER CONNECTOR 4F  
TO THE TKP VEHICLE HSRNESS MALE  
BLADE CONNECTOR P1

(a) Connect the male blade connector of the TKP  
Vehicle Harness YELLOW wire to the 4F connectors  
RED WASHER wire T-tap (Pin 2). Figure 32



## 17. CONNECTING THE DLC JUMPER

- (a) Locate DLC under knee bolster.
  - (b) Remove DLC from Bracket.
  - (c) Connect DLC Jumper.
- Figure 33



Picture not representative of actual vehicle



*Figure 33*

## 18. ROUTEING TKP HARNESS

(a) From the lower driver's side kick panel area, route the TKP Vehicle Harness upwards along the side of the door edge opening and the instrument side panel LH as shown in Yellow see illustration. Figure 34.



*Figure 34*



*Figure 35*

## 19. SECURE THE TKP VEHICLE HSRNESS MOLEX 5-PIN CONNECTOR



**Use one (1) 8' zip tie**

- a. Loosely secure the TKP Vehicle Harness Female Molex 5-pin connector P2 to the factory harness at the A-pillar with a supplied 8" zip tie to prevent it from falling.

Figure 35



Use five (5) 8" zip ties

**20. BUNDLE & SECURE THE TKP  
VEHICLE HARNESS WIRES ZIP  
TIE LOCATIONS FIGURE 36**

(a) Power and Ground wires from  
DLC Jumper, follow factory harness.

(b) Secure TPK from DLC and above  
Key Pad (Molex connector routing).

(c) Bundle over all excess harness  
and routing from KG5 Connector.

(d) Bundle over all excess harness  
and routing from KG5 Connector.

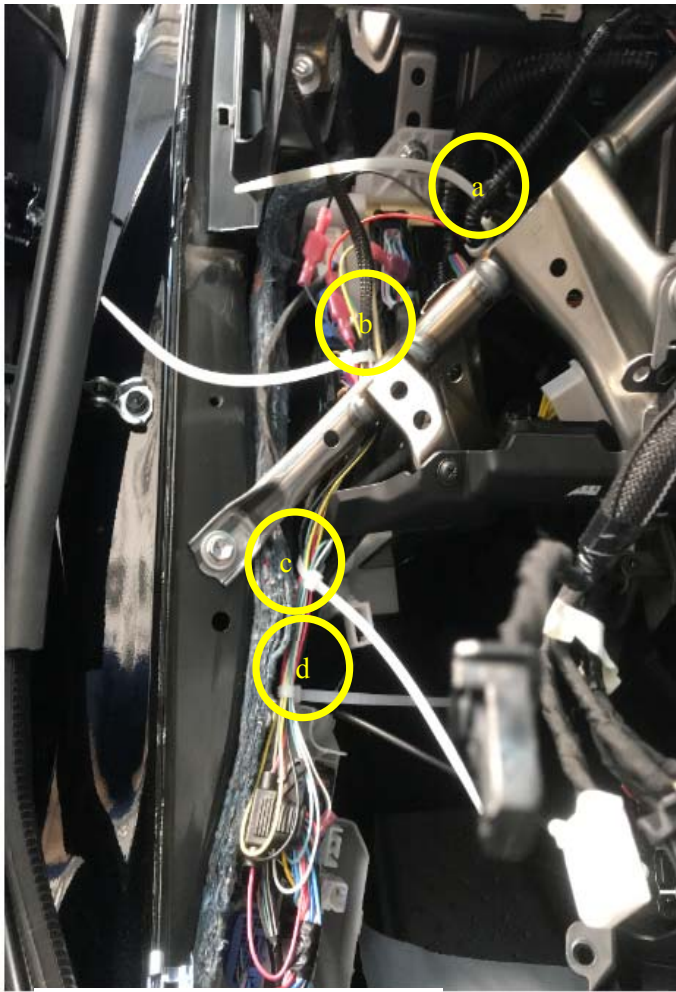
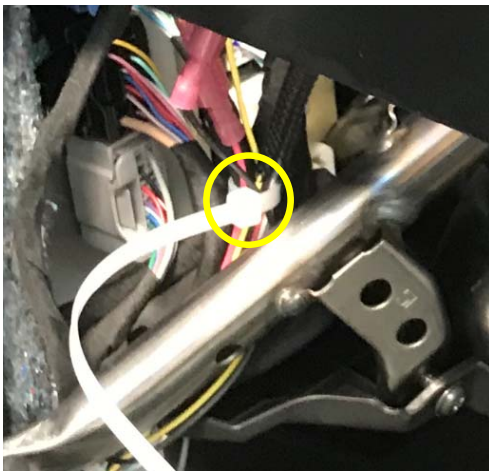

**Figure 36**



**Figure 37**

e. Tie strap Power and Ground From DLC Connector.  
Figure 37



**Figure 38**

f. Bundle over Power and Ground DLC wires and TKP harness from Molex connector from above routing.  
Figure 38



**Figure 39**

g. Wires from KG5 connector and all excess from TKP Harness. Figure 39



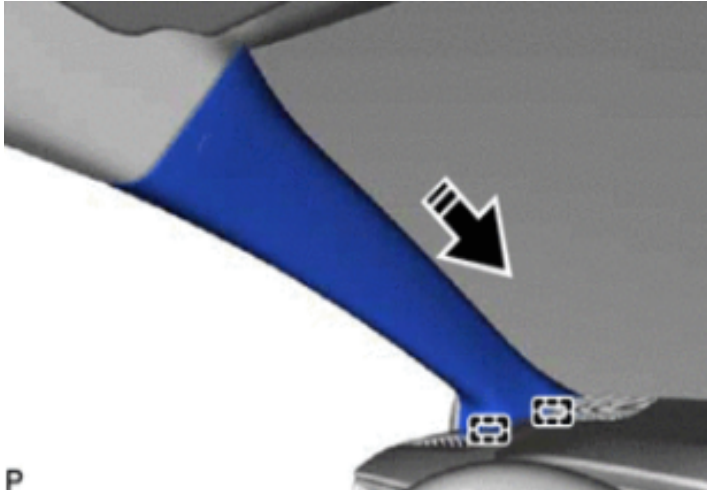

**P**  
**Figure 40**

## 21. INSTALL FRONT PILLAR GARNISH LH

(a) Install 2 new front pillar garnish clips to the front pillar garnish LH. Figure 40

**HINT: Make sure that the front pillar garnish clip is engaged correctly.**

w/o Front No. 3 Speaker:

Push the front pillar garnish LH as shown in the illustration to engage the 2 guides.

w/ Front No. 3 Speaker:

- Connect the connector.
- Push the front pillar garnish LH as shown in the illustration to engage the 2 guides.

(b) Engage the 2 front pillar garnish clips to install the front pillar garnish LH as shown in the illustration. Figure 41

**HINT: Make sure that the curtain shield airbag assembly LH is not pinched.**

(c) Align the alignment mark on the front door opening trim weather-strip with the flange on the vehicle body indicated by the arrow in the illustration, and install the front door opening trim weather-strip.

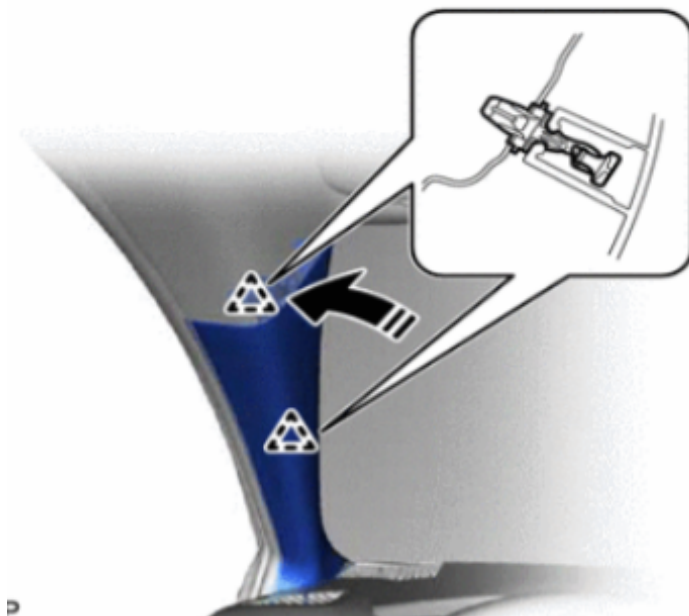

**P**  
**Figure 41**

## 22. Vehicle Reassembly

- (a) Engage the 3 claws and 2 guides as shown in the illustration to install the No. 2 instrument panel under cover sub-assembly.
- (b) Engage the claw and 2 guides to connect the hood lock control lever subassembly.
- (c) Engage the 3 claws and 2 guides as shown in the illustration to install the No. 2 instrument panel under cover sub-assembly.
- (d) Push the instrument side panel LH in the direction indicated by the arrow (1) to engage the 2 guides and push it in the direction indicated by the arrow (2) to engage the 6 clips and install the instrument side panel LH.
- (e) Engage the 2 clips as shown in the illustration. Install the cowl side trim sub-assembly LH with the clip.
- (f) Engage the 2 guides and 8 claws to install the front door scuff plate LH.

**HINT: Install the center pillar lower garnish LH side of the front door scuff plate LH first.**

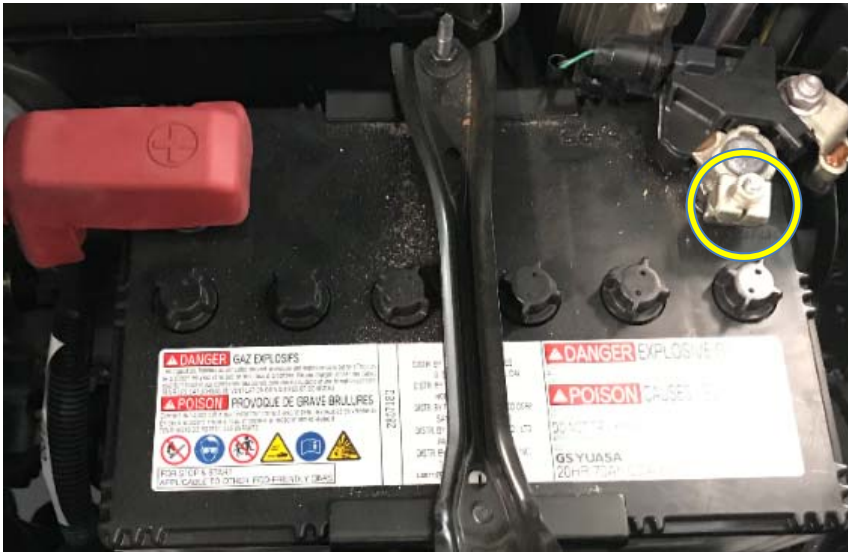

*Figure 42*

### 23. RE-INSTALL BATTERY



Use 10mm socket & torque wrench

(a) Reconnect the negative battery cable.  
Figure 42.



Torque: 48 in-LB (5.4 N-m)



Caution: DO NOT touch the positive terminal



When disconnecting the cable, some systems need to be initialized after the cable is reconnected.

24. Print Warranty Statement and place in the glove box, DIO only

## FUNCTION AND QUALITY CHECK

CHECKLIST - these points MUST be checked to ensure a quality installation.

## ACCESSORY FUNCTION CHECK:



**With Keys out of the vehicle and the Driver Side window in the down position.**

## LOOK FOR:

**TKP FUNCTION CHECK:****1) First Time Use**

- a. To guard against accidental lock, the Keypad awakes inactive.
- b. In this state, the confirmation and digit button LEDs quickly flashes three (3) times when awoke to signal there is no Access Code programmed.
- c. Then Keypad will immediately re-enter the sleep state.

**2) Set 5-digit Access Code**

- a. Press the Program button
  - i) Digit confirmation LED and all digit button LEDs illuminate.
- b. Enter the 5-digit Access Code 1-3-5-7-9
  - i) Confirmation LED flashes with each accepted digit entry.
  - ii) When the new 5-digit Access Code is set, all Keypad LEDs quickly flash three times.
- c. Keypad allows 20 seconds after each touch to enter a new code.
- d. If you enter an incomplete or incorrect Access Code, simply press the Program button and repeat the steps above.

**3) Lock All Doors**

- a. Using multiple finger tips, touch any of the digit buttons to wake up the Keypad
- b. Touch & hold the 3/4 & 7/8 digit buttons simultaneously
  - i) Confirmation LED quickly flashes five (5) times.
  - ii) You should also hear all doors lock. (background noise permitting)
- c. Keypad goes to sleep (all digit button LEDs turn off) after about 10 seconds.

#### 4) Unlock Driver's Door

- a. Using multiple finger tips, touch any of the digit buttons to wake up the Keypad.
- b. Enter the 5-digit Access Code 1-3-5-7-9.
- c. Confirmation LED flashes with each accepted digit entry.
- d. Confirmation LED flashes long once when the Driver's door is unlocked.
- e. You should hear the Driver's door unlock (background noise permitting)
- f. All doors unlocked. Enter the 5-digit Access Code 1-3-5-7-9. Hold the 9 Key down for 5 seconds.

#### 5) Turn Key on to Ignition Power

- a. With ignition turned to the on position verify that numbers 1-3-5-7-9 do not illuminate.  
Note: The indicator light will flash.

#### 6) Return to Factory Reset State (Keypad Disabled)

- a. Press & hold the Program button for about 10 seconds.
- b. In this state when awoke, the confirmation and digit button LEDs will blink three times to signal there is no code programmed.

#### 7) Check function of all disconnected switches



User Manual

Place User Manual in the glove box.



Headrest Hangtag

Hang Seat Headrest Hang tag from Passenger seat headrest.



Check Speaker

Left Front A-Pillar Speaker, if applicable.



Warranty Statement

Place Warranty Statement in the glovebox, DIO only.



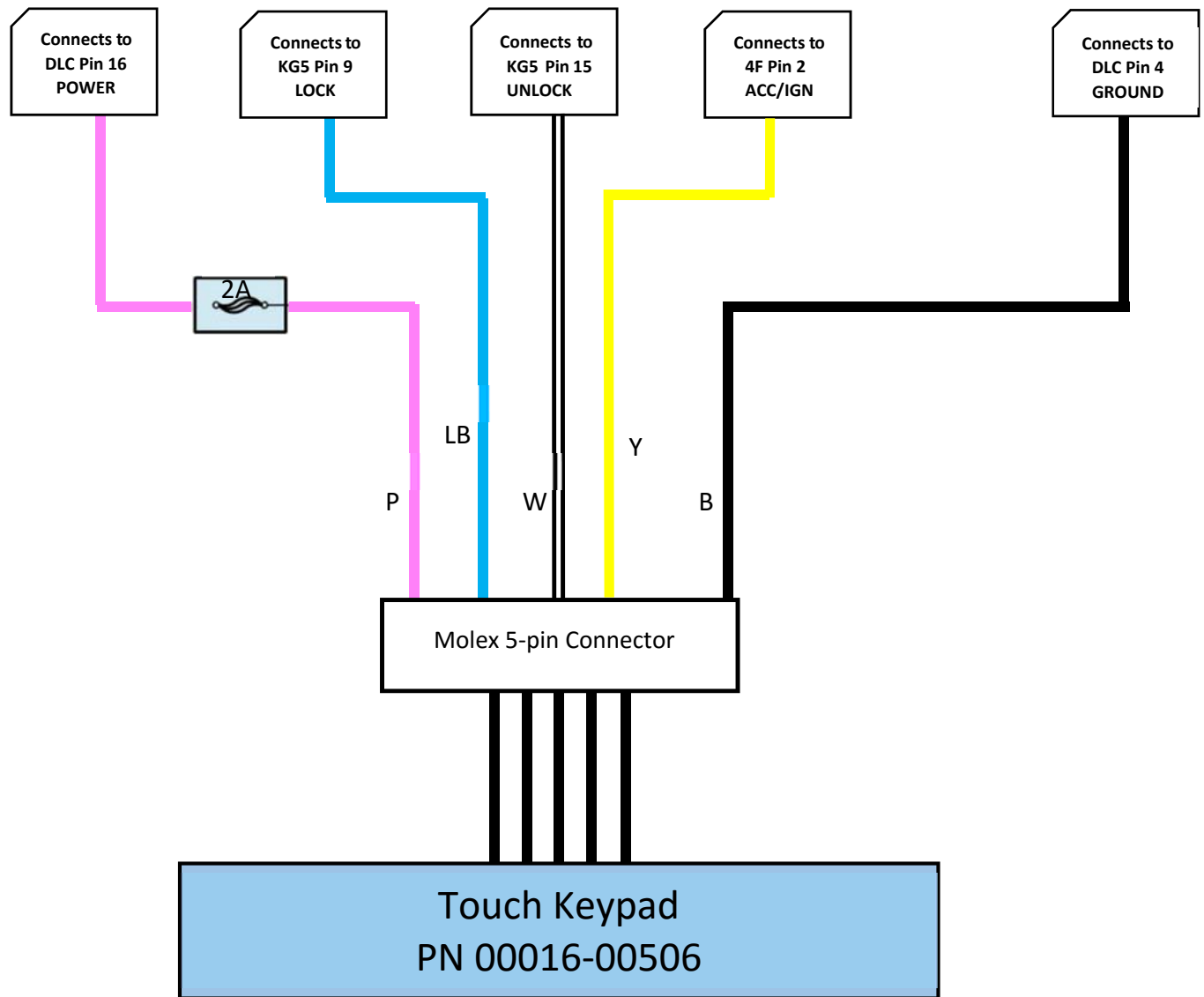

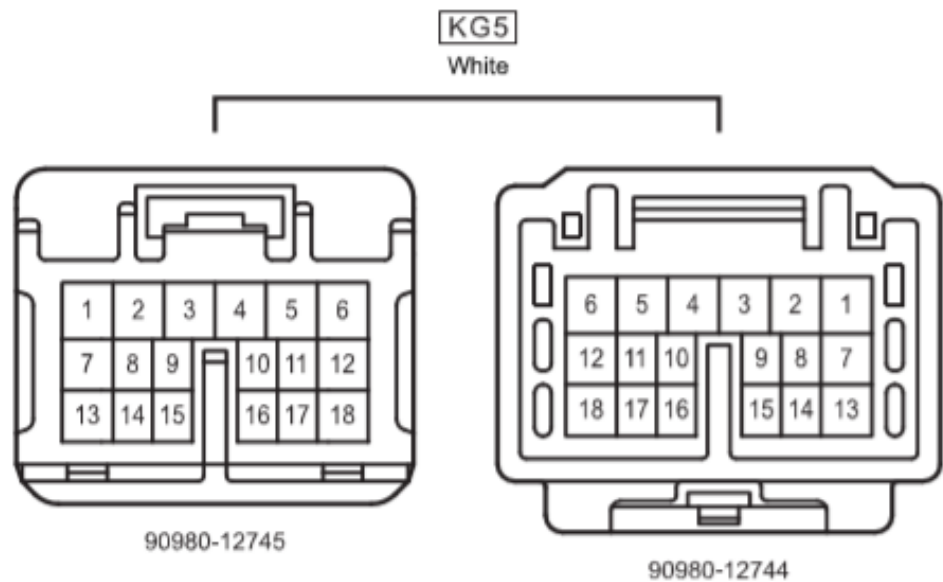

Connector  
KG5 Pin 5  
LOCK

Pin	Wire Color	Test Reference	Proper Operation
9	LG	Pin 9 to Ground	12-14VDC TO BE VERIFIED

Connector  
KG5 Pin 15  
UNLOCK

Pin	Wire Color	Test Reference	Proper Operation
15	BE	Pin 15 to Ground	12-14VDC TO BE VERIFIED

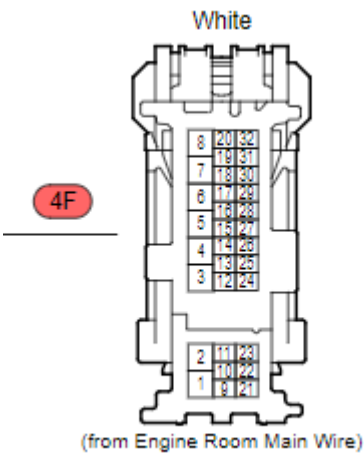

Connector  
4F Pin 2  
ASSOSSORY

Pin	Wire Color	Test Reference	Proper Operation
2	Red	Pin 2 to Ground	WASHER MOTOR 12V when ACC or IGN is ON TO BE VERIFIED

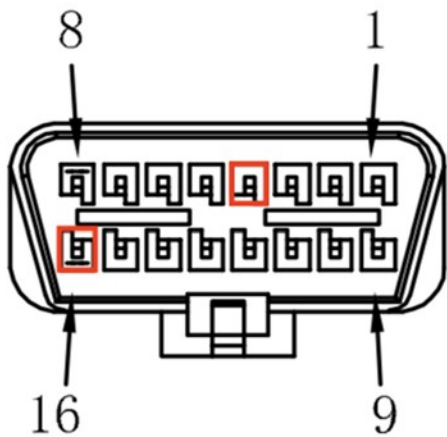

DLC  
Jumper  
Pin 4  
GROUND

Pin	Wire Color	Test Reference	Proper Operation
4	B	Pin 4 to Ground	0VDC

Pin 16 POWER

Pin	Wire Color	Test Reference	Proper Operation
16	R	Pin 16 to Ground	Approximately 0VDC when IGN is OFF and +12VDC when IGN is ON



## LIMITED WARRANTY – SOUTHEAST TOYOTA

**SOUTHEAST TOYOTA DISTRIBUTORS, LLC** ("we," "our" and "us") provides the following limited warranty on our accessories, excluding tires, ("Accessories" or "Accessory") installed on a Toyota. This limited warranty is not provided by and does not bind or provide benefit to the vehicle dealer, the manufacturer, or Toyota Motor Sales, U.S.A., Inc. This limited warranty does not apply to tires; please consult the tire manufacturer and/or its materials accompanying the vehicle for any warranty terms concerning tires. This limited warranty also does not apply to ToyoGuard Exterior Paint Sealant and ToyoGuard Interior Protector; please consult the ToyoGuard Limited Warranty Certificate for the warranty terms concerning those products.

### SCOPE OF LIMITED WARRANTY:

#### A. Protection:

- i. **Accessories Installed by Southeast Toyota Distributors, LLC on a new Toyota vehicle.** We warrant that, for a period of 36 months or 36,000 miles, whichever occurs first, we will repair or replace (includes labor), free of charge, any defect in such an Accessory due to faulty material or workmanship, or, at our option, provide a full refund of the purchase price of the Accessory. The warranty period begins on the vehicle's In-Service Date, which is the first date the new vehicle is either delivered to an ultimate purchaser, leased, or used as a company car or demonstrator. Accessories installed by Southeast Toyota Distributors, LLC are identified on the vehicle's window sticker (Monroney Label).
- ii. **Accessories Installed by a Toyota Dealer on a Toyota vehicle.** We warrant that, for 12 months, regardless of mileage, from the date such an Accessory was installed on the vehicle or the remainder of the Toyota new vehicle warranty, whichever is longer, we will repair or replace (includes labor), free of charge, any defect in the Accessory due to faulty material or workmanship, or, at our option, provide a full refund of the purchase price of the Accessory. For a new vehicle, the warranty period begins on the vehicle's In-Service Date, which is the first date the new vehicle is either delivered to an ultimate purchaser, leased, or used as a company car or demonstrator.
- iii. **Accessories purchased from a Toyota Dealer but not installed by the Toyota Dealer.** We warrant that, for a period of 12 months, regardless of mileage, from the date the accessory was purchased, we will repair or replace (does not include labor), free of charge, any defect in the Accessory due to faulty material or workmanship, or, at our option, provide a full refund of the purchase price of the Accessory.

**B. Limitation of Warranty.** This limited warranty does not apply to, and we will not repair, replace, or reimburse you for: (1) wheel balancing and wheel alignments, except for one wheel balancing or alignment during the first 12 months or 12,000 miles, whichever occurs first, from the vehicle's In-Service Date, as defined above, (2) abrasions or dents, whatever their cause, and any failure or damage resulting directly or indirectly from accidents, collisions, impacts from foreign objects, fire, theft, larceny, explosion, malicious mischief, vandalism, civil commotion, riots, war, or any other similar causes, (3) any failure or damage resulting directly or indirectly from lightning, windstorms, hail, water, floods, subfreezing temperatures, airborne chemicals, tree sap, dust, salt, and any other environmental conditions or similar causes, (4) any failure or damage caused by: (a) a failure of any part, other than the Accessory, (b) any misuse, abuse, improper towing, negligence or lack of maintenance of the vehicle or Accessory, (c) the alteration, modification or repair of the Accessory by anyone other than persons expressly authorized by us to perform such alteration, modification or repair, or (d) the use of the vehicle for commercial purposes, competitive driving or racing, (5) any failure or damage, if the Accessory has not been installed according to instructions, (6) any failure or damage occurring outside of Canada, the United States of America, its territories or possessions, (7) except to the extent required by the state whose laws govern this limited warranty, any consequential, secondary, or unreasonable costs that may be suffered as a result of the need to repair or replace the Accessory, including without limitation any loss of use of the vehicle, road service, towing, storage charges, inconvenience, loss of wages and/or income, additional expense incurred, loss of transportation, rental car expense, or any derivative damage to persons or things other than the Accessory, including other parts of the vehicle, or (8) liability for damage to property or for injury to or death of any person, arising out of the operation, maintenance or use of your vehicle whether or not related to the covered Accessory.

**C. Exclusive Remedy.** If there is a valid claim under this limited warranty for a defect due to faulty material or workmanship in the Accessory, we will, at our option, either: (i) repair, (ii) replace or (iii) provide a full refund of the purchase price of the Accessory. We have no other obligations under this limited warranty. Refunds will be made to the vehicle owner. If the vehicle is leased, the refund will be made to the leasing company.

**HOW TO MAKE A CLAIM:** In the event of a warranty claim, please contact the nearest Toyota dealer to arrange for repairs. The dealership must receive our prior authorization before making repairs covered by this limited warranty. The dealer will contact Southeast Toyota Distributors, LLC at 1-888-851-2722, select option #5 (Warranty Department), then option #4 (Repairs), for instructions on processing a warranty claim, if they are not already familiar with the process. If you have any questions or concerns regarding repairs covered by this limited warranty, please contact our **Customer Assistance Hotline at 1-800-301-6859**.

**OUR DISPUTE RESOLUTION PROGRAM:** Your satisfaction is our highest priority. In keeping with that focus, in the event that an issue arises related to this Limited Warranty, we invite you to call our Customer Assistance Hotline at 1-800-301-6859 to discuss it. In most cases, we expect that a satisfactory resolution of your issue can be reached through engagement with that Department. If our Customer Loyalty Department is unable to resolve your issue to your satisfaction, we offer a dispute resolution program administered by the National Center for Dispute Settlement (NCDS) ("the Program"). The purpose of the Program is to resolve disputes in an informal setting before an impartial arbitrator. The Program is free of charge to you (although you must bear the cost of any expert witness or attorney you elect to employ). You are required to complete the Program before exercising rights or seeking remedies under the federal Magnuson-Moss Warranty Act, 15 U.S.C. § 2301 et seq. ("the Act"). If you choose to seek remedies that are not created by the Act, you are not required to use the Program before pursuing such remedies – although the Program is still available to you to resolve the dispute. When utilizing the Program, you will need to provide (a) the vehicle identification number of your vehicle, (b) the identity of your selling and servicing dealerships, (c) the mileage on your vehicle at relevant times, (d) the date and nature of any relevant repairs, (e) legible copies of repair orders and other relevant documents, (f) a summary of the unresolved issue and the requested action, and (g) your contact information. In most cases, the dispute resolution process under the Program will be completed within forty (40) days of your submission of your request and will consist of steps such as an initial eligibility determination, an opportunity for you and us to submit information in writing relating to your claim, an oral hearing, and a decision from the arbitrator. A decision will be binding on you only if you choose to accept it. You may submit a request to NCDS by telephone at their toll free number: (877)-276-8848 or in writing at P.O. Box 463196, Mt. Clemens, MI 48046. You may obtain additional information regarding the Program at [www.ncdsusa.org](http://www.ncdsusa.org). In the event that the NCDS does not exist or no longer handles disputes for us at the time that you seek to submit a request, you may contact our **Customer Assistance Hotline at 1-800-301-6859** to obtain current information about our dispute resolution programs.

Rev. 12/01/16



**GENERAL LIMITATION OF WARRANTY:** THIS LIMITED WARRANTY IS IN LIEU OF ALL OTHER EXPRESS WARRANTIES OR LIABILITIES. IN NO EVENT SHALL WE BE LIABLE FOR ANY CONSEQUENTIAL OR INCIDENTAL DAMAGES FOR BREACH OF THIS OR ANY OTHER WARRANTY. SOME STATES DO NOT ALLOW THE EXCLUSIONS OR LIMITATIONS OF INCIDENTAL OR CONSEQUENTIAL DAMAGES, SO THE ABOVE INFORMATION OR EXCLUSION MAY NOT APPLY. NO EXPRESS WARRANTY OF FITNESS OR MERCHANTABILITY IS GRANTED BY THIS LIMITED WARRANTY. THERE ARE NO WARRANTIES WHICH EXTEND BEYOND THOSE DESCRIBED IN THIS DOCUMENT. ANY IMPLIED WARRANTIES, INCLUDING THE IMPLIED WARRANTY OF MERCHANTABILITY OR FITNESS FOR A PARTICULAR PURPOSE, WHICH MAY BE APPLICABLE BY OPERATION OF LAW SHALL BE LIMITED TO THE PERIOD OF THIS WRITTEN LIMITED WARRANTY. SOME STATES DO NOT ALLOW LIMITATIONS ON HOW LONG AN IMPLIED WARRANTY LASTS, SO THE ABOVE LIMITATIONS MAY NOT APPLY. THIS LIMITED WARRANTY PROVIDES SPECIFIC LEGAL RIGHTS, AND THERE MAY BE OTHER RIGHTS WHICH VARY FROM STATE TO STATE. ANY ACTION FOR BREACH OF ANY WARRANTY HEREUNDER, INCLUDING ANY IMPLIED WARRANTY OF MERCHANTABILITY, MUST BE BROUGHT WITHIN A PERIOD NOT EXCEEDING 12 MONTHS AFTER EXPIRATION OF THIS LIMITED WARRANTY. THE REMEDIES SPECIFIED HEREIN AND THOSE SPECIFIED BY APPLICABLE LAW ARE THE ONLY REMEDIES AVAILABLE. WE ASSUME NO OTHER OBLIGATION OR RESPONSIBILITY WITH REGARD TO THE ACCESSORY. WE NEITHER ASSUME, NOR AUTHORIZE ANYONE TO ASSUME FOR US, ANY ADDITIONAL LIABILITY IN CONNECTION HERewith.

**GENERAL:** This limited warranty describes the complete and exclusive rights that result from the purchase of Accessories. No oral representations or statements may be relied upon. This limited warranty may not be amended or modified, and additional rights may not be granted, unless in a written statement signed by one of our officers. This limited warranty shall be governed by the laws of the state where the vehicle is purchased, excluding laws concerning conflicts of law. We may delegate the performance of our duties and obligations and assign our rights and benefits hereunder. For inquiries regarding this limited warranty, we can be contacted directly at **Customer Assistance Hotline at 1-800-301-6859**, or by mail to: **Southeast Toyota Distributors, LLC, Attention: Customer Loyalty Department, 100 Jim Moran Boulevard, Deerfield Beach, Florida 33442.**