

Toyota Sequoia SR / Tundra CrewMax SR 2011-

8.5 Overhead Video

Part Number: 00016-00125-06

Accessory Code: ED90



Conflicts

1.) Third Passenger Front Seating
2.) Non-Sunroof

Color Applicability/ Trim Level:

Accessory Color	Pewter	Shale
Vehicle Trim Color		
Dk Gray	X	
Sand Beige		X

General Applicability:

Vehicle with Sunroof

Kit Contents:

Item #	Qty.	Component Description
1	1	Monitor Assembly
2	2	Trim Ring Assembly (Shale/Pewter)
3	2	Bracket Assembly
4	1	Hardware Bag
5	1	Cutout Template

Recommended Sequence of Application

Item #	Accessory	

* Mandatory

Hardware Bag Contents:

Item #	Qty.	Component Description
1	4	M6 x 10 mm Washer Bolt
2	4	Elastic Nut
3	4	Washer
4	8	1 1/2" x 8" Foam Tape
5	6	6" Wire tie
6	5	Red T-Tap
7	5	Red Male Spade

Additional Items Required For Installation:

Item #	Qty.	Component Description

Recommended Tools:

Safety Tools	
Blankets	Fender Cover
Special Tools	
	Torque Wrench 36 in/lbs
Installation Tools	
Nylon Removal Tool (NRT)	Pliers
Ratchet	Pencil
8mm socket	Wire snips
10mm socket	T-20 Torx driver
8mm Box ratchet	#2 Phillips
Razor knife	
Special Chemicals	
50/50 Alcohol/Water Solution	

LEGEND:

STOP: Damage to the vehicle may occur. Do not proceed until process has been complied with.

OPERATOR SAFETY: Use caution to avoid risk of injury.

CRITICAL PROCESS: Proceed with caution to ensure a quality installation. These points will be audited on a completed vehicle installation.

TOOLS & EQUIPMENT: This calls out the specific tools and equipment required for this process.

SAFETY TORQUE: This mark indicates that torque is related to safety.

REVISION MARK: This mark highlights a change in installation with respect to previous issue.

SPECIAL NOTE:

After TMS and Safety mandated preparatory steps have been taken, the installation sequence is the suggested method for completing the accessory installation. In some instances the suggested sequence is written for one associate to install and in others the sequence is given as part of a team accessory installation. Unless otherwise stated in the document, the associates may perform the installation in any order to make the installation efficient as possible while maintaining consistent quality.

A. Pre-Installation Precaution



1. Use Seat and Floor protectors to avoid damage to surfaces.



2. If the vehicle is equipped with an Anti-theft radio, the radio code must be written down prior to disconnecting the battery cable. The code must be re-entered when the negative battery cable is re-installed. Disconnecting the battery may cause certain vehicle settings to be lost. Manufacturer's recommendations for the battery removal should be followed. Disconnecting the battery is recommended.

B. Battery disconnect



1. Remove the NEGATIVE (-) battery terminal using a 10mm socket/ ratchet before starting any

disassembly. (Figure B1) 

Figure B1



C. Vehicle Disassembly

1. Lower forward overhead console by removing four (4) screws with a T-20 Torx driver. (Figure C1)

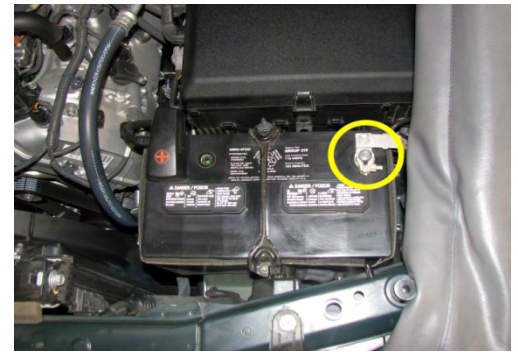

2. Disconnect electrical connector and remove console from vehicle. (Figure C2)

3. Remove wire cover above rear view mirror by sliding downward and unclipping from base.

NOTE: Only if factory EC mirror exists in vehicle.

(Figure C3)

4. Remove lens from overhead dome lamp by prying front edge with a NRT. (Figure C4) 

5. Pull dome lamp down from rear edge, disconnect electrical connector and remove from vehicle. (Figure C5)

Figure C1



Figure C2



Figure C3



Figure C4



Figure C5



6. Pull glued dome light cable loose from headliner about six inches clearance from dome lamp opening. (Figure C6)

Figure C6



D Headliner preparation.

1. Tape template to headliner as indicated and trace perimeter with a pencil.(Figure D1)



2. Carefully cut out tracing with a sharp razor knife, start at the corners and work towards the center areas.  

Figure D1



E. Wiring

1. Temporarily disconnect electrical connector **U12** or **W1** going to rear view mirror. Pull some slack into the console opening to connect to.

Figure E1



NOTE: If EC mirror does not exist, connector is in the headliner. (Figure E1)

2. Apply red T-Taps to the Sk.Blue wire Pin #1 and the White/Black wire Pin #2 with pliers about 4 inches back from the connector. (Figure E2)

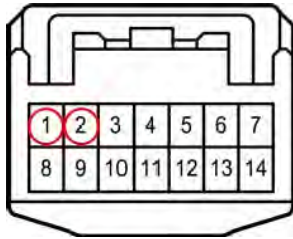

U12 Connector Sequoia

W1 Connector Tundra

3. Wrap noise filter on main power harness with foam tape. (Figure E3)

4. Attach noise filter to factory wire harness using (3) 6" wire ties. (Figure E4)

5. Attach the main power harness to the T-Taps. Red wire to Sk.Blue Pin #1 and the Black wire to the White/Black Pin # 2. Reconnect connector U12 / W1 back into mirror.

Figure E2



Figure E3



Figure E4





6. Route the cable above the headliner along the passenger side sunroof opening. Headliner is suspended with a hook and loop fastening system and can be slightly lowered by carefully pulling downwards along the inside edges. Allow about 4 inches of slack to exit from the center of the cut out. Use two pieces of foam tape strips to secure the cable to the headliner behind the hook and loop fasteners as indicated in the picture. (Figure E6)

7. Bundle excess wiring with a 6" wire tie and tuck above passenger side sun visor. (Figure E7)

F. Dome lamp harness

1. Attach one red T-Tap to each of the three wires on the **U6/W6** connector with pliers. (Figure F1) 

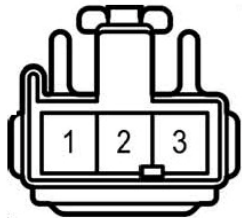

U6 Connector Sequoia

W6 Connector Tundra

Figure E6



Figure E7



Figure F1



2. Crimp (3) red male spade connectors to the wire ends on the 12" harness. (Figure F2) 

3. Attach the video systems dome light wires to the T-Taps on the factory harness as follows: (Figure F3)

U6/W6	OE Color	DVD Color	Function
Pin # 1	Gray	Black	12 volt
Pin # 2	White/Black	Red	Ground
Pin # 3	Pink	Purple	Door (-)

G. Install bracket and connect wiring

1. Install upper bracket with arrow pointing forward and attach with (4) mounting bolts. (Figure G1) 

2. Install lower bracket to upper bracket using (4) washers and elastic nuts. (Figure G2) 

Figure F2

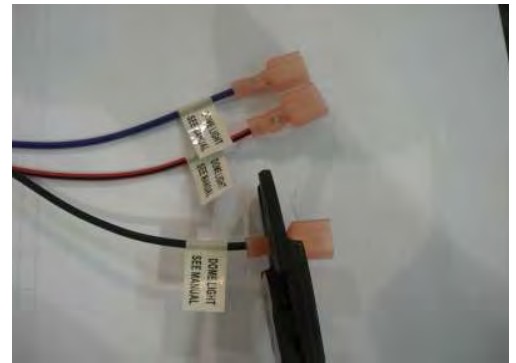

Figure F3



Figure G1



Figure G2



3. Attach three pieces of foam tape to one another and then to the front cross member. This will keep the headliner from compressing too much after final install has been completed. (Figure G3a&b)

4. Connect 12 pin harness to 15' power harness with 2 pin connector.

5. Affix 2 pin connector inside of cross member on passenger side with a ½ piece of foam tape. (Figure G5)

6. Affix dome light connection inside cross member on driver side with a ½ piece of foam tape. (Figure G6)

H. Preparing and Installing Monitor

1. Attach correct color coded trim pieces to monitor.

Installing The Snap On Covers

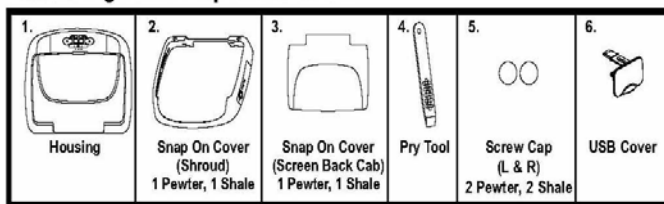

Place the pod on a soft surface to avoid damaging the plastic.

Figure G3a



Figure G3b



Figure G5



Figure G6



Installing The Shroud

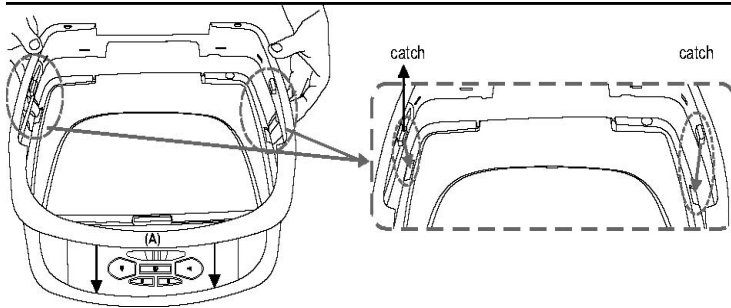

Begin by wiping down the front and back edges of the monitor housing with a 50/50 solution of alcohol and water. Then remove the thin strips of paper on front/back of shroud to expose double stick tape, hook area "A" (above) over the dome light and slide the cover over the pod. The cover will snap in place once the tabs on both sides are aligned. Press firmly where tape contacts shroud and monitor housing.

Installing The Screen Cover

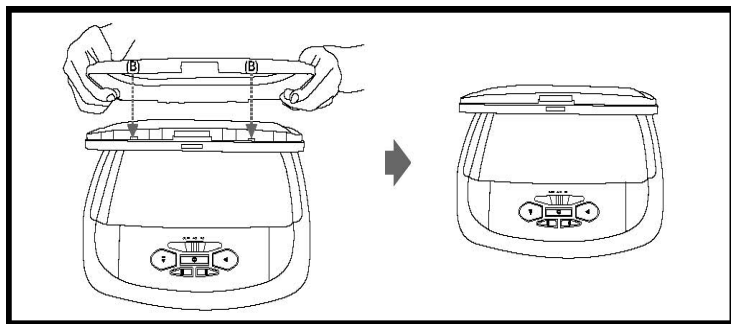

Open the screen and hook the two tabs "B" on the bottom edge of the screen. Snap the opposite side over the hinge.

2. Connect main harness to monitor. (Figure H2)
3. Affix RCA jacks to rear of monitor with foam tape. (Figure H3)

Use supplied screws to attach trim ring to unit.

- A) #4 x 5/16 Self Tapping Screws (1pc)
- B) #4 x 7/16 Self Tapping Screws (3pcs)
- C) Screws ISO 3 x 8mm Long (5pcs)

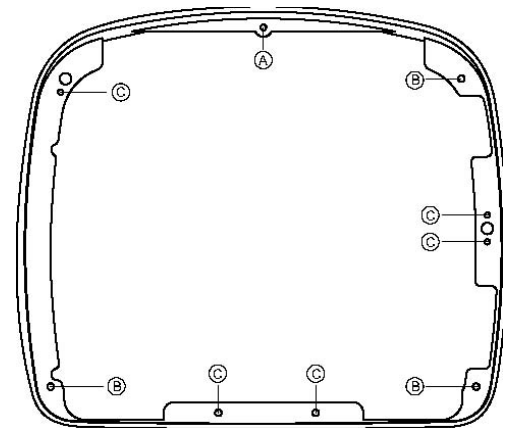

Note: The three screws located in the B locations will first need to be removed.

Figure H2



Figure H3



4. Install monitor with (4) M5 screws using #2

Phillips head screwdriver. (Figure H4) 

5. Install USB cover and screw caps.

Note: Screw caps are labeled L&R

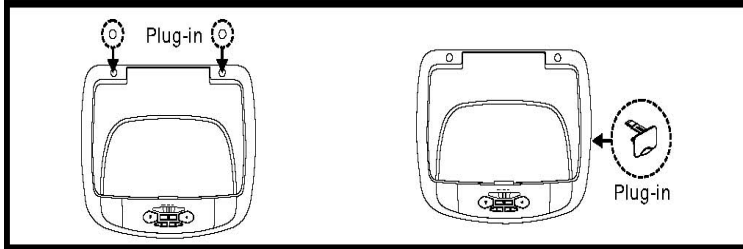



Figure H4



I. Complete Installation

1. Install 2 AAA batteries in each of the wireless headphones and the game controller. Pull battery protection strip from remote.
2. Connect battery negative cable and torque to 36 in. lbs. 
3. Check all previously disconnected factory connectors and accessories to ensure they are all connected and operational.
4. After testing with steps on following pages, carefully re-assemble vehicle by reversing steps in section C.
5. After testing, store owner's manual and RCA adapter cable in glove box. Store remote, game controller, and headphones in rear cargo area of vehicle.

Wiring Diagram

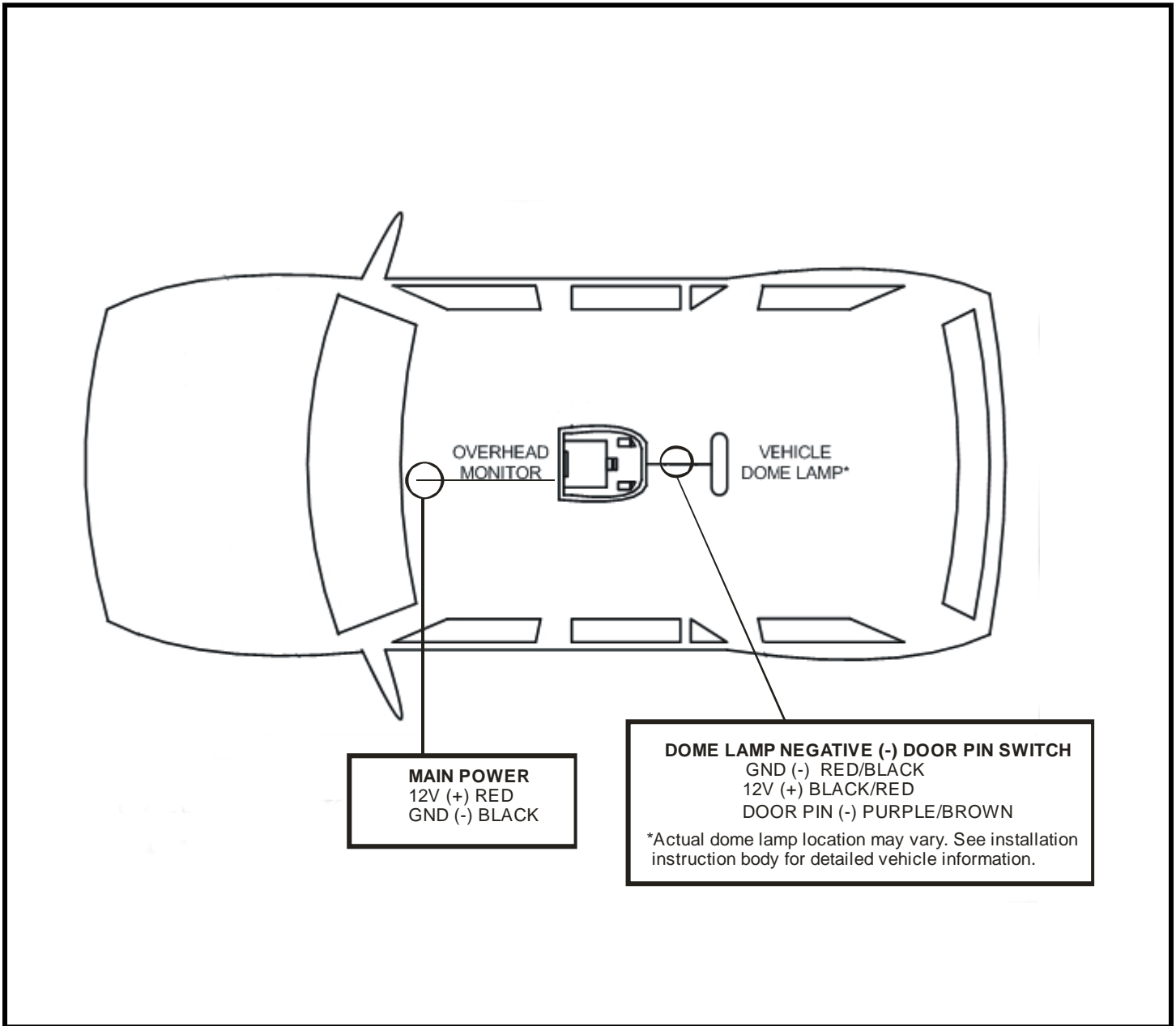



Functional Verification:

Check

Look For



Accessory Function checks:



Turn vehicle ignition to ON, depress power button on remote control for monitor.

Monitor should power on, start up screen should appear on screen.



Insert DVD into monitor, press enter.

DVD should begin playing.



Depress "FMM" on remote control. Tune vehicle FM radio station to channel displayed on screen.

FMM "ON" and FM channel displayed on screen.

Note: Install factory antenna mast for proper reception.



Depress "FMM" on remote control. Tune vehicle FM radio station to channel displayed on screen.

FMM "OFF" and FM channel displayed on screen. Vehicle radio should operate normal



Turn power "ON" wireless headphones (turn Volume dial up slightly on headphones).

Program on ADV29 monitor should be audible through wireless headphones.



Slide dome lamp switch on monitor to "ON".

Both lights on monitor should turn on.

NOTE: In order to change the radio frequency for FM modulation, press TV on the remote control, than press SYSTEM MENU in order to enter the system menu and change the frequency. This is done by going to FMM and pressing ENTER, toggle down to FMM SELECT and choosing the desired frequency.

VEHICLE FUNCTION CHECK

AFTER ALL PANELS, COVERS, AND COMPONENTS HAVE BEEN REINSTALLED, THAT WERE REMOVED, TEST THOROUGHLY, ALL MECHANICAL AND ELECTRICAL COMPONENTS DISCONNECTED AND OR REMOVED FROM THE VEHICLE DURING THE INSTALLATION OF THIS ACCESSORY.



Troubleshooting:

Condition:

Check For:

Unit does not power "ON"

1. Is ignition turned "ON"?
2. Is battery installed in remote control?
3. Are power connections and ground secured?
4. Check power on the vehicle side of power connection.
5. Check power on the accessory side of power connection.
6. Is vehicle fuse blown? If yes, check to see that there is not a short circuit.
7. Check overhead video unit for continuity to ground on black wire and power at red wire on 2 pin connector (Fig. 1). Use eyelet as ground connection for all voltage checks. If continuity and power exist, the problem lies in the overhead unit.

Sound is not heard through vehicle radio

1. Is "FMM" turned on?
2. Does vehicle radio station match radio station displayed when "FMM" is turned "ON"?

Sound is not heard through wireless headphones

1. Are batteries installed?
2. Is power "ON" (headphones)?
3. Is volume turned "UP" (on headphones)?
4. Is anything blocking signal between monitor and headphones?

Vehicle has poor sound

1. Turn off "FMM" on monitor

Interference caused by local radio station

1. Use FMM Select to step through setup menu to choose a different channel.

IR Sensor inoperative

1. Verify that the battery in the remote is fresh.
2. Verify that the remote sensor eye is not obstructed.
3. Verify that the infrared transmitter is affixed over the sensor eye of the component to be controlled.

No picture

1. Verify the correct video input mode is used.

Unit powers up but no audio and/or video

1. Try another disc format (Note: not all DVD formats are compatible with player).