



Southeast Toyota Distributors, LLC Accessory Installation Instructions

2018 Prius LED Illumination Package (Interior and Exterior)

Year & Model:	2018 Prius
Part Number:	00016-00064, 00016-00071
Accessory Code:	LL1000, LL1010
PIO / DIO:	PIO / DIO
Business Partner:	L28

Conflicts

N/A

General Applicability

Fits Models
1 All 2018 Models

Additional Items Required For Installation

Item#	Description:
1	A-Pillar Clip (62217-78010)

Sequence of Application

Item#	Accessory:
1.	N/A

SPECIAL NOTE: Installation Sequences
After TMS & Safety mandated preparatory steps have been taken, the installation sequence is the suggested method for completing the accessory installation. In some instances the suggested sequence is written for one associate to install & in others the sequence is given as part of a team accessory installation. Unless otherwise stated in the document, the associates may perform the installation steps in any order to make the installation as efficient as possible while maintaining consistent quality.

Recommended Tools

Safety Tools	
Installation Tools	Notes
Screwdriver	Philips Head
Socket	8, 10, & 12mm
Trim Panel Removal Tool	
Pliers	
Drill	
Drill Bit	11/64"
Drill Bit	7/16"
Drill Stop	
Sockets/ Ratchet	10mm, 12mm
Rivet Gun	
Tape Measure	
Fish Tape	
Utility Knife	
Special Chemicals	
50/50 Alcohol Water Mixture	
VPC Approved Sealant	

Legend



STOP: Damage to the vehicle may occur. Do not proceed until process has been complied with.



OPERATOR SAFETY: Use caution to avoid risk of injury.



CAUTION: A process that must be carefully observed in order to reduce the risk of damage to the accessory/vehicle and to ensure a quality installation.



TOOLS & EQUIPMENT: Used in Figures calls out the specific tools and equipment recommended for this process.



REVISION MARK: This mark highlights a change in installation with respect to previous issue.



SAFETY TORQUE: This mark indicates that torque is related to safety.

Table of Contents

I. Preparation.....1-5

a.) Table of Contents.....2

b.) Kit/Hardware & Wire Harness Bag Contents.....3

c.) Parts for Installation.....4

d.) Service & Warranty Information.....5

II. Procedures

a.) Battery Removal.....6

b.) Vehicle Preparation & Installation Process.....7-18

III. Re-install Battery.....19

IV. Functions & Quality Check..... 19

V. Diagnostic /Block Diagrams & Connectors Procedures.....20-22

VI. Warranty Statement.....22-24

Kit/Hardware Bag Contents:

Item #	Quantity	Description
1.	15	Wire Ties
2.	4	Foil Tape
3.	5	Foam Tape
4.	14	Plastic Rivets
5.	3	Red T-Taps
6.	3	Black T-Taps
7.	1	Blue T-Tap

Care must be taken when installing this accessory to ensure damage does not occur to the vehicle. The installation of this accessory should follow approved guidelines to ensure a quality installation. These guidelines can be found in the “Accessory Installation Practices” document.

This document covers such items as:

- Vehicle Protection (use of covers and blankets, cleaning chemicals, etc.).
- Safety (eye protection, re-checking torque procedure, etc.).
- Vehicle Disassembly/ Reassembly (panel removal, part storage, etc.).
- Electrical Component Disassembly/Reassembly (battery disconnection, connector removal, etc.).

Parts for Installation:

Item #	Quantity	Description
1.	4	Puddle Lights and Harnesses
(a)	1	LF (4.9') Puddle Light
(b)	1	LR (7.8') Puddle Light
(c)	1	RF (10.8') Puddle Light
(d)	1	RR (13.8') Puddle Light
2.	1	Control Module
3.	1	Power Harness
4.	1	Foot-well Harness
5.	2	Foot-well Lights
6.	1	Hardware Bag

1

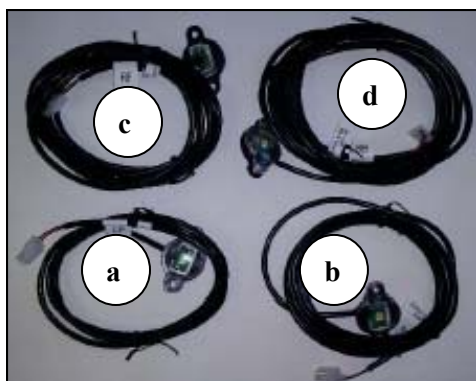

2



3



5

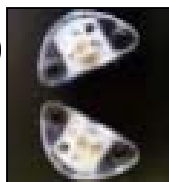

6



4



Service and Warranty Information:

Image Key	Parts information		Warranty Information	
	Part Number	Description	Warranty Time	Labor Op. Code
NA	00016-00071	LED Illumination Pckg (Int/Ext) No Trunk	NA	NA
A	00016-00064-01	Power harness	0.3	AIP011
B	00016-00064-02	Foot well light harness	0.4	AIP021
C	00016-00064-03	Foot well LED light pod	0.2	AIP031
D	00016-00064-04	Puddle light control module	0.3	AIP041
E	00016-00064-05	Left Front puddle light and harness	1.3	AIP051
F	00016-00064-06	Left Rear puddle light and harness	1.3	AIP061
G	00016-00064-07	Right Front puddle light and harness	1.3	AIP071
H	00016-00064-08	Right Rear puddle light and harness	1.3	AIP081
Note: Use Combo codes if replacing more than one puddle light. A for additional 0.3 per light. A- adds 0.3 for two lights, AA- adds 0.6 for three lights, AAA- adds 0.9 for three lights				
N/A	00016-00064-99	Trunk LED – NOT IN KIT (Stand-alone)	0.2	AIP091

Labor times include consideration for diagnosis and Administration time

If you are a dealer located outside of the Southeast Region, please contact the SET Accessory Warranty Department at (888) 851-2722 or email Accessory.Warranty@SETToyota.com for claim payment instructions.

Image:



Battery Preparation

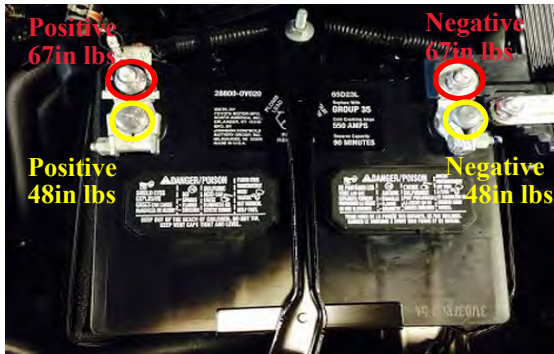

NOTE: It is recommended to use Option 1 when a lead wire is not being installed. However Option 2 is to be used when a lead wire is being added to the positive side, or anytime the negative side 12mm nut is being removed, re-torque both to 67in lbs.

NOTE: If removal of the positive battery terminal 12mm nut is required to install a lead wire, the negative battery terminal must be disconnected first to disable the electrical system. The positive battery or terminal should never be disconnected unless the negative battery terminal is first removed & waiting 90 seconds for the SRS system to power down.

Option 1: If the battery clamp nut cannot be accessed to set torque to the recommended specification without removing additional panels & /or other components. You may change (reverse the direction) the negative battery clamp bolt & nut. Battery terminal must have torque set to factory specification . **CAUTION:** Do not touch the positive terminal. Re-torque to 48in lbs.

Option 2: Removing the 12mm nut from the positive or negative terminal junction. When re-tightening the torque specification is 67in lbs.

**VEHICLE PREPERATION & INSTALLATION**

Figure 1



Figure 2

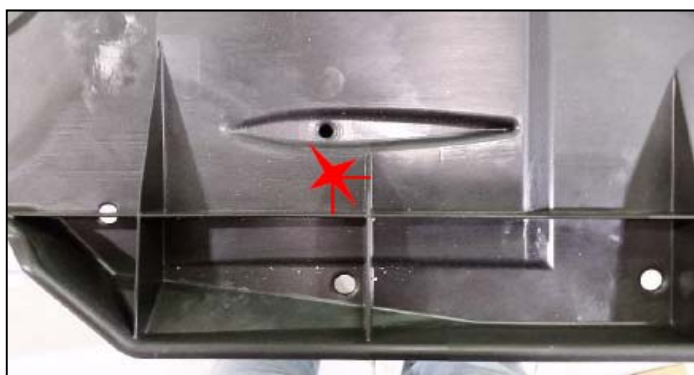

Figure 3



Figure 4

1. Remove both the underside skid plates, LH and RH. See Figure 1.
 2. Mark drill locations on skid plates for all four light pods. The rear pods should be located as shown in Figure 2 and the fronts as shown in Figure 3.
 3. Using the 1" hole saw, enlarge the factory holes found in the rear of the skid plates as shown in Figure 2.
 4. Using the 1" hole saw drill the front light locations, approximately $\frac{3}{4}$ " from each rib. See Figure 3.
 5. Temporarily align puddle lights. Using an $\frac{11}{64}$ " drill bit, drill the 2 mounting holes for each light.
- NOTE: Arrow on puddle light lens must face out, away from underside of vehicle.**
6. Thread appropriate puddle light harness through corresponding 1" hole and secure in place with plastic rivets.
 7. Route rear harnesses forward along the rib of the plastic skid plate. Using foil tape, attach harnesses to cleaned skid plate as shown in Figures 2 and 4.

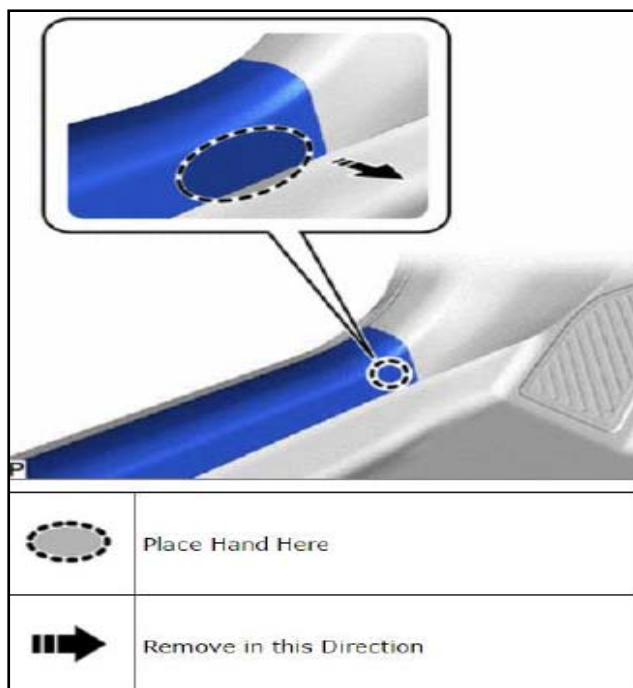

Figure 5

8. Remove Front Door Scuff Plate LH.
 - a. Disengage the claw as shown in Figure 5.
 - b. Disengage the 6 claws and 2 guides to remove the front door scuff plate LH as shown in Figure 6.

Hint: Use the same procedure for the front side and rear side.

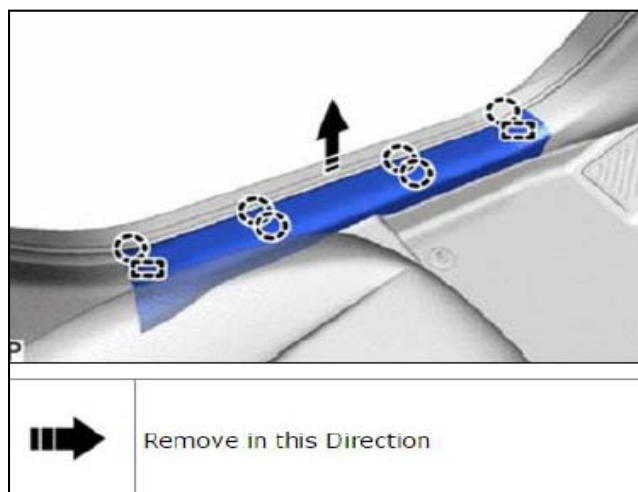

Figure 6

9. Remove cowl side trim board LH.
 - a. Remove the clip.
 - b. Disengage the 2 clips to remove the cowl side trim board as shown in Figure 7.

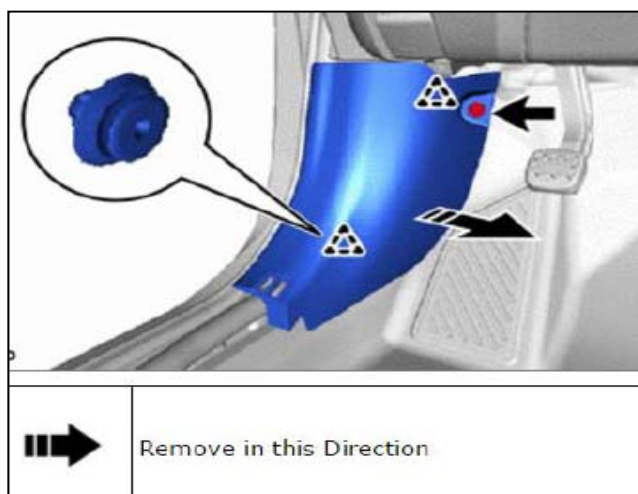

Figure 7

10. Remove the Front Door Scuff Plate RH.

Hint: Use the same procedure as for the LH side.

11. Remove the cowl side trim board RH.

Hint: Use the same procedure as for the LH side.



Figure 8

12. Locate the front floor pan drain plugs and drill a 5/8 hole in each one in order to fish the puddle light harnesses through one by one. See Figure 8.

13. Reinstall both under-body skid plates with puddle lights installed making sure to remove excess slack.



Figure 9

14. Seal harness to drain plugs using VPC approved sealant. Make sure to work sealant completely around wires for a water tight seal. See Figure 9.

15. Route harnesses to rockers and tape in place using one piece of foam tape per side. See Figure 9.



Figure 10

16. Route harnesses along factory harness at rockers towards kick panels, wire tying in place. See Figure 10.

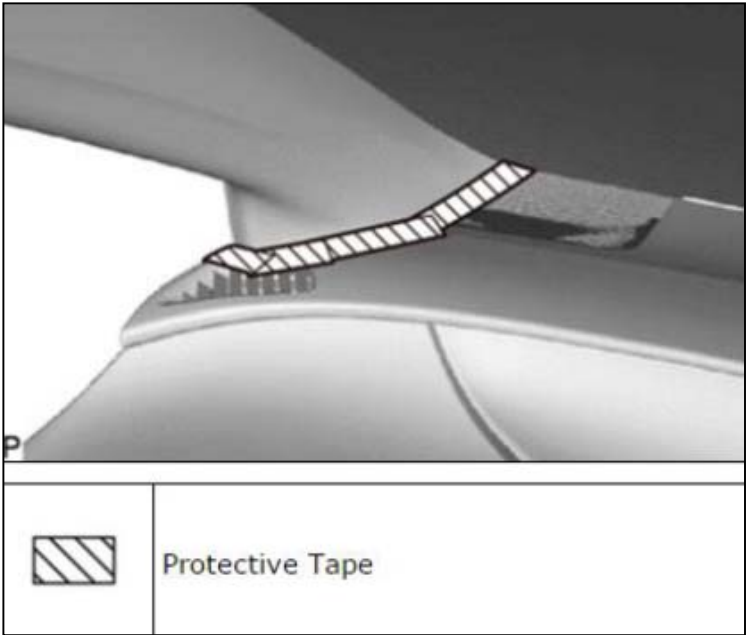

Figure 11

17. Remove Front Pillar Garnish LH.
- a. Apply protective tape around the front pillar garnish LH as shown in Figure 11.

Hint: Let the front pillar garnish LH hang from the front pillar garnish clip.

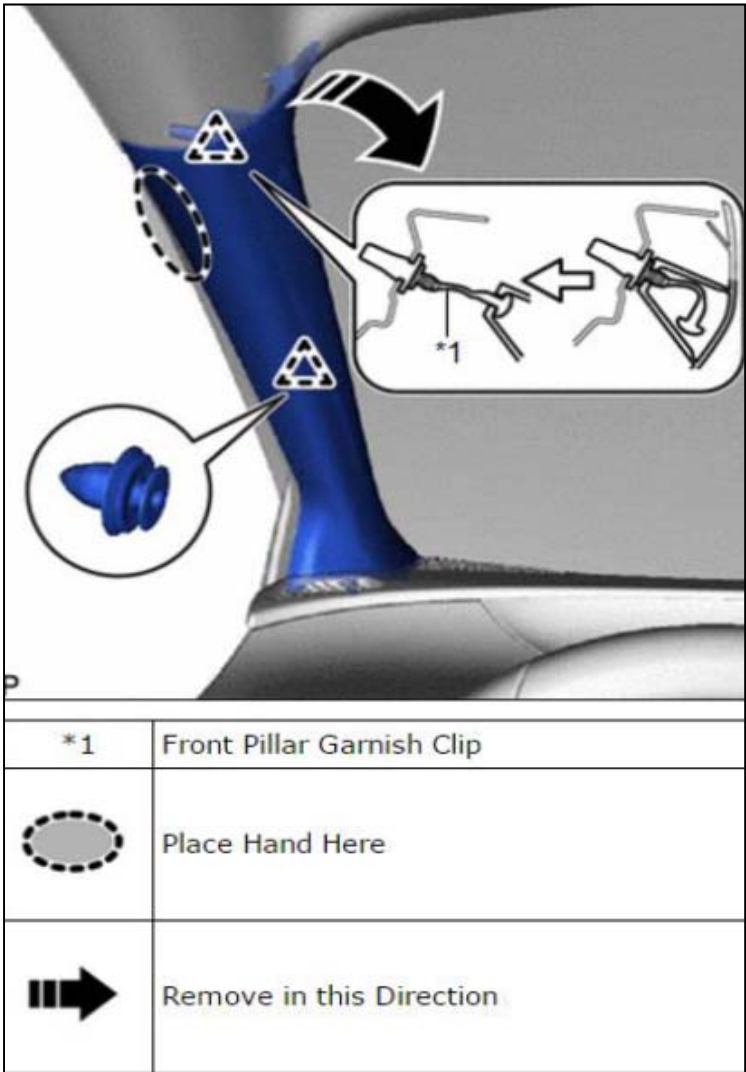

Figure 12

- b. Pull the upper part of the front pillar garnish LH towards the inside of the cabin to disengage the clip and front pillar garnish LH from the base of the front pillar garnish clip. See Figure 12.

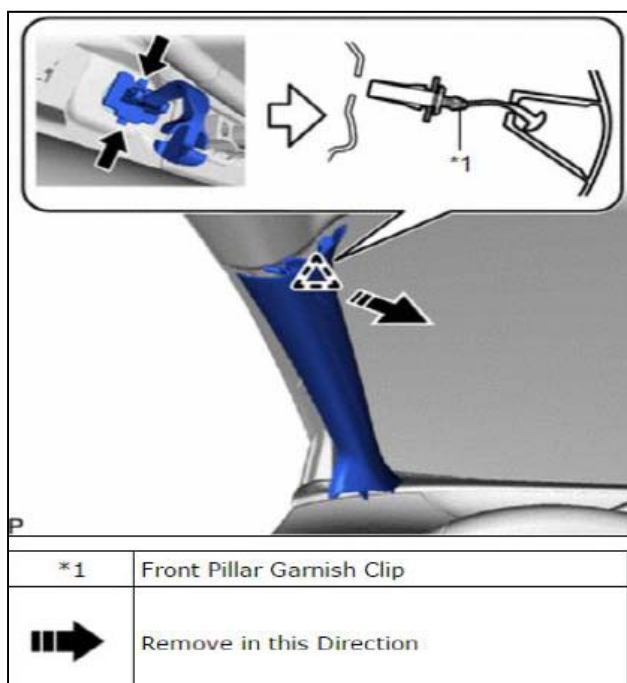

Figure 13

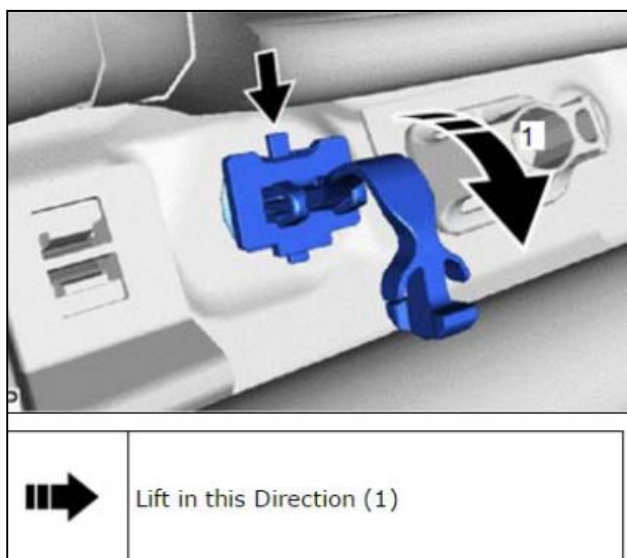

Figure 14

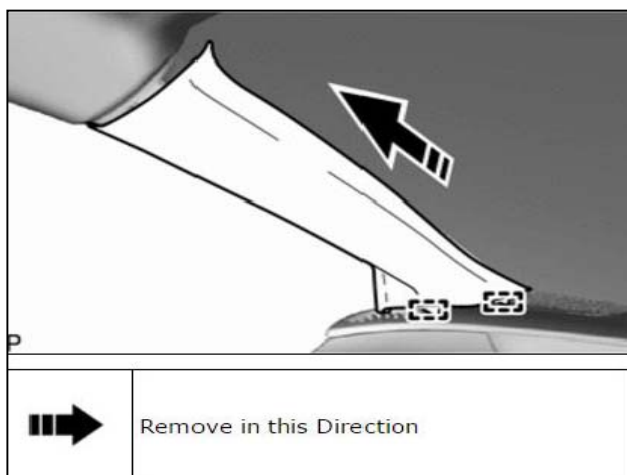

Figure 15

- c. While pushing the tabs of the front pillar garnish clip as shown in Figure 13, disengage it.

Hint: When the front pillar garnish clip cannot be removed using your fingers.

While pressing the part shown in Figure 14 with your finger, move the front pillar garnish clip in the direction indicated by the arrow (1) shown in Figure 14.

While pulling the front pillar garnish clip in the direction indicated by the arrow (2) push the part shown in the illustration with the end of a screw driver and remove the front pillar garnish clip.

- d. Disengage the 2 guides to remove the front pillar garnish LH as shown in Figure 15.



These clips CAN NOT be reused. DESTROY and DISPOSE of clips. See Figure 11 NOTE: Install a new A-Pillar garnish upper clip when replacing garnish at end of installation. A-Pillar clip 62217-78010 is not provided in the kit. This item must be ordered separately.

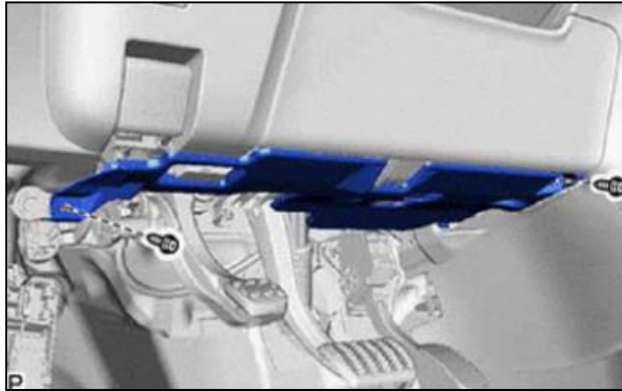

Figure 16

18. Remove No. 1 Instrument Panel Under Cover Sub-Assembly.

- a. Remove the 2 screws. See Figure 16.



Figure 17

- b. Disengage the claw as shown in the illustration. See Figure 17.

- c. Disengage the guide shown in the illustration. See Figure 18.

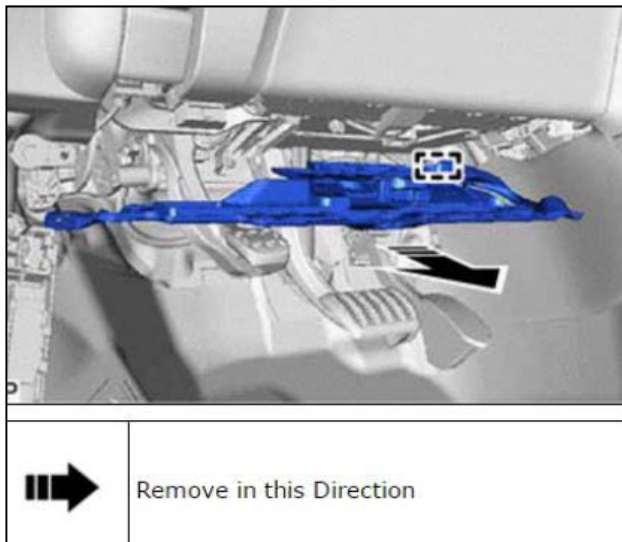

Figure 18

- d. Disconnect the connector to remove the No.1 instrument panel under cover sub-assembly.

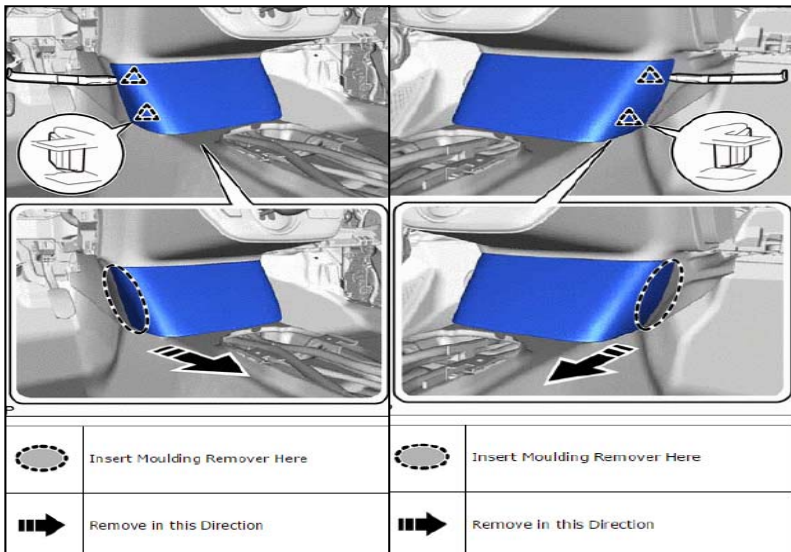

Figure 19

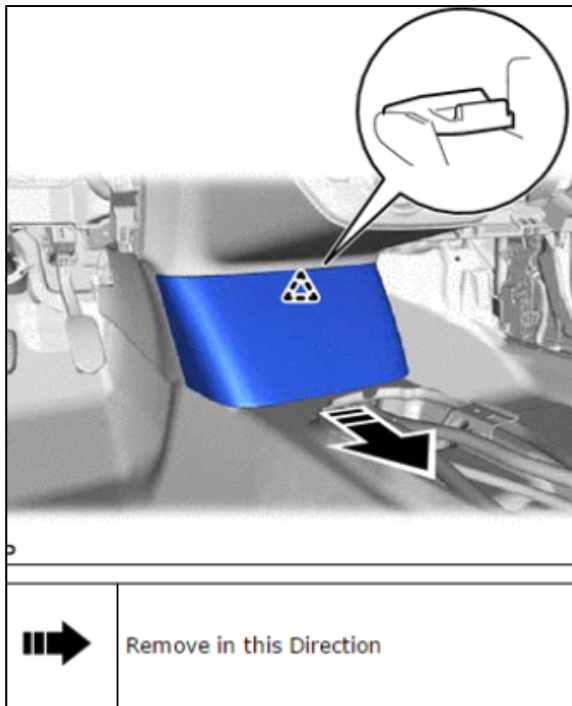

Figure 20

19. Remove Lower Center Instrument Cluster Finish Panel Sub-Assembly.

- Using a moulding remover, disengage the 2 clips as shown. See Figure 19.
- Using a moulding remover, disengage the 2 clips as shown. See Figure 19.
- Disengage the clip as shown in the illustration. See Figure 20.

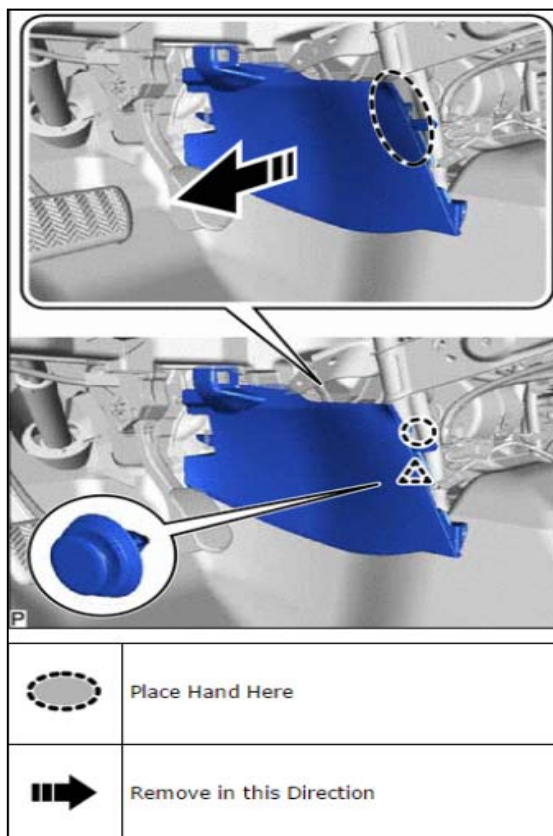

Figure 21

20. Remove Front No.1 Console Box Insert.

- a. Disengage the clip as shown. See Figure 21.

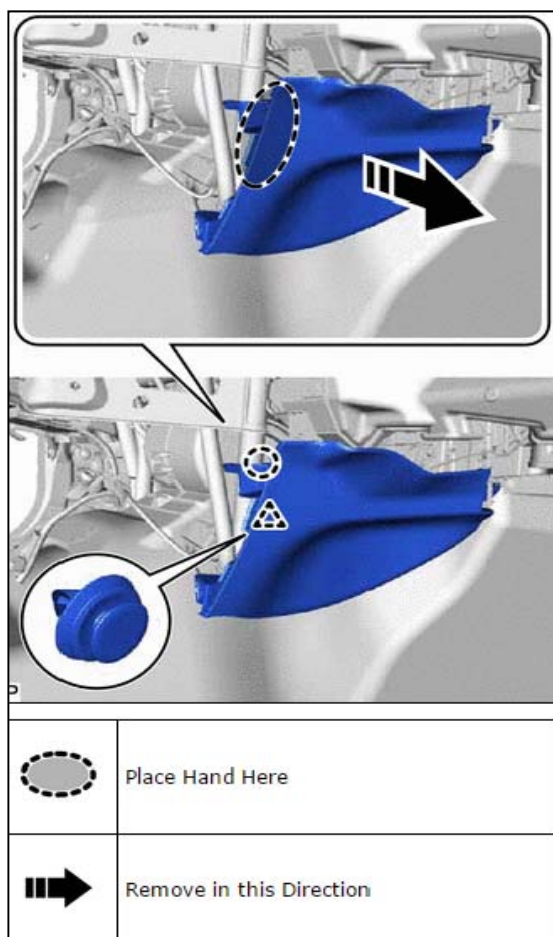

Figure 22

21. Remove Front No.2 Console Box Insert.

- a. Disengage the clip and claw as shown. See Figure 22.

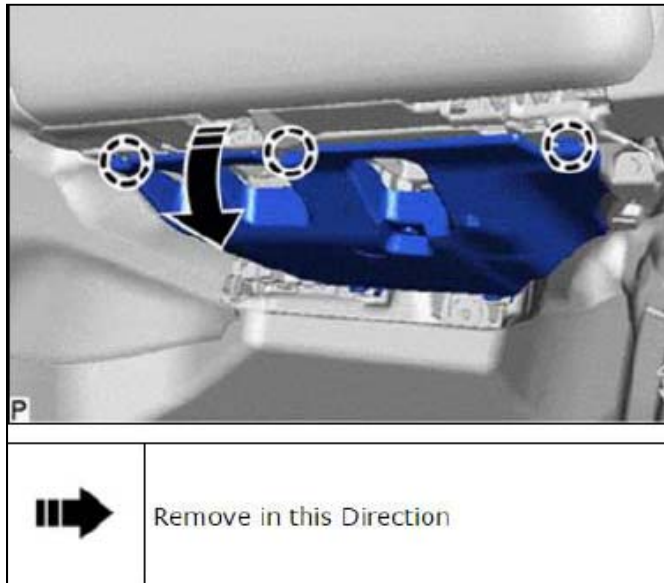

Figure 23

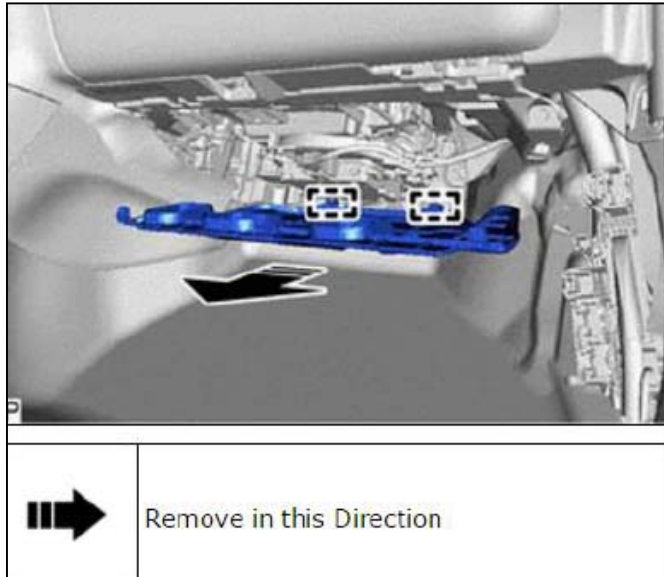

Figure 24



Figure 25

22. Remove No. 2 Instrument Panel Under Cover Sub-Assembly.

- a. Disengage the 3 claws as shown in the illustration. See Figure 23.
- b. Remove the 2 guides as shown. See Figure 24.
- c. Disconnect the connector to remove the No. 2 instrument panel under cover sub-assembly.

23. On the No.1 Instrument Panel under cover sub-assembly, mark where the foot-well light will be mounted as shown in Figure 25.



Figure 26



Figure 27



Figure 28



Figure 29

24. On the No. 2 Instrument panel under cover sub-assembly, mark where the foot-well light will be mounted, approximately $\frac{3}{4}$ " from each rib. See Figure 26.

25. Drill a $\frac{7}{16}$ " hole where the foot-well connector will be located. Align light with connector in place and the flat side facing the seats. Using an $\frac{11}{64}$ " drill bit, drill mounting holes. Mount light using plastic rivets.

26. Route passenger side puddle light harnesses under foam foot board and over to driver side kick panel. See Figure 27.

27. Route longer side of foot-well harness from driver side foot-well to passenger side. Secure to factory harness on passenger side as shown. See Figure 28.

28. Secure passenger foot-well and puddle light harnesses along emergency brake cable to driver kick panel. See Figure 29.

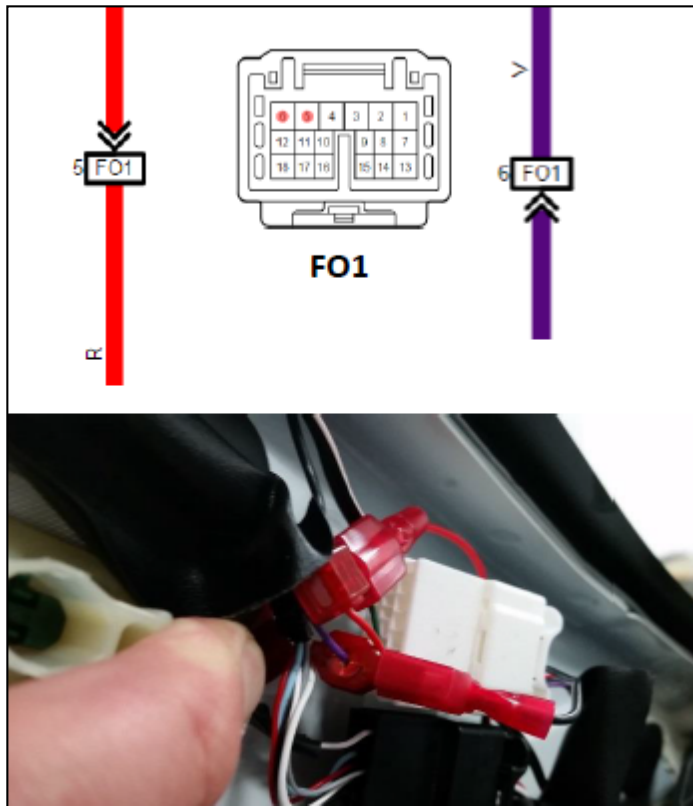

Figure 30

29. Using a Red T-Tap, connect the Red wire from the puddle light power harness to the Red wire in Pin 5 of the white FO1 connector found in the A-pillar. See figure 30.

30. Using a Red T-Tap connect the Black wire from the puddle light harness to the Violet wire in Pin 6 of the FO1 connector. See Figure 30.

31. Drop the fused end of the power harness from the lower corner of the A-pillar down towards the driver's kick panel, securing in existing wire locations.

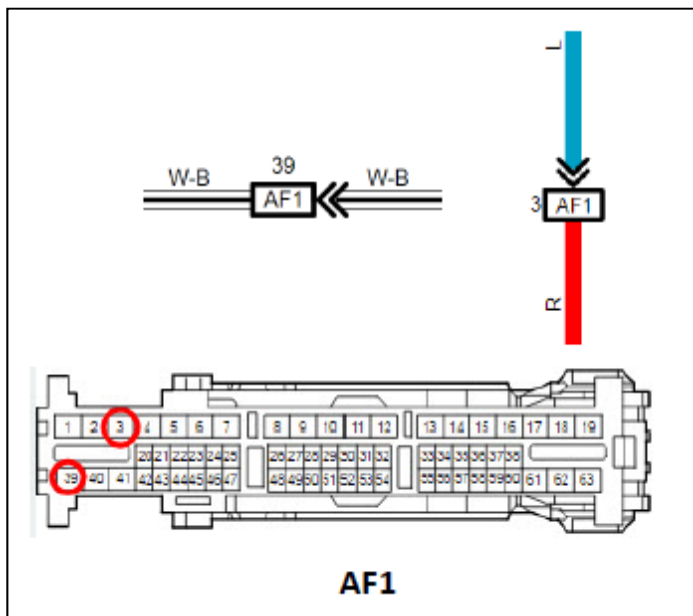

Figure 31

32. Connect the Red wire from the foot-well harness to the Red wire from puddle light power harness. Connect the White wire from the foot-well harness to the White wire from the puddle light harness.

33. Using a Blue T-Tap connect the Yellow wire from the foot-well harness to the Red wire in the AF1 connector pin 3 found in the driver sidekick panel. See Figure 31.



Figure 32

34. Using a Red T-Tap connect the Black wire from the foot-well harness to the White/Black wire in Pin 39 of the AF1 connector. See Figure 32.

35. Route additional foot-well connector to driver side foot-well location and wire tie in place.



Figure 33

36. Connect all harnesses to control module and mount under driver side dash. See Figure 33.

37. Bundle excess harnesses behind factory harnesses in the driver sidekick panel.



Figure 34

38. Connect lights and reinstall No. 1 and No. 2 instrument panel undercover sub-assemblies. See Figure 34.

Note: Trunk light will not be used in the installation.

39. Print Warranty Statement and place into the glove box, DIO Only.

TESTING AND REASSEMBLY



1. REINSTALL ALL TRIM PANELS IN THE ORDER OF REMOVAL TAKING SPECIAL CARE TOMAKE SURE ALL HARNESES AND WIRING ARE PROPERLY SECURED. MAKE SURE HARNESES ARE NOT PINCHED OR BOUND BY TRIM PIECES.

2. RECONNECT NEGATIVE BATTERY CABLE AND TORQUE.



If option1 was used: 10mm nut 48 IN/LBS.

If Option2 was used: 12mm nut 67 IN/LBS.

ACCESSORY FUNCTION CHECK:

LOOK FOR:



Test for full light condition

Close all doors and lock vehicle. Do foot-well and puddle lights go out? Unlock vehicle, do foot-well lights come on full brightness? Do puddle lights come on?



Test for low light condition

Start vehicle, do puddle lights go out? Do the foot-well lights dim to low level? Turn on headlights. Do foot-well lights come on in dim mode?

VEHICLE FUNCTION CHECK:



Ignition

Verify vehicle will crank.



SRS Warning Light

Confirm SRS warning light illuminated for approximately 6 seconds with the ignition on, and then goes out.



Warranty Statement

Place Warranty Statement in glove box, DIO only.

F kci pquwle 'IDmjemF kci t co u('Eqppgevt u'Rt qegf wt gu

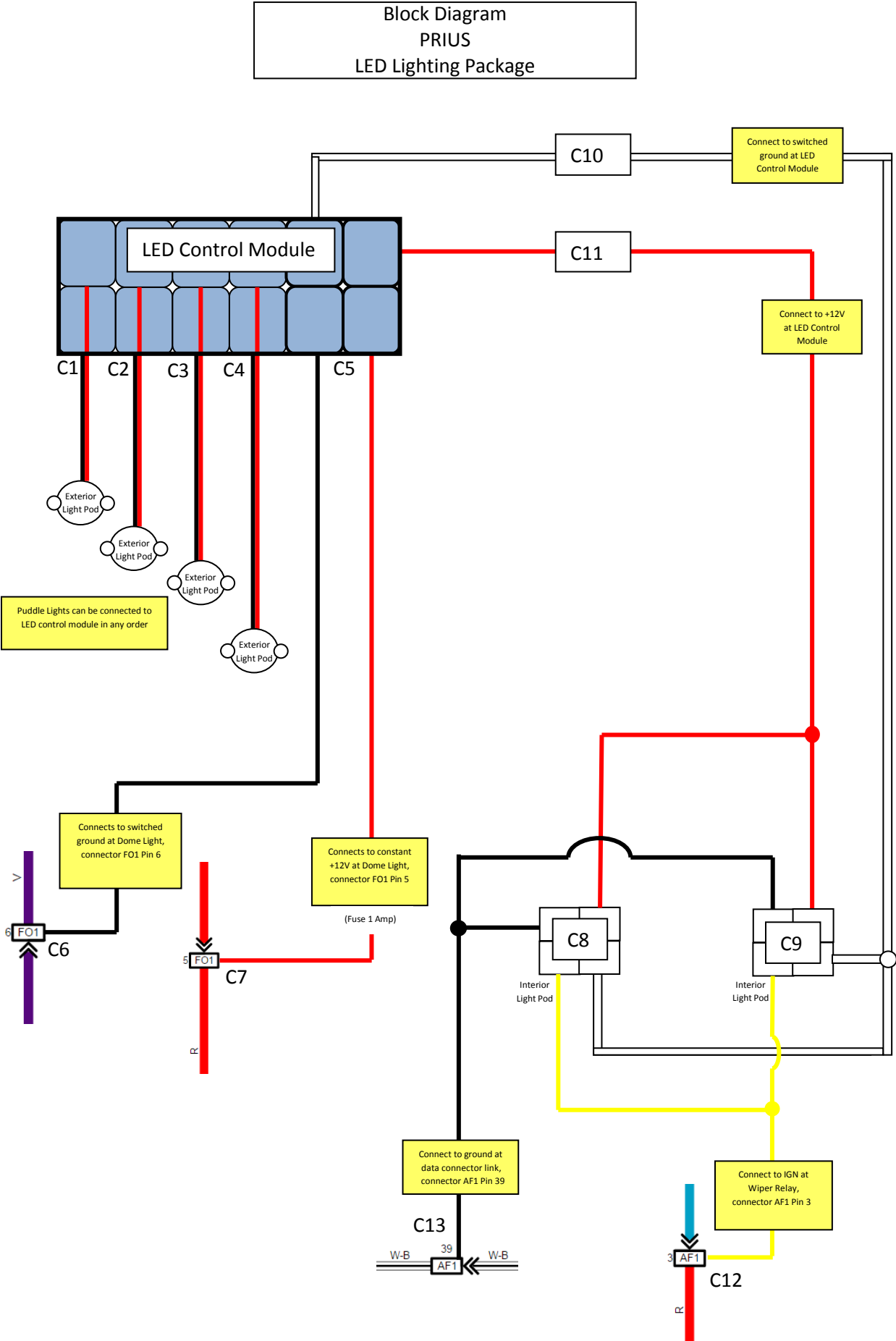

F k i p q u k e ' I D n e m F k i t c o u (' E q p p g e v t u ' R t q e g f w t g u



Connector C-1 thru C-4

Pin	Wire Color	Test Reference	Proper Orientation
1	Black	Pin 1 to Ground	Exterior LEDs (-)
2	Red	Pin 2 to Ground	Exterior LED (+)

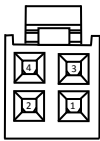

Connector C5

Pin	Wire Color	Test Reference	Proper Operation
1	Black	Pin 1 to Ground	Approximately 0 VDC
2	Red	Pin 2 to Ground	Approximately 0 VDC when Dome Light is ON +12 VDC when Dome Light is OFF
3	White	Pin 3 to Ground	Approximately 0 VDC (when disconnected from control module)
4	Red	Pin 4 to Ground	Approximately 0 VDC (when disconnected from control module)

Connector C6



Pin	Wire Color	Test Reference	Proper Operation
1		Pin 1 to Ground	Approximately 0 VDC when Dome Light is ON +12 VDC when Dome Light is OFF

Connector C7



Pin	Wire Color	Test Reference	Proper Operation
1			+12 VDC

Connector C8 & C9



Pin	Wire Color	Test Reference	Proper Operation
1	Red	Pin 1 to Ground	+12 VDC
2	Black	Pin 2 to Ground	Approximately 0 VDC
3	White	Pin 3 to Ground	Approximately 0 VDC when Dome Light is ON +12 VDC when Dome Light is OFF
4	Yellow	Pin 4 to Ground	Approximately 0 VDC ignition switch OFF +12 VDC when ignition ON

F lci pqule'DmgeniF lci t co u'('E qppgewqt u'Rt qegf wt gu

Connector C10



Pin	Wire Color	Test Reference	Proper Operation
1	White	Pin 1 to Ground	Approximately 0 VDC when Dome Light is ON +12 VDC when Dome Light is OFF

Connector C11



Pin	Wire Color	Test Reference	Proper Operation
1	Red	Pin 1 to Ground	+12 VDC

Connector C12



Pin	Wire Color	Test Reference	Proper Operation
1	Yellow	Pin 1 to Ground	Approximately 0 VDC ignition switch OFF +12 VDC when ignition ON

Connector C13



Pin	Wire Color	Test Reference	Proper Operation
1	Black	Pin 1 to Ground	Approximately 0 VDC

LIMITED WARRANTY – SOUTHEAST TOYOTA

SOUTHEAST TOYOTA DISTRIBUTORS, LLC ("we," "our" and "us") provides the following limited warranty on our accessories, excluding tires, ("Accessories" or "Accessory") installed on a Toyota. This limited warranty is not provided by and does not bind or provide benefit to the vehicle dealer, the manufacturer, or Toyota Motor Sales, U.S.A., Inc. This limited warranty does not apply to tires; please consult the tire manufacturer and/or its materials accompanying the vehicle for any warranty terms concerning tires. This limited warranty also does not apply to ToyoGuard Exterior Paint Sealant and ToyoGuard Interior Protector; please consult the ToyoGuard Limited Warranty Certificate for the warranty terms concerning those products.

SCOPE OF LIMITED WARRANTY:

A. Protection:

- i. **Accessories Installed by Southeast Toyota Distributors, LLC on a new Toyota vehicle.** We warrant that, for a period of 36 months or 36,000 miles, whichever occurs first, we will repair or replace (includes labor), free of charge, any defect in such an Accessory due to faulty material or workmanship, or, at our option, provide a full refund of the purchase price of the Accessory. The warranty period begins on the vehicle's In-Service Date, which is the first date the new vehicle is either delivered to an ultimate purchaser, leased, or used as a company car or demonstrator. Accessories installed by Southeast Toyota Distributors, LLC are identified on the vehicle's window sticker (Monroney Label).
- ii. **Accessories Installed by a Toyota Dealer on a Toyota vehicle.** We warrant that, for 12 months, regardless of mileage, from the date such an Accessory was installed on the vehicle or the remainder of the Toyota new vehicle warranty, whichever is longer, we will repair or replace (includes labor), free of charge, any defect in the Accessory due to faulty material or workmanship, or, at our option, provide a full refund of the purchase price of the Accessory. For a new vehicle, the warranty period begins on the vehicle's In-Service Date, which is the first date the new vehicle is either delivered to an ultimate purchaser, leased, or used as a company car or demonstrator.
- iii. **Accessories purchased from a Toyota Dealer but not installed by the Toyota Dealer.** We warrant that, for a period of 12 months, regardless of mileage, from the date the accessory was purchased, we will repair or replace (does not include labor), free of charge, any defect in the Accessory due to faulty material or workmanship, or, at our option, provide a full refund of the purchase price of the Accessory.

B. Limitation of Warranty. This limited warranty does not apply to, and we will not repair, replace, or reimburse you for: (1) wheel balancing and wheel alignments, except for one wheel balancing or alignment during the first 12 months or 12,000 miles, whichever occurs first, from the vehicle's In-Service Date, as defined above, (2) abrasions or dents, whatever their cause, and any failure or damage resulting directly or indirectly from accidents, collisions, impacts from foreign objects, fire, theft, larceny, explosion, malicious mischief, vandalism, civil commotion, riots, war, or any other similar causes, (3) any failure or damage resulting directly or indirectly from lightning, windstorms, hail, water, floods, subfreezing temperatures, airborne chemicals, tree sap, dust, salt, and any other environmental conditions or similar causes, (4) any failure or damage caused by: (a) a failure of any part, other than the Accessory, (b) any misuse, abuse, improper towing, negligence or lack of maintenance of the vehicle or Accessory, (c) the alteration, modification or repair of the Accessory by anyone other than persons expressly authorized by us to perform such alteration, modification or repair, or (d) the use of the vehicle for commercial purposes, competitive driving or racing, (5) any failure or damage, if the Accessory has not been installed according to instructions, (6) any failure or damage occurring outside of Canada, the United States of America, its territories or possessions, (7) except to the extent required by the state whose laws govern this limited warranty, any consequential, secondary, or unreasonable costs that may be suffered as a result of the need to repair or replace the Accessory, including without limitation any loss of use of the vehicle, road service, towing, storage charges, inconvenience, loss of wages and/or income, additional expense incurred, loss of transportation, rental car expense, or any derivative damage to persons or things other than the Accessory, including other parts of the vehicle, or (8) liability for damage to property or for injury to or death of any person, arising out of the operation, maintenance or use of your vehicle whether or not related to the covered Accessory.

C. Exclusive Remedy. If there is a valid claim under this limited warranty for a defect due to faulty material or workmanship in the Accessory, we will, at our option, either: (i) repair, (ii) replace or (iii) provide a full refund of the purchase price of the Accessory. We have no other obligations under this limited warranty. Refunds will be made to the vehicle owner. If the vehicle is leased, the refund will be made to the leasing company.

HOW TO MAKE A CLAIM: In the event of a warranty claim, please contact the nearest Toyota dealer to arrange for repairs. The dealership must receive our prior authorization before making repairs covered by this limited warranty. The dealer will contact Southeast Toyota Distributors, LLC at 1-888-851-2722, select option #5 (Warranty Department), then option #4 (Repairs), for instructions on processing a warranty claim, if they are not already familiar with the process. If you have any questions or concerns regarding repairs covered by this limited warranty, please contact our **Customer Assistance Hotline at 1-800-301-6859**.

OUR DISPUTE RESOLUTION PROGRAM: Your satisfaction is our highest priority. In keeping with that focus, in the event that an issue arises related to this Limited Warranty, we invite you to call our Customer Assistance Hotline at 1-800-301-6859 to discuss it. In most cases, we expect that a satisfactory resolution of your issue can be reached through engagement with that Department. If our Customer Loyalty Department is unable to resolve your issue to your satisfaction, we offer a dispute resolution program administered by the National Center for Dispute Settlement (NCDS) ("the Program"). The purpose of the Program is to resolve disputes in an informal setting before an impartial arbitrator. The Program is free of charge to you (although you must bear the cost of any expert witness or attorney you elect to employ). You are required to complete the Program before exercising rights or seeking remedies under the federal Magnuson-Moss Warranty Act, 15 U.S.C. § 2301 et seq. ("the Act"). If you choose to seek remedies that are not created by the Act, you are not required to use the Program before pursuing such remedies – although the Program is still available to you to resolve the dispute. When utilizing the Program, you will need to provide (a) the vehicle identification number of your vehicle, (b) the identity of your selling and servicing dealerships, (c) the mileage on your vehicle at relevant times, (d) the date and nature of any relevant repairs, (e) legible copies of repair orders and other relevant documents, (f) a summary of the unresolved issue and the requested action, and (g) your contact information. In most cases, the dispute resolution process under the Program will be completed within forty (40) days of your submission of your request and will consist of steps such as an initial eligibility determination, an opportunity for you and us to submit information in writing relating to your claim, an oral hearing, and a decision from the arbitrator. A decision will be binding on you only if you choose to accept it. You may submit a request to NCDS by telephone at their toll free number: (877)-276-8848 or in writing at P.O. Box 463196, Mt. Clemens, MI 48046. You may obtain additional information regarding the Program at www.ncdsusa.org. In the event that the NCDS does not exist or no longer handles disputes for us at the time that you seek to submit a request, you may contact our **Customer Assistance Hotline at 1-800-301-6859** to obtain current information about our dispute resolution programs.

GENERAL LIMITATION OF WARRANTY: THIS LIMITED WARRANTY IS IN LIEU OF ALL OTHER EXPRESS WARRANTIES OR LIABILITIES. IN NO EVENT SHALL WE BE LIABLE FOR ANY CONSEQUENTIAL OR INCIDENTAL DAMAGES FOR BREACH OF THIS OR ANY OTHER WARRANTY. SOME STATES DO NOT ALLOW THE EXCLUSIONS OR LIMITATIONS OF INCIDENTAL OR CONSEQUENTIAL DAMAGES, SO THE ABOVE INFORMATION OR EXCLUSION MAY NOT APPLY. NO EXPRESS WARRANTY OF FITNESS OR MERCHANTABILITY IS GRANTED BY THIS LIMITED WARRANTY. THERE ARE NO WARRANTIES WHICH EXTEND BEYOND THOSE DESCRIBED IN THIS DOCUMENT. ANY IMPLIED WARRANTIES, INCLUDING THE IMPLIED WARRANTY OF MERCHANTABILITY OR FITNESS FOR A PARTICULAR PURPOSE, WHICH MAY BE APPLICABLE BY OPERATION OF LAW SHALL BE LIMITED TO THE PERIOD OF THIS WRITTEN LIMITED WARRANTY. SOME STATES DO NOT ALLOW LIMITATIONS ON HOW LONG AN IMPLIED WARRANTY LASTS, SO THE ABOVE LIMITATIONS MAY NOT APPLY. THIS LIMITED WARRANTY PROVIDES SPECIFIC LEGAL RIGHTS, AND THERE MAY BE OTHER RIGHTS WHICH VARY FROM STATE TO STATE. ANY ACTION FOR BREACH OF ANY WARRANTY HEREUNDER, INCLUDING ANY IMPLIED WARRANTY OF MERCHANTABILITY, MUST BE BROUGHT WITHIN A PERIOD NOT EXCEEDING 12 MONTHS AFTER EXPIRATION OF THIS LIMITED WARRANTY. THE REMEDIES SPECIFIED HEREIN AND THOSE SPECIFIED BY APPLICABLE LAW ARE THE ONLY REMEDIES AVAILABLE. WE ASSUME NO OTHER OBLIGATION OR RESPONSIBILITY WITH REGARD TO THE ACCESSORY. WE NEITHER ASSUME, NOR AUTHORIZE ANYONE TO ASSUME FOR US, ANY ADDITIONAL LIABILITY IN CONNECTION HERewith.

GENERAL: This limited warranty describes the complete and exclusive rights that result from the purchase of Accessories. No oral representations or statements may be relied upon. This limited warranty may not be amended or modified, and additional rights may not be granted, unless in a written statement signed by one of our officers. This limited warranty shall be governed by the laws of the state where the vehicle is purchased, excluding laws concerning conflicts of law. We may delegate the performance of our duties and obligations and assign our rights and benefits hereunder. For inquiries regarding this limited warranty, we can be contacted directly at **Customer Assistance Hotline at 1-800-301-6859**, or by mail to: **Southeast Toyota Distributors, LLC, Attention: Customer Loyalty Department, 100 Jim Moran Boulevard, Deerfield Beach, Florida 33442.**